

WELL LOCATION SURVEY PLAT

COMPANY

SINCLAIR OIL & GAS COMPANY

LEASE

State "157-A"

WELL NO.

HOODE OFFICE OCC
1955 MAR 9 AM 9:45

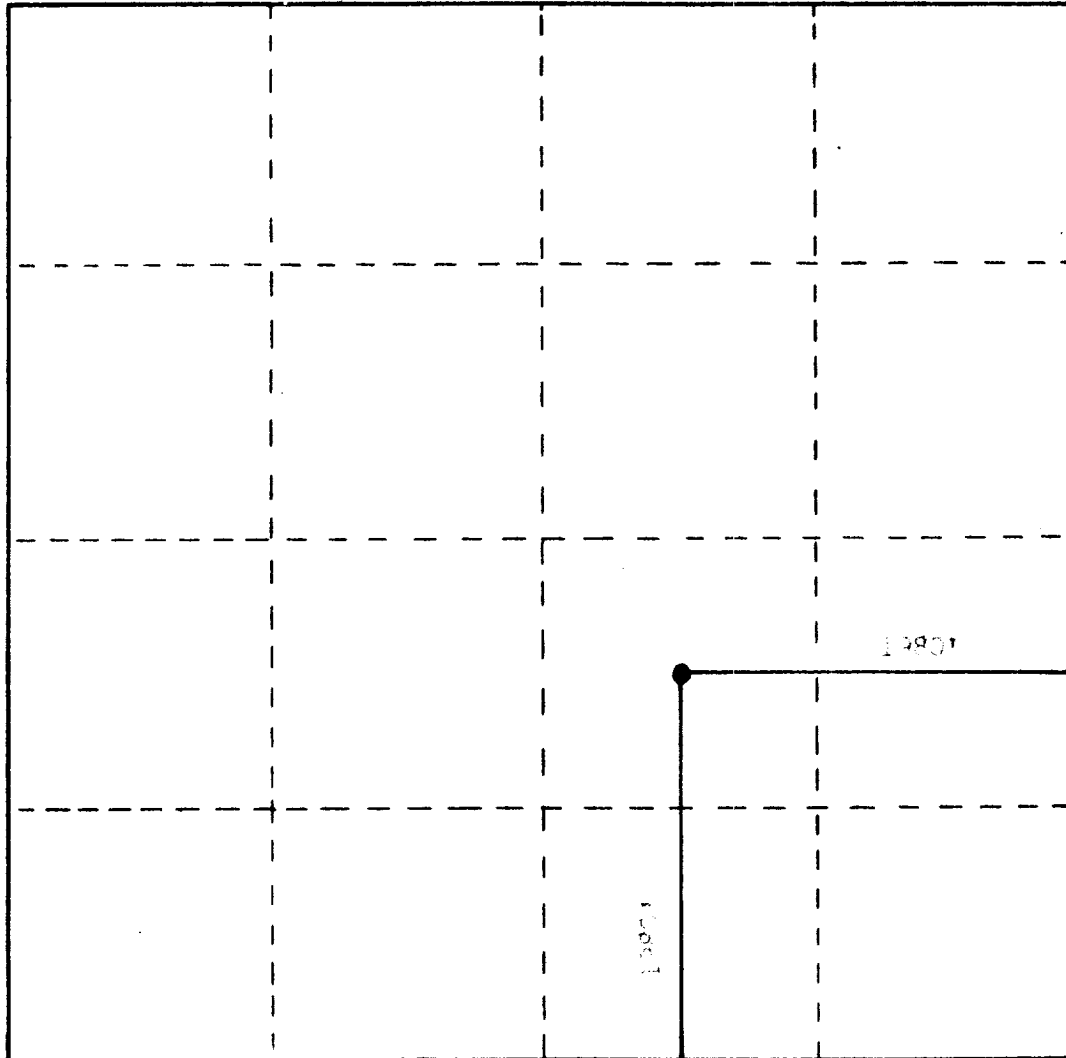

N

SEC. 2 TWP. 22 S. RGE. 36 E. N.M.P.M.

I CERTIFY THAT THIS SURVEY WAS MADE UNDER
MY DIRECTION, AND THAT THE PLAT IS CORRECT
TO THE BEST OF MY KNOWLEDGE.

Glenn H. [Signature]
NEW MEXICO LICENSE NO. 102