

Submit to Appropriate
District Office
State Lease - 4 copies
Fee Lease - 3 copies

State of New Mexico
Energy, Minerals and Natural Resources Department

Form C-102
Revised 1-1-89

OIL CONSERVATION DIVISION

P.O. Box 2088
Santa Fe, New Mexico 87504-2088

DISTRICT I
P.O. Box 1980, Hobbs, NM 88240

DISTRICT II
P.O. Drawer DD, Artesia, NM 88210

DISTRICT III
1000 Rio Brizos Rd., Aztec, NM 87410

WELL LOCATION AND ACREAGE DEDICATION PLAT

All Distances must be from the outer boundaries of the section

Operator ARCO PERMIAN		Lease STATE 157-D		Well No. 7	
Unit Letter N	Section 12	Township T-22-S	Range R-36-E	County NMEN	LEA
Actual Footage Location of Well: 330 feet from the SOUTH line and 2310 feet from the WEST line					
Ground level Elev. 3491'	Producing Formations YATES/7-RIVERS/QUEEN		Pool EUMONT GAS	Dedicated Acreage: 320 Acres	

- Outline the acreage dedicated to the subject well by colored pencil or hatchure marks on the plat below.
- If more than one lease is dedicated to the well, outline each and identify the ownership thereof (both as to working interest and royalty).
- If more than one lease of different ownership is dedicated to the well, have the interest of all owners been consolidated by communitization, unitization, force-pooling, etc.?
☐ Yes ☐ No If answer is "yes" type of consolidation _____
If answer is "no" list the owners and tract descriptions which have actually been consolidated. (Use reverse side of this form if necessary.)
No allowable will be assigned to the well until all interests have been consolidated (by communitization, unitization, forced-pooling, or otherwise) or until a non-standard unit, eliminating such interest, has been approved by the Division.

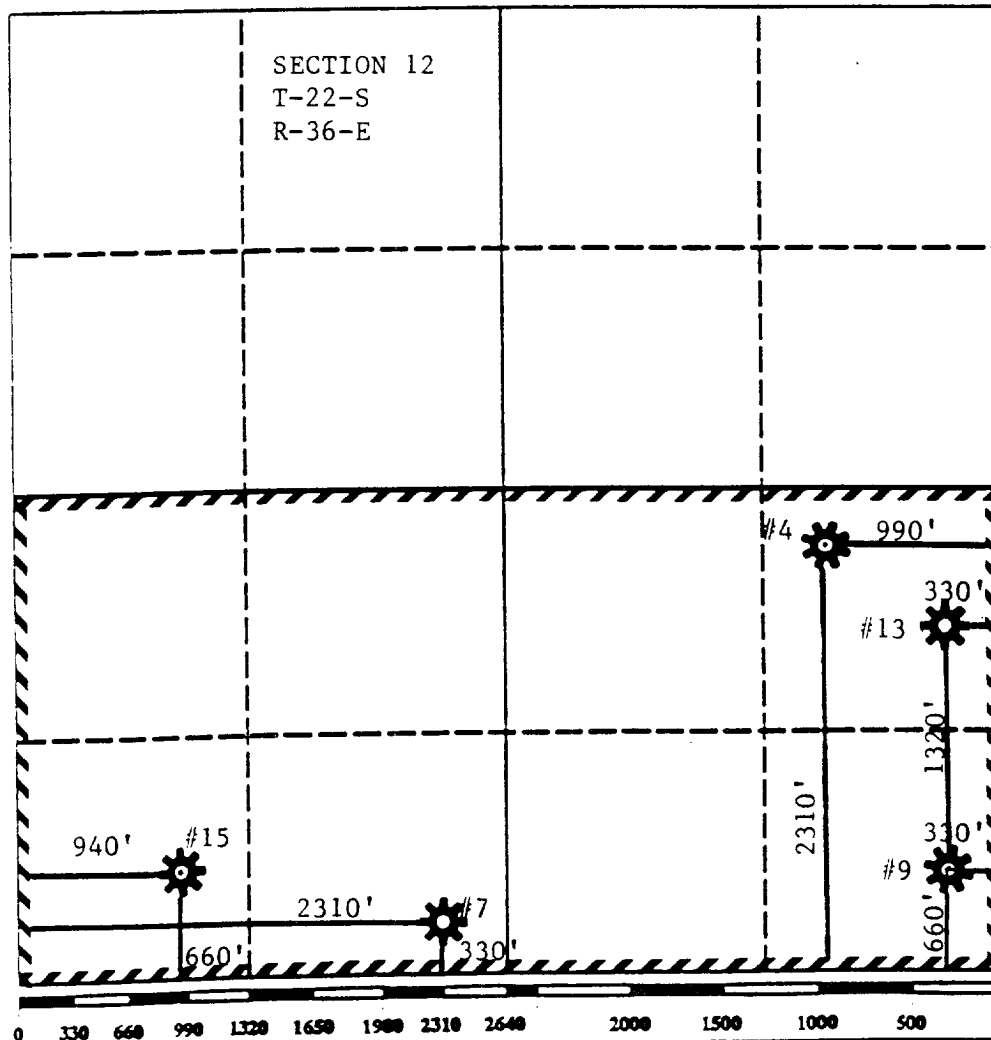

OPERATOR CERTIFICATION

I hereby certify that the information contained herein is true and complete to the best of my knowledge and belief.

Signature
Kathy E. Godfrey
Printed Name
KATHY E. GODFREY

Position
ENGINEERING TECHNICIAN

Company
ARCO PERMIAN

Date
12-05-94

SURVEYOR CERTIFICATION

I hereby certify that the well location shown on this plat was plotted from field notes of actual surveys made by me or under my supervision, and that the same is true and correct to the best of my knowledge and belief.

Date Surveyed

Signature & Seal of
Professional Surveyor

Certificate No.

Submit to Appropriate
District Office
State Lease - 4 copies
Fee Lease - 3 copies

State of New Mexico
Energy, Minerals and Natural Resources Department

Form C-102
Revised 1-1-89

OIL CONSERVATION DIVISION

DISTRICT I
P.O. Box 1980, Hobbs, NM 88240

P.O. Box 2088
Santa Fe, New Mexico 87504-2088

DISTRICT II
P.O. Drawer DD, Artesia, NM 88210

DISTRICT III
1000 Rio Brazos Rd., Aztec, NM 87410

WELL LOCATION AND ACREAGE DEDICATION PLAT

All Distances must be from the outer boundaries of the section

Operator ARCO OIL AND GAS COMPANY			Lease STATE 157-D		Well No. 7
Unit Letter N	Section 12	Township T-22S	Range R-36E	NMPM	County LEA
Actual Footage Location of Well: 330 feet from the SOUTH line and 2310 feet from the WEST line					
Ground level Elev. 3491'	Producing Formation YATES/7-RIVERS/QUEEN		Pool EUMONT GAS		Dedicated Acreage: 320 Acres

1. Outline the acreage dedicated to the subject well by colored pencil or hatchure marks on the plat below.
2. If more than one lease is dedicated to the well, outline each and identify the ownership thereof (both as to working interest and royalty).
3. If more than one lease of different ownership is dedicated to the well, have the interest of all owners been consolidated by communitization, unitization, force-pooling, etc.?
☐ Yes ☐ No If answer is "yes" type of consolidation _____

If answer is "no" list the owners and tract descriptions which have actually been consolidated. (Use reverse side of this form if necessary.)

No allowable will be assigned to the well until all interests have been consolidated (by communitization, unitization, forced-pooling, or otherwise) or until a non-standard unit, eliminating such interest, has been approved by the Division.

OPERATOR CERTIFICATION

I hereby certify that the information contained herein is true and complete to the best of my knowledge and belief.

Signature

E. E. Gilson

Printed Name

E. E. GILSON

Position

ENGINEERING TECHNICIAN

Company

ARCO OIL AND GAS COMPANY

Date

MARCH 22, 1993

SURVEYOR CERTIFICATION

I hereby certify that the well location shown on this plat was plotted from field notes of actual surveys made by me or under my supervision, and that the same is true and correct to the best of my knowledge and belief.

Date Surveyed

Signature & Seal of
Professional Surveyor

Certificate No.

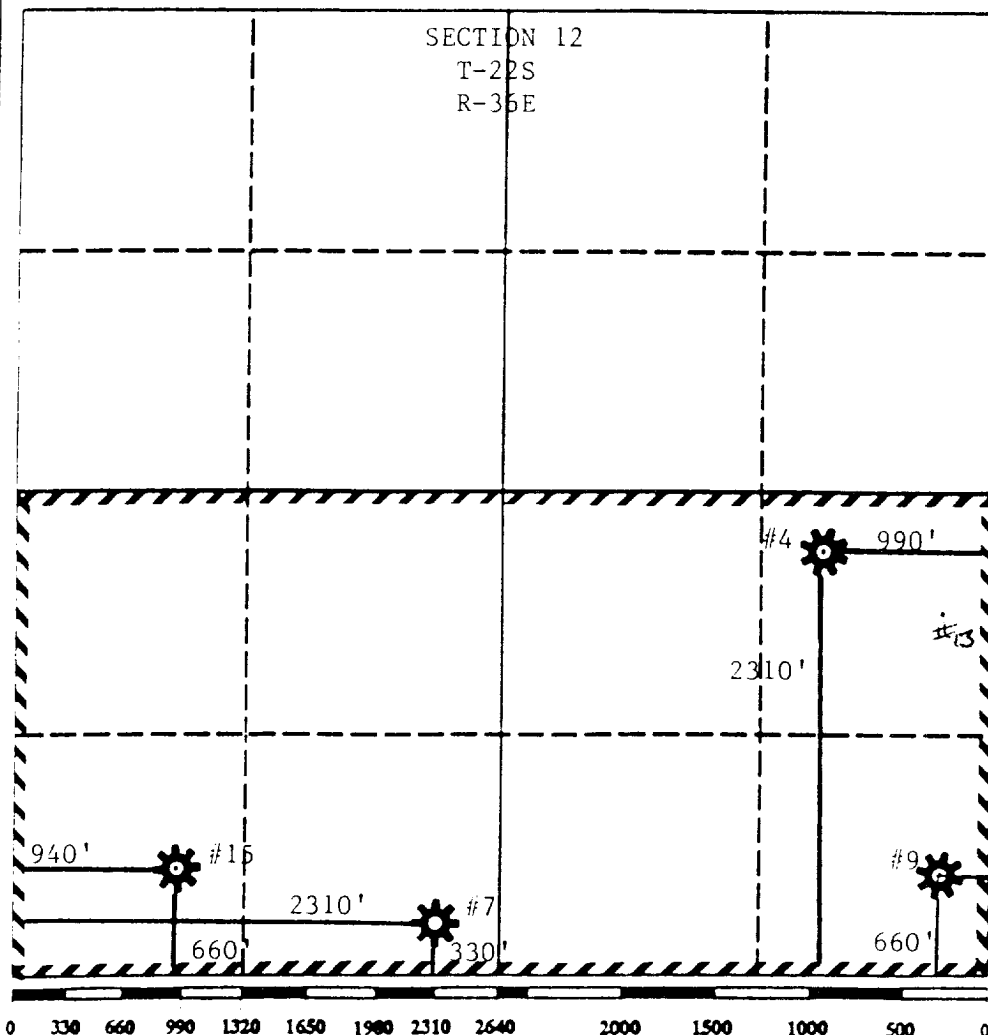

NSL 3190-A(SD) 10, 15, 20

RECEIVED

1967

ROBBS
OFFICE

Submit to Appropriate
District Office
State Leases - 4 copies
Fee Leases - 3 copies

State of New Mexico
Energy, Minerals and Natural Resources Department

Form C-103
Revised 1-1-89

OIL CONSERVATION DIVISION

P.O. Box 2088
Santa Fe, New Mexico 87504-2088

DISTRICT I
P.O. Box 1980, Hobbs, NM 88240

DISTRICT II
P.O. Drawer 00, Artesia, NM 88210

DISTRICT III
1000 Rio Brizos Rd., Aztec, NM 87410

WELL LOCATION AND ACREAGE DEDICATION PLAT

All Distances must be from the outer boundaries of the section

Operator ARCO OIL AND GAS COMPANY			Lease STATE 157-D		Well No. 7
Unit Letter N	Section 12	Township T-22S	Range R-36E	NMFM	County LEA
Actual Footage Location of Well: 330 feet from the SOUTH line and 2310 feet from the WEST line					
Ground level Elev. 3482	Producing Formation YATES/7-RIVERS/QUEEN		Pool EUMONT GAS	Dedicated Acreage 320 Acres	

- Outline the acreage dedicated to the subject well by colored pencil or hatchwork marks on the plat below.
- If more than one lease is dedicated to the well, outline each and identify the ownership thereof (both as to working interest and royalty).
- If more than one lease of different ownership is dedicated to the well, have the interest of all owners been consolidated by communitization, unitization, force-pooling, etc?
☐ Yes ☐ No If answer is "yes" type of consolidation _____
If answer is "no" list the owners and tract descriptions which have actually been consolidated. (Use reverse side of this form if necessary.)
No allowable will be assigned to the well until all interests have been consolidated (by communitization, unitization, force-pooling, or otherwise) or until a non-standard unit, eliminating such interest, has been approved by the Division.

OPERATOR CERTIFICATION

I hereby certify that the information contained herein is true and complete to the best of my knowledge and belief.

EVELYN E. GILSON
Signature

EVELYN E. GILSON

Printed Name
ENGINEERING TECHNICIAN

Position
ARCO OIL AND GAS COMPANY

Company
SEPTEMBER 24, 1992

Date

SURVEYOR CERTIFICATION

I hereby certify that the well location shown on this plat was plotted from field notes of actual surveys made by me or under my supervision, and that the same is true and correct to the best of my knowledge and belief.

Date Surveyed

Signature & Seal of
Professional Surveyor

Certificate No.

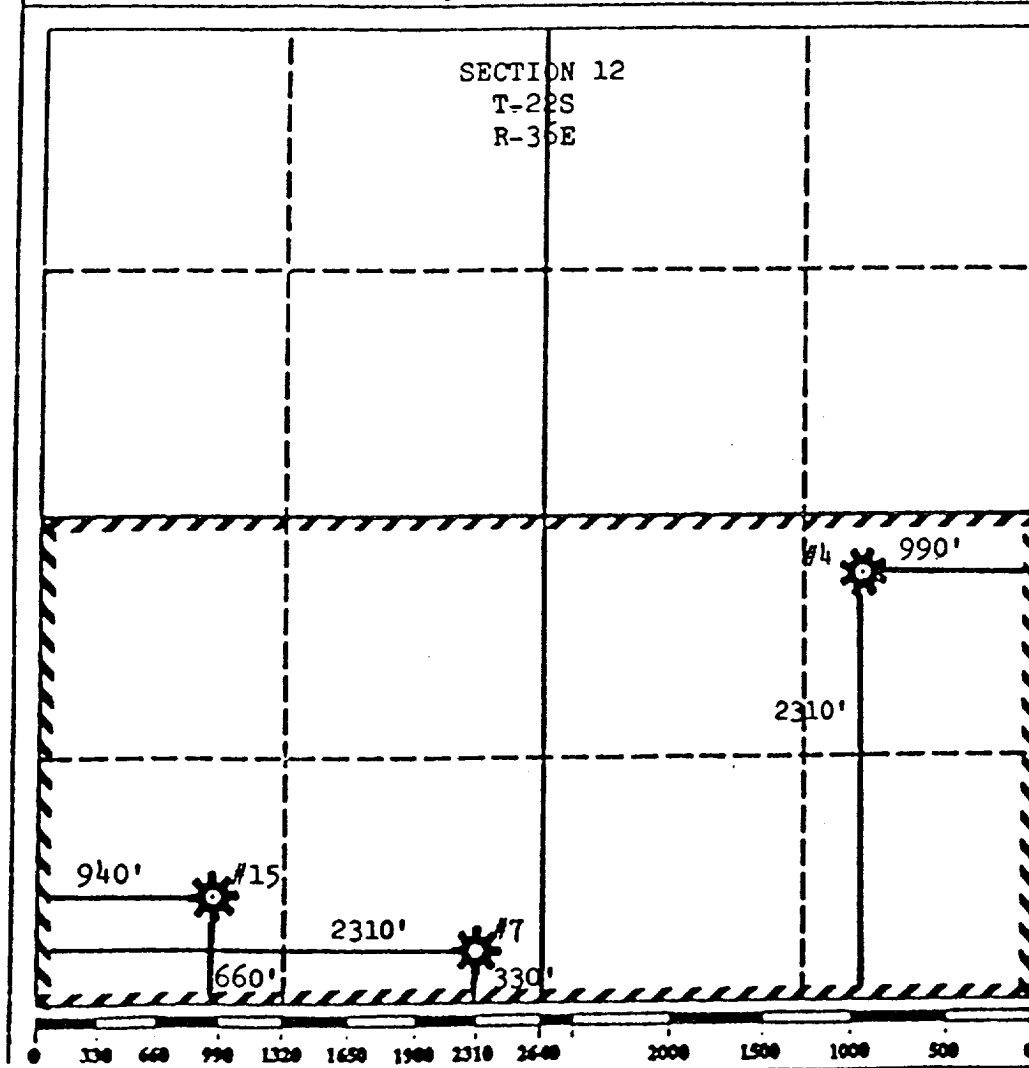

RECEIVED

MAY 25 1993

OCD HOBBS OFFICE

**NEW MEXICO OIL CONSERVATION COMMISSION
WELL LOCATION AND ACREAGE DEDICATION PLAT**

Form O-102
Supersedes O-128
Effective 1-1-65

All distances must be from the outer boundaries of the Section.

Operator Atlantic Richfield Company			Lease State 157 D		Well No. 7
Unit Letter N	Section 12	Township 22S	Range 36E	County Lea	
Actual Footage Location of Well:					
330		feet from the South	line and 2310	feet from the West	line
Ground Level Elev. 3482'	Producing Formation Eumont Queen Gas		Pool Eumont Queen Gas		Dedicated Acreage: 320 Acres

1. Outline the acreage dedicated to the subject well by colored pencil or hachure marks on the plat below.
2. If more than one lease is dedicated to the well, outline each and identify the ownership thereof (both as to working interest and royalty).
3. If more than one lease of different ownership is dedicated to the well, have the interests of all owners been consolidated by communitization, unitization, force-pooling, etc?

☐ Yes ☐ No If answer is "yes," type of consolidation _____

If answer is "no," list the owners and tract descriptions which have actually been consolidated. (Use reverse side of this form if necessary.) _____

No allowable will be assigned to the well until all interests have been consolidated (by communitization, unitization, forced-pooling, or otherwise) or until a non-standard unit, eliminating such interests, has been approved by the Commission.

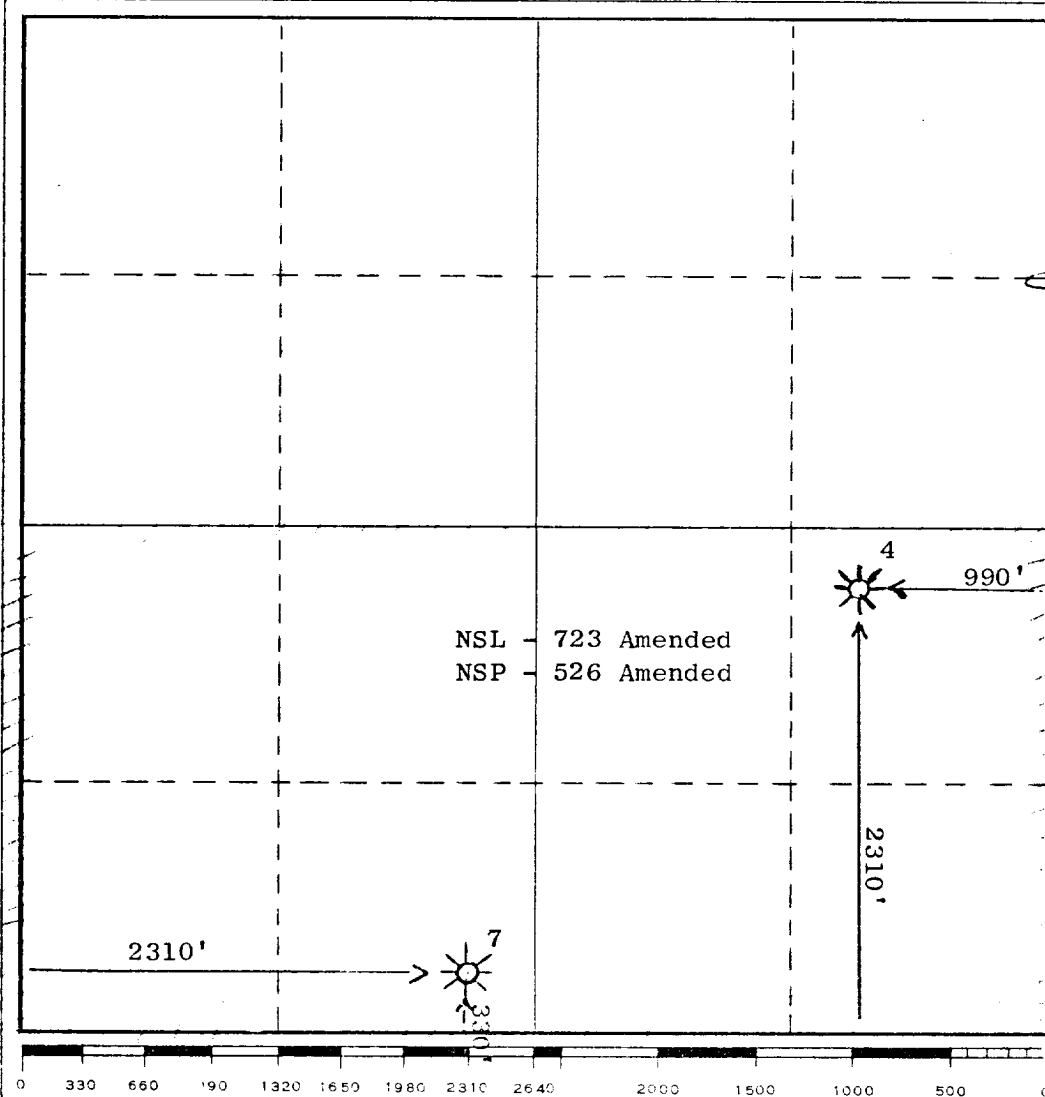

CERTIFICATION

I hereby certify that the information contained herein is true and complete to the best of my knowledge and belief.

Name _____

Position _____

Dist. Drlg. Supv.

Company _____

Atlantic Richfield Company

Date _____

3/31/76

I hereby certify that the well location shown on this plat was plotted from field notes of actual surveys made by me or under my supervision, and that the same is true and correct to the best of my knowledge and belief.

Date Surveyed _____

Registered Professional Engineer
and/or Land Surveyor

Certificate No. _____

NEW MEXICO OIL CONSERVATION COMMISSION
WELL LOCATION AND ACREAGE DEDICATION PLAT

FORM C-128
 Revised 5/1/57

SEE INSTRUCTIONS FOR COMPLETING THIS FORM ON THE REVERSE SIDE

SECTION A

Operator Sinclair Oil & Gas Company			Lease State 157 "D"		1869 OCT 11	Well No. 41
Unit Letter B	Section 12	Township 22 South	Range 36 East	County Lea		
Actual Footage Location of Well: 330 feet from the South line and 2310 feet from the West line						
Ground Level Elev. 3495	Producing Formation Queen		Pool Bumont Gas Pool		Dedicated Acreage: 320 Acres	

1. Is the Operator the only owner in the dedicated acreage outlined on the plat below? YES ☒ NO ____ . ("Owner" means the person who has the right to drill into and to produce from any pool and to appropriate the production either for himself or for himself and another. (65-3-29 (e) N.M.A. 1935 Comp.)
2. If the answer to question one is "no," have the interests of all the owners been consolidated by communization agreement or otherwise? YES ____ NO ____ . If answer is "yes," Type of Consolidation _____
3. If the answer to question two is "no," list all the owners and their respective interests below:

Owner	Land Description

SECTION B

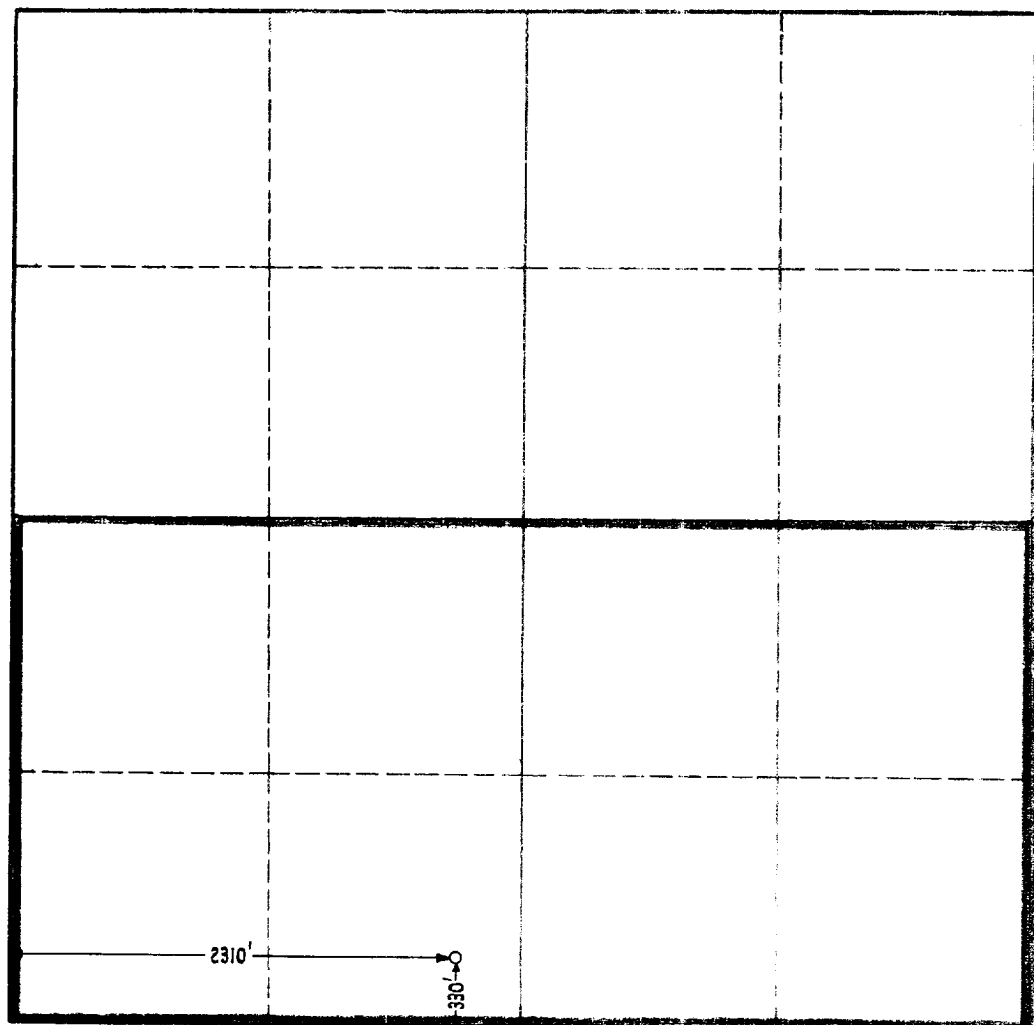

CERTIFICATION

I hereby certify that the information in SECTION A above is true and complete to the best of my knowledge and belief.

Name *D. C. Kettum*
 Position **Div. Clerk Prod. Dept.**
 Company **Sinclair Oil & Gas Company**
 Date **October 7, 1960**

I hereby certify that the well location shown on the plat in SECTION B was plotted from field notes of actual surveys made by me or under my supervision, and that the same is true and correct to the best of my knowledge and belief.

Date Surveyed **11/8/39**
 Registered Professional Engineer and/or Land Surveyor
Glen Staley
 Certificate No. **423**

0 330 660 990 1320 1650 1980 2310 2640 2970 3300 3630 3960 4290 4620 4950 5280 5610 5940 6270 6600

INSTRUCTIONS FOR COMPLETION OF FORM C-128

1. Operator shall furnish and certify to the information called for in Section A.
2. Operator shall outline the dedicated acreage for *both* oil and gas wells on the plat in Section B.
3. A registered professional engineer or land surveyor registered in the State of New Mexico or approved by the Commission shall show on the plat the location of the well and certify this information in the space provided.
4. All distances shown on the plat must be from the outer boundaries of the Section.
5. If additional space is needed for listing owners and their respective interests as required in question 3 of Section A, please use space below.

CSG	8 5/8" at 289' w/150 sx	5 1/2" at 3659' w/250 sx	WELL CLASS: INIT DX FIN DG ELEV L & S
			FORMATION DATUM FORMATION DATUM
			ID 3761' (QUEN) PRG 2635'

CONTR	OPRS ELEV	3482' GL	PD	2700' WO
-------	-----------	----------	----	----------

2-2-18 NM

LEA
ATLANTIC RICHFIELD CO.

Eumont
7 State 157 "D"
Sec 12, T22S, R36E

NM
Page #2

2-5-79 Continued
 Acid (2717-2928') 2000 gals
 Frac (2717-2928') 20,000 gals + 20,000
 gals CO₂
2-10-79 COMPLETION ISSUED

2-2-18 NM
IC 30-025-70032-79

Top Yater @ 2732'

Top H. @ 2977'

Top Green @ 3512'

Part of 3142 - 3540

are in the same 7R
as the other 7R

Just

[illegible]

7531 Advocate Print