

NEW MEXICO OIL CONSERVATION COMMISSION

Well Location and Acreage Dedication Plat

Form C-128
Revised 5/17/57

Section A.

Operator Ohio Oil Co. Lease State McDonald Account No. 42
Well No. 26 Unit letter J Section 13 Township 22 S Range 36 E NMFM
Located 1980 Feet From South Line, 1980' Feet From East Line
County Lea G. L. Elevation 3467.8 Dedicated Acreage 640 Acres
Name of Producing Formation Queen Pool Eumont Gas

1. Is the Operator the only owner* in the dedicated acreage outlined on the plat below?
Yes X No .
2. If the answer to question one is "no," have the interests of all the owners been consolidated by communitization agreement or otherwise? Yes No . If answer is "yes," Type of Consolidation
3. If the answer to question two is "no," list all the owners and their respective interests below:

Owner

Land Description

Section B

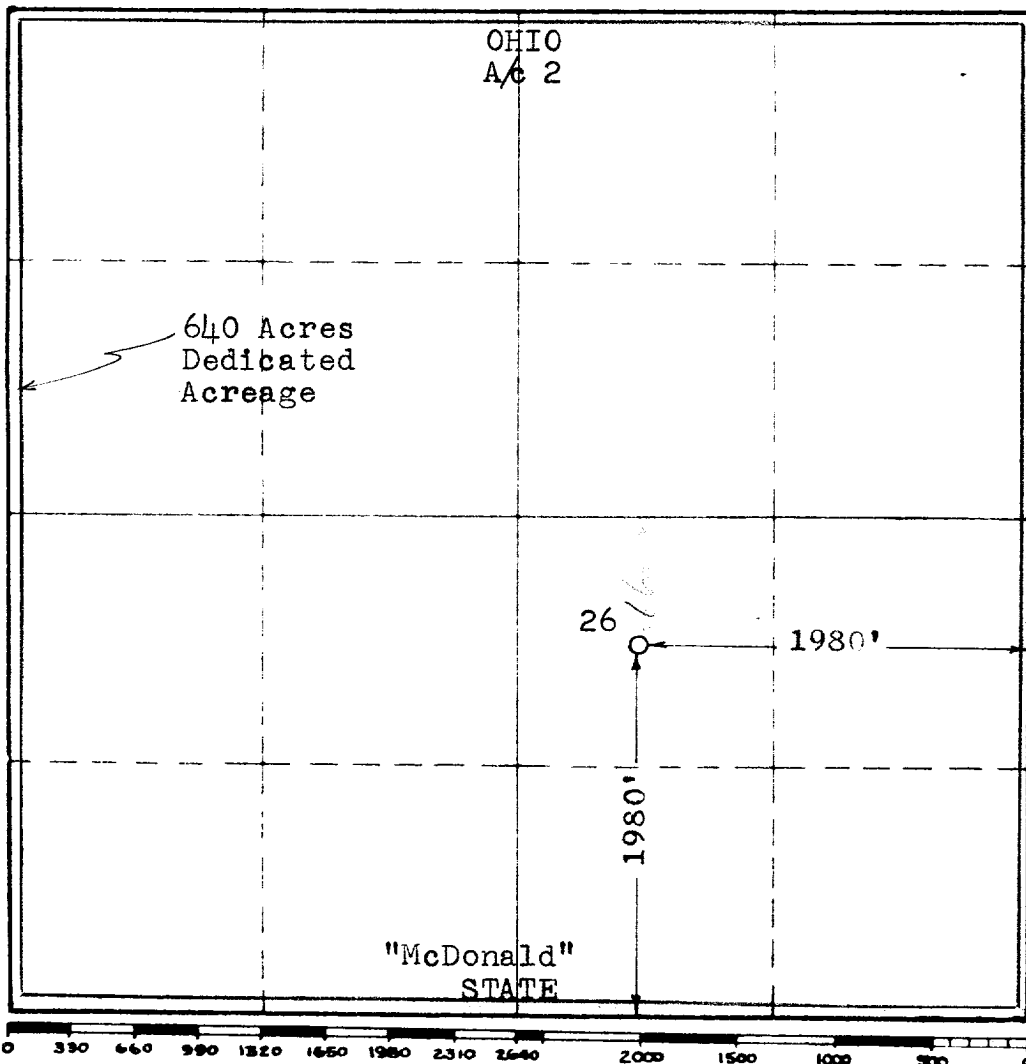

This is to certify that the information in Section A above is true and complete to the best of my knowledge and belief.

The Ohio Oil Company
(Operator)

Thomas D. White
(Representative)

Box 2107, Hobbs, N.M.
Address

This is to certify that the well location shown on the plat in Section B was plotted from field notes of actual surveys made by me or under my supervision and that the same is true and correct to the best of my knowledge and belief.

Date Surveyed 12-2-57

John W. White
Registered Professional
Engineer and/or Land Surveyor.

Certificate No. 676

(See instructions for completing this form on the reverse side)