

UNITED STATES  
DEPARTMENT OF THE INTERIOR  
BUREAU OF LAND MANAGEMENT

FORM APPROVED  
Budget Bureau No. 1004-0135  
Expires: March 31, 1993

**SUNDRY NOTICES AND REPORTS ON WELLS**

Do not use this form for proposals to drill or to deepen or reentry to a different reservoir.  
Use "APPLICATION FOR PERMIT—" for such proposals

**SUBMIT IN TRIPLICATE**

1. Type of Well

☐ Oil Well ☒ Gas Well ☐ Other

2. Name of Operator

CONOCO INC.

3. Address and Telephone No.

10 DESTA DR. STE. 100W, MIDLAND, TX. 79705-4500 (915) 686-5424

4. Location of Well (Footage, Sec., T. R. M. or Survey Description)

Section 19, T-20-S, R-38-E, ~~A~~ B  
330' FNL & 1650' FEL

5. Lease Designation and Serial No.

LC 031670B

6. If Indian, Allottee or Tribe Name

7. If Unit or CA, Agreement Designation

8. Well Name and No.

SEMU Burger B # 72

9. API Well No.

30-0425-12760

10. Field and Pool, or Exploratory Area

11. County or Parish, State

Lea Co., NM

**CHECK APPROPRIATE BOX(S) TO INDICATE NATURE OF NOTICE, REPORT, OR OTHER DATA**

TYPE OF SUBMISSION

- ☒ Notice of Intent  
☐ Subsequent Repon  
☐ Final Abandonment Notice

TYPE OF ACTION

- ☐ Abandonment  
☒ Recompletion  
☐ Plugging Back  
☐ Casing Repair  
☐ Altering Casing  
☐ Other

- ☐ Change of Plans  
☐ New Construction  
☐ Non-Routine Fracrunng  
☐ Water Shut-Off  
☐ Conversion to Injection  
☐ Dispose Water

(Note: Repon results of multiple completion on Well Completion or Recompletion Report and Log form.)

13. Describe Proposed or Completed Operations (Clearly state all pertinent details, and give pertinent dates, including estimated date of starting any proposed work. If well is directionally drilled, give subsurface locations and measured and true vertical depths for all markers and zones pertinent to this work.)\*

Conoco, Inc proposes to Recomplete this well to the Eumont using the following procedure:

1. MIRU Pull production equipment
2. RIH w/RBP and set at 6300' Dump Bail 35' cement on plug Test plug to 500 psig
3. Perf and stimulate 7 rivers interval from 2915-3488'
4. RIH w/production equipment and put on production

\* NSL + NSP Applied for

14. I hereby certify that the foregoing is true and correct

Signed

*Kay Maddox*

Title

Kay Maddox

-Regulatory Agent

Date

December 16, 1999

(This space for Federal or State office use)

Approved by

(ORIG. SGD.) ALEXIS C. SWOBODA

Title

PETROLEUM ENGINEER

Date

DEC 21 1999

Conditions of approval if any:

BLM(6), NMOCD(1), SHEAR, PONCA, COST ASST, FILE ROOM

Title 18 U.S.C. Section 1001, makes it a crime for any person knowingly and willfully to make to any department or agency of the United States any false, fictitious or fraudulent statements or representations as to any matter within its jurisdiction.

\*See Instruction on Reverse Side

District I  
PO Box 1980, Hobbs, NM 88241-1980  
District II  
PO Drawer DD, Artesia, NM 88211-0719  
District III  
1000 Rio Brazos Rd. Aztec, NM 87410  
District IV  
PO Box 2088, Santa Fe, NM 87504-2088

State of New Mexico  
Energy, Minerals & Natural Resources Department

OIL CONSERVATION DIVISION  
PO Box 2088  
Santa Fe, NM 87504-2088

Form C-102

Revised February 21, 1994  
instructions on back

Submit to Appropriate District Office  
State Lease - 4 Copies  
Fee Lease - 3 Copies

☐ AMENDED REPORT

WELL LOCATION AND ACREAGE DEDICATION PLAT

|                            |   |   |
|----------------------------|---|---|
| API Number<br>30-025-12760 | 2 Pool Code<br>76480  | 3 Pool Name<br>Eumont Yates Seven Rvrs Qn |
| 4 Property Code<br>3078    | 5 Property Name<br>SEMU Burger B  | 6 Well Number<br># 72                     |
| 7 OGRID No.<br>005073      | 8 Operator Name<br>Conoco Inc., 10 Desta Drive, Ste. 100W, Midland, TX 79705-4500 | 9 Elevation<br>3550'                      |

10 Surface Location

|                    |               |                 |              |         |                       |                           |                        |                        |               |
|--------------------|---------------|-----------------|--------------|---------|-----------------------|---------------------------|------------------------|------------------------|---------------|
| UL or lot no.<br>B | Section<br>19 | Township<br>20S | Range<br>38E | Lot Idn | Feet from the<br>330' | North/South line<br>North | Feet from the<br>1650' | East/West line<br>East | County<br>Lea |
|--------------------|---------------|-----------------|--------------|---------|-----------------------|---------------------------|------------------------|------------------------|---------------|

11 Bottom Hole Location If Different From Surface

|                           |                    |                       |              |         |               |                  |               |                |        |
|---------------------------|--------------------|-----------------------|--------------|---------|---------------|------------------|---------------|----------------|--------|
| UL or lot no.             | Section            | Township              | Range        | Lot Idn | Feet from the | North/South line | Feet from the | East/West line | County |
| 12 Dedicated Acres<br>440 | 13 Joint or Infill | 14 Consolidation Code | 15 Order No. |         |               |                  |               |                |        |

NO ALLOWABLE WILL BE ASSIGNED TO THIS COMPLETION UNTIL ALL INTERESTS HAVE BEEN CONSOLIDATED  
OR A NON-STANDARD UNIT HAS BEEN APPROVED BY THE DIVISION

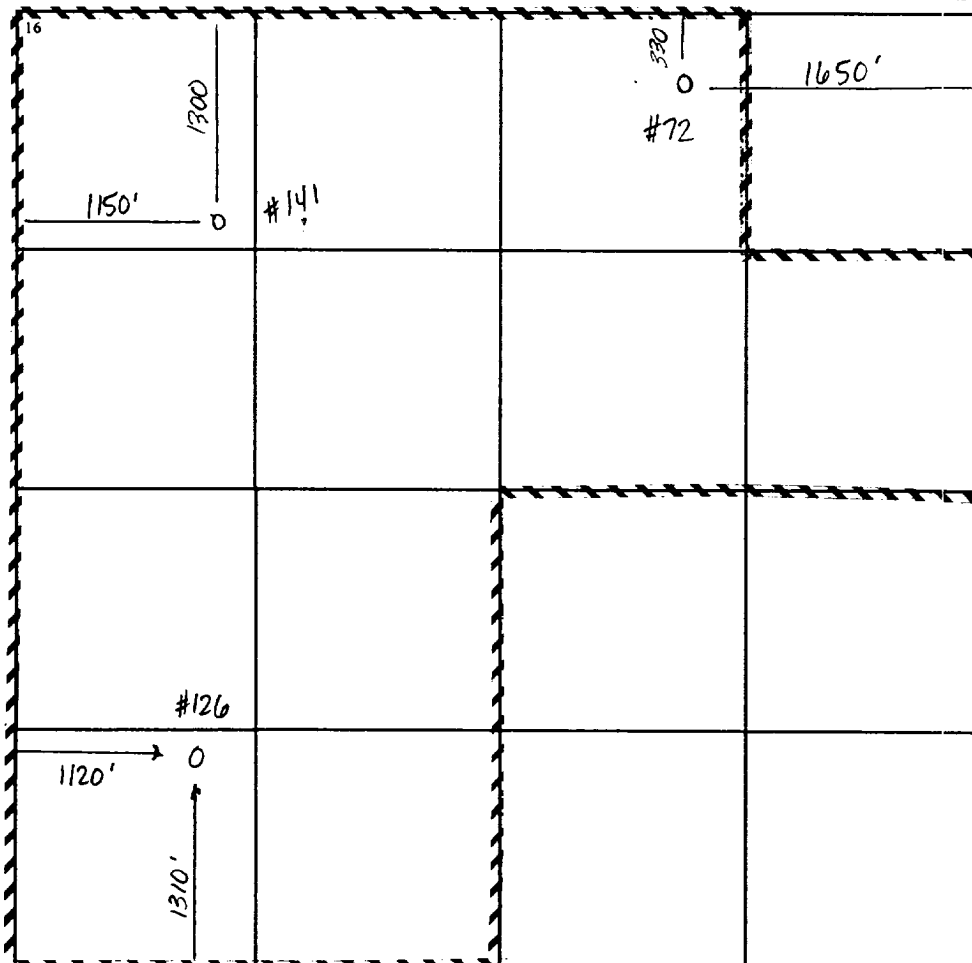

17 OPERATOR CERTIFICATION

I hereby certify that the information contained herein is true and complete to the best of my knowledge and belief

*Kay Maddox*  
Signature

Kay Maddox

Printed Name

Regulatory Agent

Title

December 15, 1999

Date

18 SURVEYOR CERTIFICATION

I hereby certify that the well location shown on this plat was plotted from field notes of actual surveys made by me or under my supervision, and that the same is true and correct to the best of my belief.

Date of Survey

Signature and Seal of Professional Surveyor:

Certificate Number