

MAR 5 1963

(SUBMIT IN TRIPLICATE)

Land Office Las Cruces
Lease No. LC 031620 b
Unit Lease

X		

E. W. STANDLEY
DISTRICT ENGINEERUNITED STATES
DEPARTMENT OF THE INTERIOR
GEOLOGICAL SURVEY

MAR 5 1963

SUNDRY NOTICES AND REPORTS ON WELLS

NOTICE OF INTENTION TO DRILL	X	SUBSEQUENT REPORT OF WATER SHUT-OFF	
NOTICE OF INTENTION TO CHANGE PLANS		SUBSEQUENT REPORT OF SHOOTING OR ACIDIZING	
NOTICE OF INTENTION TO TEST WATER SHUT-OFF		SUBSEQUENT REPORT OF ALTERING CASING	
NOTICE OF INTENTION TO RE-DRILL OR REPAIR WELL		SUBSEQUENT REPORT OF RE-DRILLING OR REPAIR	
NOTICE OF INTENTION TO SHOOT OR ACIDIZE		SUBSEQUENT REPORT OF ABANDONMENT	
NOTICE OF INTENTION TO PULL OR ALTER CASING		SUPPLEMENTARY WELL HISTORY	
NOTICE OF INTENTION TO ABANDON WELL			

(INDICATE ABOVE BY CHECK MARK NATURE OF REPORT, NOTICE, OR OTHER DATA)

Skaggs B-12

February 27, 1963

Well No. 5 is located 990 ft. from N line and 1700 ft. from W line of sec. 12

<u>NE/4</u>	<u>NE/4</u>	<u>Sec. 12</u>	<u>20-S</u>	<u>37-E</u>	<u>NMPN</u>
(1/4 Sec. and Sec. No.)			(Twp.)	(Range)	(Meridian)

<u>NMPN</u>	<u>Lea</u>	<u>New Mexico</u>
(Field)	(County or Subdivision)	(State or Territory)

The elevation of the derrick floor above sea level is _____ ft.

DETAILS OF WORK

(State names of and expected depths to objective sands; show sizes, weights, and lengths of proposed casings; indicate mudding jobs, cementing points, and all other important proposed work)

It is intended to drill with rotary tools at the above location to an approximate total depth of 6900'. Plans call for triple completing in the Glorieta, Elinebry and Brinkard formations. Casing will be set in accordance with USGS regulations and other special requirements will be complied with.

The following casing pattern is planned: 5 5/8" OD 36# H-40 casing set at 1250' with 350 sacks cement, cement to circulate; 7" OD 20# and 23# J-55 and N-60 casing set at 6900' with 540 sacks cement, cement to return to 2400'.

Permission to produce this well upon completion is also requested.

I understand that this plan of work must receive approval in writing by the Geological Survey before operations may be commenced.

Company Continental Oil CompanyAddress Box 68Emine, New MexicoBy Stanley W. Standley

USGS-5 N/5 plats	USGS-2 N/2 plats	Title	<u>District Superintendent</u>
WAM WAR w/plat	Pan Am. Hbs-3	Atl, Hbs-2	
Calif, Hous, Mid - 1 each			

NEW MEXICO OIL CONSERVATION COMMISSION
WELL LOCATION AND ACREAGE DEDICATION PLAT

FORM C-128
Revised 5/1/57

SEE INSTRUCTIONS FOR COMPLETING THIS FORM ON THE REVERSE SIDE

SECTION A

Operator CONTINENTAL OIL CO.		Lease MAY 12 AM 8:22 SKAGGS B-12		Well No. 5
Unit Letter C	Section 12	Township 20 SOUTH	Range 37 EAST	County LEA
Actual Footage Location of Well: 990 feet from the NORTH line and 1700 feet from the WEST line				
Ground Level Elev.	Producing Formation Blinobry & Drinkard	Pool Skaggs Glorieta, Skaggs Drinkard & Rast Woir Blinobry	Dedicated Acreage: 40 Acres	

1. Is the Operator the only owner in the dedicated acreage outlined on the plat below? YES ☒ NO ☐ ("Owner" means the person who has the right to drill into and to produce from any pool and to appropriate the production either for himself or for himself and another. (65-3-29 (e) NMSA 1935 Comp.)
2. If the answer to question one is "no," have the interests of all the owners been consolidated by communitization agreement or otherwise? YES ☐ NO ☐ If answer is "yes," Type of Consolidation _____
3. If the answer to question two is "no," list all the owners and their respective interests below:

Owner	Land Description

SECTION B

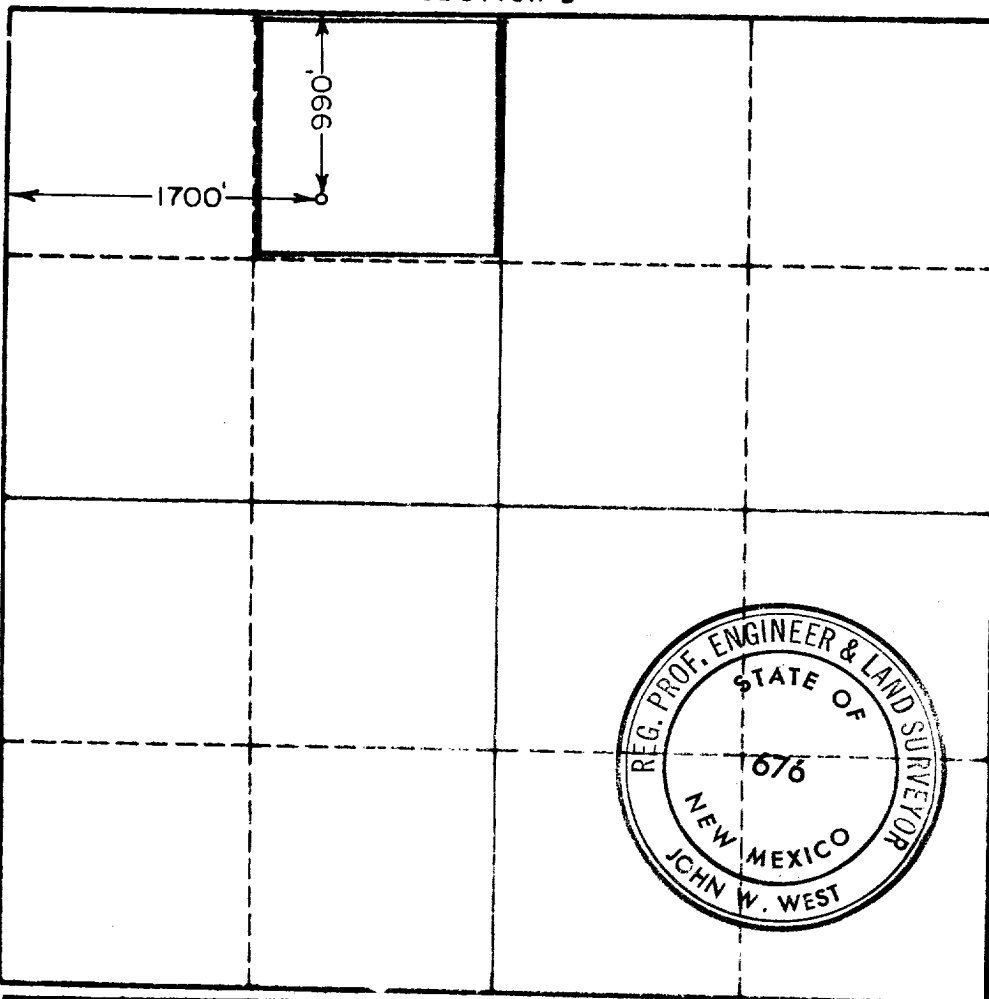

CERTIFICATION

I hereby certify that the information in SECTION A above is true and complete to the best of my knowledge and belief.

Name
Signed: J. R. PARKER
Position
District Superintendent
Company
Continental Oil Company
Date
2-26-63

I hereby certify that the well location shown on the plat in SECTION B was plotted from field notes of actual surveys made by me or under my supervision, and that the same is true and correct to the best of my knowledge and belief.

Date Surveyed
2-27-63
Registered Professional Engineer and/or Land Surveyor, JOHN W. WEST
Certificate No.
N. M. - P. E. & L. S. NO. 676

0 330 660 990 1320 1650 1980 2310 2640 2000 1500 1000 500 0