

(SUBMIT IN TRIPLICATE)

UNITED STATES  
DEPARTMENT OF THE INTERIOR  
GEOLOGICAL SURVEY

Land Office **Las Cruces**  
Lease No. **LC 032621 b**  
Unit **Lease**

|  |  |          |
|--|--|----------|
|  |  | <b>X</b> |
|  |  |          |
|  |  |          |

1953 JUL 22 AM 8:11

SUNDRY NOTICES AND REPORTS ON WELLS

|  |          |  |
|--|----------|--|
| NOTICE OF INTENTION TO DRILL                   | <b>X</b> | SUBSEQUENT REPORT OF WATER SHUT-OFF        |
| NOTICE OF INTENTION TO CHANGE PLANS            |          | SUBSEQUENT REPORT OF SHOOTING OR ACIDIZING |
| NOTICE OF INTENTION TO TEST WATER SHUT-OFF     |          | SUBSEQUENT REPORT OF ALTERING CASING       |
| NOTICE OF INTENTION TO RE-DRILL OR REPAIR WELL |          | SUBSEQUENT REPORT OF RE-DRILLING OR REPAIR |
| NOTICE OF INTENTION TO SHOOT OR ACIDIZE        |          | SUBSEQUENT REPORT OF ABANDONMENT           |
| NOTICE OF INTENTION TO PULL OR ALTER CASING    |          | SUPPLEMENTARY WELL HISTORY                 |
| NOTICE OF INTENTION TO ABANDON WELL            |          |  |

(INDICATE ABOVE BY CHECK MARK NATURE OF REPORT, NOTICE, OR OTHER DATA)

**Britt B** **July 18**, 19**63**

Well No. **19** is located **660** ft. from **[N]** line and **1980** ft. from **[E]** line of sec. **15**

**NW/4 NE/4 Sec. 15** **20E** **37E** **NMPN**  
(1/4 Sec. and Sec. No.) (Twp.) (Range) (Meridian)  
**NMPU** **Lea** **New Mexico**  
(Field) (County or Subdivision) (State or Territory)

The elevation of the derrick floor above sea level is \_\_\_\_\_ ft.

DETAILS OF WORK

(State names of and expected depths to objective sands; show sizes, weights, and lengths of proposed casings; indicate mudding jobs, cementing points, and all other important proposed work)

It is intended to drill a well with rotary tools at the above location to an approximate TD of 6650'. Plans call for dual completing in the Weir Blinberry & Monument Tubb formations. Casing will be set in accordance with USGS regulations and other special requirements will be complied with.

The following casing pattern is planned: 8-5/8" OD 24 # J-55 casing set at 1320' with 500 sacks cement, cement to circulate; 5-1/2" OD 14# & 15.5# J-55 casing set at 6650' with 475 sacks cement, cement to return to 2300'.

Permission to produce this well upon completion is also requested.

I understand that this plan of work must receive approval in writing by the Geological Survey before operations may be commenced.

Company **Continental Oil Company**

Address **Box 68, Dunice, N.M.**

USGS-5 w/5 plats NMGS-2 w/2 plats  
AEE HER w/plat File Pan Am-Sub-3  
Atl-Ros--2 Calif-Mous, Mid-1 each

By \_\_\_\_\_  
Title **District Superintendent**

**NEW MEXICO OIL CONSERVATION COMMISSION**  
**WELL LOCATION AND ACREAGE DEDICATION PLAT**

FORM C-128  
 Revised 5/1/57

SEE INSTRUCTIONS FOR COMPLETING THIS FORM ON THE REVERSE SIDE

**SECTION A**

JUL 22 AM 8:11

|   |   |                             |  |                                       |
|---|---|-----------------------------|--|---------------------------------------|
| Operator<br><b>CONTINENTAL OIL CO.</b>  |   | Lease<br><b>BRITT "B"</b>   |  | Well No.<br><b>19</b>                 |
| Unit Letter<br><b>B</b>   | Section<br><b>15</b>                              | Township<br><b>20 SOUTH</b> | Range<br><b>37 EAST</b>                          | County<br><b>LEA</b>                  |
| Actual Footage Location of Well:<br><b>660</b> feet from the <b>NORTH</b> line and <b>1980</b> feet from the <b>EAST</b> line |   |                             |  |                                       |
| Ground Level Elev.  | Producing Formation<br><b>Tubb &amp; Blinebry</b> |                             | Pool<br><b>Monument Tubb &amp; Weir Blinebry</b> | Dedicated Acreage:<br><b>40</b> Acres |

1. Is the Operator the only owner in the dedicated acreage outlined on the plat below? YES ☒ NO \_\_\_\_ . ("Owner" means the person who has the right to drill into and to produce from any pool and to appropriate the production either for himself or for himself and another. (65-3-29 (e) NMSA 1935 Comp.)
2. If the answer to question one is "no," have the interests of all the owners been consolidated by communitization agreement or otherwise? YES \_\_\_\_ NO \_\_\_\_ . If answer is "yes," Type of Consolidation \_\_\_\_
3. If the answer to question two is "no," list all the owners and their respective interests below:

| Owner | Land Description |
|-------|------------------|
|       |                  |
|       |                  |

**SECTION B**

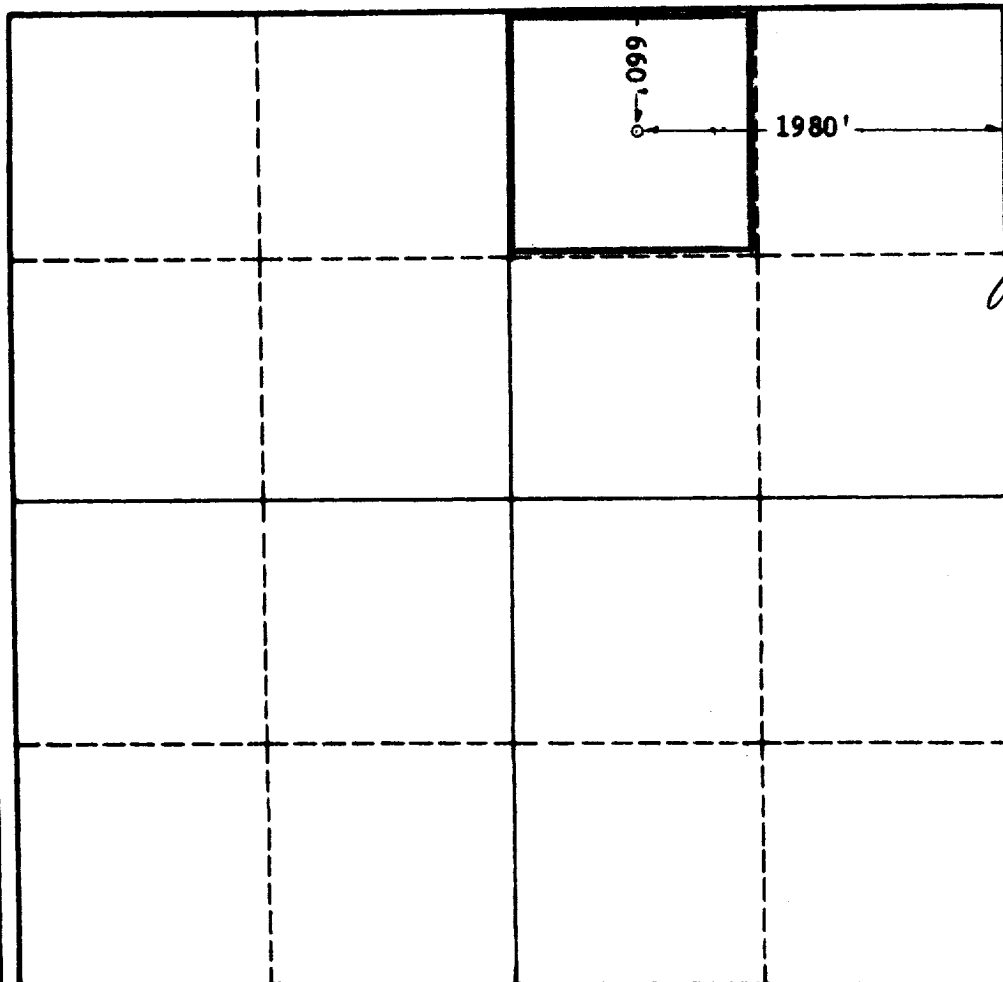

**CERTIFICATION**

I hereby certify that the information in SECTION A above is true and complete to the best of my knowledge and belief.

Name  
**Robert Gault III**

Position  
**District Superintendent**

Company  
**Continental Oil Company**

Date  
**7-19-63**

I hereby certify that the well location shown on the plat in SECTION B was plotted from field notes of actual surveys made by me or under my supervision, and that the same is true and correct to the best of my knowledge and belief.

|  |
|--|
| Date Surveyed<br><b>7-18-63</b>  |
| Registered Professional Engineer and/or Land Surveyor, <b>JOHN W. WEST</b> |
| Certificate No. <b>N.M. - P.E. &amp; L.S. NO. 670</b>                      |

0 330 660 990 1320 1650 1980 2310 2640 2000 1600 1200 800 400