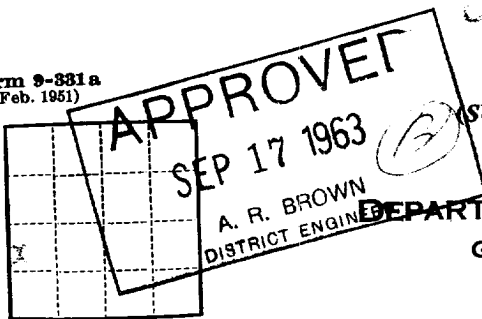

Land Office Las Cruces
Lease No. 031621 b
Unit 1

SUBMIT IN TRIPLICATE

UNITED STATES
DEPARTMENT OF THE INTERIOR
GEOLOGICAL SURVEY

SUNDRY NOTICES AND REPORTS ON WELLS

NOTICE OF INTENTION TO DRILL	<input checked="" type="checkbox"/>	SUBSEQUENT REPORT OF WATER SHUT-OFF	
NOTICE OF INTENTION TO CHANGE PLANS		SUBSEQUENT REPORT OF SHOOTING OR ACIDIZING	
NOTICE OF INTENTION TO TEST WATER SHUT-OFF		SUBSEQUENT REPORT OF ALTERING CASING	
NOTICE OF INTENTION TO RE-DRILL OR REPAIR WELL		SUBSEQUENT REPORT OF RE-DRILLING OR REPAIR	
NOTICE OF INTENTION TO SHOOT OR ACIDIZE		SUBSEQUENT REPORT OF ABANDONMENT	
NOTICE OF INTENTION TO PULL OR ALTER CASING		SUPPLEMENTARY WELL HISTORY	
NOTICE OF INTENTION TO ABANDON WELL			

(INDICATE ABOVE BY CHECK MARK NATURE OF REPORT, NOTICE, OR OTHER DATA)

September 16, 1963

Well No. Britt 20 is located 1880 ft. from N line and 330 ft. from E line of sec. 10

N 1/4 10 10 37-2 106° 15'
 (1/4 Sec. and Sec. No.) (Twp.) (Range) (Meridian)
Lea New Mexico
 (Field) (County or Subdivision) (State or Territory)

The elevation of the derrick floor above sea level is _____ ft.

DETAILS OF WORK

(State names of and expected depths to objective sands; show sizes, weights, and lengths of proposed casings; indicate mudlogging jobs, cementing points, and all other important proposed work)

It is our intention to drill a well at the above location to a depth of approximately 6650' with rotary tools in order to develop Tubbs & Blinberry oil reserves on this lease. All casing points will be cemented in accordance with approved methods of the G.S. and any special requirements will be followed.

It is planned to use the following casing pattern: 5 1/2" 14.55 surface string to be set at 1200' and cemented w/500 ex. cnt. Cement calculated to circulate. 5 1/2" 14.55 5 1/2" 15.55 5-55 production string to be set at 6650' and cemented w/475 ex. cnt. Cement is calculated to return to 2300'.

Approval to produce this well upon completion is also requested.

I understand that this plan of work must receive approval in writing by the Geological Survey before operations may be commenced.

Company Continental Oil CompanyAddress P.O. Box 52Alameda, New MexicoBy SIGNEE RE, JR.Title Alternate for
District Superintendent

10-5 14-5 14-5 14-5 14-5 14-5 14-5 14-5 14-5 14-5
 File; run in hole; 14-5 14-5 14-5 14-5 14-5 14-5 14-5 14-5 14-5 14-5
 Hole, 14-5 14-5.

**NEW MEXICO OIL CONSERVATION COMMISSION
WELL LOCATION AND ACREAGE DEDICATION PLAT**

FORM C-128
Revised 3/1/57

SEE INSTRUCTIONS FOR COMPLETING THIS FORM ON THE REVERSE SIDE

SECTION 17 PM 4:40

Operator CONTINENTAL OIL CO.			Lease BRITT "B"		Well No. 20
Unit Letter L	Section 10	Township 20 SOUTH	Range 37 EAST	County LEA	
Actual Footage Location of Well: 1880 feet from the SOUTH line and 330 feet from the WEST line					
Ground Level Elev.	Producing Formation Tub # Blinberry		Pool Name Blinberry		Dedicated Acreage: 40 Acres

1. Is the Operator the only owner in the dedicated acreage outlined on the plat below? YES ☒ NO ☐ ("Owner" means the person who has the right to drill into and to produce from any pool and to appropriate the production either for himself or for himself and another. (65-3-29 (a) NMSA 1935 Comp.)
2. If the answer to question one is "no," have the interests of all the owners been consolidated by communitization agreement or otherwise? YES ☐ NO ☐ If answer is "yes," Type of Consolidation _____
3. If the answer to question two is "no," list all the owners and their respective interests below:

Owner	Lead Description

SECTION B

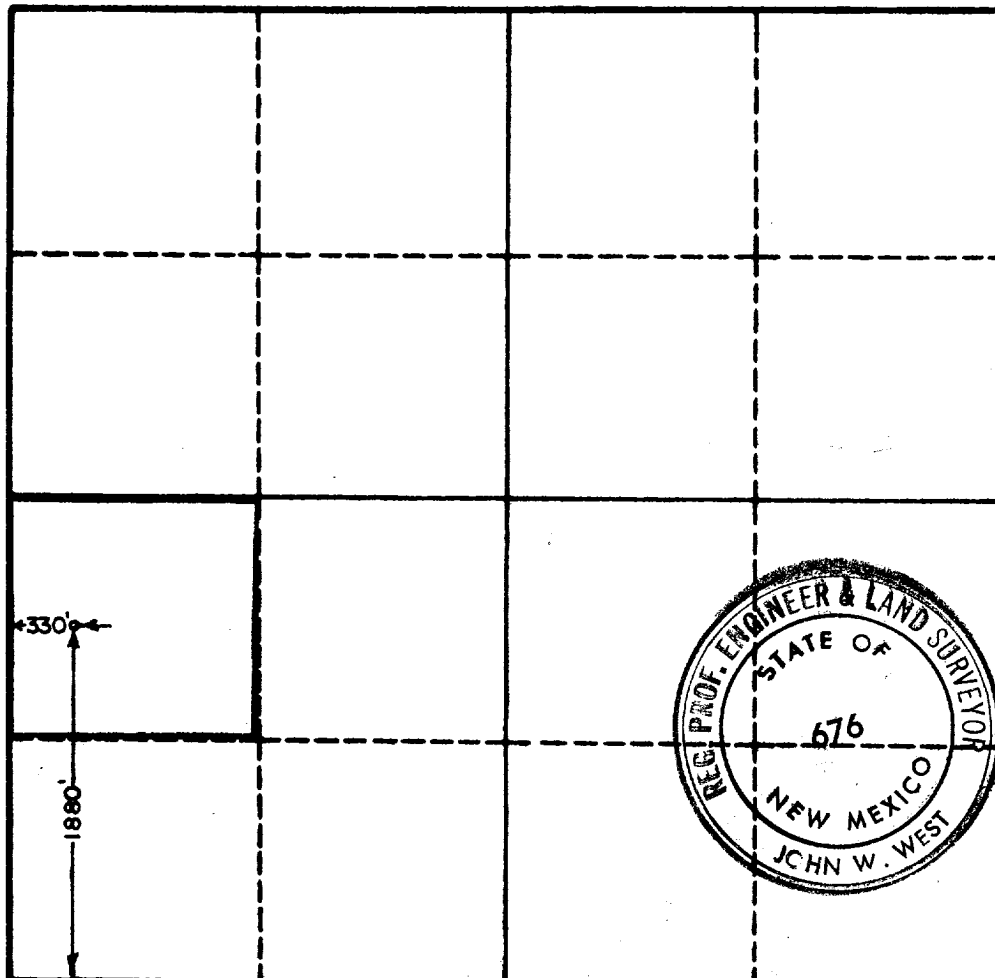

CERTIFICATION

I hereby certify that the information in SECTION A above is true and complete to the best of my knowledge and belief.

Name
SIGNED: **JOHN W. WOLFE, JR.**

Position **Assistant for District Superintendent**

Company
Continental Oil Company

Date
September 16, 1963

WOLFE, JR., DISTRICT SUPERINTENDENT

I hereby certify that the well location shown on the plat in SECTION B was plotted from field notes of actual surveys made by me or under my supervision, and that the same is true and correct to the best of my knowledge and belief.

Date Surveyed
9-13-63

Registered Professional Engineer and/or Land Surveyor, **JOHN W. WEST**

John W. West

Certificate No.
N. M. - P. E. & L. S. NO. 676

ILLEGIBLE