

NEW MEXICO OIL CONSERVATION COMMISSION
SANTA FE, NEW MEXICO
APPLICATION FOR MULTIPLE COMPLETION

Form C-107
5-1-61

Operator TEXACO Inc.		County Lea		Date January 22, 1965
Address Box 728, Hobbs, New Mexico		Lease M. B. Weir "B"		Well No. 10
Location of Well P	Unit 12	Section 20 South	Range 37 East	

1. Has the New Mexico Oil Conservation Commission heretofore authorized the multiple completion of a well in these same pools or in the same zones within one mile of the subject well? YES _____ NO X (zones are common in two wells)
2. If answer is yes, identify one such instance: Order No. *; Operator Lease, and Well No.:
* A-2392, TEXACO Inc. M. B. Weir "B" Well No. 7, Tubb and Drinkard
* MC-1554, TEXACO Inc. M. B. Weir "B" Well No. 9, Blinebry and Drinkard

3. The following facts are submitted:	Upper Zone	Intermediate Zone	Lower Zone
a. Name of Pool and Formation	East Weir Blinebry	Weir Tubb	Skaggs Drinkard
b. Top and Bottom of Pay Section (Perforations)	Est. 5810'-5870'	Est. 6420'-6490'	6840'-6860'
c. Type of production (Oil or Gas)	Oil	Oil	Oil
d. Method of Production (Flowing or Artificial Lift)	Flow	Flow	Flow

4. The following are attached. (Please check YES or NO)

Yes	No	
<input checked="" type="checkbox"/>	<input type="checkbox"/>	a. Diagrammatic Sketch of the Multiple Completion, showing all casing strings, including diameters and setting depths, centralizers and/or turbolizers and location thereof, quantities used and top of cement, perforated intervals, tubing strings, including diameters and setting depth, location and type of packers and side door chokes, and such other information as may be pertinent.
<input checked="" type="checkbox"/>	<input type="checkbox"/>	b. Plat showing the location of all wells on applicant's lease, all offset wells on offset leases, and the names and addresses of operators of all leases offsetting applicant's lease.
<input checked="" type="checkbox"/>	<input type="checkbox"/>	c. Waivers consenting to such multiple completion from each offset operator, or in lieu thereof, evidence that said offset operators have been furnished copies of the application.*
<input type="checkbox"/>	<input checked="" type="checkbox"/>	d. Electrical log of the well or other acceptable log with tops and bottoms of producing zones and intervals of perforation indicated thereon. (If such log is not available at the time application is filed it shall be submitted as provided by Rule 112-A.)

5. List all offset operators to the lease on which this well is located together with their correct mailing address.

Continental Oil Company, Box 460, Hobbs, New Mexico

Hisson Drilling Company, 901 W. Missouri, Midland, Texas

6. Were all operators listed in Item 5 above notified and furnished a copy of this application? YES X NO _____. If answer is yes, give date of such notification **January 22, 1965 (by registered mail)**

CERTIFICATE: I, the undersigned, state that I am the **Assist. Dist. Supt.** of **TEXACO Inc.** (company), and that I am authorized by said company to make this report; and that this report was prepared under my supervision and direction and that the facts stated therein are true, correct and complete to the best of my knowledge.

H. D. Raymond

Signature

*Should waivers from all offset operators not accompany an application for administrative approval, the New Mexico Oil Conservation Commission will hold the application for a period of twenty (20) days from date of receipt by the Commission's Santa Fe office. If, after said twenty-day period, no protest nor request for hearing is received by the Santa Fe office, the application will then be processed.

NOTE: If the proposed multiple completion will result in an unorthodox well location and/or a non-standard proration unit in one or more of the producing zones, then separate application for approval of the same should be filed simultaneously with this application.

DIAGRAMMATIC SKETCH OF TRIPLE TUBINGLESS COMPLETION

NOTE: 2-7/8" casing to be cemented with 500 sacks Class "C", 8% gel, cement and 500 sacks Class "C", 4% gel, cement. Cement volume equals 165% of calculated annular volume from T.D. to base of salt at 2540'.

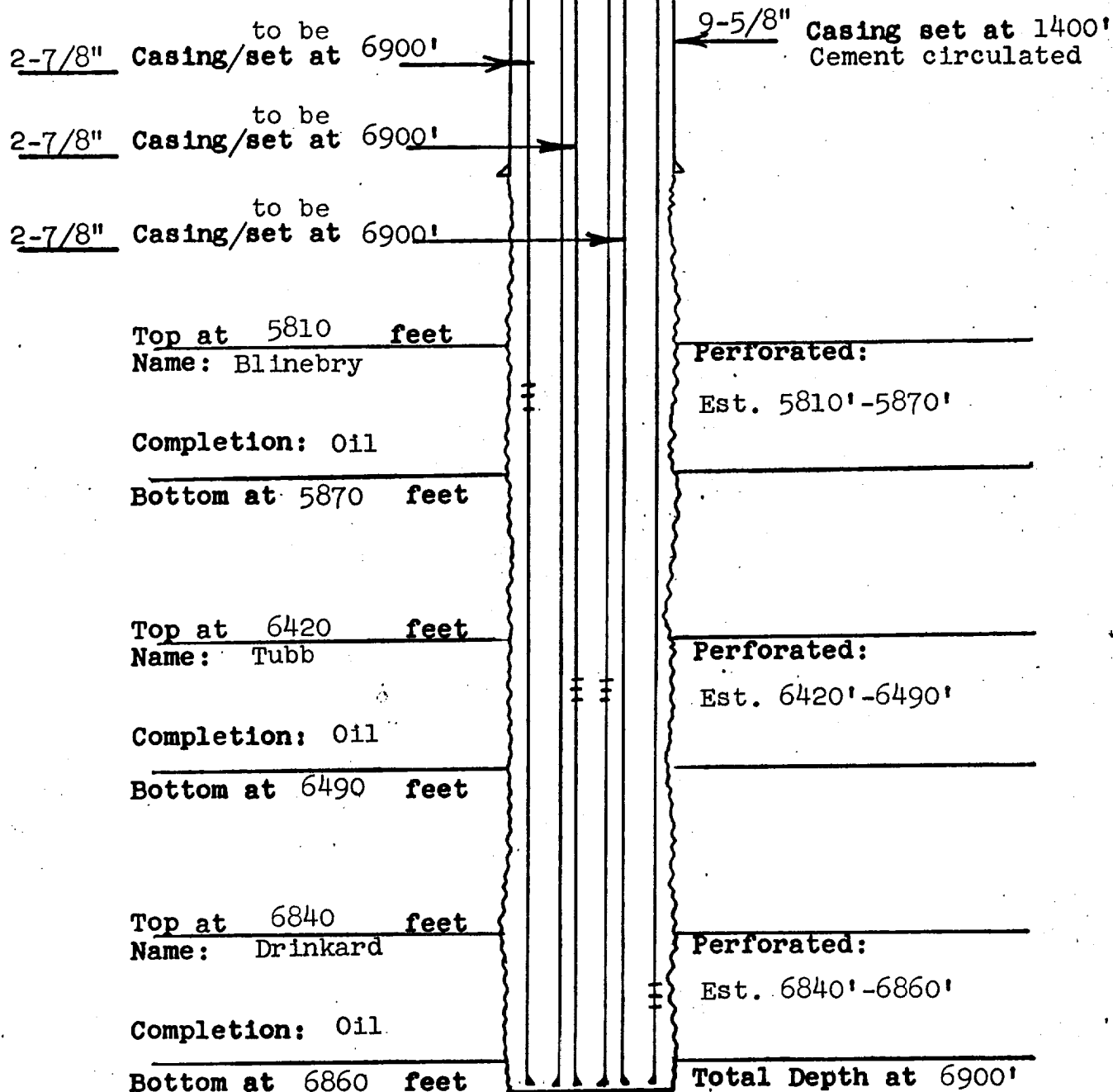

TEXACO Inc.

Lease: M.B. Weir "B" Well No. 10
Field: Skaggs Drinkard, Weir Tubb, East Weir Blinebry
Date: January 22, 1965

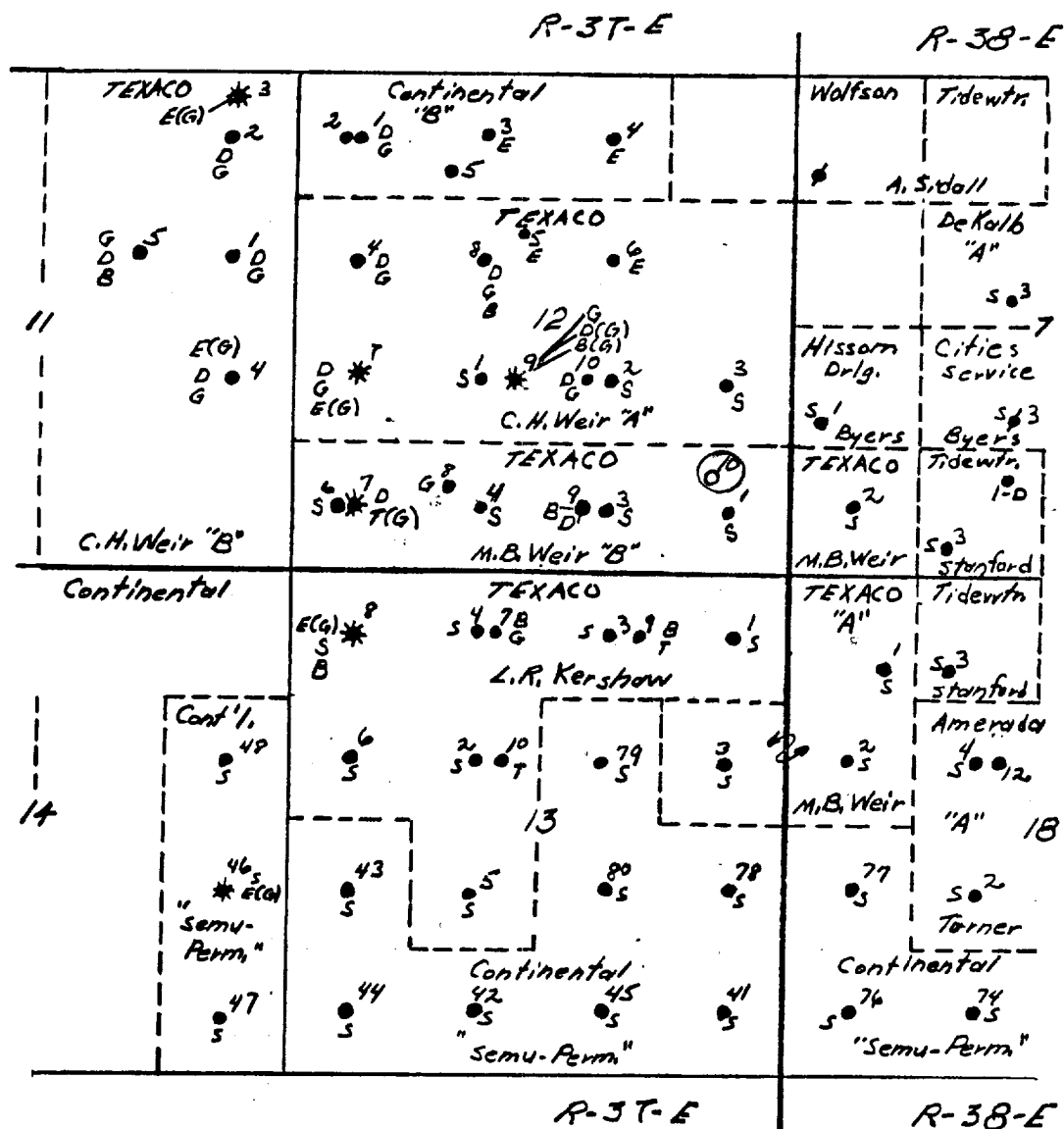

TEXACO Inc.
M. B. Weir "B" Lease
Lea County, New Mexico

Scale: 1" = 2000'

LEGEND

S - Skaggs (Grayburg)
D - Drinkard (Oil)
D(G) - Drinkard Gas
E - Eumont (Oil)
E(G) - Eumont Gas
B - Blinebry (Oil)
B(G) - Blinebry Gas
G - Glorieta
T - Tubb (Oil)
T(G) - Tubb Gas

OFFSET OPERATORS

Continental Oil Co.-Box 460-Hobbs, New Mexico
Hissom Drilling Co.-401 W. Missouri-Midland, Texas

LAND OFFICE		
TRANSPORTER	OIL	
	GAS	
PROBATION OFFICE		
OPERATOR		

NEW MEXICO OIL CONSERVATION COMMISSION

Santa Fe, New Mexico

Form C-101
Revised 12/1/55

NOTICE OF INTENTION TO DRILL

Notice must be given to the District Office of the Oil Conservation Commission and approval obtained before drilling or recompletion begins. If changes in the proposed plan are considered advisable, a copy of this notice showing such changes will be returned to the sender. Submit this notice in QUINTUPLICATE. One copy will be returned following approval. See additional instructions in Rules and Regulations of the Commission. If State Land submit 6 Copies. Attach Form C-128 in triplicate to first 3 copies of Form C-101.

Midland, Texas

December 11, 1964

(Place)

(Date)

OIL CONSERVATION COMMISSION
SANTA FE, NEW MEXICO

Gentlemen:

You are hereby notified that it is our intention to commence the Drilling of a well to be known as
TEXACO INC.

(Company or Operator)

M. B. Weir "B"

, Well No. 10

, in P

The well is

(Lease)

(Unit)

located 990 feet from the South line and 987 feet from the

East

line of Section 12

T-20-S

R-37-E

NMPM.

(GIVE LOCATION FROM SECTION LINE)

Weir East Blinebry

Pool, Lea

County

Skaggs-Drinkard

If State Land the Oil and Gas Lease is No.

If patented land the owner is M. B. Weir

Address P. O. Box 1023, Pecos, Texas

We propose to drill well with drilling equipment as follows:

The status of plugging bond is \$10,000 blanket surety bond of Maryland Casualty Co. filed with State Geologist.

Drilling Contractor Unknown at present.

We intend to complete this well in the Blinebry, Tubb & Drinkard formation at an approximate depth of 6900 feet.

CASING PROGRAM

We propose to use the following strings of Casing and to cement them as indicated:

Size of Hole	Size of Casing	Weight per Foot	New or Second Hand	Depth	Sacks Cement
		SEE ATTACHED	SHEET FOR CASING PROGRAM		

If changes in the above plans become advisable we will notify you immediately.

ADDITIONAL INFORMATION (If recompletion give full details of proposed plan of work.)

Approved _____, 19____
Except as follows:

EMENT MUST BE CIRCULATED BEHIND

9/18

CASING
Cement must tie back

OIL CONSERVATION COMMISSION

By

Sincerely yours,

TEXACO Inc.

(Company or Operator)

By

J. J. Velten

Position

Division Civil Engineer

Send Communications regarding well to

Name

J. H. Markley

Address

P. O. Box 3109, Midland, Texas

CASING PROGRAM

We propose to use the following strings of casing and to cement them as indicated:

Size of Hole	Size of Casing	Weight per foot	New or Second Hand	Depth	Sacks Cement
12-1/4"	9-5/8"	32#, 19.37# & 25.43	New	1400'	750*
Dr. 8-3/4"	2-7/8"	6.5#	New	6900'	1000** X
Tubb	2-7/8"	6.5#	New	6900'	
Bl.	2-7/8"	6.5#	New	6900'	

* Cement with 550 sacks Class "C" 4% gel, followed by 200 sacks Class "C" neat. Use 2% calcium chloride in neat cement.

** Install centralizers over pay and on first three joints above pay. Cement with 500 sacks Class "C" 8% gel, containing friction reducer followed by 500 sacks Class "C" 4% gel. Precede cement with 60 barrels fresh water. Displace plugs with acetic acid.

FORMATION TOPS EXPECTED

Anhydrite	1400'
Top of salt	1480'
Base of salt	2540'
Yates	2690'
San Andres	4097'
Glorieta	5264'
Blinbry	5810'
Tubb	6390'
Drinkard	6803'
Total Depth	6900'

NEW MEXICO OIL CONSERVATION COMMISSION
WELL LOCATION AND ACREAGE DEDICATION PLAT

FORM C-17
 REVISED 5/1/57

SEE INSTRUCTIONS FOR COMPLETING THIS FORM ON THE REVERSE SIDE

SECTION A

Operator TEXACO Inc.		Lease M. B. Weir "B"		Well No. 10
Unit Letter P	Section 12	Township 20 South	Range 37 East	County Lea
Actual Footage Location of Well: 990 feet from the South line and 987 feet from the East line Sec. 12				
Ground Level Elev. 3553	Producing Formation Blinbry, Tubb & Drinkard	Pool Well - East Blinbry, Weir - Tubb (old) Skaggs - Drinkard	Dedicated Acreage: 40 Acres	

1. Is the Operator the only owner in the dedicated acreage outlined on the plat below? YES X NO ____ . ("Owner" means the person who has the right to drill into and to produce from any pool and to appropriate the production either for himself or for himself and another. (65-3-29 (c) NMSA 1935 Comp.)
2. If the answer to question one is "no," have the interests of all the owners been consolidated by communication agreement or otherwise? YES ____ NO ____ . If answer is "yes," Type of Consolidation ____
3. If the answer to question two is "no," list all the owners and their respective interests below:

Owner	Land Description

SECTION B

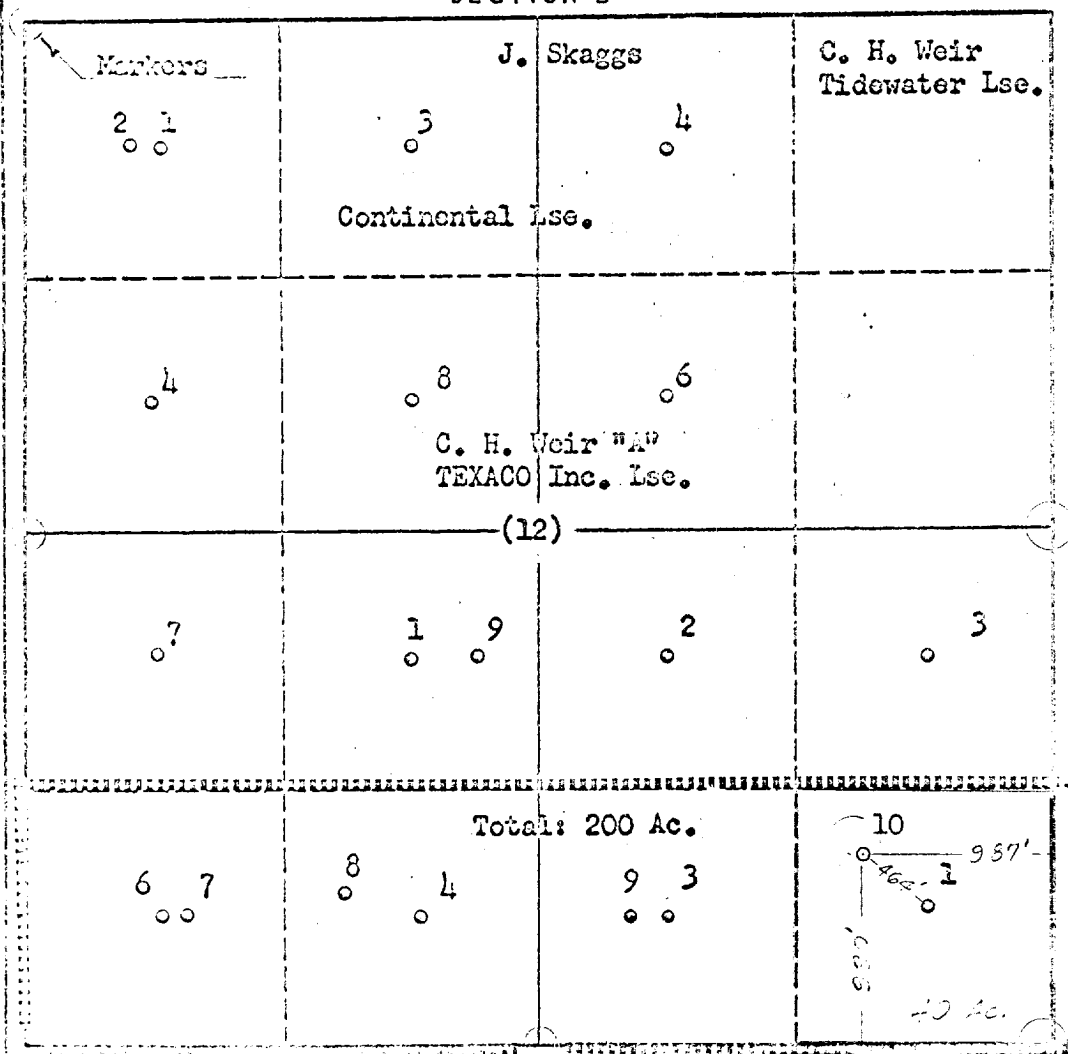

CERTIFICATION

I hereby certify that the information in SECTION A above is true and complete to the best of my knowledge and belief.

Name J. J. Velten
 Position Division Civil Engineer
 Company TEXACO Inc.
 Date 12/11/64

I hereby certify that the well location shown on the plat in SECTION B was plotted from field notes of actual surveys made by me or under my supervision, and that the same is true and correct to the best of my knowledge and belief.

Date Surveyed 12/10/64
 Registered Professional Engineer and/or Land Surveyor J. J. Velten
 Certificate No. 8174

0 350 650 950 1250 1550 1850 2150 2450 2000 1500 1000 500 0