

NO. OF COPIES RECEIVED	
DISTRIBUTION	
SANTA FE	
FILE	
U.S.G.S.	
LAND OFFICE	
OPERATOR	

NEW MEXICO OIL CONSERVATION COMMISSION

Form C-103
Supersedes Old
C-102 and C-103
Effective 1-1-65

<p>SUNDARY NOTICES AND REPORTS ON WELLS (DO NOT USE THIS FORM FOR PROPOSALS TO DRILL OR TO RE-ENTER OR FILL BACK TO A DIFFERENT RESERVOIR. USE APPLICATION FOR PERMIT TO DRILL C-101 FOR SUCH PROPOSALS.)</p>		<p>5a. Indicate Type of Lease State <input checked="" type="checkbox"/> Fee <input type="checkbox"/></p>
<p>6. Name of Operator MorOilCo, Inc.</p>		<p>5. State Oil & Gas Lease No. L-5317</p>
<p>7. Unit Agreement Name</p>		<p>10. Field and Pool, or Wildcat Jalmat</p>
<p>8. Form of Lease Name West State</p>		
<p>9. Well No. #1</p>		
<p>11. Location of Well UNIT LETTER M 660 FEET FROM THE South LINE AND 660 FEET FROM THE West LINE, SECTION 1 TOWNSHIP 22S RANGE 35E N.M.P.M.</p>		
<p>15. Elevation (Show whether DF, RT, GR, etc.) 3593' GR</p>		<p>12. County Lea</p>

<p>16. Check Appropriate Box To Indicate Nature of Notice, Report or Other Data</p>	
<p>NOTICE OF INTENTION TO:</p>	<p>SUBSEQUENT REPORT OF:</p>
<p>PERFORM REMEDIAL WORK <input type="checkbox"/></p> <p>TEMPORARILY ABANDON <input type="checkbox"/></p> <p>PULL OR ALTER CASING <input type="checkbox"/></p> <p>OTHER <input type="checkbox"/></p>	<p>PLUG AND ABANDON <input type="checkbox"/></p> <p>CHANGE PLANS <input type="checkbox"/></p> <p>OTHER <input type="checkbox"/></p>
<p>REMEDIAL WORK <input checked="" type="checkbox"/></p> <p>COMMENCE DRILLING OPNS. <input type="checkbox"/></p> <p>CASING TEST AND CEMENT JOBS <input type="checkbox"/></p> <p>OTHER <input type="checkbox"/></p>	<p>ALTERING CASING <input type="checkbox"/></p> <p>PLUG AND ABANDONMENT <input type="checkbox"/></p>

17. Describe Proposed or Completed Operations (Clearly state all pertinent details, and give pertinent dates, including estimated date of starting any proposed work) SEE RULE 1103.

10-13-80 Move rig & equipment to re-enter well. Remove marker and drill out 35' of cement.

10-14-80 Drill out of cement @ 65', fill material to 85', drilling mud to 1800'. Circulate hole clean.

10-15-80 Clean out to 4058', found good bridge @ that point, circulate hole clean, pressure test casing to 2000#, test good. Pull pipe, casing scraper and bit.

10-16-80 Ran correlation log 'GR', tie to old log, perf 3812-14, 3862-64, 3887-89, 3898-3900, 2 pf, .49" Dia. hole. Ran RTTS to 3918, spot 400 gal. acid, pull RTTS to 3757 & set. Pump 2000 gal. 15% NEA & 48 ball sealers. Max. psi 3850, broke down @ 2660, avg. rate 5 bpm, good ball action, isdp 2250, 10 min. 2120. Start swabbing back acid treatment.

10-17-80 Swab well down with no show of oil, slight show of gas.

10-18-80 Frac with 928 bbl. gel fluid, 16 ball sealers, 36,000# 20-40 and 10-20 sand. Max. psi 4300, avg. psi 3950, isdp 2150, 15 min. 2050, avg. rate of 19.9 bpm. Shut-in. (continued)

18. I hereby certify that the information above is true and complete to the best of my knowledge and belief.

<p>SIGNED <u>William J. Ziegler</u></p>	<p>TITLE <u>Operator</u></p>	<p>DATE <u>10-29-80</u></p>
<p>ORIG. SIGNED BY <u>Jerry Seaton</u></p>	<p>TITLE <u>Dist. In Charge</u></p>	<p>DATE <u>11-30-80</u></p>
<p>REMOVED BY <u>Dist. In Charge</u></p>	<p>TITLE <u>Dist. In Charge</u></p>	<p>DATE <u>11-30-80</u></p>
<p>CONDITIONS OF APPROVAL, IF ANY:</p>		

MorOilCo, Inc. - West State #1 (continue)

10-19-80 Shut-in psi 1875, flowed back, swab 450 bbl. fluid.
No show of oil, slight amount of gas.

10-20-80 Well flowing to frac tank, 120 bbl. over night,
swab 130 bbl. No oil, slight amount of gas.

10-21-80 Well flowed 60 bbl. to tank, swab 120 bbl.
No show, gas staying same. Fluid turning salty.

10-22-80 Well flowed 60 bbl. to tank, swab 110 bbl.,
Recovered all of frac with no show of oil and
very light amount of gas.

Preparing to plug & abandon.

NO. OF COPIES RECEIVED		
DISTRIBUTION		
SANTA FE		
FILE		
U.S.G.S.		
LAND OFFICE		
OPERATOR		

NEW MEXICO OIL CONSERVATION COMMISSION

Form C-101
Revised 1-1-65

5A. Indicate Type of Lease	
STATE <input checked="" type="checkbox"/>	FEE <input type="checkbox"/>
5. State Oil & Gas Lease No.	
L-5317	

APPLICATION FOR PERMIT TO DRILL, DEEPEN, OR PLUG BACK

1a. Type of Work		7. Unit Agreement Name	
b. Type of Well DRILL <input type="checkbox"/> DEEPEN <input type="checkbox"/> PLUG BACK <input type="checkbox"/> OIL WELL <input checked="" type="checkbox"/> GAS WELL <input type="checkbox"/> OTHER <input type="checkbox"/> Re-Entry <input type="checkbox"/> SINGLE ZONE <input checked="" type="checkbox"/> MULTIPLE ZONE <input type="checkbox"/>		8. Farm or Lease Name West State	
2. Name of Operator MorOilCo, Inc.		9. Well No. #1	
3. Address of Operator P.O. Drawer I, Artesia, New Mexico 88210		10. Field and Pool, or Wildcat Jalmat	
4. Location of Well UNIT LETTER <u>M</u> LOCATED <u>660</u> FEET FROM THE <u>South</u> LINE AND <u>660</u> FEET FROM THE <u>West</u> LINE OF SEC. <u>1</u> TWP. <u>22S</u> RGE. <u>35E</u> NMPM		12. County Lea	
19. Proposed Depth 4100'		19A. Formation Yates	
20. Rotary or C.T. Plg. Unit			
21. Elevations (Show whether DF, RT, etc.) 3593'GR		22. Approx. Date Work will start 9-25-80	
21A. Kind & Status Plug. Bond Blanket Bond Active		21B. Drilling Contractor N/A	

23. PROPOSED CASING AND CEMENT PROGRAM

SIZE OF HOLE	SIZE OF CASING	WEIGHT PER FOOT	SETTING DEPTH	SACKS OF CEMENT	EST. TOP
17 1/2"	13 3/8"	48#	369'	300sx. (circ.)	
12 1/4"	9 5/8"	36# & 40#	5524'	2890sx. (circ.)	

Intend to re-work existing road & location, set anchors, dig small working pit on north side of location in original pit area. Dig out cellar, pull marker, install head on 9 5/8" casing, install BOP & drill out cement plug 0 - 50'. With bit & casing scraper will drill and wash to 4100', circulate, test casing & plug @ 5475'. If plug is not secure, will set CIBP @ 4100'. Perf 3862-64(2), 3868-70(2), 3872-78(2), 3888-90(2), 3894-3908(2), test & frac in accordance with test, put on pump and build battery.

(Well was formerly Gulf Oil Corp. - Jalmat Deep #1. OTD 12,643', plug & abandoned February 19, 1966.)

APPROVAL VALID
FOR 90 DAYS UNLESS
DRILLING COMMENCED,
12-21-80

IN ABOVE SPACE DESCRIBE PROPOSED PROGRAM; IF PROPOSAL IS TO DEEPEN OR PLUG BACK, GIVE DATA ON PRESENT PRODUCTIVE ZONE AND PROPOSED NEW PRODUCTIVE ZONE. GIVE BLOWOUT PREVENTER PROGRAM, IF ANY.

I hereby certify that the information above is true and complete to the best of my knowledge and belief.

Signed William D. McKnight Title Operator Date 9-15-80

(This space for State Use)

APPROVED BY [Signature] TITLE STATE ENGINEER DATE 9-15-80
CONDITIONS OF APPROVAL, IF ANY:

NEW MEXICO OIL CONSERVATION COMMISSION
WELL LOCATION AND ACREAGE DEDICATION PLAT

Form C-102
Supersedes C-128
Effective 1-1-65

All distances must be from the outer boundaries of the Section.

Operator MorOilCo, Inc.			Lease West State		Well No. #1
Unit Letter M	Section 1	Township 22S	Range 35E	County Lea	
Actual Footage Location of Well: 660 feet from the South line and 660 feet from the West line					
Ground Level Elev. 3593' GL	Producing Formation Yates		Pool Jalmat		Dedicated Acreage 40 Acres

- Outline the acreage dedicated to the subject well by colored pencil or hachure marks on the plat below.
- If more than one lease is dedicated to the well, outline each and identify the ownership thereof (both as to working interest and royalty).
- If more than one lease of different ownership is dedicated to the well, have the interests of all owners been consolidated by communitization, unitization, force-pooling, etc?

☐ Yes ☐ No If answer is "yes," type of consolidation _____

If answer is "no," list the owners and tract descriptions which have actually been consolidated. (Use reverse side of this form if necessary.) _____

No allowable will be assigned to the well until all interests have been consolidated (by communitization, unitization, forced-pooling, or otherwise) or until a non-standard unit, eliminating such interests, has been approved by the Commission.

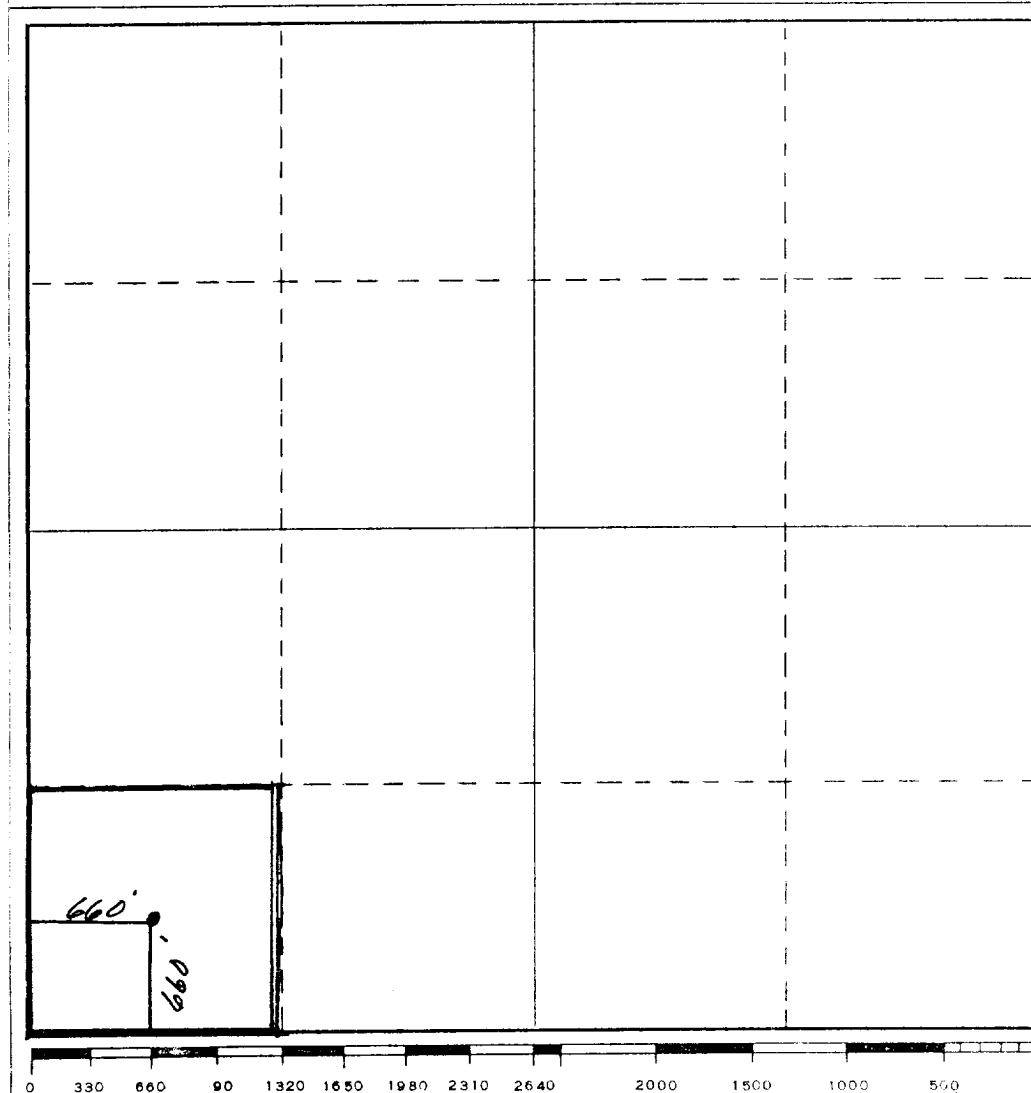

CERTIFICATION

I hereby certify that the information contained herein is true and complete to the best of my knowledge and belief.

William N. Morgan

Name
William N. Morgan

Position
Operator

Company
MorOilCo, Inc.

Date
9-15-80

I hereby certify that the well location shown on this plat was plotted from field notes of actual surveys made by me or under my supervision, and that the same is true and correct to the best of my knowledge and belief.

(refer to original plat)

Registered Professional Engineer
and/or Land Surveyor

Certificate No.

NO. OF COPIES RECEIVED	
DISTRIBUTION	
SANTA FE	
FILE	
U.S.G.S.	
LAND OFFICE	
OPERATOR	

NEW MEXICO OIL CONSERVATION COMMISSION

Form C-103
Supersedes Old
C-102 and C-103
Effective 1-1-65

FEB 23 1966

5a. Indicate Type of Lease State NM Fee <input type="checkbox"/>
5. State Oil & Gas Lease No. B-9438
7. Unit Agreement Name
8. Farm or Lease Name Jalmat Deep
9. Well No. 1
10. Field and Pool, or Wildcat Wildcat
12. County Lea

SUNDRY NOTICES AND REPORTS ON WELLS
(DO NOT USE THIS FORM FOR PROPOSALS TO DRILL OR TO DEEPEN OR PLUG BACK TO A DIFFERENT RESERVOIR. USE "APPLICATION FOR PERMIT -" (FORM C-101) FOR SUCH PROPOSALS.)

1. OIL WELL ☐ GAS WELL ☐ OTHER- **Dry**

2. Name of Operator
Gulf Oil Corporation

3. Address of Operator
Box 670, Hobbs, New Mexico

4. Location of Well
UNIT LETTER **M**, **660** FEET FROM THE **South** LINE AND **660** FEET FROM
THE **West** LINE, SECTION **1** TOWNSHIP **22-S** RANGE **35-E** NMPM.

15. Elevation (Show whether DF, RT, GR, etc.)
3593 GL

16. Check Appropriate Box To Indicate Nature of Notice, Report or Other Data

NOTICE OF INTENTION TO:	SUBSEQUENT REPORT OF:
PERFORM REMEDIAL WORK <input type="checkbox"/>	REMEDIAL WORK <input type="checkbox"/>
TEMPORARILY ABANDON <input type="checkbox"/>	COMMENCE DRILLING OPNS. <input type="checkbox"/>
PULL OR ALTER CASING <input type="checkbox"/>	CASING TEST AND CEMENT JOB <input type="checkbox"/>
OTHER <input type="checkbox"/>	OTHER <input type="checkbox"/>
PLUG AND ABANDON <input type="checkbox"/>	ALTERING CASING <input type="checkbox"/>
CHANGE PLANS <input type="checkbox"/>	PLUG AND ABANDONMENT <input type="checkbox"/>
	Plugged and abandoned

17. Describe Proposed or Completed Operations (Clearly state all pertinent details, and give pertinent dates, including estimated date of starting any proposed work) SEE RULE 1103.

12,635' TD.

Reached TD of 12-3/4" hole at 12,635' on February 17, 1966. Ran logs. Ran Drill Pipe open ended to 12,635' and spotted cement plugs as follows: Plug No. 1, 12,635' to 12,535', 50 sack Incor with .4% HR-4. Plug No. 2, 11,550' to 11,450', 50 sack Incor with .4% HR-4. Plug No. 3, 10,050' to 9950', 55 sack Incor with .4% HR-4. Plug No. 4, 7300' to 7200', 65 sack Incor Neat. Plug No. 5, 5575' to 5475', 50 sack Incor Neat. Plug No. 6, 50' to surface, 50 sack Incor Neat. Installed dry hole marker. Plugged and abandoned February 19, 1966.

(Verbal permission obtained from Mr. Joe D. Ramsey to plug and abandon ad above)

~~PLEASE TREAT THIS INFORMATION AS CONFIDENTIAL~~

18. I hereby certify that the information above is true and complete to the best of my knowledge and belief.

SIGNED _____ TITLE **Area Production Manager** DATE **February 22, 1966**

APPROVED BY **Leslie A. Clement** TITLE _____ DATE _____

CONDITIONS OF APPROVAL, IF ANY: