

OIL CONSERVATION DIVISION

DISTRICT I
P.O. Box 1980, Hobbs, NM 88240

P.O. Box 2088

DISTRICT II

P.O. Box Drawer DD, Artesia, NM 88210

Santa Fe, New Mexico 87504-2088

DISTRICT III

1000 Rio Brazos Rd., Aztec, NM 87410

WELL API NO.	30 025 22023
5. Indicate Type of Lease	STATE <input type="checkbox"/> FEE <input checked="" type="checkbox"/>
6. State Oil / Gas Lea	648530

WELL COMPLETION OR RECOMPLETION REPORT AND LOG															
1a. Type of Well: OIL WELL <input type="checkbox"/> GAS WELL <input checked="" type="checkbox"/> DRY <input type="checkbox"/> OTHER <input type="checkbox"/>					7. Lease Name or Unit Agreement Name SARKEYS, S. J.										
b. Type of Completion: NEW WELL <input type="checkbox"/> WORKOVER <input type="checkbox"/> DEEPEN <input type="checkbox"/> PLUG BACK <input checked="" type="checkbox"/> DIFF RES. <input checked="" type="checkbox"/> OTHER <input type="checkbox"/>															
2. Name of Operator TEXACO EXPLORATION & PRODUCTION INC.					8. Well No. 5										
3. Address of Operator 205 E. Bender, HOBBS, NM 88240					9. Pool Name or Wildcat TUBB OIL & GAS										
4. Well Location Unit Letter C : 330 Feet From The NORTH Line and 2310 Feet From The WEST Line Section 26 Township 21S Range 37E NMPM LEA COUNTY															
10. Date Spudded 3/1/87		11. Date T.D. Reached		12. Date Compl. (Ready to Prod.) 1/16/97		13. Elevations (DF & RKB, RT, GR, etc.) 3391' GR		14. Elev. Csghead							
15. Total Depth 7299'		16. Plug Back T.D. 6695'		17. If Mult. Compl. How Many Zones?		18. Intervals Drilled By PRIDE		Rotary Tools Cable Tools							
19. Producing Interval(s), of this completion - Top, Bottom, Name 6052' - 6248' TUBB OIL AND GAS								20. Was Directional Survey Made No							
21. Type Electric and Other Logs Run GR-CCL								22. Was Well Cored No							
23. CASING RECORD (Report all Strings set in well)															
CASING SIZE		WEIGHT LB./FT.		DEPTH SET		HOLE SIZE		CEMENT RECORD		AMOUNT PULLED					
13-3/8"		48#		344'		17-1/2"		325							
8-5/8"		24#		2449'		11"		2100							
5-1/2"		15.5#		7299'		7-7/8"		1020							
24. LINER RECORD										25. TUBING RECORD					
SIZE		TOP		BOTTOM		SACKS CEMENT		SCREEN		SIZE		DEPTH SET		PACKER SET	
										2-3/8		6302'			
26. Perforation record (interval, size, and number) 6052'-6248' 85'-2jspf 170-.52						27. ACID, SHOT, FRACTURE, CEMENT, SQUEEZE, ETC.									
						DEPTH INTERVAL		AMOUNT AND KIND MATERIAL USED							
						6052' - 6248'		acidize w/4k gls 15% ne fe hcl							
						6052' - 6248'		frac w/ 50.5k gls 35# xlg w/153,320							
								16/30 sand & 40,630# 16/30 resin							
28. PRODUCTION															
Date First Production 1/17/97		Production Method (Flowing, gas lift, pumping - size and type pump) PUMPING - 2" X 1 - 1/2 X 16'								Well Status (Prod. or Shut-in) PROD					
Date of Test 1/17/97		Hours tested 24 hr.		Choke Size		Prod'n For Test Period		Oil - Bbl. 41		Gas - MCF 94		Water - Bbl. 44		Gas - Oil Ratio 2292	
Flow Tubing Press.		Casing Pressure		Calculated 24-Hour Rate		Oil - Bbl.		Gas - MCF		Water - Bbl.		Oil Gravity - API -(Corr.)			
29. Disposition of Gas (Sold, used for fuel, vented, etc.) SOLD										Test Witnessed By LLD					
30. List Attachment															
31. I hereby certify that the information on both sides of this form is true and complete to the best of my knowledge and belief.															
SIGNATURE <i>J. Denise Leake</i> TITLE Engineering Assistant DATE 6/18/98															
TYPE OR PRINT NAME J. Denise Leake Telephone No. 397-0405															

DISTRICT I

P.O. Box 1980, Hobbs, NM 88241-1980

DISTRICT II

P.O. Box Drawer DD, Artesia, NM 88211-0719

DISTRICT III

1000 Rio Brazos Rd., Aztec, NM 87410

DISTRICT IV

P.O. Box 2088, Santa Fe, NM 87504-2088

State of New Mexico

Energy, Minerals and Natural Resources Department

Form C-102

Revised February 10, 1999

Instructions on back

Submit to Appropriate District Office

State Lease - 4 Copies

Fee Lease - 3 Copies

☒ AMENDED REPORT**OIL CONSERVATION DIVISION**

P.O. Box 2088

Santa Fe, New Mexico 87504-2088

WELL LOCATION AND ACREAGE DEDICATION PLAT

¹ API Number 30 025 22023	² Pool Code 60240	³ Pool Name TUBB OIL & GAS
⁴ Property Code 011076	⁵ Property Name SARKEYS, S. J.	⁶ Well No. 5
⁷ OGRID Number 4323	⁸ Operator Name CHEVRON USA INC	⁹ Elevation 3391' GR

¹⁰ Surface Location

UI or lot no	Section	Township	Range	Lot.Idn	Feet From The	North/South Line	Feet From The	East/West Line	County
C	26	21S	37E		330	NORTH	2310	WEST	LEA

¹¹ Bottom Hole Location If Different From Surface

UI or lot no.	Section	Township	Range	Lot.Idn	Feet From The	North/South Line	Feet From The	East/West Line	County
---------------	---------	----------	-------	---------	---------------	------------------	---------------	----------------	--------

¹² Dedicated Acre 40	¹³ Joint or Infill No	¹⁴ Consolidation Code	¹⁵ Order No. NSP-1350-A
------------------------------------	-------------------------------------	----------------------------------	---------------------------------------

NO ALLOWABLE WILL BE ASSIGNED TO THIS COMPLETION UNTIL ALL INTERESTS HAVE BEEN CONSOLIDATED
OR A NON-STANDARD UNIT HAS BEEN APPROVED BY THE DIVISION

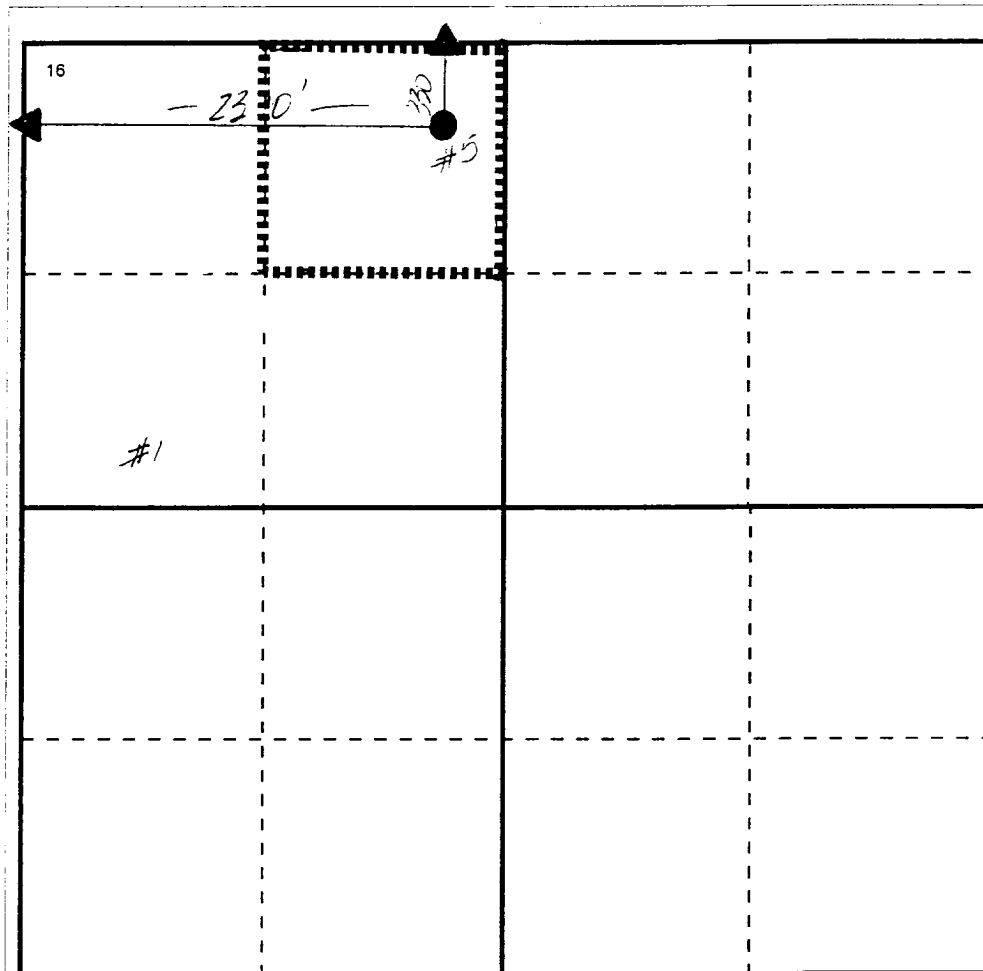
**17 OPERATOR CERTIFICATION**

I hereby certify that the information contained herein is true and complete to the best of my knowledge and belief

Signature

Denise Leake

Printed Name

Denise Leake

Position

Regulatory Specialist

Date

12/17/2002

18 SURVEYOR CERTIFICATION

I hereby certify that the well location shown on this plat was plotted from field notes of actual surveys made by me or under my supervision, and that the same is true and correct to the best of my knowledge and belief.

Date Surveyed

Signature & Seal of

Professional Surveyor

Certificate No.