

UNITED STATES  
DEPARTMENT OF THE INTERIOR  
GEOLOGICAL SURVEY

## APPLICATION FOR PERMIT TO DRILL, DEEPEN, OR PLUG BACK

## 1a. TYPE OF WORK

DRILL ☒DEEPEN ☐PLUG BACK ☐

## b. TYPE OF WELL

OIL  
WELL ☒GAS  
WELL ☐

OTHER

SINGLE  
ZONE ☒MULTIPLE  
ZONE ☐

## 2. NAME OF OPERATOR

PAN AMERICAN PETROLEUM CORPORATION

## 3. ADDRESS OF OPERATOR

BOX 68, HOBBS, N. M. 88240

## 4. LOCATION OF WELL (Report location clearly and in accordance with any State requirements.)\*

At surface

2086' FNL x 1874' FEL Sec. 22 (Unit G, SW/4 NE/4)

At proposed prod. zone

## 14. DISTANCE IN MILES AND DIRECTION FROM NEAREST TOWN OR POST OFFICE\*

## 15. DISTANCE FROM PROPOSED\*

LOCATION TO NEAREST  
PROPERTY OR LEASE LINE, FT.  
(Also to nearest drlg. line, if any)

## 16. NO. OF ACRES IN LEASE

18. DISTANCE FROM PROPOSED LOCATION\*  
TO NEAREST WELL, DRILLING, COMPLETED,  
OR APPLIED FOR, ON THIS LEASE, FT.

## 19. PROPOSED DEPTH

7750'

17. NO. OF ACRES ASSIGNED  
TO THIS WELL

80

## 20. ROTARY OR CABLE TOOLS

O-TD

## 21. ELEVATIONS (Show whether DF, RT, GR, etc.)

## 22. APPROX. DATE WORK WILL START\*

8-10-68

## 23.

## PROPOSED CASING AND CEMENTING PROGRAM

SIZE OF HOLE	SIZE OF CASING	WEIGHT PER FOOT	SETTING DEPTH	QUANTITY OF CEMENT
17 1/2"	13 3/8"	48	300'	Circulate
12 1/4"	9 5/8"	36	3800'	Base of Salt
8 3/4"	7"	23-26	7700'	600' above Blinbury.

After drilling well logs will be run and evaluations made, perforating and/or stimulating as necessary in attempting commercial production.

IN ABOVE SPACE DESCRIBE PROPOSED PROGRAM: If proposal is to deepen or plug back, give data on present productive zone and proposed new productive zone. If proposal is to drill or deepen directionally, give pertinent data on subsurface locations and measured and true vertical depths. Give blowout preventer program, if any.

## 24.

SIGNED

AREA SUPERINTENDENT

DATE

8-5-68

(This space for Federal or State office use)

PERMIT NO.

APPROVAL DATE

APPROVED BY

TITLE

CONDITIONS OF APPROVAL, IF ANY:

APPROVED

AUG 8 1968

A. R. Brumby  
DISTRICT ENGINEER

DATE

\*See Instructions On Reverse Side

4-USGS-10  
1-NSW  
1-SUSP  
1-RRY

NEW MICO OIL CONSERVATION COMMISSION  
WELL LOCATION AND ACREAGE DEDICATION PLAT

Form C-102  
Supersedes C-128  
Effective 1-1-65

All distances must be from the outer boundary of the Section

Operator <b>PAN AMERICAN PETROLEUM CORP.</b>		Lease <b>AUG 13 3 06 PM '68 "B" FEDERAL</b>		Well No. <b>13</b>
Unit Letter <b>G</b>	Section <b>22</b>	Township <b>20 SOUTH</b>	Range <b>37 EAST</b>	County <b>LEA</b>
Actual Well Location of Well:				
<b>2086</b>	feet from the <b>NORTH</b>	line and	<b>1874</b>	feet from the <b>EAST</b>
Ground Level Elev.	Producing Formation <b>STRAWN</b>	Pool <b>CASS PENN</b>	Estimated Acreage <b>80</b> Acres	

1. Outline the acreage dedicated to the subject well by colored pencil or hatchure marks on the plat below.
2. If more than one lease is dedicated to the well, outline each and identify the ownership thereof (both as to working interest and royalty).
3. If more than one lease of different ownership is dedicated to the well, have the interests of all owners been consolidated by communitization, unitization, force-pooling, etc?

☐ Yes ☐ No If answer is "yes," type of consolidation \_\_\_\_\_

If answer is "no," list the owners and tract descriptions which have actually been consolidated. (Use reverse side of this form if necessary.) \_\_\_\_\_

No allowable will be assigned to the well until all interests have been consolidated (by communitization, unitization, forced-pooling, or otherwise) or until a non-standard unit, eliminating such interests, has been approved by the Commission.

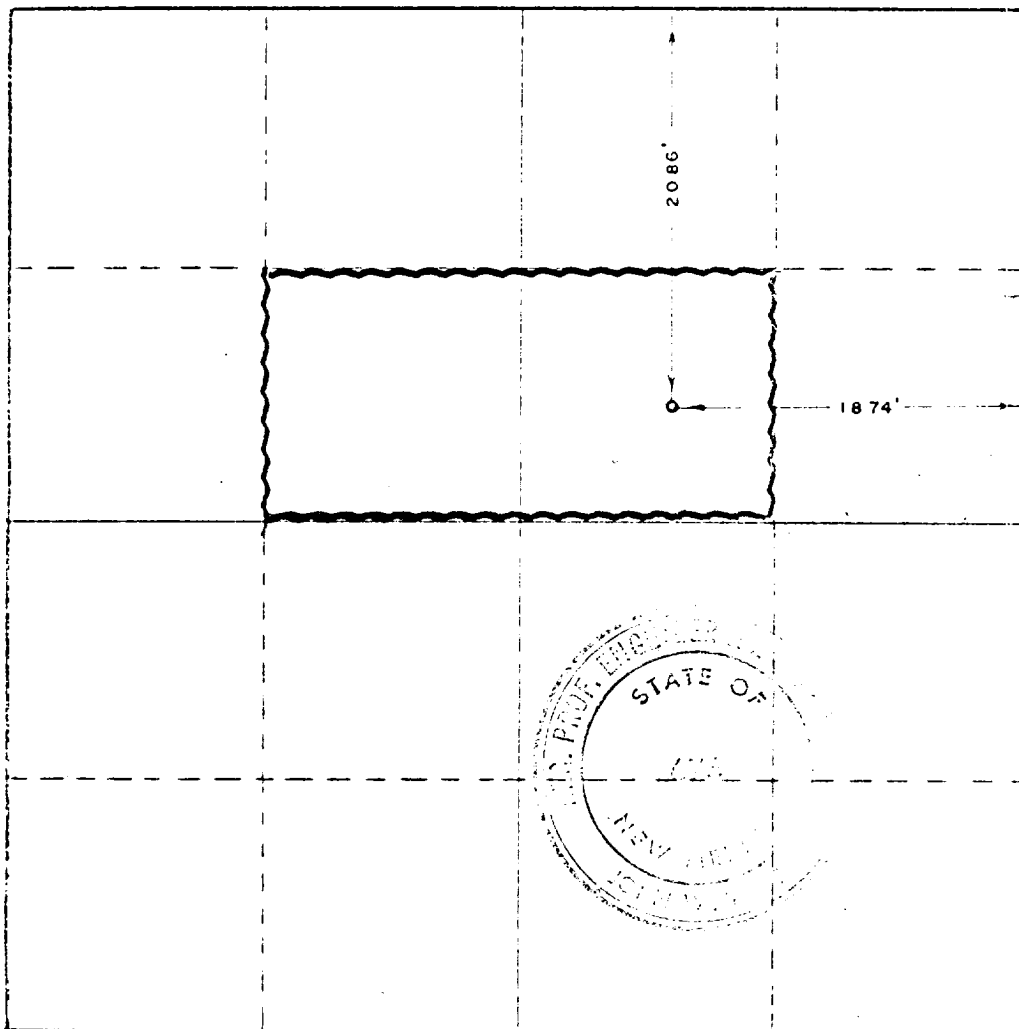

CERTIFICATION

I hereby certify that the information contained herein is true and complete to the best of my knowledge and belief.

AREA SUPERINTENDENT

PAN AMERICAN PETROLEUM CORPORATION

AUG 6 1968

I hereby certify that the well location shown on this plat was plotted from field notes of actual surveys made by me or under my supervision, and that the same is true and correct to the best of my knowledge and belief.

Date Surveyed

AUGUST 3, 1968

Registered Professional Engineer  
and Licensed Surveyor

*John W. West*  
Certificate No. 676