

|                        |  |  |
|------------------------|--|--|
| NO. OF COPIES RECEIVED |  |  |
| DISTRIBUTION           |  |  |
| SANTA FE               |  |  |
| FILE                   |  |  |
| U.S.G.S.               |  |  |
| LAND OFFICE            |  |  |
| OPERATOR               |  |  |

# NEW MEXICO OIL CONSERVATION COMMISSION

Form C-101  
Revised 1-1-65

|                                |   |
|--------------------------------|---|
| 5A. Indicate Type of Lease     |   |
| STATE <input type="checkbox"/> | FEE <input checked="" type="checkbox"/> |
| 5. State Oil & Gas Lease No.   |   |

## APPLICATION FOR PERMIT TO DRILL, DEEPEN, OR PLUG BACK

|   |  |  |  |
|---|--|--|--|
| 1a. Type of Work  |  | 7. Unit Agreement Name                         |  |
| b. Type of Well<br>DRILL <input checked="" type="checkbox"/> DEEPEN <input type="checkbox"/> PLUG BACK <input type="checkbox"/><br>OIL WELL <input checked="" type="checkbox"/> GAS WELL <input type="checkbox"/> OTHER <input type="checkbox"/> SINGLE ZONE <input type="checkbox"/> MULTIPLE ZONE <input checked="" type="checkbox"/> |  | 8. Farm or Lease Name<br>Gulf Sarkey's         |  |
| 2. Name of Operator<br>Solar Oil Company  |  | 9. Well No.<br>1                               |  |
| 3. Address of Operator<br>P. O. Box 5114, Midland, Texas  |  | 10. Field and Pool, or Wildcat<br>Undesignated |  |
| 4. Location of Well<br>UNIT LETTER C LOCATED 660 FEET FROM THE North LINE<br>AND 1980 FEET FROM THE West LINE OF SEC. 25 TWP. 21-S RGE. 37-E NMPM   |  | 12. County<br>Lea                              |  |
| 19. Proposed Depth<br>7500'   |  | 19A. Formation                                 |  |
| 21. Elevations (Show whether DF, RT, etc.)  |  | 20. Rotary or C.T.<br>Rotary                   |  |
| 21A. Kind & Status Plug. Bond<br>Blanket-Current  |  | 22. Approx. Date Work will start<br>9-1-68     |  |

## PROPOSED CASING AND CEMENT PROGRAM

| SIZE OF HOLE | SIZE OF CASING | WEIGHT PER FOOT | SETTING DEPTH | SACKS OF CEMENT | EST. TOP      |
|--------------|----------------|-----------------|---------------|-----------------|---------------|
| 13-1/2"      | 10-3/4"        | 40.5#           | 850'          | 325 sx.         | Circ.         |
| 9-5/8"       | 7-5/8"         | 33.9#           | 7400'         | 550 sx.         | base of salt. |

This well will be drilled to depth sufficient to test the Abo formation, approximately to 7400'.

APPROVAL VALID  
FOR 90 DAYS UNLESS  
RENEWED OR REVOKED

COMMISSION MUST BE FILED  
48 HRS PRIOR TO RUNNING 10/3/68

EXPIRES 12/2/68

IN ABOVE SPACE DESCRIBE PROPOSED PROGRAM: IF PROPOSAL IS TO DEEPEN OR PLUG BACK, GIVE DATA ON PRESENT PRODUCTIVE ZONE AND PROPOSED NEW PRODUCTIVE ZONE. GIVE BLOWOUT PREVENTER PROGRAM, IF ANY.

I hereby certify that the information above is true and complete to the best of my knowledge and belief.

Signed M. J. Smith Title Production Clerk Date August 26, 1968

(This space for State Use)

APPROVED BY Leshi N. Clements TITLE SECRETARY DATE 1968

CONDITIONS OF APPROVAL, IF ANY:

**NEW MEXICO OIL CONSERVATION COMMISSION  
WELL LOCATION AND ACREAGE DEDICATION PLAT**

Form C-102  
Supersedes C-128  
Effective 1-1-65

All distances must be from the outer boundaries of the Section

|  |                                   |  |  |                      |                      |
|--|-----------------------------------|--|--|----------------------|----------------------|
| Operator<br><b>SOLAR OIL COMPANY</b>           |                                   |  | Lease<br><b>AUG 30 11 AM 1968<br/>GULF SARKEYS</b> |                      | Well No.<br><b>1</b> |
| Unit Letter<br><b>C</b>                        | Section<br><b>25</b>              | Township<br><b>21 SOUTH</b>                | Range<br><b>37 EAST</b>                            | County<br><b>LEA</b> |                      |
| Actual Footage Location of Well:               |                                   |  |  |                      |                      |
| <b>660</b> feet from the <b>NORTH</b> line and |                                   | <b>1980</b> feet from the <b>WEST</b> line |  |                      |                      |
| Ground Level Elev.<br><b>3405 GL</b>           | Producing Formation<br><b>Abo</b> | Pool<br><b>Wentz-Abo<br/>Undesignated</b>  | Dedicated Acreage:<br><b>40</b> Acres              |                      |                      |

1. Outline the acreage dedicated to the subject well by colored pencil or hatchure marks on the plat below.
2. If more than one lease is dedicated to the well, outline each and identify the ownership thereof (both as to working interest and royalty).
3. If more than one lease of different ownership is dedicated to the well, have the interests of all owners been consolidated by communitization, unitization, force-pooling, etc?

☐ Yes   ☐ No   If answer is "yes," type of consolidation \_\_\_\_\_

If answer is "no," list the owners and tract descriptions which have actually been consolidated. (Use reverse side of this form if necessary.) \_\_\_\_\_

No allowable will be assigned to the well until all interests have been consolidated (by communitization, unitization, forced-pooling, or otherwise) or until a non-standard unit eliminating such interests, has been approved by the Commission.

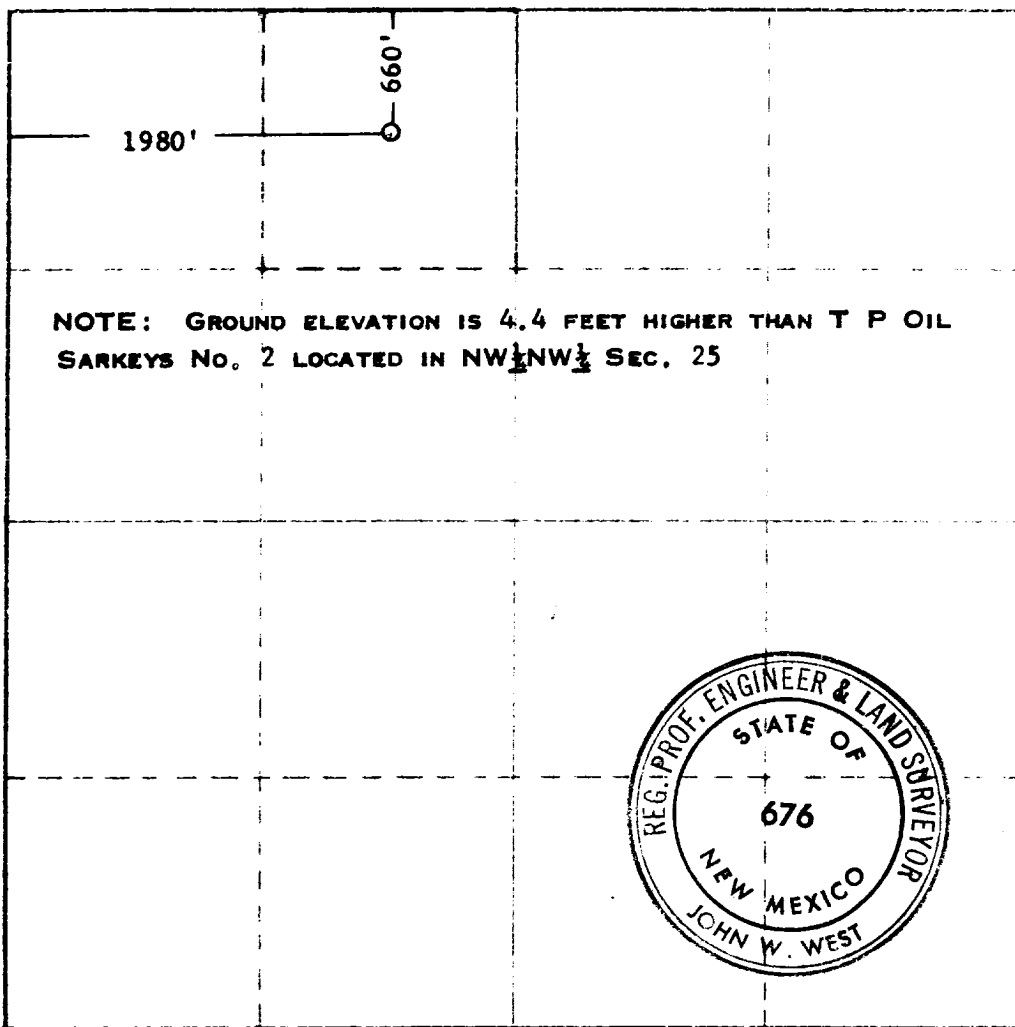

**CERTIFICATION**

I hereby certify that the information contained herein is true and complete to the best of my knowledge and belief

*[Signature]*  
Vice President  
Solar Oil Company

August 26, 1968

I hereby certify that the well location shown on this plat was plotted from field notes of actual surveys made by me or under my supervision, and that the same is true and correct to the best of my knowledge and belief.

Date Surveyed:  
**AUGUST 23, 1968**

Registered Professional Engineer  
and/or Land Surveyor

*[Signature]*  
Certificate No. **676**