

UNITED STATES
DEPARTMENT OF THE INTERIOR
GEOLOGICAL SURVEY

7. LEASE IDENTIFICATION AND SERIAL NO.
LC-065525
8. IF INDICATED, NAME OF TRIBE NAME

APPLICATION FOR PERMIT TO DRILL, DEEPEN, OR PLUG BACK

1a. TYPE OF WORK: DRILL ☒ DEEPEN ☐ PLUG BACK ☐

b. TYPE OF WELL: OIL WELL ☒ GAS WELL ☐ OTHER ☐ SINGLE ZONE ☐ MULTIPLE ZONE ☒

2. NAME OF OPERATOR: SOLAR OIL COMPANY

3. ADDRESS OF OPERATOR: Box 5596 Midland, Texas 79701

4. LOCATION OF WELL (Give location clearly and in accordance with any State requirements *):
At 1980' FWL; 660' FSL
At proposed prod. zone: 1980' FWL; 660' FSL

14. DISTANCE IN MILES AND DIRECTION FROM NEAREST TOWN OR POST OFFICE: 4 miles NE/Eunice, New Mexico

15. DISTANCE FROM PROPOSED LOCATION TO NEAREST PROPERTY OR LEASE LINE, IF ANY (Also to nearest drilg. unit line, if any): 660'

16. NO. OF ACRES IN LEASE: 320

17. NO. OF ACRES ASSIGNED TO THIS WELL: 40

18. DISTANCE FROM PROPOSED LOCATION TO NEAREST WELL, DRILLING, COMPLETED, OR APPLIED FOR, ON THIS LEASE, FT.: 1320'

19. PROPOSED DEPTH: 7600'

20. ROTARY OR CABLE TOOLS: Rotary

21. ELEVATIONS (Show whether OF, RT, GR, etc.):

22. APPROX. DATE WORK WILL START: 2-1-69

23. PROPOSED CASING AND CEMENTING PROGRAM

SIZE OF HOLE	SIZE OF CASING	WEIGHT PER FOOT	SETTING DEPTH	QUANTITY OF CEMENT
<u>12-1/2"</u>	<u>9-5/8"</u>	<u>32.3#</u>	<u>850'</u>	<u>325 sx Circ</u>
<u>8-3/4"</u>	<u>7"</u>	<u>23 & 26#</u>	<u>7600'</u>	<u>650 sx base of salt</u>

It is proposed to drill a well to a depth sufficient to test the Abo formation, estimated at 7600'.

IN ABOVE SPACE DESCRIBE PROPOSED PROGRAM: If proposal is to deepen or plug back, give data on present productive zone and proposed new productive zone. If proposal is to drill or deepen directionally, give pertinent data on subsurface locations and measured and true vertical depths. Give blowout preventer program, if any.

24. SIGNED: [Signature] TITLE: Production Clerk DATE: Jan. 20, 1969

(This space for Federal or State office use)

PERMIT NO. _____ APPROVAL DATE _____

APPROVED BY: [Signature] TITLE: APPROVED

CONDITIONS OF APPROVAL, IF ANY:

*See Instructions On Reverse Side

RECEIVED
JAN 21 1969

NEW MEXICO OIL CONSERVATION COMMISSION
WELL LOCATION AND ACREAGE DEDICATION PLAT

Form C-102
Supersedes C-128
Effective 1-1-65

All distances must be from the outer boundaries of the Section

Operator SOLAR OIL COMPANY			Lease ELLIOTT FIELDS		Well No. 3
Tract Letter N	Section 6	Township 21 SOUTH	Range 38 EAST	County LEA	
Actual Well Location of Well: 660 feet from the SOUTH line and 1980 feet from the WEST line					
Ground Level Elev. 3555.8	Producing Formation Abo	Pool Undesignated		Dedicated Acreage: 40 Acres	

1. Outline the acreage dedicated to the subject well by colored pencil or hatchure marks on the plat below.
2. If more than one lease is dedicated to the well, outline each and identify the ownership thereof (both as to working interest and royalty).
3. If more than one lease of different ownership is dedicated to the well, have the interests of all owners been consolidated by communitization, unitization, force-pooling, etc?

☐ Yes ☐ No If answer is "yes" type of consolidation _____

If answer is "no," list the owners and tract descriptions which have actually been consolidated. (Use reverse side of this form if necessary.) _____

No allowable will be assigned to the well until all interests have been consolidated (by communitization, unitization, forced-pooling, or otherwise) or until a non-standard unit, eliminating such interests, has been approved by the Commission.

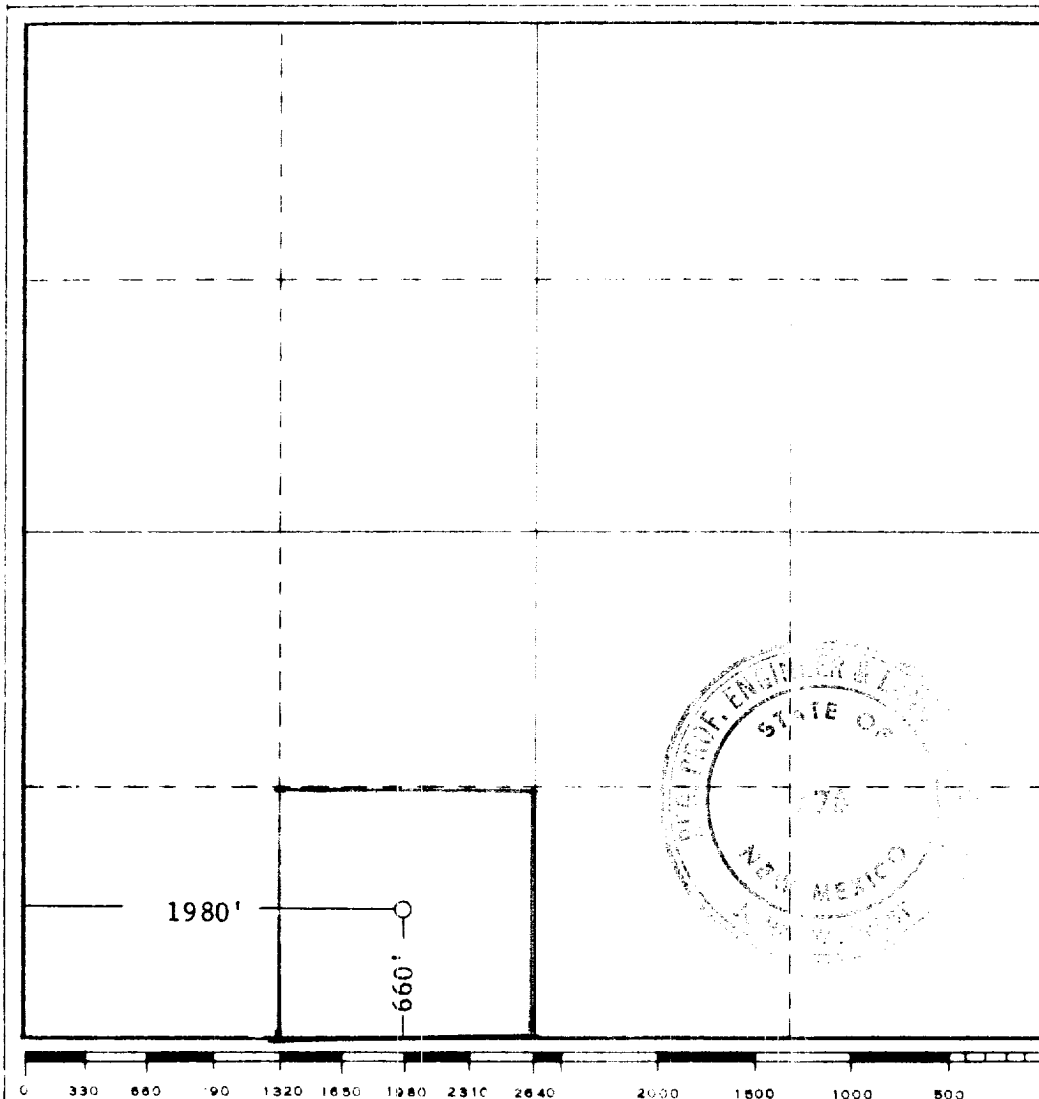

CERTIFICATION

I hereby certify that the information contained herein is true and complete to the best of my knowledge and belief.

Name *John W. West*

Position
Production Clerk

Company
SOLAR OIL COMPANY

Date
Jan. 21, 1969

I hereby certify that the well location shown on this plat was plotted from field notes of actual surveys made by me or under my supervision, and that the same is true and correct to the best of my knowledge and belief.

Date Surveyed
1-13-1969

Registered Professional Engineer
and/or Land Surveyor

John W. West
Certificate No. **676**