

CONSERVATION COMMISSION  
ACREAGE DEDICATION AND ACREAGE DEDICATION PLAT

Form C-102  
Supersedes C-128  
Effective 1-4-65

HOBBS OFFICE O. G. O.

Plat boundaries must be from the outer boundaries of the Section

PAN AMERICAN PETROLEUM CORP.		JUN 10 11 10 AM '69		WILLY "B" FEDERAL		Well No. 14
Section Letter F	Section 34	Range 20 SOUTH	Range 37 EAST	County LEA		
Annual Production Location and Area:						
1980 feet from the NORTH line and		1980 feet from the WEST line				
Ground Level Elev.	Producing Formation ABO	Foot WILDCAT	Dedicated Acreage: 40 Acres			

1. Outline the acreage dedicated to the subject well by colored pencil or hachure marks on the plat below.
2. If more than one lease is dedicated to the well, outline each and identify the ownership thereof (both a to working interest and royalty).
3. If more than one lease of different ownership is dedicated to the well, have the interests of all owners been consolidated by communitization, unitization, force-pooling, etc?

☐ Yes ☐ No If answer is "yes," type of consolidation \_\_\_\_\_

If answer is "no," list the owners and tract descriptions which have actually been consolidated. (Use reverse side of this form if necessary.) \_\_\_\_\_

No allowable will be assigned to the well until all interests have been consolidated (by communitization, unitization, forced-pooling, or otherwise) or until a non-standard unit, eliminating such interests, has been approved by the Commission.

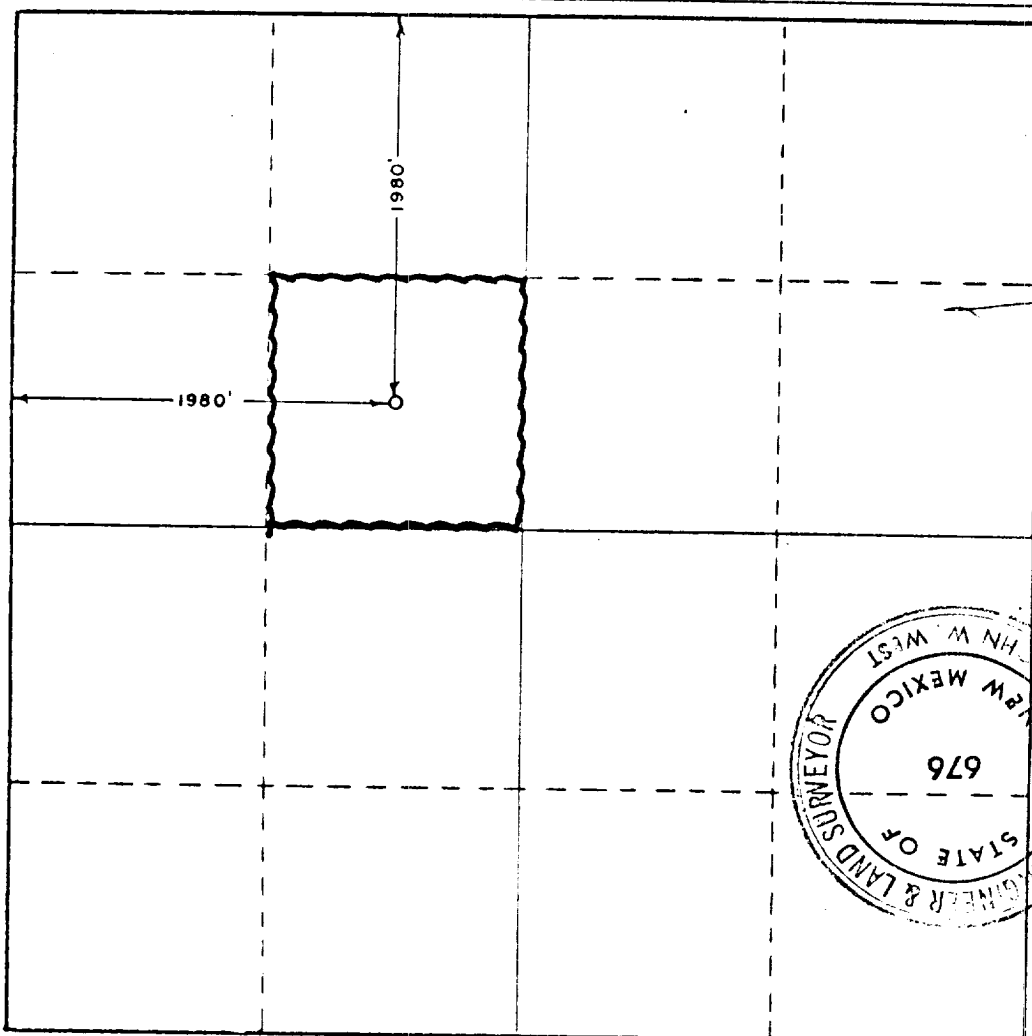

CERTIFICATION

I hereby certify that the information contained herein is true and complete to the best of my knowledge and belief.

Name \_\_\_\_\_

Position \_\_\_\_\_

AREA SUPERINTENDENT

Company \_\_\_\_\_

PAN AMERICAN PETROLEUM CORPORATION

Date \_\_\_\_\_

JUN 6 1969

I hereby certify that the well location shown on this plat was plotted from field notes of actual surveys made by me or under my supervision, and that the same is true and correct to the best of my knowledge and belief.

MAY 30, 1969

Date Surveyed \_\_\_\_\_

Registered Professional Engineer and/or Land Surveyor

*John W. West*  
Certificate No. 676

