

**Petroleum Information**

COUNTY **LEA** FIELD **Jalmat**

OPR **ZIA ENERGY INC.**

1 LEASE **Cities Federal**

Sec 20, T22S, R36E

2310 FSL, 330 FWL of Sec

9 mi SW/Eunice

CSC  
8 5/8-325-225 sx  
4 1/2-3800-400 sx

WELL CLASS: INIT DX FIN D LSE CODE			
FORMATION	DATUM	FORMATION	DATUM
TD 3800 (SVRV)		PBD	

RESPD 1-6-81 RE CMP 1-13-81

10-5-56 NM

10-025-23664

DRY & ABANDONED

CONTR **OPRSELEV 3570 GL** sub-s

10-26-81 F.R.C. 10-31-81 OWWO  
PD 3712 WO (Seven Rivers)  
(Orig. Wolfson Oil Co. #1 Cities-Federal cmp  
2-22-71 thru (Yates) Perfs 3221-3442, OTD  
3800; OPB 3480)  
TD 3800; Dry & Abandoned  
Perf (Upper Yates) 3148-98  
Acid (3148-98) 1000 gals  
Swbd dry (3148-95)  
DO to 3712  
Perf (Seven Rivers) @ 3457, 3459, 3462, 3468,  
3470, 3526, 3528, 3532, 3536, 3544, 3546, 3550,  
3552, 3558, 3560, 3586, 3590, 3650, 3656, 3658,  
3695, 3697, 3700  
Swbd wtr (3457-3700)  
Frac (3650-3700) 20,000 gal + 20,000# sd  
Swbd wtr (3650-3700)  
COMPLETION ISSUED

10-31-81

10-5-56 NM  
IC 30-025-70574-8

COUNTY IEA FIELD Eunice, S. STATE NM 38-025-22664

OPR WOLFSON OIL CO. MAP

1 Cities - Federal

Sec 20, T-22-S, R-36-E

2310' FSL, 330' FWL of Sec CO-ORD

Spd 1-15-71

Cmp 2-22-71 CLASS EL 3570.8

FORMATION	DATUM	FORMATION	DATUM
CSG & SX TUBING			
8 5/8" at 325' w/225 SX			
4 1/2" at 3800' w/400 SX.			

LOGS EL GR RA IND HC A

TD 3800'; PBD 3480'

IP (Gates) Perfs 3221-3442' CAOF 1945 MCF/GPD. GOR Dry; (Gates) NR; SIWHP 361#.

Distribution limited and publication prohibited by subscribers' agreement.  
Reproduction rights reserved by Williams & Lee Logging Service, Inc.

CONT Cactus PROP DEPTH 4000' TYPE RT  
DATE

F.R. 12-29-70; Opr's Elev. 3568' CD  
PD 4000' RT (Queen)  
Contractor - Cactus  
1-19-71 TD 3402'; Trip  
1-26-71 TD 3800'; Prep Perf  
2-3-71 No Tests or Cores  
TD 3800'; PBD 3715'; Istg  
Perf @ 3767', 3790' w/2 SPI  
Acid (3767-90') 2500 gals  
Swbd 100% wtr (3767-90')  
PB @ 3715'  
Perf 3221-3442' w/10 shots (overall)  
Perf 3498-3508' w/3 shots (overall)  
Acid (3221-3508') 2250 gals  
Frac (3221-3508') 20,000 gals wtr + 33,500# sd

WOLFSON CIL CO.

Eunice, S. NM  
1 Cities - Federal

Sec 20, T22S, R36E  
Page #2

2-8-71 TD 3800'; PBD 3715'; Tstg  
2-15-71 TD 3800'; PBD 3715'; Tstg  
2-22-71 TD 3800'; PBD 3715'; WO Potential  
3-8-71 TD 3800'; PBD 3715'; WO Potential  
3-15-71 TD 3800'; PBD 3715'; WO Potential  
3-22-71 TD 3800'; PBD 3480'; WO Potential  
Swbd 100% wtr (3498-3508')  
EP @ 3480'  
CAOF 1950 MCF/CPD (3221-3442')  
3-29-71 TD 3800'; PBD 3480'; WO Potential  
4-5-71 TD 3800'; PBD 3480'; COMPLETE  
(Yates) ONE POINT GAUGE:  
Flwd 870 MCF/CPD, 1/2" ch, 24 hrs, TP 120#

4-5-71

Continued  
LOG ICPS: Base salt 3214', Yates 3268',  
Seven Rivers 3470'  
COMPLETION REPORTED

4-8-71

COUNTY LEA FIELD Jalmat STATE NM 30-025-23664  
OPR WOLFSON OIL CO. MAP

1 Cities - Federal

Sec 20, T-22-S, R-36-E CO-ORD

2310' FSL, 330' FWL of Sec

Spd 1-15-71

CLASS

EL 3570.4

Cmp 2-22-71

FORMATION

DATUM

FORMATION

DATUM

CSG & SX TUBING

8 5/8" at 325' w/225 sx

4 1/2" at 3800' w/400 sx.

LOGS EL GR RA IND HC A

TD 3800'; PBD 3480'

IP (Yates) Perfs 3221-3442' CAOF 1945 MCFGPD. GOR Dry; Grav  
(Gas) NR; SIWHP 361#.

Distribution limited and publication prohibited by subscribers' agreement.  
Reproduction rights reserved by Williams & Lee Logging Service, Inc.

CONT. Cactus  
DATE

PROP DEPTH 4000' TYPE RT

F.R. 12-29-70; Opr's Elev. 3568' CL

PD 4000' RT (Queen)

Contractor - Cactus

5-13-71

AMEND FIELD NAME, Formerly reported as  
Eunice, S.

4-8-71

COMPLETION REPORTED

# NEW MEXICO OIL CONSERVATION COMMISSION WELL LOCATION AND ACREAGE DEDICATION PLAT

FORM C-128  
State 1-1-65

All distances must be from the outer boundaries of the Section.

Operator <b>ZIA ENERGY, INC.</b>				Lease <b>Cities Federal</b>		Well No. <b>1-1</b>
Unit Letter <b>L</b>	Section <b>20</b>	Township <b>22 South</b>	Range <b>36 East</b>	County <b>Lea</b>		
Actual Footage Location of Well: <b>2310</b> feet from <b>South</b> line and <b>330</b> feet from the <b>West</b> line						
Ground Level Elev. <b>3568'</b>	Producing Formation <b>Yates-Seven Rivers</b>		Pool <b>Jalmat (Gas)</b>	Dedicated Acreage: <b>280</b> Acres		

1. Outline the acreage dedicated to the subject well by colored pencil or hatchure marks on the plat below.
2. If more than one lease is dedicated to the well, outline each and identify the ownership thereof (both as to working interest and royalty).
3. If more than one lease of different ownership is dedicated to the well, have the interests of all owners been consolidated by communitization, unitization, force-pooling, etc?

☐ Yes ☐ No If answer is "yes," type of consolidation \_\_\_\_\_

If answer is "no," list the owners and tract descriptions which have actually been consolidated. (Use reverse side of this form if necessary.) \_\_\_\_\_

No allowable will be assigned to the well until all interests have been consolidated (by communitization, unitization, forced-pooling, or otherwise) or until a non-standard unit, eliminating such interests, has been approved by the Commission.

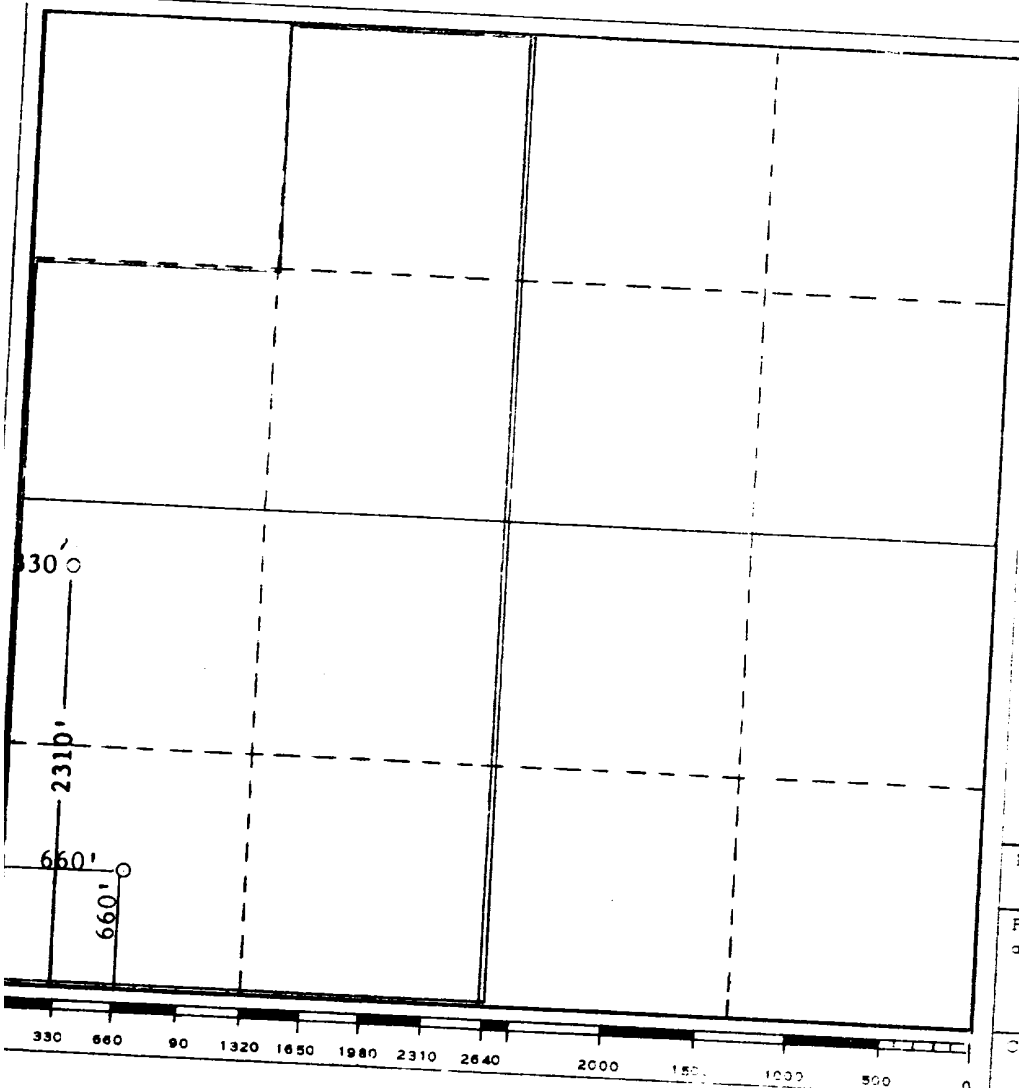

## CERTIFICATION

I hereby certify that the information contained herein is true and complete to the best of my knowledge and belief.

Name M. J. Nelson  
Position **Engineer**  
Company **Zia Energy, Inc.**  
Date **2/14/84**

I hereby certify that the well location shown on this plat was plotted from field notes of actual surveys made by me or under my supervision, and that the same is true and correct to the best of my knowledge and belief.

Date Surveyed \_\_\_\_\_  
Registered Professional Engineer and/or Land Surveyor

Certificate No. \_\_\_\_\_

RECEIVED  
FEB 28 1984  
O.C.D.  
HOBB'S OFFICE

---

NEW MEXICO OIL CONSERVATION COMMISSION  
WELL LOCATION AND ACREAGE DEDICATION PLAT

Form C-102  
Supersedes C-128  
Effective 1-1-65

All distances must be from the outer boundaries of the Section.

Operator <b>Wolfson Oil Company</b>				Lease <b>Cities-Federal</b>		Well No. <b>1</b>
Unit Letter <b>L</b>	Section <b>20</b>	Township <b>22 South</b>	Range <b>36 East</b>	County <b>Lea</b>		
Actual Footage Location of Well: <b>2310</b> feet from the <b>South</b> line and <b>330</b> feet from the <b>East</b> line						
Ground Level Elev. <b>3568</b>	Producing Formation <b>Yates</b>		Pool <b>Jalmit (Yates) Gas</b>	Dedicated Acreage: <b>280</b> Acres		

- Outline the acreage dedicated to the subject well by colored pencil or hachure marks on the plat below.
- If more than one lease is dedicated to the well, outline each and identify the ownership thereof (both as to working interest and royalty).
- If more than one lease of different ownership is dedicated to the well, have the interests of all owners been consolidated by communitization, unitization, force-pooling, etc?

☐ Yes ☐ No If answer is "yes," type of consolidation \_\_\_\_\_

If answer is "no," list the owners and tract descriptions which have actually been consolidated. (Use reverse side of this form if necessary.) \_\_\_\_\_

No allowable will be assigned to the well until all interests have been consolidated (by communitization, unitization, forced-pooling, or otherwise) or until a non-standard unit, eliminating such interests, has been approved by the Commission. **Non-standard unit approved Commission Order No. P-4139**

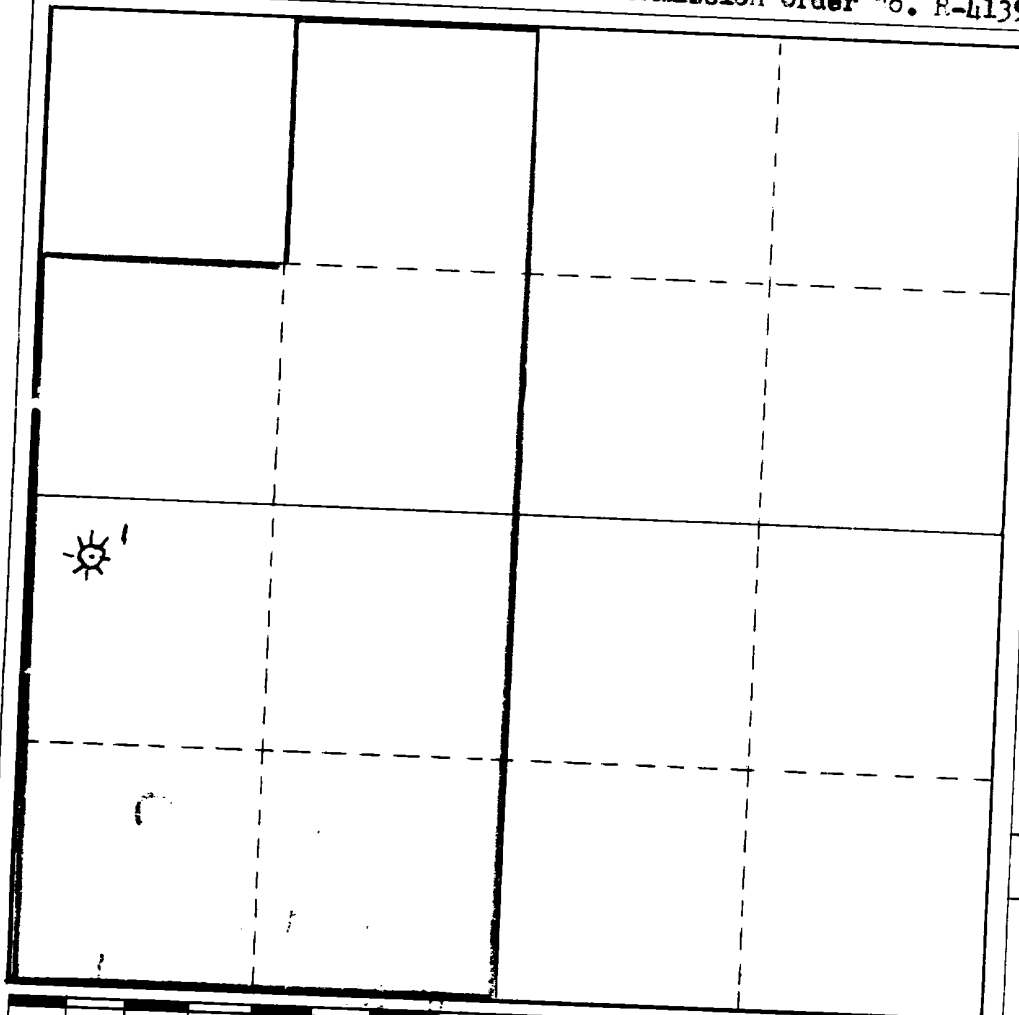

CERTIFICATION

I hereby certify that the information contained herein is true and complete to the best of my knowledge and belief.

Name **H.S. Freedman**

Position **Prod. Engr.**

Company **Wolfson Oil Co.**

Date **May 13, 1971**

I hereby certify that the well location shown on this plat was plotted from field notes of actual surveys made by me or under my supervision, and that the same is true and correct to the best of my knowledge and belief.

Date Surveyed \_\_\_\_\_

Registered Professional Engineer and/or Land Surveyor

Certificate No. \_\_\_\_\_

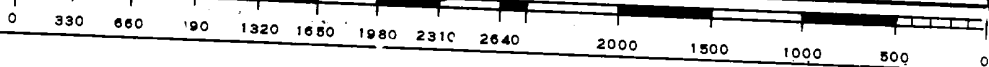

100-100000

RECEIVED

MAY 14 1971

OIL CONSERVATION COMM.  
HOBBS, N. M.