

UNITED STATES  
DEPARTMENT OF THE INTERIOR  
GEOLOGICAL SURVEY

## APPLICATION FOR PERMIT TO DRILL, DEEPEN, OR PLUG BACK

## 1a. TYPE OF WORK

DRILL ☒DEEPEN ☐PLUG BACK ☐

## 5. LEASE DESIGNATION AND SERIAL NO.

NM 0195029

## 6. IF INDIAN, ALLOTTEE OR TRIBE NAME

## 7. UNIT AGREEMENT NAME

## 8. FARM OR LEASE NAME

Merchant-B

## 9. WELL NO.

1

## 10. FIELD AND POOL, OR WILDCAT

Undesignated - Morrow

11. SEC., T., R., M., OR BLK.  
AND SURVEY OR AREA

Sec. 26, T-22-S, R-34-E

## 12. COUNTY OR PARISH

Lea

## 13. STATE

New Mexico

## b. TYPE OF WELL

OIL  
WELL ☐GAS  
WELL ☒

OTHER

SINGLE  
ZONE ☒MULTIPLE  
ZONE ☐

## 2. NAME OF OPERATOR

Phillips Petroleum Company

## 3. ADDRESS OF OPERATOR

Room B-2, Phillips Building, Odessa, Texas 79760

## 4. LOCATION OF WELL (Report location clearly and in accordance with any State requirements.)\*

At surface

660' FE and 1980' FS lines

At proposed prod. zone

## 14. DISTANCE IN MILES AND DIRECTION FROM NEAREST TOWN OR POST OFFICE\*

20 miles SW Eunice, New Mexico

## 15. DISTANCE FROM PROPOSED\*

LOCATION TO NEAREST  
PROPERTY OR LEASE LINE, FT.  
(Also to nearest drlg. unit line, if any)

660'

## 16. NO. OF ACRES IN LEASE

2560

17. NO. OF ACRES ASSIGNED  
TO THIS WELL

320

## 18. DISTANCE FROM PROPOSED LOCATION\*

TO NEAREST WELL, DRILLING, COMPLETED,  
OR APPLIED FOR, ON THIS LEASE, FT.

--

## 19. PROPOSED DEPTH

13,500'

## 20. ROTARY OR CABLE TOOLS

Rotary

## 21. ELEVATIONS (Show whether DF, RT, GR, etc.)

later

## 22. APPROX. DATE WORK WILL START\*

Upon approval

## 23.

## PROPOSED CASING AND CEMENTING PROGRAM

SIZE OF HOLE	SIZE OF CASING	WEIGHT PER FOOT	SETTING DEPTH	QUANTITY OF CEMENT
20"	16	65#	350'	400, Circulated
13-3/4"	10-3/4	51#	5700'	Sufficient, Base of salt
9-5/8"	7-5/8(liner)	26.4#	11600'	Sufficient, Tie back to 10-3/4 csg.
6-3/4"	5-1/2(liner)	17#, 20#, 23#	13500'	Sufficient, Tie back to 7-5/8 csg.
(Tie Back 5-1/2")				

Use mud additives as required for control.

Series 900 BOP to 5700', Series 1500 BOP, 5700' to T.D.

NOTED: USED IN SUFFICIENT TIME TO  
WELD INVENTING THE 10 3/4" CASING.

IN ABOVE SPACE DESCRIBE PROPOSED PROGRAM: If proposal is to deepen or plug back, give data on present productive zone and proposed new productive zone. If proposal is to drill or deepen directionally, give pertinent data on subsurface locations and measured and true vertical depths. Give blowout preventer program, if any.

## 24.

SIGNED

W. J. Mueller

TITLE

Senior Reservoir Engineer

DATE

July 20, 1971

(This space for Federal or State office use)

PERMIT NO.

APPROVAL DATE

APPROVED BY

TITLE

DATE

CONDITIONS OF APPROVAL, IF ANY:

RECEIVED

JUL 27 1971

OIL CONSERVATION COMM.  
HOBBS, N. M.

NEW MEXICO OIL CONSERVATION COMMISSION  
WELL LOCATION AND ACREAGE DEDICATION PLAT

Form C-102  
Supersedes C-128  
Effective 1-1-65

All distances must be from the outer boundaries of the Section

Operator <b>PHILLIPS PETROLEUM CO.</b>			Lease <b>MERCHANT-B</b>		Well No. <b>1</b>
Unit Letter <b>I</b>	Section <b>26</b>	Township <b>22 SOUTH</b>	Range <b>34 EAST</b>	County <b>LEA</b>	
Actual Footage Location of Well: <b>660</b> feet from the <b>EAST</b> line and <b>1980</b> feet from the <b>SOUTH</b> line					
Ground Level Elev. <b>Later</b>	Producing Formation <b>Morrow - gas</b>	Pool <b>Undesignated - Morrow</b>	Dedicated Acreage: <b>320</b> Acres		

1. Outline the acreage dedicated to the subject well by colored pencil or hachure marks on the plat below.

2. If more than one lease is dedicated to the well, outline each and identify the ownership thereof (both as to working interest and royalty).

NOTE: See lease ownership, royalty ownership and tract description on reverse side.

3. If more than one lease of different ownership is dedicated to the well, have the interests of all owners been consolidated by communitization, unitization, force-pooling, etc?

☐ Yes ☒ No If answer is "yes," type of consolidation **-**

If answer is "no," list the owners and tract descriptions which have actually been consolidated. (Use reverse side of this form if necessary.) **None**

No allowable will be assigned to the well until all interests have been consolidated (by communitization, unitization, forced-pooling, or otherwise) or until a non-standard unit, eliminating such interests, has been approved by the Commission.

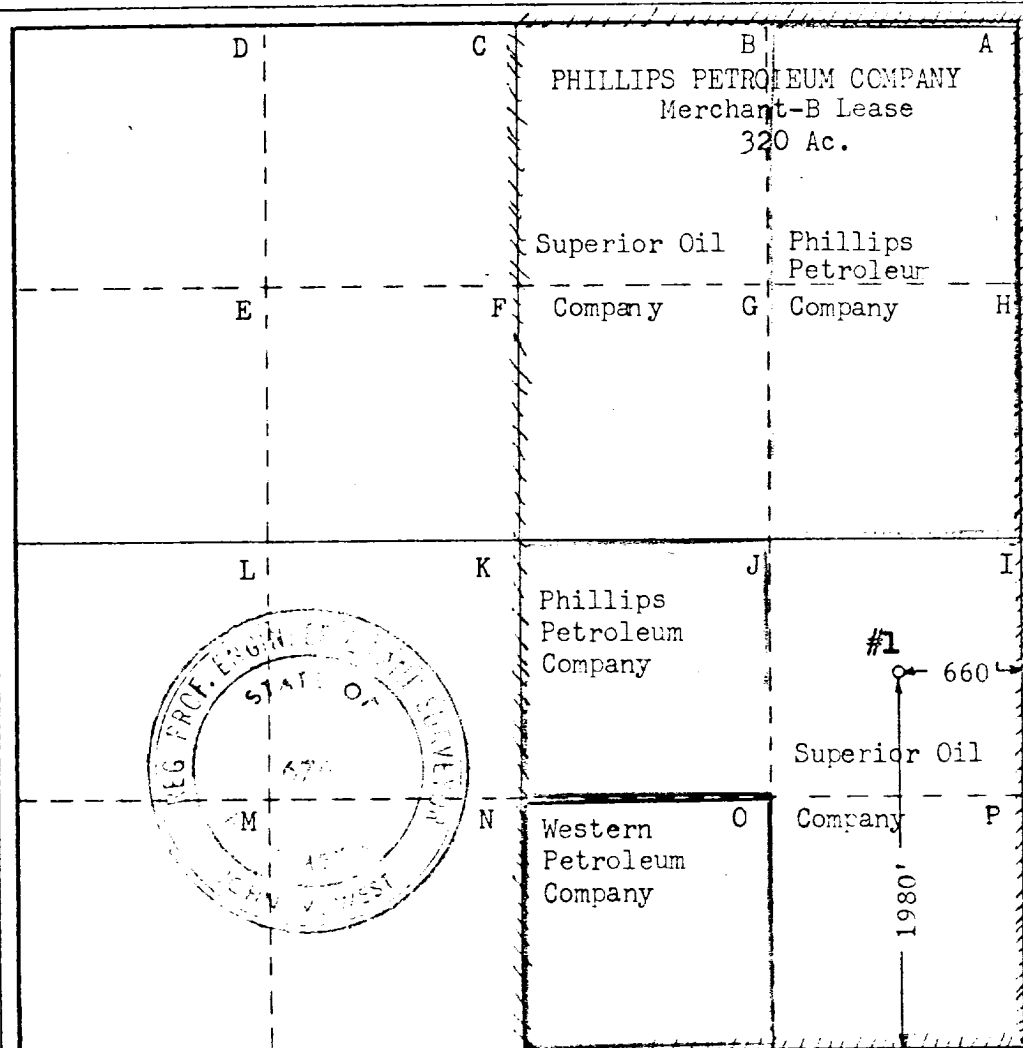

CERTIFICATION

I hereby certify that the information contained herein is true and complete to the best of my knowledge and belief.

*W. J. Mueller*  
Name  
W. J. Mueller

Position  
Senior Reservoir Engineer

Company  
Phillips Petroleum Company

Date  
July 13, 1971

I hereby certify that the well location shown on this plat was plotted from field notes of actual surveys made by me or under my supervision, and that the same is true and correct to the best of my knowledge and belief.

Date Surveyed  
JULY 6, 1971

Registered Professional Engineer and/or Land Surveyor

*John W. West*  
Signature

320 acre proration unit assigned this well consists of the below listed lease tracts, with Phillips Petroleum Company as the designated lease operator:

<u>Lease Tract:</u>	<u>WI Owner:</u>	<u>RI Owner:</u>
W/2 NE/4	Superior Oil Company	United States of America
E/2 SE/4	Superior Oil Company	United States of America
E/2 NE/4	Phillips Petroleum Company	United States of America
NW/4 SE/4	Phillips Petroleum Company	United States of America
SW/4 SE/4	Western Petroleum Company	United States of America

RECEIVED

JUL 27 1971

OIL CONSERVATION COMM.  
HOBBS, N. M.

173