

Submit to Appropriate
District Office
State Lease-6 copies
Fee Lease-6 copies

State of New Mexico
Energy, Minerals and Natural Resources Department

Form C-101
Revised 1-1-89

OIL CONSERVATION DIVISION

P.O. Box 2088
Santa Fe, New Mexico 87504-2088

DISTRICT I

P.O. Box 1980, Hobbs, NM 88240

DISTRICT II

P.O. Drawer Dd, Artesia, NM 88210

DISTRICT III

1000 Rio Brazos Rd., Aztec, Nm 87410

API NO. (assigned by OCD on New Wells)

30-025-24021

5. Indicate Type of Lease

STATE

☐ FEE

☒

6. State Oil & Gas Lease No.

N/A

7. Lease Name or Unit Agreement Name

ARROWHEAD GRAYBURG UNIT

8. Well No.

146

9. Pool name or Wildcat

ARROWHEAD/GB

APPLICATION FOR PERMIT TO DRILL, DEEPEN, OF PLUG BACK

1a. Type of Work:

DRILL ☐

RE-ENTER ☐

DEEPEN ☒

PLUG BACK ☐

b. Type of Well:

OIL

GAS

OTHER

SINGLE

MULTIPLE

WELL ☒

WELL ☐

ZONE ☐

ZONE ☐

2. Name of Operator

CHEVRON U.S.A. INC.

3. Address of Operator

P.O. BOX 1150, MIDLAND, TX 79702 ATTN: P.R. MATTHEWS

4. Well Location

Unit Letter A : 660 Feet From The NORTH Line and 660 Feet From The EAST Line
Section: 1 Township 22S Range 36E NMPM LEA County

10. Proposed depth

4500'

11. Formation

GRAYBURG

12. Rotary or C.T.

ROTARY

13. Elevation (Show DF, RT, GR, etc.)

3476 GE

14. Kind & Status Plug Bond

BLANKET

15. Drig Contractor

UNKNOWN

16. Date Work will start

'04-15-92

17 EXISTING CASING AND CEMENT PROGRAM

SIZE OF HOLE	SIZE OF CASING	WEIGHT PER FOOT	SETTING DEPTH	SACKS OF CEMENT	EST. TOP
UNK.	8 5/8"	24	358	200	SURFACE
UNK.	5 1/2"	15.5	3900'	425	'2158' CAL.

DEEPEN TO 4500' WITH BIT AND UNDERREAM TO 6 1/2".
LOG, PERF AND ACIDIZE.
2000 PSI BOPE.
MIST AND BRINE WATER MUD SYSTEM.
WELL NAME FORMER NAME CHEVRON H.T. MATTERN (NCT-F) #2.

IN ABOVE SPACE DESCRIBE PROPOSED PROG IF PROPOSAL IS TO DEEPEN OR PLUG BACK, GIVE DATA ON PRESENT PRODUCTIVE ZONE AND PROPOSED
NEW PRODUCTIVE ZONE. GIVE BLOWOUT PREVENTER PROGRAM, IF ANY.

I hereby certify that the information above is true and complete to the best of my knowledge and belief.

SIGNATURE

P.R. Matthews

TITLE

TECHNICAL ASSISTANT

DATE

'03-16-92

TYPE OR PRINT NAME

P.R. MATTHEWS

TELEPHONE NO.

(915)687-7812

APPROVED BY

ORIGINAL SIGNED BY JERRY SEXTON

TITLE

DATE

MAR 19

CONDITIONS OF APPROVAL, IF ANY:

RECEIVED

MAR 16 1992

CD HOBBS 07000

Submit to Appropriate
District Office
State Lease-6 copies
Fee Lease-5 copies

State of New Mexico
Energy, Minerals and Natural Resources Department

Form C-101
Revised 1-1-89

OIL CONSERVATION DIVISION

P.O. Box 2088
Santa Fe, New Mexico 87504-2088

DISTRICT I

P.O. Box 1980, Hobbs, NM 88240

DISTRICT II

P.O. Drawer Dd, Artesia, NM 88210

DISTRICT III

1000 Rio Brazos Rd., Aztec, Nm 87410

API NO. (assigned by OCD on New Wells)

30-025-24021

5. Indicate Type of Lease

STATE

☐ FEE

☒

6. State Oil & Gas Lease No.

N/A

APPLICATION FOR PERMIT TO DRILL, DEEPEN, OF PLUG BACK

1a. Type of Work:

DRILL ☐

RE-ENTER ☐

DEEPEN ☒

PLUG BACK ☐

b. Type of Well:

OIL
WELL ☒

GAS
WELL ☐

OTHER
SINGLE
ZONE ☐

MULTIPLE
ZONE ☐

2. Name of Operator

CHEVRON U.S.A. INC.

3. Address of Operator

P.O. BOX 1150, MIDLAND, TX 79702 ATTN: P.R. MATTHEWS

4. Well Location

Unit Letter A : 660 Feet From The NORTH Line and 660 Feet From The EAST Line
Section 1 Township 22S Range 36E NMPM LEA County

7. Lease Name or Unit Agreement Name

ARROWHEAD GRAYBURG UNIT

8. Well No.

146

9. Pool name or Wildcat

ARROWHEAD/GB

10. Proposed depth

4500'

11. Formation

GRAYBURG

12. Rotary or C.T.

ROTARY

13. Elevation (Show DF,RT, GR, etc.)

3476 GE

14. Kind & Status Plug Bond

BLANKET

15. Drig Contractor

UNKNOWN

16. Date Work will start

'04-15-92

17. EXISTING CASING AND CEMENT PROGRAM

SIZE OF HOLE	SIZE OF CASING	WEIGHT PER FOOT	SETTING DEPTH	SACKS OF CEMENT	EST. TOP
UNK.	8 5/8"	24	358	200	SURFACE
UNK.	5 1/2"	15.5	3900'	425	'2158' CAL.

DEEPEN TO 4500' WITH BIT AND UNDERREAM TO 6 1/2".
LOG, PERF AND ACIDIZE.
2000 PSI BOPE.
MIST AND BRINE WATER MUD SYSTEM.
WELL NAME FORMER NAME CHEVRON H.T. MATTERN (NCT-F) #2.

IN ABOVE SPACE DESCRIBE PROPOSED PROG IF PROPOSAL IS TO DEEPEN OR PLUG BACK, GIVE DATA ON PRESENT PRODUTIVE ZONE AND PROPOSED
NEW PRODUCTIVE ZONE. GIVE BLOWOUT PREVENTER PROGRAM, IF ANY.

I hereby certify that the information above is true and complete to the best of my knowledge and belief.

SIGNATURE P.R. Matthews TITLE

TECHNICAL ASSISTANT

DATE

'03-16-92

TYPE OR PRINT NAME P.R. MATTHEWS

TELEPHONE NO.

(915)687-7812

APPROVED BY ORIGINAL SIGNED BY JERRY SEXTON TITLE

DATE

MAR 19

CONDITIONS OF APPROVAL, IF ANY:

RECEIVED

MAR 16 1992

JOHN HOBBS OFFICE

Submit to Appropriate
District Office
State Lease - 4 copies
Fee Lease - 3 copies

State of New Mexico
Energy, Minerals and Natural Resources Department

Form C-102
Revised 1-1-89

OIL CONSERVATION DIVISION

P.O. Box 2088
Santa Fe, New Mexico 87504-2088

DISTRICT I
P.O. Box 1980, Hobbs, NM 88240

DISTRICT II
P.O. Drawer DD, Artesia, NM 88210

DISTRICT III
1000 Rio Brazos Rd., Aztec, NM 87410

WELL LOCATION AND ACREAGE DEDICATION PLAT

All Distances must be from the outer boundaries of the section

Operator CHEVRON U.S.A. INC.			Lease ARROWHEAD GRAYBURG UNIT		Well No. 146
Unit Letter A	Section 1	Township 22S	Range 36E	County LEA	
Actual Footage Location of Well: 660 feet from the NORTH line and 660 feet from the EAST line					
Ground level Elev. 3476 GE		Producing Formation GRAYBURG		Pool ARROWHEAD	Dedicated Acreage: 40 Acres

1. Outline the acreage dedicated to the subject well by colored pencil or hatchure marks on the plat below.
2. If more than one lease is dedicated to the well, outline each and identify the ownership thereof (both as to working interest and royalty).
3. If more than one lease of different ownership is dedicated to the well, have the interest of all owners been consolidated by communitization, unitization, force-pooling, etc.?
☐ Yes ☐ No If answer is "yes" type of consolidation _____
If answer is "no" list the owners and tract descriptions which have actually been consolidated. (Use reverse side of this form if necessary.)
No allowable will be assigned to the well until all interests have been consolidated (by communitization, unitization, forced-pooling, or otherwise) or until a non-standard unit, eliminating such interest, has been approved by the Division.

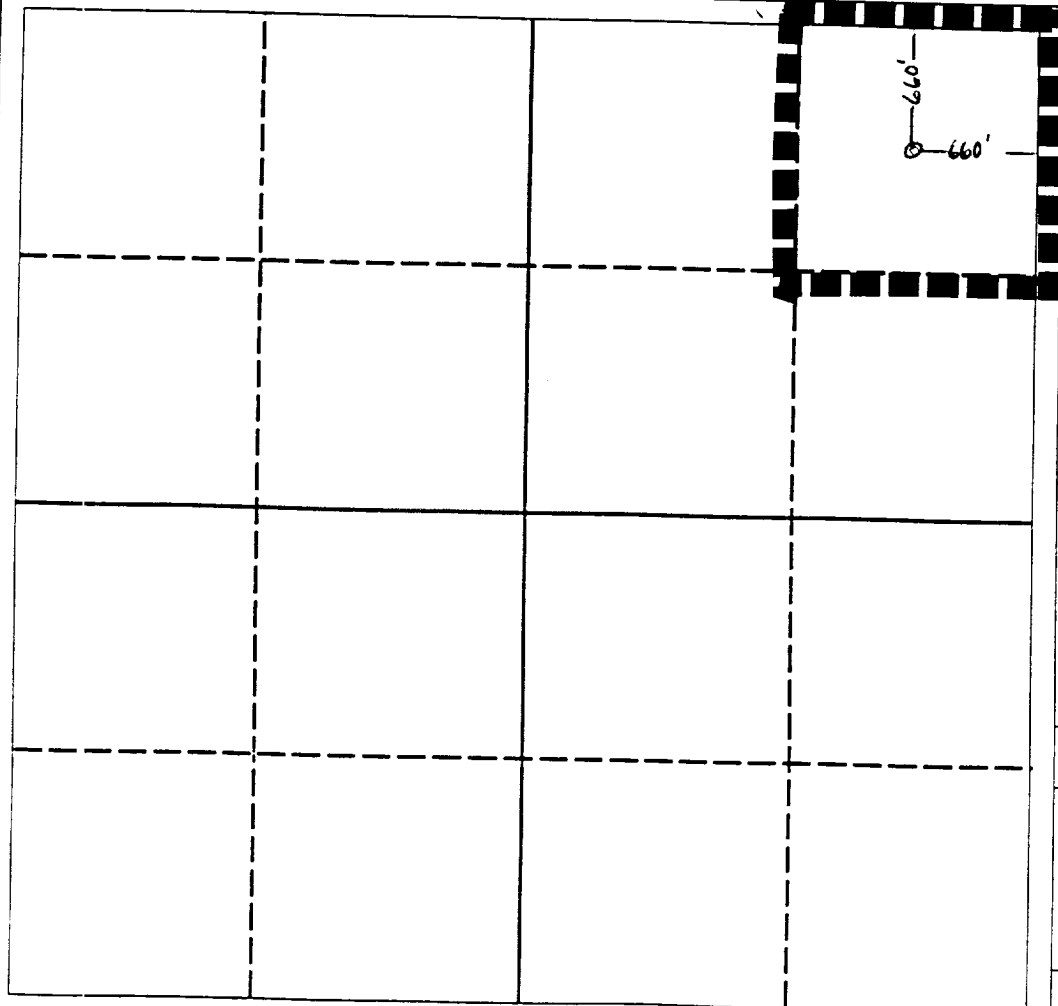

OPERATOR CERTIFICATION

I hereby certify that the information contained herein is true and complete to the best of my knowledge and belief.

Signature

P.R. Matthews

Printed Name

P.R. MATTHEWS

Position

TECHNICAL ASSISTANT

Company

CHEVRON U.S.A. INC.

Date

3-16-92

SURVEYOR CERTIFICATION

I hereby certify that the well location shown on this plat was plotted from field notes of actual surveys made by me or under my supervision, and that the same is true and correct to the best of my knowledge and belief.

Date Surveyed

Signature & Seal of
Professional Surveyor

Certificate No.

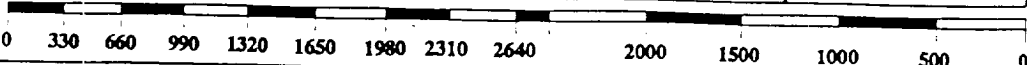

RECEIVED

MAR 18 1992

CD HOEBS 00000