

Belco Petroleum Corporation

December 27, 1973

Belco

United States Geological Survey
Post Office Box 1157
Hobbs, New Mexico 88240

Re: Belco Petroleum Corporation
Federal False No. 1
1980' FEL & 660' FSL
Section 33, T-22-S, R-34-E
Lea County, New Mexico

Gentlemen:

1. Existing Roads - Black top road from Eunice to Jal. Loving highway is the nearest existing road.
2. Planned Access Roads - It is planned to use the existing ranch road which lays approximately 200' to the south of the location.
3. Location of Wells - This is the only well in the immediate area.
4. Lateral Roads to Well Locations - There are no well locations.
5. Location of Tank Batteries and Flowlines - In case of production, any tank battery or necessary producing facility would be placed upon the drilling pad.
6. Location and Types of Water Supply - There is no ground water available in the area and water will have to be purchased from a commercial source and trucked to the location.
7. Methods for Handling Waste Disposal - It is planned to build an 8' X 4' X 4' waste pit next to the reserve pit in which to dispose of all waste. The waste will be covered upon completion of the well.
8. Proposed Disposition of Produced Brine Water - Subject well is a gas prospect and no water production is anticipated; however, any produced brine water would be disposed of by hauling to a commercial water disposal well.
9. Disposition of Casinghead Gas - There is a ready market in the area for casinghead gas and the low pressure casinghead gas will be sold.

United States Geological Survey
Belco Petroleum Corporation #1 Federal False
December 27, 1973

Page -2-

10. Location Layout - Attached is a diagram of the location showing the position of the various components of the system.
11. Plans for Restoration of the Surface - In case of a dry hole or upon abandonment of the well, all pits and cellars will be filled and leveled. The location will be leveled as nearly as possible to original top ground contour with all dead men removed, all junk and trash disposed.

Very truly yours,

BELCO PETROLEUM CORPORATION

Glenn Cope
District Engineer

GC/s1

Attachments

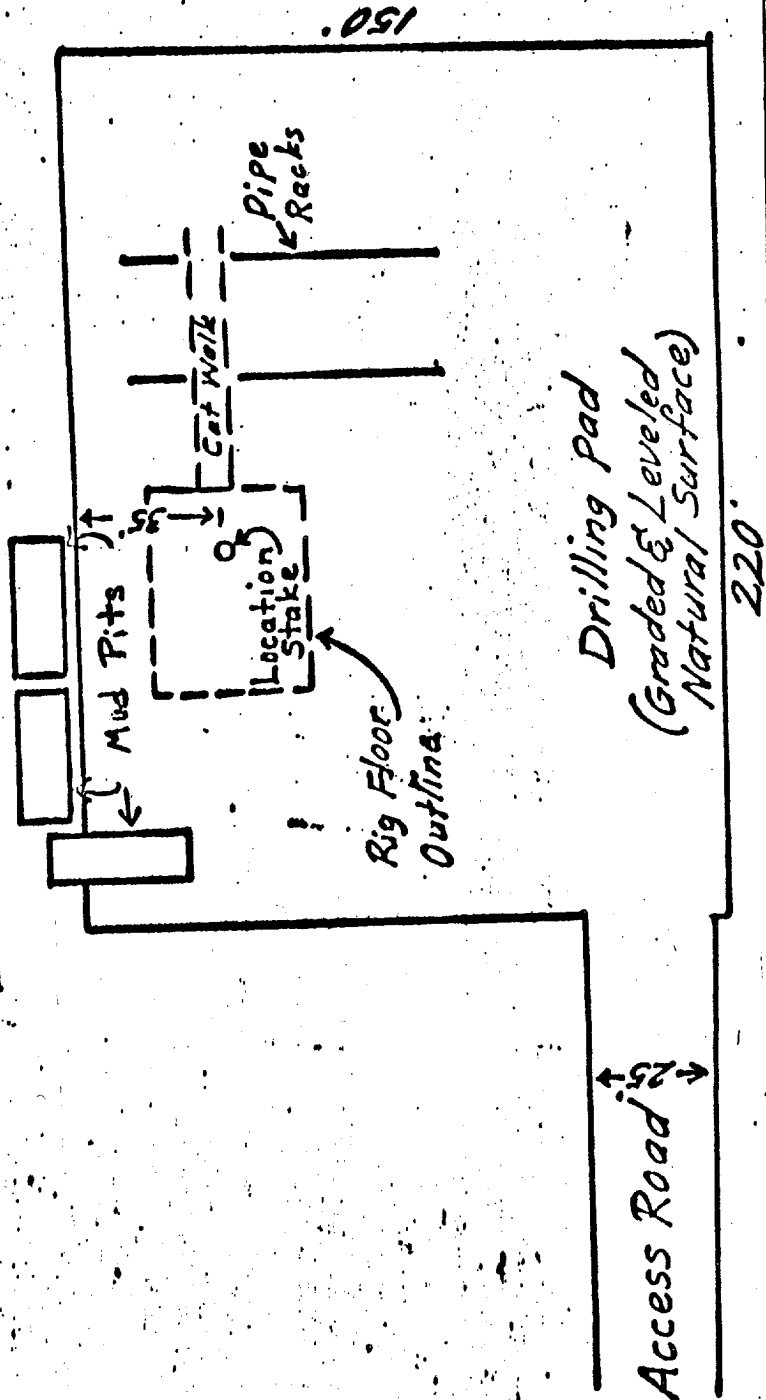
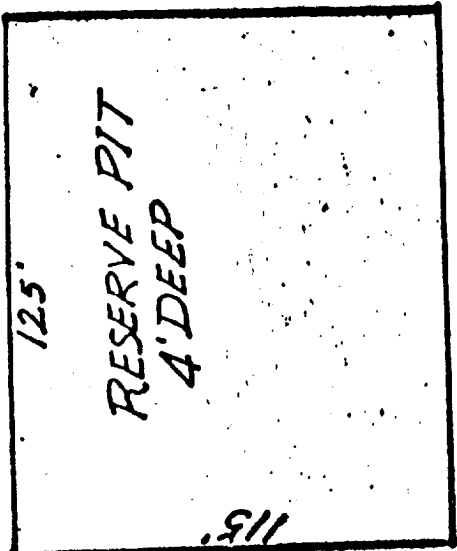

BELCO PETROLEUM CORPORATION

FEDERAL FALSE NO. 1
1980' FEL & 660' FSL
Section 33, T-22-S, R-34-E
Lea County, New Mexico
Scale: 1" = 50'

PLAT NO.

