

NO. OF COPIES RECEIVED	
DISTRIBUTION	
SANTA FE	
FILE	
U.S.G.S.	
LAND OFFICE	
OPERATOR	

# NEW MEXICO OIL CONSERVATION COMMISSION

Form C-101  
Revised 1-4-65

5A. Indicate Type of Lease	
STATE <input checked="" type="checkbox"/>	FEE <input type="checkbox"/>
5. State Oil & Gas Lease No.	
A 2614	

## APPLICATION FOR PERMIT TO DRILL, DEEPEN, OR PLUG BACK

1a. Type of Work		7. Unit Agreement Name	
b. Type of Well OIL WELL <input type="checkbox"/> GAS WELL <input checked="" type="checkbox"/> OTHER <input type="checkbox"/>		8. Farm or Lease Name McDonald State WN	
2. Name of Operator Atlantic Richfield Company		9. Well No. 23	
3. Address of Operator P. O. Box 1710, Hobbs, New Mexico 88240		10. Field and Pool, or Wildcat Jalmat	
4. Location of Well UNIT LETTER <u>C</u> LOCATED <u>660</u> FEET FROM THE <u>North</u> LINE AND <u>1980</u> FEET FROM THE <u>West</u> LINE OF SEC. <u>15</u> TWP. <u>22S</u> RGE. <u>36E</u> NMPM		12. County Lea	
19. Proposed Depth 3710		19A. Formation Yates	
20. Rotary or C.T. Rotary		21. Elevations (Show whether DF, RT, etc.) To be reported	
21A. Kind & Status Plug. Bond Bond #8 GCA		21B. Drilling Contractor Not selected	
22. Approx. Date Work will start 2/4/74			

23.

### PROPOSED CASING AND CEMENT PROGRAM

SIZE OF HOLE	SIZE OF CASING	WEIGHT PER FOOT	SETTING DEPTH	SACKS OF CEMENT	EST. TOP
12-1/4	7-5/8	26.4	400	Circ to surface	
6-1/4	4-1/2	9.5	3600	300 sx	2500

We propose to drill a well as outlined above to test the producing capabilities of the Jalmat Yates Gas zone. Two ram hydraulic BOP's will be used on the 7-5/8" csg string.

APPROVAL VALID  
FOR 90 DAYS UNLESS  
DRILLING COMMENCED,

EXPIRES 4-25-74

IN ABOVE SPACE DESCRIBE PROPOSED PROGRAM: IF PROPOSAL IS TO DEEPEN OR PLUG BACK, GIVE DATA ON PRESENT PRODUCTIVE ZONE AND PROPOSED NEW PRODUCTIVE ZONE. GIVE BLOWOUT PREVENTER PROGRAM, IF ANY.

I hereby certify that the information above is true and complete to the best of my knowledge and belief.

Signed La Ray Knott Title Drilling Engineer Date 1/25/74

(This space for State Use)

APPROVED BY [Signature] TITLE  DATE

CONDITIONS OF APPROVAL, IF ANY:

**MEXICO OIL CONSERVATION COMMISSION  
WELL LOCATION AND ACREAGE DEDICATION PLAT**

Form C-102  
Supersedes C-128  
Effective 1-1-65

All distances must be from the outer boundaries of the Section.

Operator <b>Atlantic Richfield Company</b>			Lease <b>McDonald State WN</b>		Well No. <b>23</b>
Unit Letter <b>C</b>	Section <b>15</b>	Township <b>22S</b>	Range <b>36E</b>	County <b>Lea</b>	
Actual Footage Location of Well: <div style="display: flex; justify-content: space-between;"> <span><b>660</b> feet from the <b>North</b> line and</span> <span><b>1980</b> feet from the <b>West</b> line</span> </div>					
Ground Level Elev: <b>3539'</b>	Producing Formation <b>Yates</b>	Pool <b>Jalmat</b>		Dedicated Acreage: <b>640</b> Acres	

1. Outline the acreage dedicated to the subject well by colored pencil or hachure marks on the plat below.
2. If more than one lease is dedicated to the well, outline each and identify the ownership thereof (both as to working interest and royalty).
3. If more than one lease of different ownership is dedicated to the well, have the interests of all owners been consolidated by communitization, unitization, force-pooling, etc?

☐ Yes   ☐ No   If answer is "yes," type of consolidation \_\_\_\_\_

If answer is "no," list the owners and tract descriptions which have actually been consolidated. (Use reverse side of this form if necessary.) \_\_\_\_\_

No allowable will be assigned to the well until all interests have been consolidated (by communitization, unitization, forced-pooling, or otherwise) or until a non-standard unit, eliminating such interests, has been approved by the Commission.

**R 36 E**

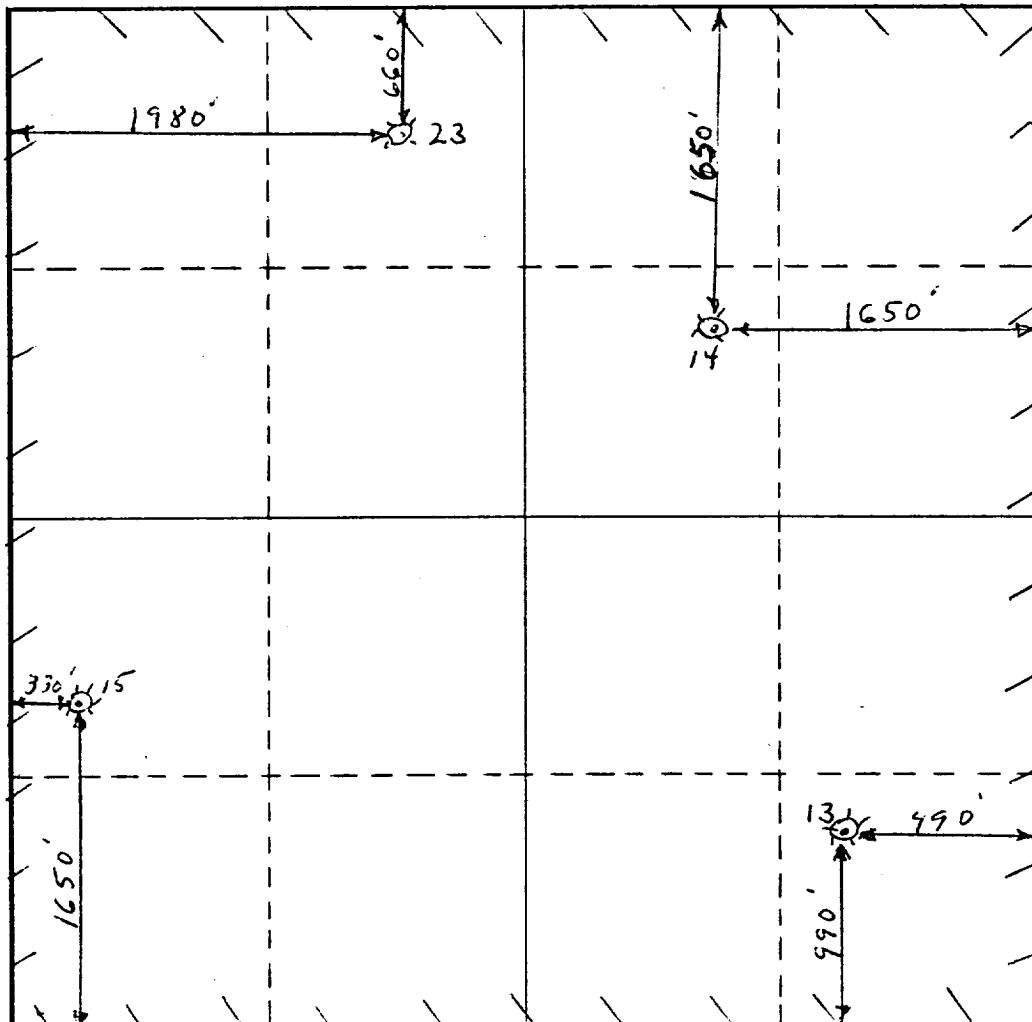

**CERTIFICATION**

I hereby certify that the information contained herein is true and complete to the best of my knowledge and belief.

Name *Thoy Knott*  
Position **Drilling Engineer**  
Company **Atlantic Richfield Company**  
Date **1/24/74**

I hereby certify that the well location shown on this plat was plotted from field notes of actual surveys made by me or under my supervision, and that the same is true and correct to the best of my knowledge and belief.

Date Surveyed *Oct 1, 1973*  
Registered Professional Engineer and/or Land Surveyor *[Signature]*

Certificate No. *642*

T  
22  
S