

NO. OF COPIES RECEIVED	
DISTRIBUTION	
SANTA FE	
FILE	
U.S.G.S.	
LAND OFFICE	
OPERATOR	

NEW MEXICO OIL CONSERVATION COMMISSION

Form C-101
Revised 1-1-65

5A. Indicate Type of Lease STATE <input type="checkbox"/> FEE <input checked="" type="checkbox"/>
5. State Oil & Gas Lease No.
7. Unit Agreement Name
8. Farm or Lease Name H. T. Mattern (NCT-F)
9. Well No. 3
10. Field and Pool, or Wildcat Drinkard
12. County Lea
19. Proposed Depth 6850'
19A. Formation Drinkard
20. Rotary or C.T. Rotary
21. Elevations (Show whether DE, RT, etc.) Blanket
21A. Kind & Status Plug. Bond Blanket
21B. Drilling Contractor
22. Approx. Date Work will start April 1, 1974

APPLICATION FOR PERMIT TO DRILL, DEEPEN, OR PLUG BACK

1a. Type of Work	DRILL <input checked="" type="checkbox"/>	DEEPEN <input type="checkbox"/>	PLUG BACK <input type="checkbox"/>
b. Type of Well	OIL WELL <input checked="" type="checkbox"/>	GAS WELL <input type="checkbox"/>	OTHER <input type="checkbox"/>
2. Name of Operator	Gulf Oil Corporation		
3. Address of Operator	Box 670, Hobbs, New Mexico 88240		
4. Location of Well	UNIT LETTER A LOCATED 800 FEET FROM THE North LINE AND 389 FEET FROM THE East LINE OF SEC. 1 TWP. 22-S RGE. 36-E NMPM		
19. Proposed Depth	6850'		
19A. Formation	Drinkard		
20. Rotary or C.T.	Rotary		
21. Elevations (Show whether DE, RT, etc.)	Blanket		
21A. Kind & Status Plug. Bond	Blanket		
21B. Drilling Contractor			
22. Approx. Date Work will start	April 1, 1974		

PROPOSED CASING AND CEMENT PROGRAM

SIZE OF HOLE	SIZE OF CASING	WEIGHT PER FOOT	SETTING DEPTH	SACKS OF CEMENT	EST. TOP
12-1/4"	9-5/8"	32.30#	1200'	Circulate	
8-3/4"	7"	20#	6850'	500 sacks (Base of Salt)	

APPROVAL MADE
FOR THE STATE OF NEW MEXICO
DRILLING COMMENCED,
EXPIRES June 18, 1974

IN ABOVE SPACE DESCRIBE PROPOSED PROGRAM; IF PROPOSAL IS TO DEEPEN OR PLUG BACK, GIVE DATA ON PRESENT PRODUCTIVE ZONE AND PROPOSED NEW PRODUCTIVE ZONE. GIVE BLOWOUT PREVENTER PROGRAM, IF ANY.

I hereby certify that the information above is true and complete to the best of my knowledge and belief.

Signed W. Borland Title Area Production Manager Date March 18, 1974

(This space for State Use)

APPROVED BY John W. Remyan TITLE _____ DATE _____

CONDITIONS OF APPROVAL, IF ANY:

NEW MEXICO OIL CONSERVATION COMMISSION
WELL LOCATION AND ACREAGE DEDICATION PLAT

Form O-107
Superseded O-128
Effective 1-1-65

All distances must be from the outer boundaries of the Section

GULF OIL CORPORATION		H.T. MATTERN NCT "F"		Well No. 3
Section 1	Township 22 SOUTH	Range 36 EAST	County LEA	
Actual Well Location of Well:				
389	feet from the EAST line and	800	feet from the NORTH line	
Ground Level Elev.	Producing Formation	Pool	Dedicated Acreage	
	Drinkard	Drinkard	40 Acres	

1. Outline the acreage dedicated to the subject well by colored pencil or hachure marks on the plat below.
2. If more than one lease is dedicated to the well, outline each and identify the ownership thereof (both as to working interest and royalty).
3. If more than one lease of different ownership is dedicated to the well, have the interests of all owners been consolidated by communitization, unitization, force-pooling, etc?

☐ Yes ☐ No If answer is "yes," type of consolidation _____

If answer is "no," list the owners and tract descriptions which have actually been consolidated. (Use reverse side of this form if necessary.) _____

No allowable will be assigned to the well until all interests have been consolidated (by communitization, unitization, forced-pooling, or otherwise) or until a non-standard unit, eliminating such interests, has been approved by the Commission.

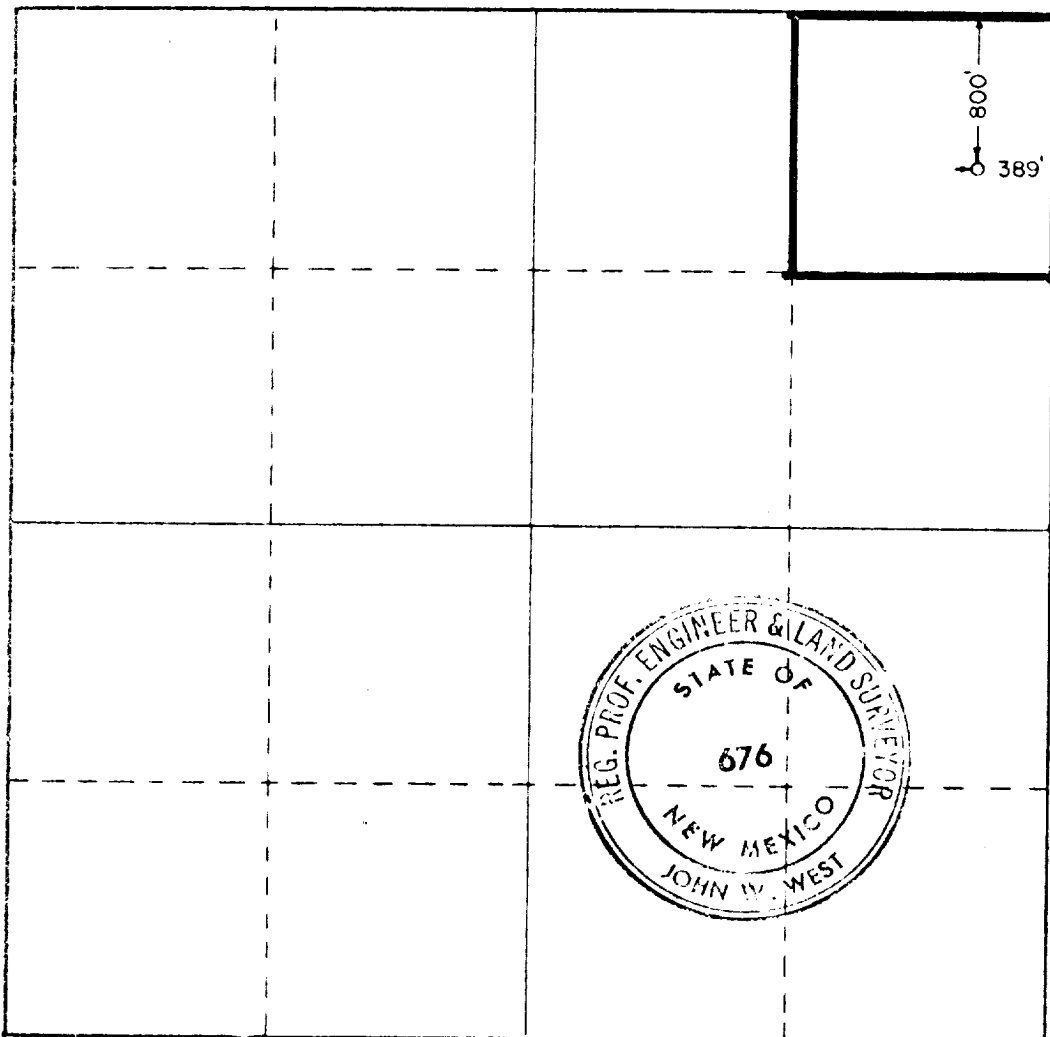

CERTIFICATION

I hereby certify that the information contained herein is true and complete to the best of my knowledge and belief.

C. D. Borland

Name
C. D. BORLAND
Position
Area Production Manager
Company
Gulf Oil Corporation
Date
March 18, 1974

I hereby certify that the well location shown on this plat was plotted from field notes of actual surveys made by me or under my supervision, and that the same is true and correct to the best of my knowledge and belief.

Date Surveyed
MARCH 15, 1974
Registered Professional Engineer and/or Land Surveyor

John W. West
Certificate No. 676

0 330 660 990 1320 1650 1980 2310 2640 2000 1500 1000 500 0