

NEW MEXICO OIL CONSERVATION COMMISSION  
WELL LOCATION AND ACREAGE DEDICATION PLAT

Form C-112  
Supersedes C-112  
Effective 1-1-68

All distances must be from the outer boundaries of the Section

Continental Oil Company			SEMU EUMONT		Well No. 92
Section	Township	Range	County		
C	14	20 SOUTH	37 EAST LEA		

Acres	Section	Township	Range	County
660	NORTH	1980	WEST	
3,556.8'	Eumont Queen	Eumont Box	Dedicated Acreage 40	

1. Outline the acreage dedicated to the subject well by colored pencil or hatchure marks on the plat below.
2. If more than one lease is dedicated to the well, outline each and identify the ownership thereof (both as to working interest and royalty)
3. If more than one lease of different ownership is dedicated to the well, have the interests of all owners been consolidated by communization, unitization, force-pooling, etc?

Yes ☐ No ☐ If answer is "yes," type of consolidation \_\_\_\_\_

If answer is "no," list the owners and tract descriptions which have actually been consolidated. (Use reverse side of this form if necessary) \_\_\_\_\_

No allowable will be assigned to the well until all interests have been consolidated (by communization, unitization, forced-pooling, or otherwise) or until a non-standard unit, eliminating such interests, has been approved by the Commission.

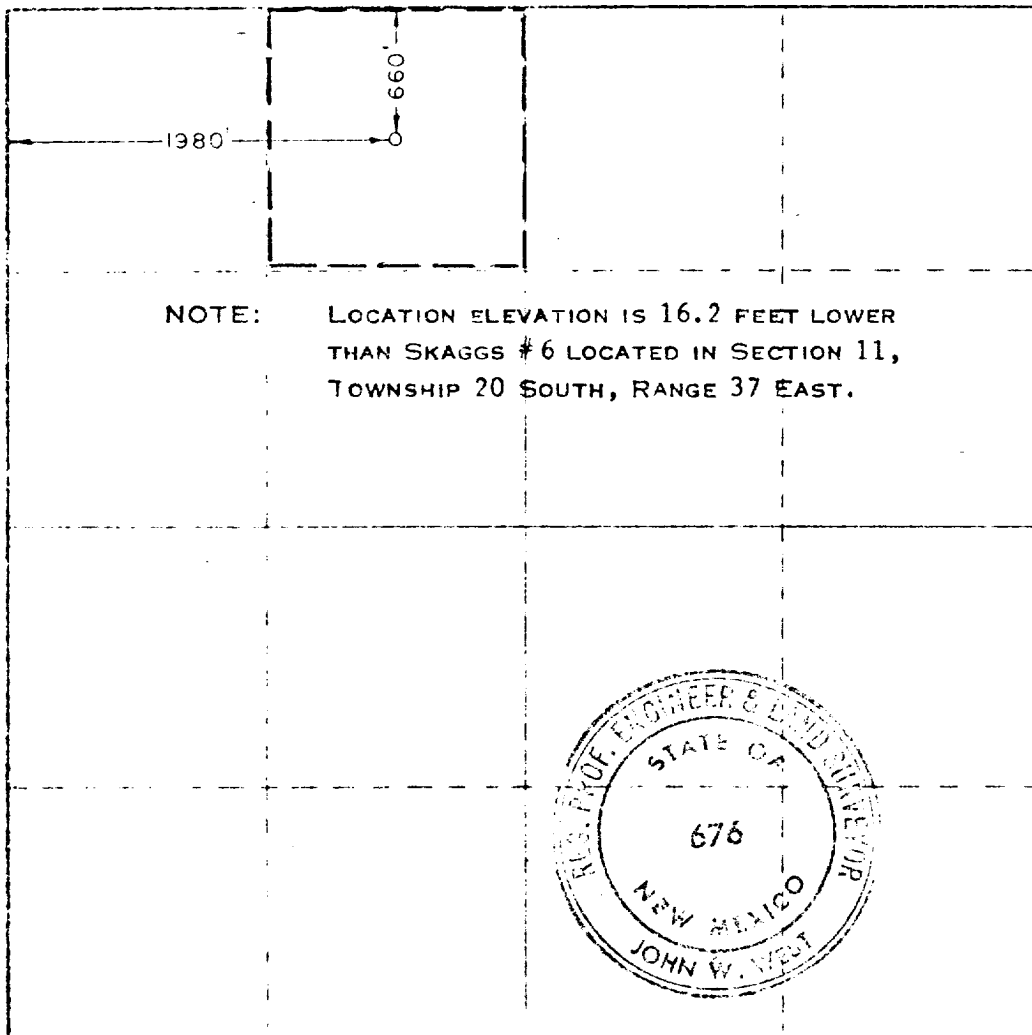

CERTIFICATION

I hereby certify that the information contained herein is true and complete to the best of my knowledge and belief

*Robert Gault III*  
Division Office Manager  
Continental Oil Co.  
May 6, 1974

I hereby certify that the well location shown on this plat was plotted from field notes of actual surveys made by me or under my supervision and that the same is true and correct to the best of my knowledge and belief

Date Certified

APRIL 30, 1974

Registered Professional Engineer  
State of New Mexico

*John W. West*

676