

## NEW MEXICO OIL CONSERVATION COMMISSION

SANTA FE, NEW MEXICO

5-1-61

## APPLICATION FOR MULTIPLE COMPLETION

Operator <u>Continental Oil Company</u>		County <u>Lea</u>	Date <u>7-15-75</u>
Address <u>Box 460, Hobbs, N. M. 88240</u>		Lease <u>Warren Unit</u>	Well No. <u>32</u>
Location or Well <u>P</u>	Unit <u>27</u>	Township <u>20-S</u>	Range <u>38-E</u>

1. Has the New Mexico Oil Conservation Commission heretofore authorized the multiple completion of a well in these same pools or in the same zones within one mile of the subject well? YES X NO
2. If answer is yes, identify one such instance: Order No. R-5025 ; Operator, Lease, and Well No.: Warren Unit A/C 1 No.31

3. The following facts are submitted:	Upper Zone	Intermediate Zone	Lower Zone
a. Name of Pool and Formation	<u>Blinebry Oil &amp; Gas</u>		<u>Warren Tubb Oil</u>
b. Top and Bottom of Pay Section (Perforations)	<u>5850-6000</u>		<u>6600-6700</u>
c. Type of production (Oil or Gas)	<u>Oil</u>		<u>Oil</u>
d. Method of Production (Flowing or Artificial Lift)	<u>Flowing</u>		<u>Pumping</u>

4. The following are attached. (Please mark YES or NO)

- Yes a. Diagrammatic Sketch of the Multiple Completion, showing all casing strings, including diameters and setting depths, centralizers and /or turbolizers and location thereof, quantities used and top of cement, perforated intervals, tubing strings, including diameters and setting depth, location and type of packers and side door chokes, and such other information as may be pertinent.
- Yes b. Plat showing the location of all wells on applicant's lease, all offset wells on offset leases, and the names and addresses of operators of all leases offsetting applicant's lease.
- No c. Waivers consenting to such multiple completion from each offset operator, or in lieu thereof, evidence that said offset operators have been furnished copies of the application. \*
- \* d. Electrical log of the well or other acceptable log with tops and bottoms of producing zones and intervals of perforation indicated thereon. (If such log is not available at the time application is filed, it shall be submitted as provided by Rule 112-A.)

5. List all offset operators on the lease on which this well is located together with their correct mailing address.

Nearest offset operator is more than 1 mile distant.

\* Will follow.

WFOCC-SANTA FE (2) WFOCC-HOBBS (2) FILE

6. Were all operators listed in item 5 above notified and furnished a copy of this application? YES        NO       . If answer is yes, give date of such notification Not required

CERTIFICATE: I, the undersigned, state that I am the Administrative Supervisor Continental Oil Company (company), and that I am authorized by said company to make this report; and that this report was prepared under my supervision and direction and that the facts stated therein are true, correct and complete to the best of my knowledge.

Ralph Family  
Signature

Should waivers from all offset operators not accompany an application for administrative approval, the New Mexico Oil Conservation Commission will hold the application for a period of twenty (20) days from date of receipt by the Commission's Santa Fe office. If, after said twenty-day period, no protest nor request for hearing is received by the Santa Fe office, the application will then be processed.

NOTE: If the proposed multiple completion will result in an unorthodox well location and/or a non-standard production unit in either or both of the producing zones, then separate application for approval of the same should be filed simultaneously with this application.

PROPOSED MULTIPLE COMPLETION  
 Continental Oil Co.  
 Warren Unit #32  
 660 FS1; 660 FEL 27-20S-38E  
 Lea County, New Mexico  
 "0" - 8' AGL

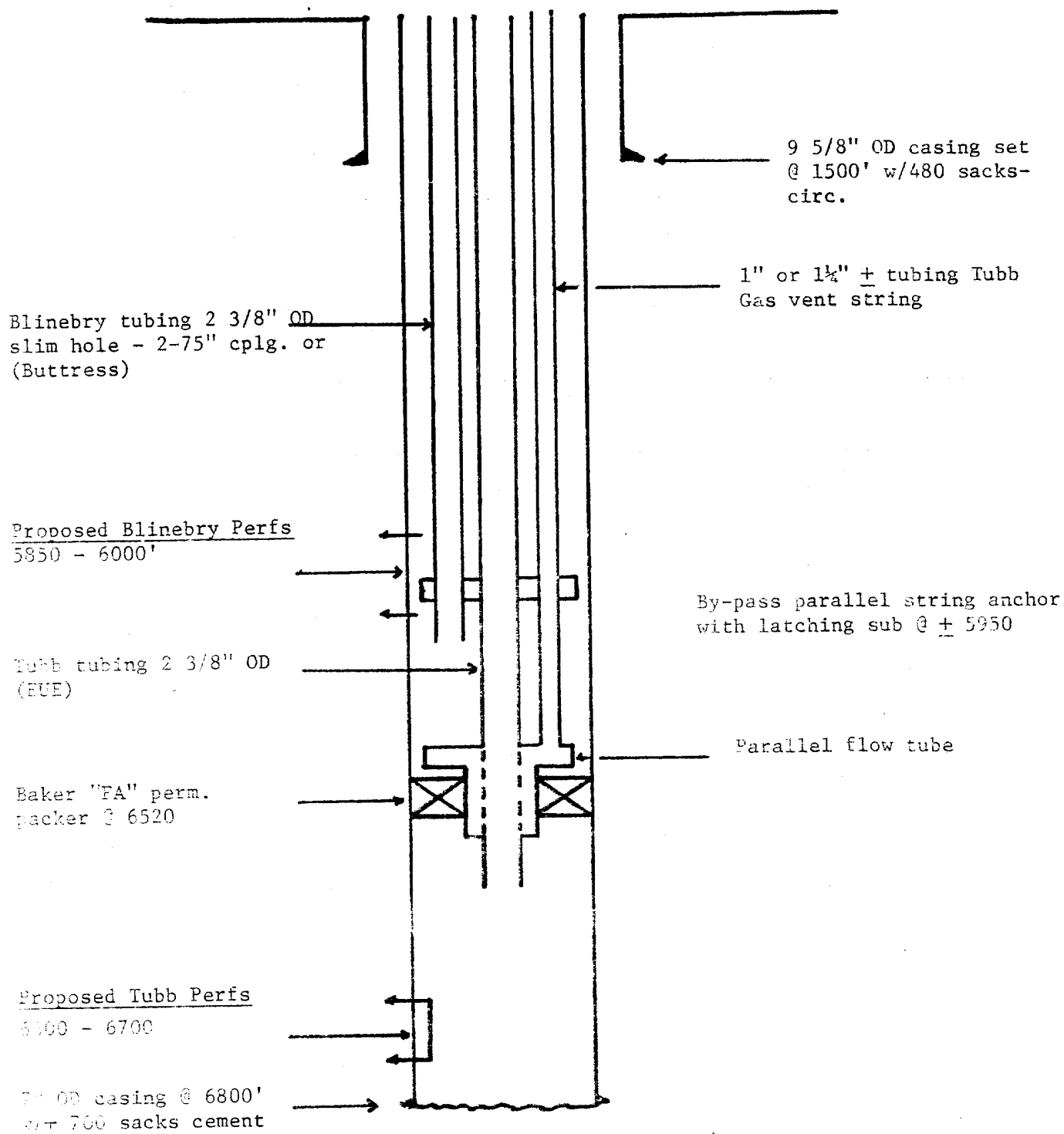

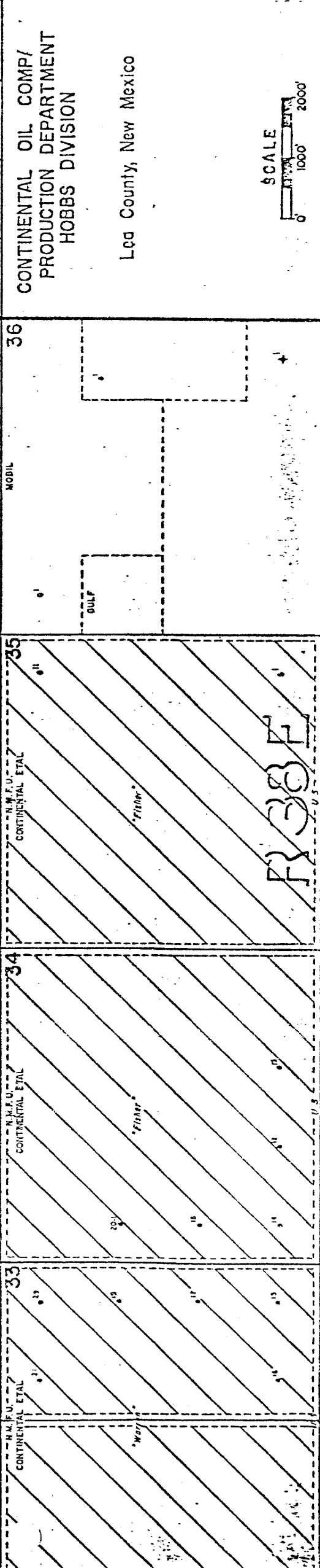
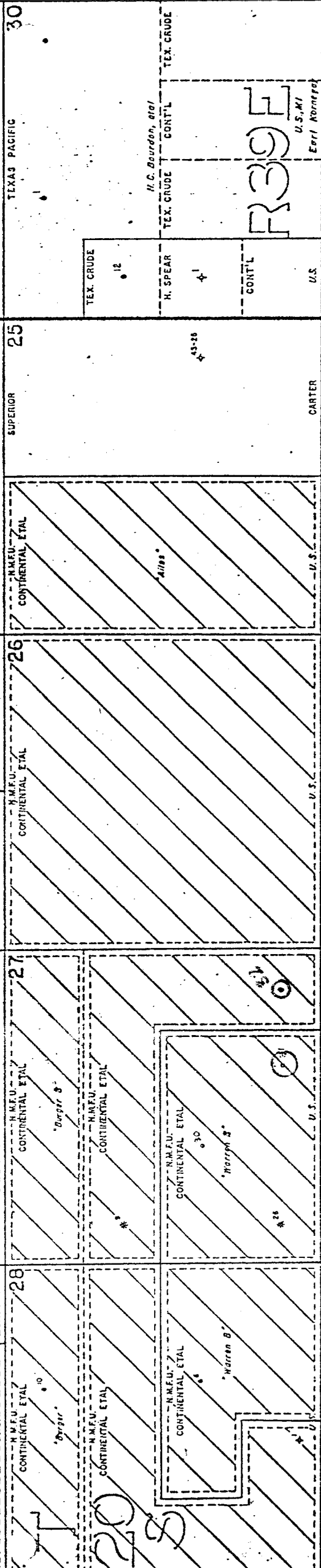
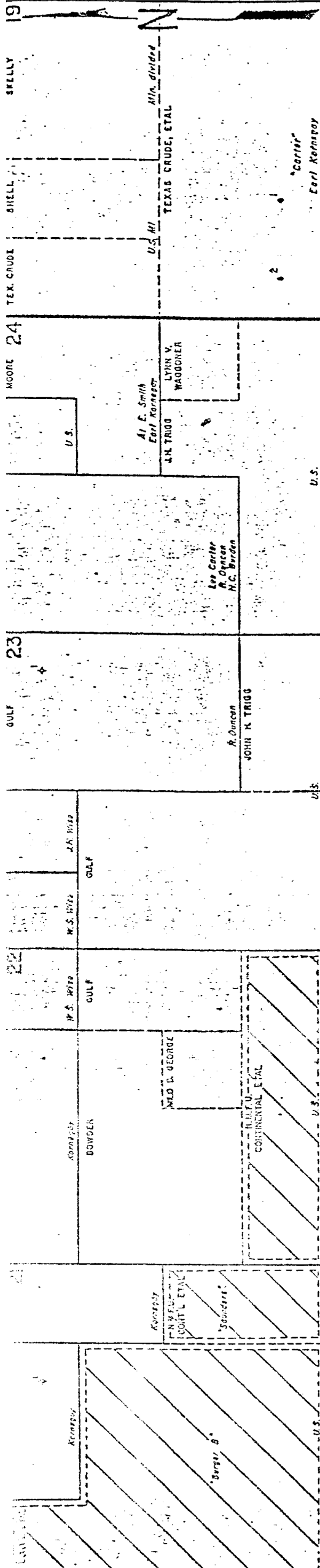

CONTINENTAL OIL COMP/  
PRODUCTION DEPARTMENT  
HOBBS DIVISION

Lea County, New Mexico

