

Submit to Appropriate
District Office
State Lease - 4 copies
Fee Lease - 3 copies

State of New Mexico
Energy, Minerals and Natural Resources Department

30-1 15124
F 02
Rev... 1-89

OIL CONSERVATION DIVISION

P.O. Box 2088
Santa Fe, New Mexico 87504-2088

DISTRICT I

P.O. Box 1980, Hobbs, NM 88240

DISTRICT II

P.O. Drawer DD, Artesia, NM 88210

DISTRICT III

1000 Rio Brazos Rd., Aztec, NM 87410

WELL LOCATION AND ACREAGE DEDICATION PLAT

All Distances must be from the outer boundaries of the section

Operator Conoco Inc.			Lease Warren- Blindery <i>Unit Tubb</i>		Well No. 35
Unit Letter K	Section 28	Township 20S	Range 38E	County NMPM Lea	
Actual Footage Location of Well: 1880 feet from the South line and 1980 feet from the West line					
Ground level Elev. 3531	Producing Formation Tubb		Pool Warren Tubb	Dedicated Acreage: 40 Acres	

1. Outline the acreage dedicated to the subject well by colored pencil or hatchure marks on the plat below.
2. If more than one lease is dedicated to the well, outline each and identify the ownership thereof (both as to working interest and royalty).
3. If more than one lease of different ownership is dedicated to the well, have the interest of all owners been consolidated by communitization, unitization, force-pooling, etc.?
☐ Yes ☐ No If answer is "yes" type of consolidation _____
If answer is "no" list the owners and tract descriptions which have actually been consolidated. (Use reverse side of this form if necessary.) _____
No allowable will be assigned to the well until all interests have been consolidated (by communitization, unitization, forced-pooling, or otherwise) or until a non-standard unit, eliminating such interest, has been approved by the Division.

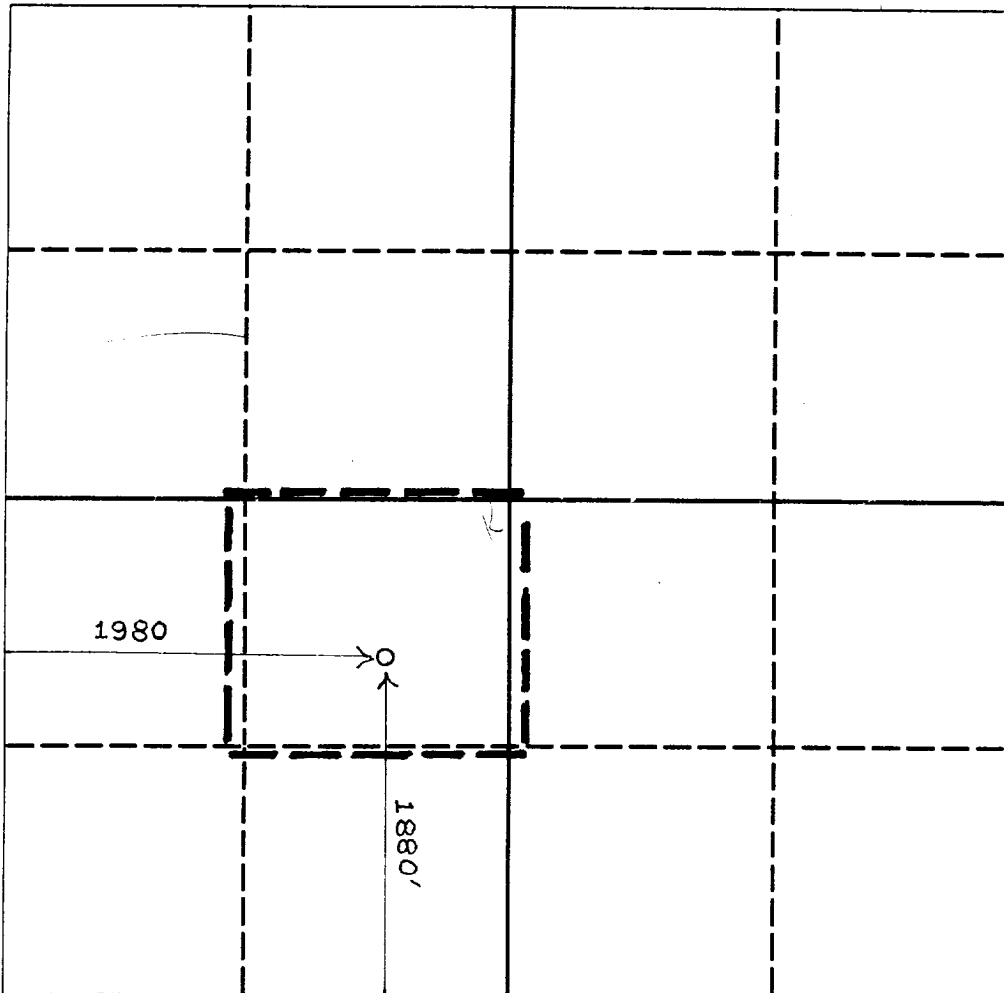

OPERATOR CERTIFICATION

I hereby certify that the information contained herein is true and complete to the best of my knowledge and belief.

Signature

Printed Name

Jerry W. Hoover

Position

Sr. Conservation Coord.

Company

Conoco, Inc.

Date

03-30-92

SURVEYOR CERTIFICATION

I hereby certify that the well location shown on this plat was plotted from field notes of actual surveys made by me or under my supervision, and that the same is true and correct to the best of my knowledge and belief.

Date Surveyed

Signature & Seal of
Professional Surveyor

Certificate No.

Reclassify to oil 4-1-92

Submit 2 copies to Appropriate District Office.
DISTRICT I
P.O. Box 1980, Hobbs, NM 88240
DISTRICT II
P.O. Drawer DD, Artesia, NM 88210
DISTRICT III
1000 Rio Brazos Rd., Aztec, NM 87410

State of New Mexico
Energy, Minerals and Natural Resources Department
OIL CONSERVATION DIVISION
P.O. Box 2088
Santa Fe, New Mexico 87504-2088

Form C-116
Revised 1/1/89

GAS - OIL RATIO TEST

Operator Conoco Inc.		Pool Warren Tubb		County Lea											
Address 10 Desta Dr, Ste 100W, Midland, Tx 79705		TYPE OF TEST - (X) <input checked="" type="checkbox"/> Scheduled <input type="checkbox"/>		Completion <input type="checkbox"/> Special <input checked="" type="checkbox"/>											
LEASE NAME Warren Unit	WELL NO. 35	LOCATION U S T R K 28 20S38E			DATE OF TEST 3/26/92	STATUS	CHOKE SIZE	TBG. PRESS.	DAILY ALLOW-ABLE	LENGTH OF TEST HOURS 24	PROD. DURING TEST			GAS - OIL RATIO CU./FT./BBL.	
		WATER BBL.S.	GRAV. OIL	OIL BBL.S.							GAS M.C.F.				
											1	40.4	1	987	987000

Instructions:

During gas-oil ratio test, each well shall be produced at a rate not exceeding the top unit allowable for the pool in which well is located by more than 25 percent. Operator is encouraged to take advantage of this 25 percent tolerance in order that well can be assigned increased allowables when authorized by the Division.
Gas volumes must be reported in MCF measured at a pressure base of 15.025 psia and a temperature of 60° F. Specific gravity base will be 0.60.
Report casing pressure in lieu of tubing pressure for any well producing through casing.

(See Rule 301, Rule 1116 & appropriate pool rules.)

I hereby certify that the above information is true and complete to the best of my knowledge and belief.

Signature

Jerry W. Hoover, Sr. Conservation

Printed name and title Coordinator

03-30-92 (915) 686-6548

Date Telephone No.