

NO. OF COPIES RECEIVED	
DISTRIBUTION	
SANTA FE	
FILE	
U.S.G.S.	
LAND OFFICE	
OPERATOR	

# NEW MEXICO OIL CONSERVATION COMMISSION

Form 10-11  
Revised 1-1-65

5A. Immediate Type of Operation  
SEAL ☐ PLUG ☒  
5. State of New Mexico

## APPLICATION FOR PERMIT TO DRILL, DEEPEN, OR PLUG BACK

1a. Type of Work b. Type of Well OIL WELL <input type="checkbox"/> GAS WELL <input checked="" type="checkbox"/> OTHER <input type="checkbox"/> SINGLE ZONE <input checked="" type="checkbox"/> MULTIPLE ZONE <input type="checkbox"/>		DRILL <input checked="" type="checkbox"/> DEEPEN <input type="checkbox"/> PLUG BACK <input type="checkbox"/>	7. Unit Equipment Name Central Drinkard Unit
2. Name of Operator Gulf Oil Corporation			8. Farm or Lease Name
3. Address of Operator Box 670, Hobbs, New Mexico 88240			9. Well No. 415
4. Location of Well UNIT LETTER I LOCATED 2212' FEET FROM THE South LINE AND 1146' FEET FROM THE East LINE OF SEC. 28 TWP. 21-S RGE. 37-E NMPM			10. Field and Locality Drinkard (D)
11. Proposed Depth 6485'			12. County Lea
19A. Formation Drinkard			
21. Elevations (Show whether DT, RT, etc.) Blanket		21A. Kind & Status Plug, Bond	22. Date March 15, 1976

## PROPOSED CASING AND CEMENT PROGRAM

SIZE OF HOLE	SIZE OF CASING	WEIGHT PER FOOT	SETTING DEPTH	SACKS OF CEMENT
11"	8-5/8"	24#	1150'	Circulate
7-7/8"	5-1/2"	15.50#	6485'*	Base of Salt

\* Will set DV tool at approximately 1150' and circulate cement.

BOP: See Drawing No. 3 attached.

IN ABOVE SPACE DESCRIBE PROPOSED PROGRAM: IF PROPOSAL IS TO DEEPEN OR PLUG BACK, GIVE DATA ON PRESENT PRODUCTIVE ZONE AND PRO-  
TIVE ZONE. GIVE BLOWOUT PREVENTER PROGRAM, IF ANY.

I hereby certify that the information above is true and complete to the best of my knowledge and belief.

Signed [Signature] Title Area Production Manager Date March 4, 1976  
(This space for State Use)

APPROVED BY [Signature] TITLE BO DATE MAR 24 1976  
CONDITIONS OF APPROVAL, IF ANY:

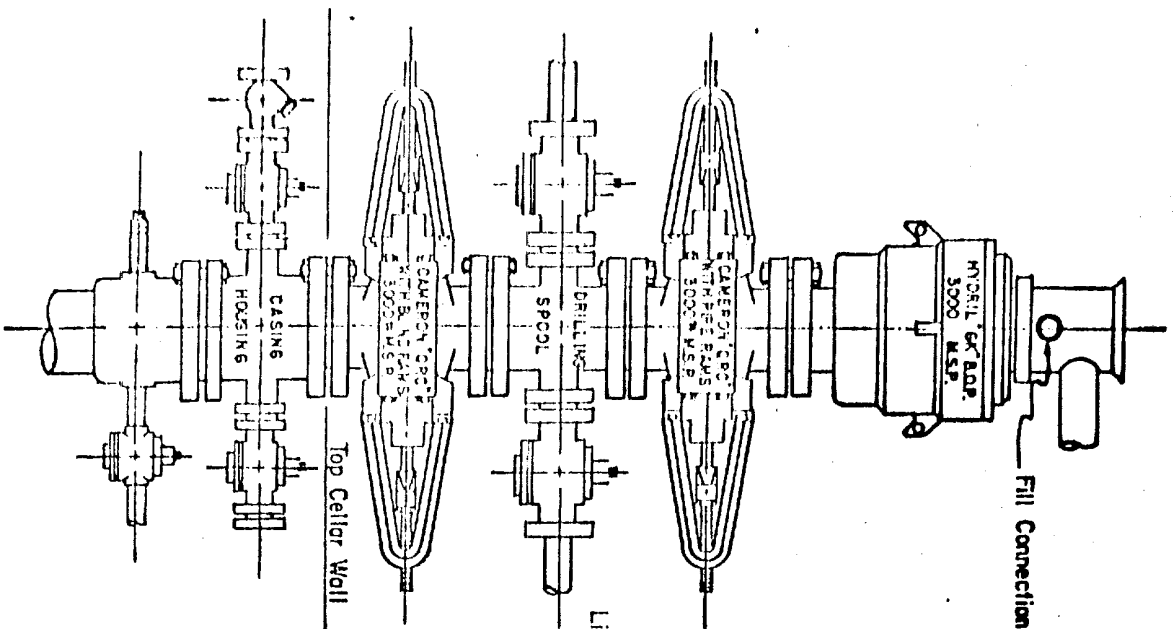

### 3,000 PSI WORKING PRESSURE BLOWOUT PREVENTER HOOK-UP

Series 900 Flanges, or Better

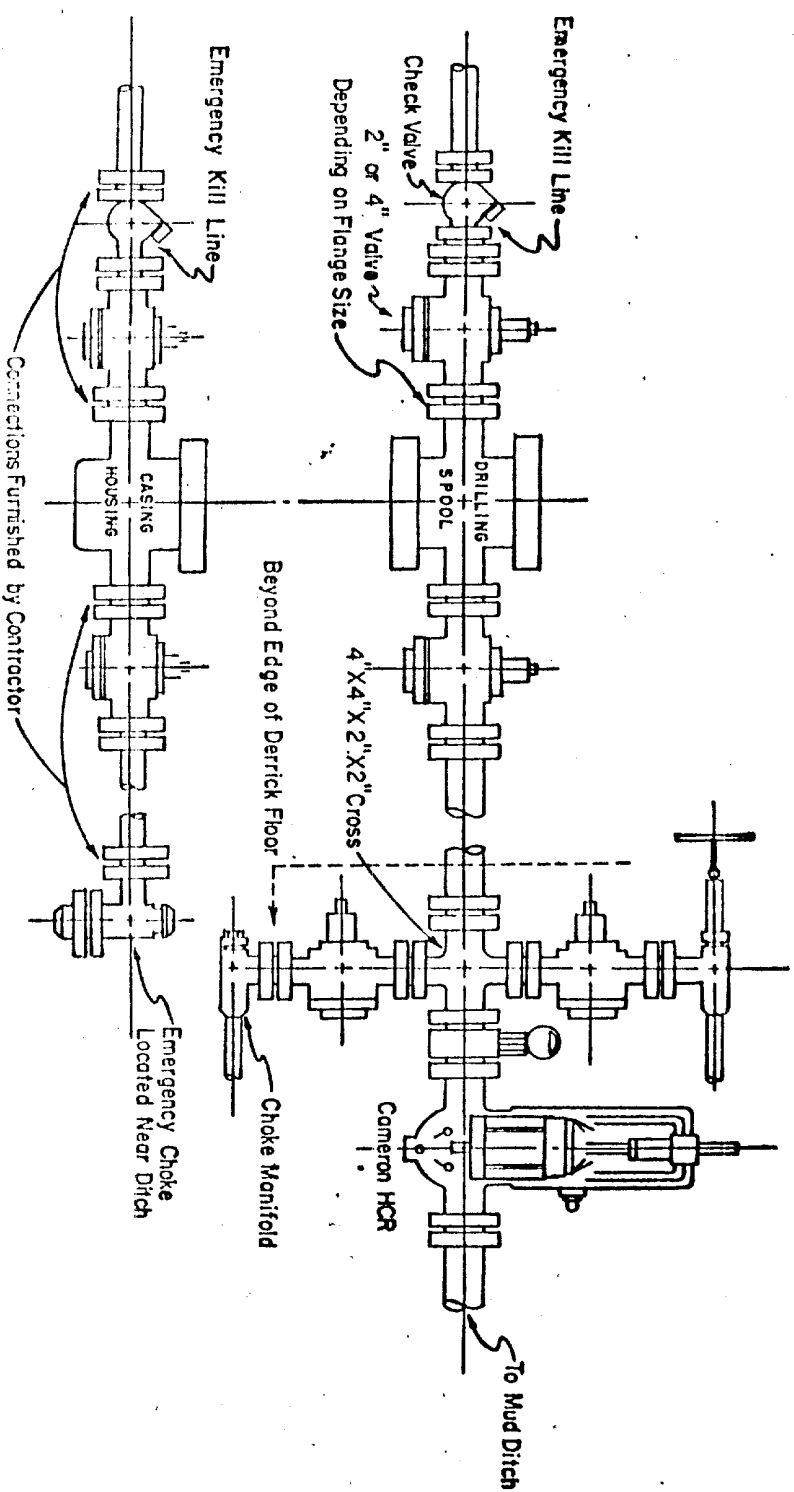

### 3,000 PSI WORKING PRESSURE KILL, CHOKE, AND FILL CONNECTIONS

API Series 900 Flanges or Better

#### DETAIL OF 4" FLOW LINE CHOKE ASSEMBLY

Minimum assembly for 3000 PSI working pressure will consist of three preventers. The bottom and middle preventers may be Cameron ORC, Cameron Type F single or Sheffer Hydraulic single, and the upper will be Hydril GK. In lieu of the drilling spool, the flanged outlets from the Cameron Type F single open face flanged preventer, provided the outlets are the correct size, may be used for the four-inch flow line and the two-inch kill line.

Size 12-inch preventers may be used for work down through 8-5/8-inch casing. Size 10-inch preventers may be used for work down through 7-5/8-inch casing. Size six-inch preventers are to be used for work through 7-inch and 5-1/2-inch casings.

Minimum operating equipment for the preventers will be: (1) An air operated pump and (2) An accumulator(s) with some means of obtaining a fluid charge. A closed fluid system is recommended. The closing manifold and remote closing manifold will have a separate four-way valve for each pressure operated device and a Hydril regulator will be provided. Sufficient fluid capacity in the accumulator(s) shall be available to close all the pressure operated devices at the same time with 25 percent reserve. Guffin E51 hydraulic oil shall be used as the operating fluid.

The four-inch flow line from the preventers shall be supported by a metal stand or reinforced concrete. All valves throughout the assembly shall be selected for operation in both gas and fluids.

The ram type preventers and the Cameron HCR valve will be provided with stem extensions, universal joints, if needed, and operating wheels.

NEW MEXICO OIL CONSERVATION COMMISSION  
WELL LOCATION AND ACREAGE DEDICATION PLAT

Form O-102  
Superseded O-128  
Effective 1-1-65

All distances must be from the outer boundaries of the Section

Operator <b>Gulf Oil Company - USA</b>		Lease <b>Central Drinkard Unit</b>		Well No. <b>415</b>
Section <b>1</b>	Range <b>28</b>	Township <b>21 South</b>	Range <b>37 East</b>	County <b>Lea</b>
Approximate Location of Well <b>2212</b> feet from the <b>South</b> line and <b>1146</b> feet from the <b>East</b> line				
Ground Level Elev.	Drinking Water		Drinking Water	Dedicated Acreage <b>40</b> Acres

1. Outline the acreage dedicated to the subject well by colored pencil or hatchure marks on the plat below.
2. If more than one lease is dedicated to the well, outline each and identify the ownership thereof (both as to working interest and royalty).
3. If more than one lease of different ownership is dedicated to the well, have the interests of all owners been consolidated by communitization, unitization, force-pooling, etc?

☐ Yes ☐ No If answer is "yes," type of consolidation \_\_\_\_\_

If answer is "no," list the owners and tract descriptions which have actually been consolidated (Use reverse side of this form if necessary) \_\_\_\_\_

No allowable will be assigned to the well until all interests have been consolidated (by communitization, unitization, forced-pooling, or otherwise) or until a non-standard unit, eliminating such interests, has been approved by the Commission.

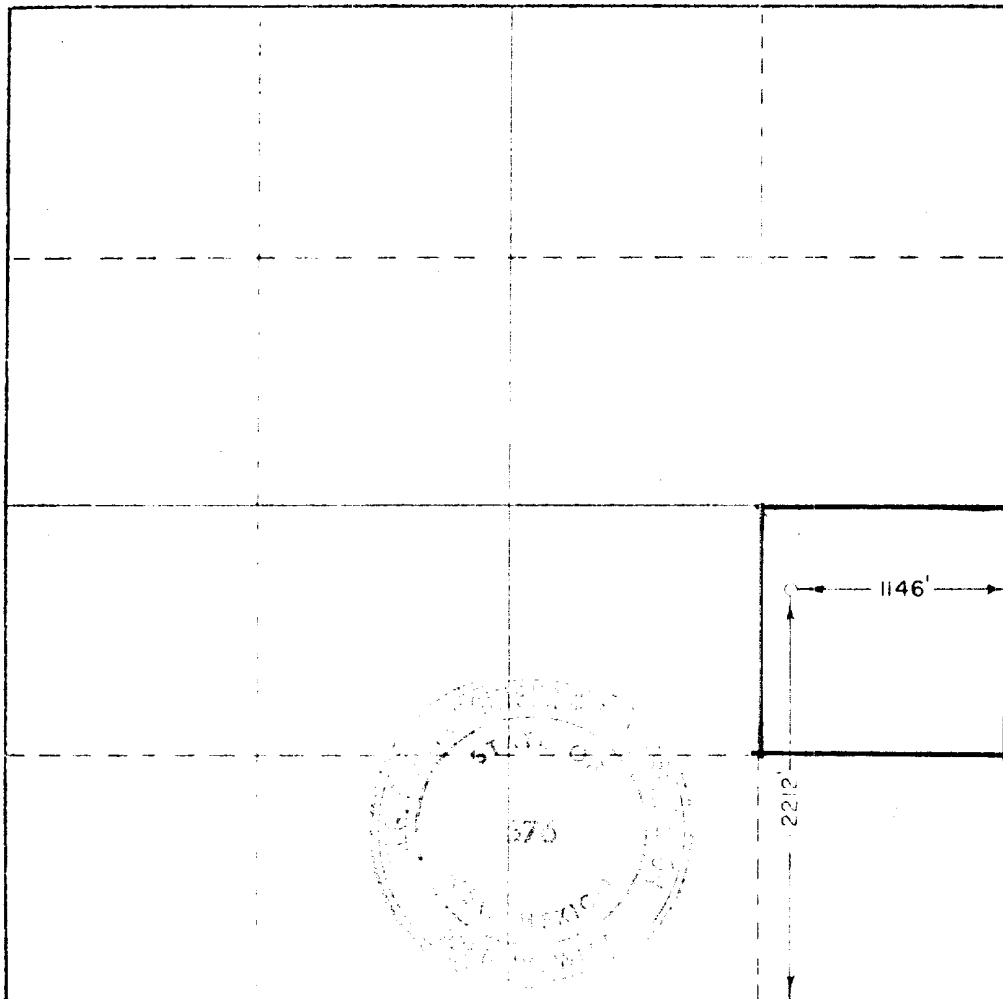

CERTIFICATION

I hereby certify that the information contained herein is true and complete to the best of my knowledge and belief.

*C. D. Borland*

Name

**C. D. BORLAND**

Position

**Area Production Manager**

Company

**Gulf Oil Corporation**

Date

**March 4, 1976**

I hereby certify that the well location shown on this plat was plotted from field notes of actual surveys made by me or under my supervision, and that the same is true and correct to the best of my knowledge and belief.

Date Surveyed

**February 24, 1976**

Registered Professional Engineer and or Land Surveyor

*John W. West*

Certificate No.

**676**

0 100 200 300 400 500 600 700 800 900 1000 1100 1200 1300 1400 1500 1600 1700 1800 1900 2000 2100 2200 2300 2400 2500 2600 2700 2800 2900 3000 3100 3200 3300 3400 3500 3600 3700 3800 3900 4000 4100 4200 4300 4400 4500 4600 4700 4800 4900 5000 5100 5200 5300 5400 5500 5600 5700 5800 5900 6000 6100 6200 6300 6400 6500 6600 6700 6800 6900 7000 7100 7200 7300 7400 7500 7600 7700 7800 7900 8000 8100 8200 8300 8400 8500 8600 8700 8800 8900 9000 9100 9200 9300 9400 9500 9600 9700 9800 9900 10000

RECEIVED

APR 4 1976

U.S. CONSERVATION COMMISSION  
FISH & BIRDS