

NO. OF COPIES RECEIVED	
DISTRIBUTION	
SANTA FE	
FILE	
U.S.G.S.	
LAND OFFICE	
OPERATOR	

# NEW MEXICO OIL CONSERVATION COMMISSION

Form C-101  
Revised 1-1-65

5A. Indicate Type of Lease	
STATE <input type="checkbox"/>	FEE <input checked="" type="checkbox"/>
5. State Oil & Gas Lease No.	

## APPLICATION FOR PERMIT TO DRILL, DEEPEN, OR PLUG BACK

1a. Type of Work		7. Unit Agreement Name	
b. Type of Well OIL WELL <input type="checkbox"/> GAS WELL <input checked="" type="checkbox"/> OTHER <input type="checkbox"/>		Central Drinkard Unit	
2. Name of Operator Gulf Oil Corporation		8. Farm or Lease Name	
3. Address of Operator Box 670, Hobbs, New Mexico 88240		9. Well No. 416	
4. Location of Well UNIT LETTER P LOCATED 1305' FEET FROM THE South LINE AND 348 FEET FROM THE East LINE OF SEC. 28 TWP. 21-S RGE. 37-E NMPM		10. Field and Pool, or Wildcat Drinkard	
19. Proposed Depth 6488'		19A. Formation Drinkard	
20. Rotary or C.T. Rotary		21. Elevations (Show whether DF, RT, etc.) 3419' GL	
21A. Kind & Status Plug. Bond Blanket		21B. Drilling Contractor	
22. Approx. Date Work will start April 1, 1976		12. County Lea	

### PROPOSED CASING AND CEMENT PROGRAM

SIZE OF HOLE	SIZE OF CASING	WEIGHT PER FOOT	SETTING DEPTH	SACKS OF CEMENT	EST. TOP
11"	8-5/8"	24#	1150'	Circulate	
7-7/8"	5-1/2"	15.50#	6488' *	Base of salt.	

\* Will set DV tool at approximately 1200' and circulate cement.

BOP: See Drawing No. 3 attached.

ACREAGE IS DEDICATED.

IN ABOVE SPACE DESCRIBE PROPOSED PROGRAM: IF PROPOSAL IS TO DEEPEN OR PLUG BACK, GIVE DATA ON PRESENT PRODUCTIVE ZONE AND PROPOSED NEW PRODUCTIVE ZONE. GIVE BLOWOUT PREVENTER PROGRAM, IF ANY.

I hereby certify that the information above is true and complete to the best of my knowledge and belief.

Signed W. B. Borland Title Area Production Manager Date March 25, 1976

APPROVED BY [Signature] TITLE Director DATE APR 19 1976

CONDITIONS OF APPROVAL, IF ANY:

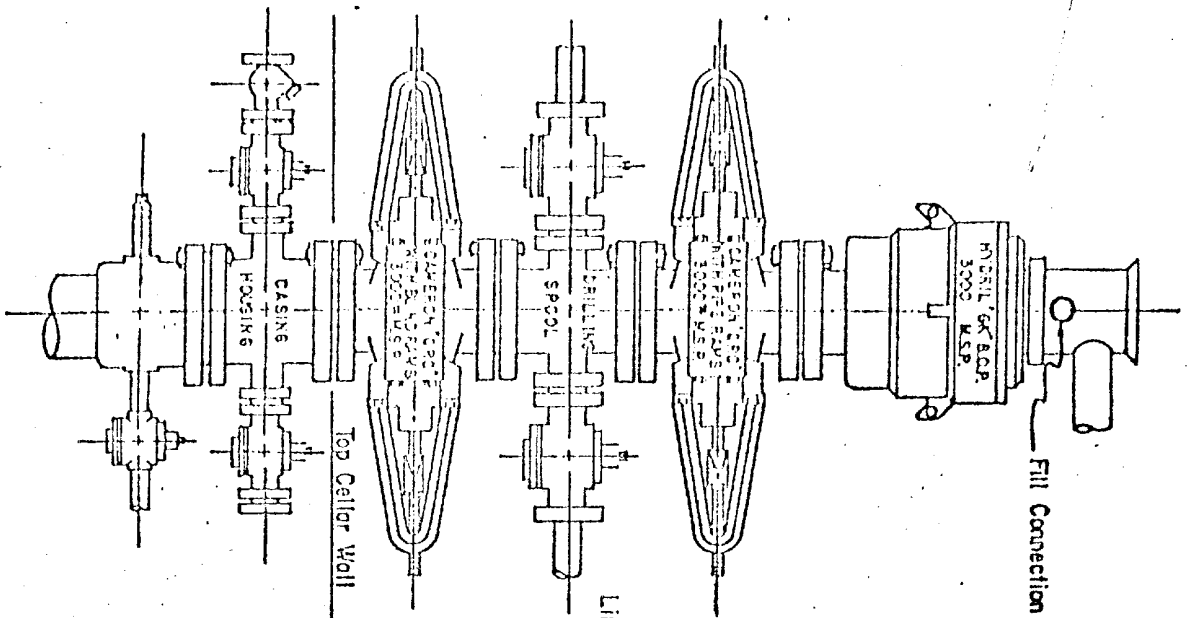

See Detail of 4" Flow Line and Choke Assembly

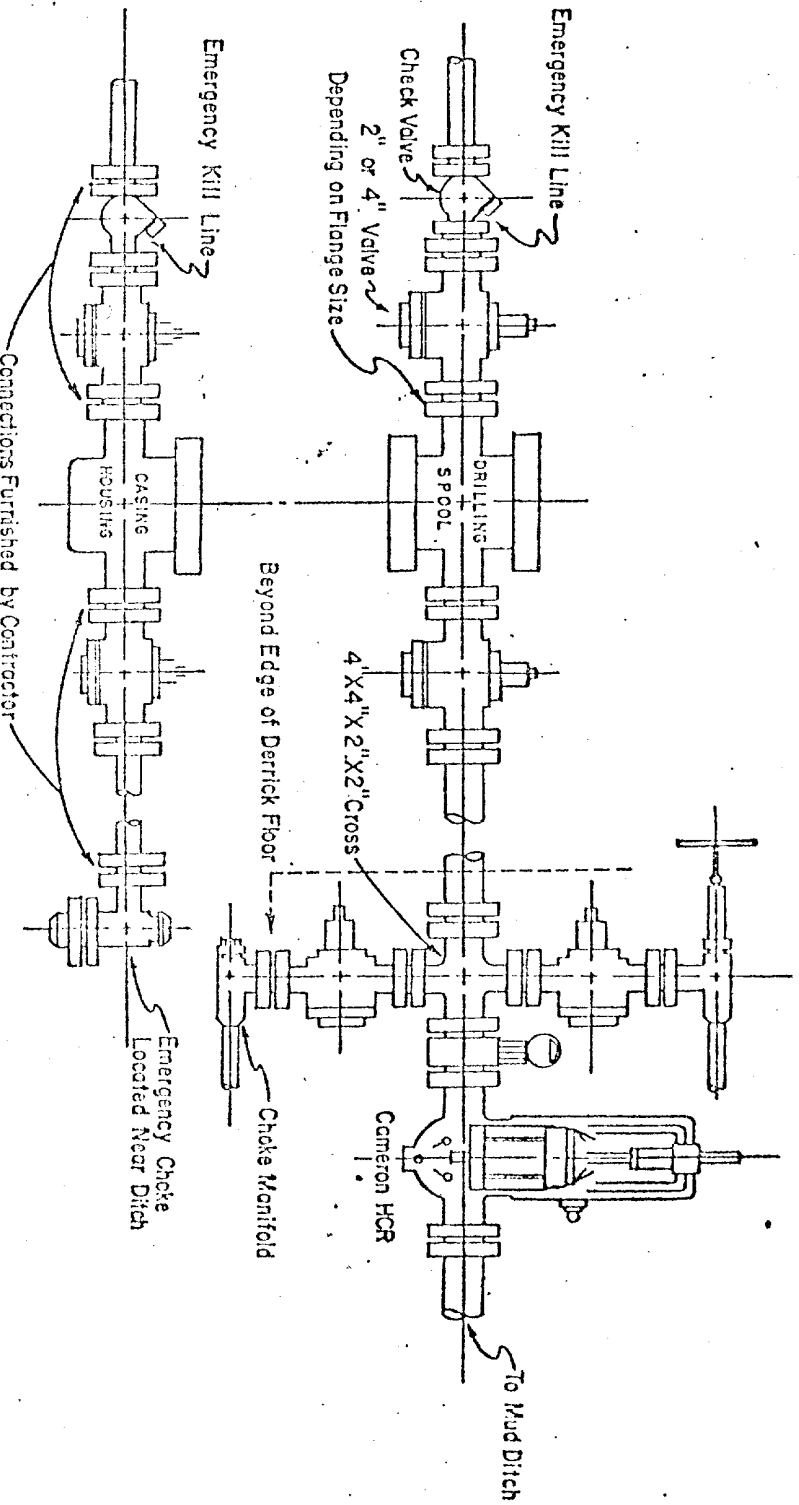

### 3,000 PSI WORKING PRESSURE KILL, CHOKE, AND FILL CONNECTIONS

API Series 900 Flanges or Better

#### DETAIL OF 4" FLOW LINE CHOKE ASSEMBLY

Minimum assembly for 3000 PSI working pressure will consist of three preventers. The bottom and middle preventers may be Cameron ORC, Cameron Type F single or Shafter Hydraulic single, and the upper will be Hydril GK. In lieu of the drilling spool, the flanged outlets from the Cameron Type F single open face flanged preventer, provided the outlets are the correct size, may be used for the four-inch flow line and the two-inch kill line.

Size 12-inch preventers may be used for work down through 8-5/8-inch casing. Size 10-inch preventers may be used for work down through 7-5/8-inch casing. Size six-inch preventers are to be used for work through 7-inch and 5-1/2-inch casings.

Minimum operating equipment for the preventers will be: (1) An air operated pump and (2) An accumulator(s) with some means of obtaining a fluid charge. A closed fluid system is recommended. The closing manifold and remote closing manifold will have a separate four-way valve for each pressure operated device and a Hydril regulator will be provided. Sufficient fluid capacity in the accumulator(s) shall be available to close all the pressure operated devices at the same time with 25 percent reserve. Gulf No. 531 Hydraulic oil shall be used as the operating fluid.

The four-inch flow line from the preventers shall be supported by a metal stand or reinforced concrete. All valves throughout the assembly shall be selected for operation in both gas and fluids.

The ram type preventers and the Cameron HCR valve will be provided with stem extensions, universal joints, if needed, and operating wheels.

### 3,000 PSI WORKING PRESSURE BLOWOUT PREVENTER HOOK-UP

Series 900 Flanges, or Better

NEW MEXICO OIL CONSERVATION COMMISSION  
WELL LOCATION AND ACREAGE DEDICATION PLAT

Form C-102  
Supersedes C-128  
Effective 1-1-65

All distances must be from the outer boundaries of the Section

Operator <b>Gulf Oil Company - USA</b>			Lease <b>Central Drinkard Unit</b>		Well No. <b>416</b>
Unit Letter <b>P</b>	Section <b>28</b>	Township <b>21 South</b>	Range <b>37 East</b>	County <b>Lea</b>	
Actual Footage Location of Well: <b>1305</b> feet from the <b>South</b> line and <b>348</b> feet from the <b>East</b> line					
Ground Level Elev. <b>3419</b>	Producing Formation <b>Drinkard</b>		Pool <b>Drinkard</b>	Dedicated Acreage per <b>40</b> Acres	

1. Outline the acreage dedicated to the subject well by colored pencil or hatchure marks on the plat below.
2. If more than one lease is dedicated to the well, outline each and identify the ownership thereof (both as to working interest and royalty).
3. If more than one lease of different ownership is dedicated to the well, have the interests of all owners been consolidated by communitization, unitization, force-pooling, etc?

☐ Yes ☐ No If answer is "yes," type of consolidation \_\_\_\_\_

If answer is "no," list the owners and tract descriptions which have actually been consolidated. (Use reverse side of this form if necessary.) \_\_\_\_\_

No allowable will be assigned to the well until all interests have been consolidated (by communitization, unitization, forced-pooling, or otherwise) or until a non-standard unit, eliminating such interests, has been approved by the Commission.

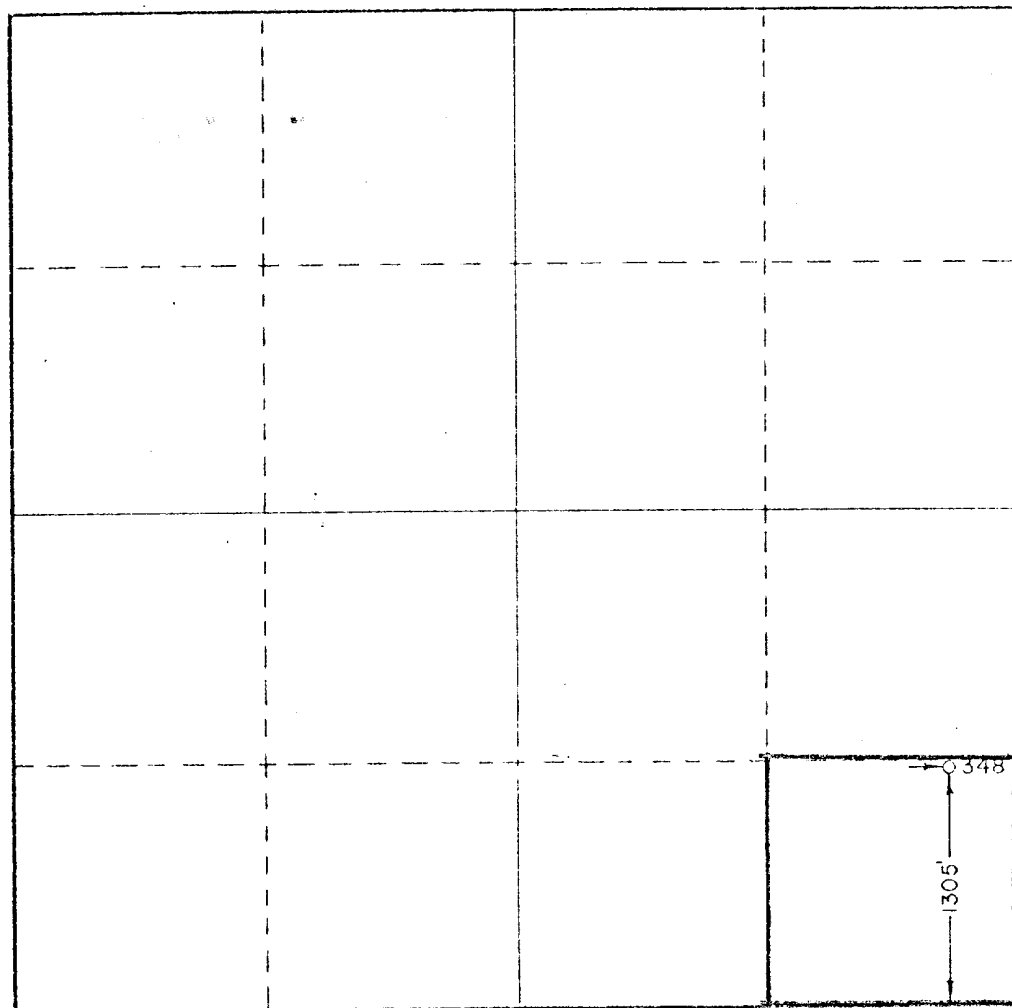

CERTIFICATION

I hereby certify that the information contained herein is true and complete to the best of my knowledge and belief.

*C. D. Borland*

Name

**C. D. BORLAND**

Position

**Area Production Manager**

Company

**Gulf Oil Corporation**

Date

**March 25, 1976**

I hereby certify that the well location shown on this plat was plotted from field notes of actual surveys made by me or under my supervision, and that the same is true and correct to the best of my knowledge and belief.

Date

**March 16, 1976**

Registered Professional Engineer and Land Surveyor

*John W. Waite*  
John W. Waite  
1975

