

NO. OF COPIES RECEIVED	
DISTRIBUTION	
SANTA FE	
FILE	
U.S.G.S.	
LAND OFFICE	
OPERATOR	

# NEW MEXICO OIL CONSERVATION COMMISSION

Form C-101  
Revised 1-1-65

5A. Indicate Type of Lease	
STATE <input type="checkbox"/>	FEE <input checked="" type="checkbox"/>

5. State Oil & Gas Lease No.

## APPLICATION FOR PERMIT TO DRILL, DEEPEN, OR PLUG BACK

1a. Type of Work DRILL <input checked="" type="checkbox"/> DEEPEN <input type="checkbox"/> PLUG BACK <input type="checkbox"/>			7. Unit Agreement Name
b. Type of Well OIL WELL <input checked="" type="checkbox"/> GAS WELL <input type="checkbox"/> OTHER <input type="checkbox"/> SINGLE ZONE <input type="checkbox"/> MULTIPLE ZONE <input type="checkbox"/>			8. Name or Lease Name Mark Owen
2. Name of Operator Marathon Oil Company			9. Well No. 8
3. Address of Operator P. O. Box 2409, Hobbs, New Mexico 88240			10. Field and Pool, or Wildcat Wantz Granite Wash
4. Location of Well UNIT LETTER M LOCATED 760 FEET FROM THE South LINE AND 760 FEET FROM THE West LINE OF SEC. 35 TWP. 21S RGE. 37E NWPM			12. County Lea
19. Proposed Depth 7700'			19A. Formation Granite Wash
21. Elevations (Show whether DJ, RT, etc.) 3385' GR (Est)			22. Approx. Date Work will start March 23, 1977

## PROPOSED CASING AND CEMENT PROGRAM

SIZE OF HOLE	SIZE OF CASING	WEIGHT PER FOOT	SETTING DEPTH	SACKS OF CEMENT	EST. TOP
12 1/4"	9 5/8"	32.3#	1250'	650	Circulated
8 3/4"	7"	23#	*7700'	2450	Circulated

Plan to drill to approximately 7700'.

Cement and test all casing by approved methods.

Blowout equipment to be used is 900 Series, Cameror or equivalent, with pipe and blank rams. Remote BOP controls will be located on derrick floor with closing unit located a minimum of 75' from the wellhead.

\*With DV tool at approximately 4500'.

IN ABOVE SPACE DESCRIBE PROPOSED PROGRAM: IF PROPOSAL IS TO DEEPEN OR PLUG BACK, GIVE DATA ON PRESENT PRODUCTIVE ZONE AND PROPOSED NEW PRODUCTIVE ZONE. GIVE BLOWOUT PREVENTER PROGRAM, IF ANY.

I hereby certify that the information above is true and complete to the best of my knowledge and belief.

Signed William D. Holmes Title Petroleum Engineer Date March 11, 1977

(This space for State Use)

APPROVED BY [Signature] SUPERVISOR TITLE [Signature] DATE [Signature]

CONDITIONS OF APPROVAL, IF ANY:

NEW MEXICO OIL CONSERVATION COMMISSION  
WELL LOCATION AND ACREAGE DEDICATION PLAT

Form C-102  
Supersedes C-128  
Effective 1-1-65

All distances must be from the outer boundaries of the Section

Operator <b>MARATHON OIL COMPANY</b>		Lease <b>MARK OWEN</b>		Well No. <b>8</b>
Section <b>M</b>	Section <b>35</b>	Township <b>21 South</b>	Range <b>37 East</b>	County <b>Lea</b>
Actual Well Location of Well: <b>760</b> feet from the <b>South</b> line and <b>760</b> feet from the <b>West</b> line				
Ground Elev. Elev <b>3385.0</b>	Producing Formation <b>Granite Wash</b>	Pool <b>Wantz Granite Wash</b>	Dedicated Acreage <b>40</b> Acres	

1. Outline the acreage dedicated to the subject well by colored pencil or hachure marks on the plat below.
2. If more than one lease is dedicated to the well, outline each and identify the ownership thereof (both as to working interest and royalty).
3. If more than one lease of different ownership is dedicated to the well, have the interests of all owners been consolidated by communitization, unitization, force-pooling, etc?

☐ Yes ☐ No If answer is "yes," type of consolidation \_\_\_\_\_

If answer is "no," list the owners and tract descriptions which have actually been consolidated (Use reverse side of this form if necessary.) \_\_\_\_\_

No allowable will be assigned to the well until all interests have been consolidated (by communitization, unitization, forced-pooling, or otherwise) or until a non-standard unit, eliminating such interests, has been approved by the Commission.

R-37E

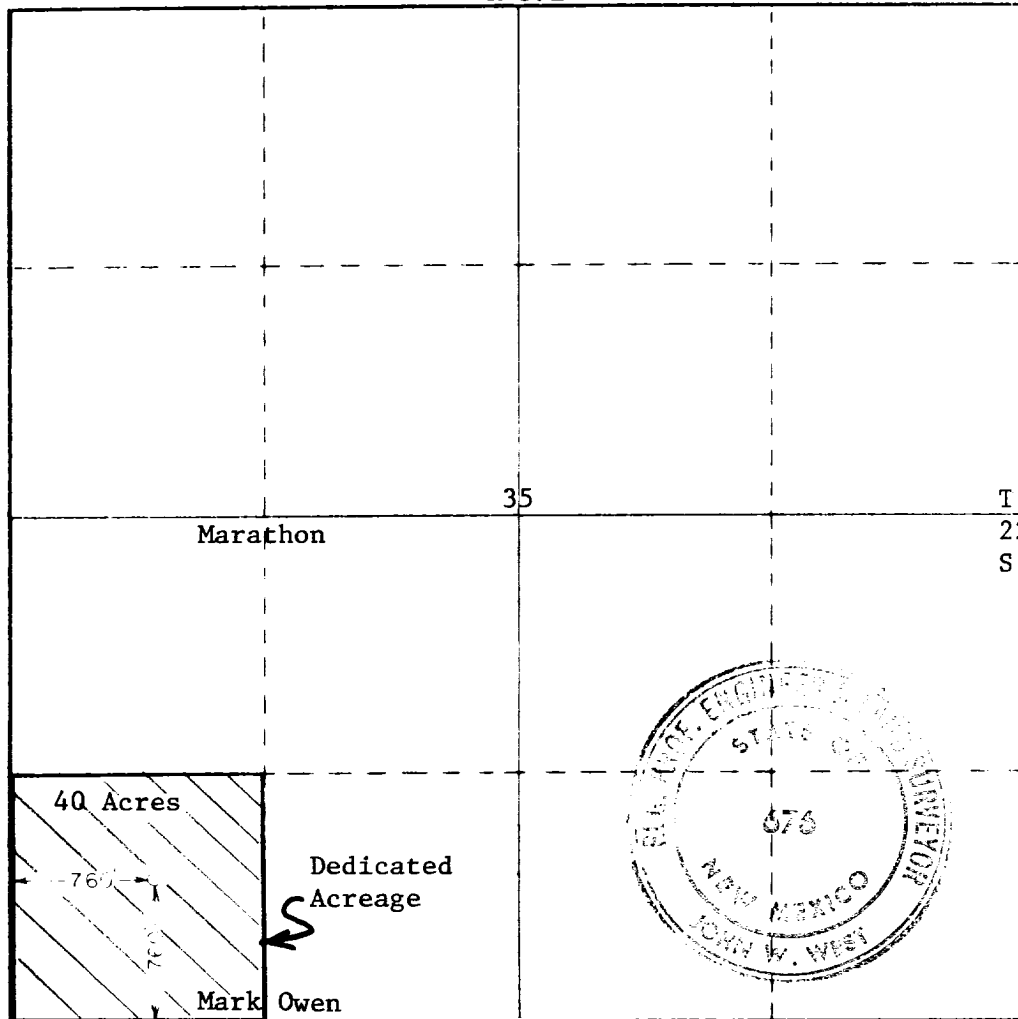

CERTIFICATION

I hereby certify that the information contained herein is true and complete to the best of my knowledge and belief.

*William D. Holmes*

Name

William D. Holmes

Position

Petroleum Engineer

Company

Marathon Oil Company

Date

March 11, 1977

I hereby certify that the well location shown on this plat was plotted from field notes of actual surveys made by me or under my supervision, and that the same is true and correct to the best of my knowledge and belief.

March 8, 1977

Date Surveyed

Registered Professional Engineer and Land Surveyor

*John W. West*

Certificate No.

676



RECEIVED

MAR 1 1977

OIL CONSERVATION BOARD  
WASHINGTON, D. C.

173