

NEW MEXICO OIL CONSERVATION COMMISSION
WELL LOCATION AND ACREAGE DEDICATION PLAT

Form C-102
Supersedes C-128
Effective 1-1-85

All distances must be from the outer boundaries of the Section.

Operator Marathon Oil Co.		Lease Mc Donald State Account 2		Well No. 29
Section H	Section 13	Range 22 South	Range 36 East	County Lea
Actual Well Location (if well) 330		feet from true East 1800	feet from true North 330	Line
Ground Level Elev. 3451.9	Producing Formation Drinkard	Section Arrowhead-Drinkard	Dedicated Acreage 40	

- Outline the acreage dedicated to the subject well by colored pencil or hatchure marks on the plat below.
- If more than one lease is dedicated to the well, outline each and identify the ownership thereof (both as to working interest and royalty).
- If more than one lease of different ownership is dedicated to the well, have the interests of all owners been consolidated by communitization, unitization, force pooling, etc?

☐ Yes ☐ No If answer is "yes," type of consolidation _____

If answer is "no," list the owners and tract descriptions which have actually been consolidated. (Use reverse side of this form if necessary) _____

No allowable will be assigned to the well until all interests have been consolidated (by communitization, unitization, forced-pooling, or otherwise) or until a non-standard unit, eliminating such interests, has been approved by the Commission.

R-36E

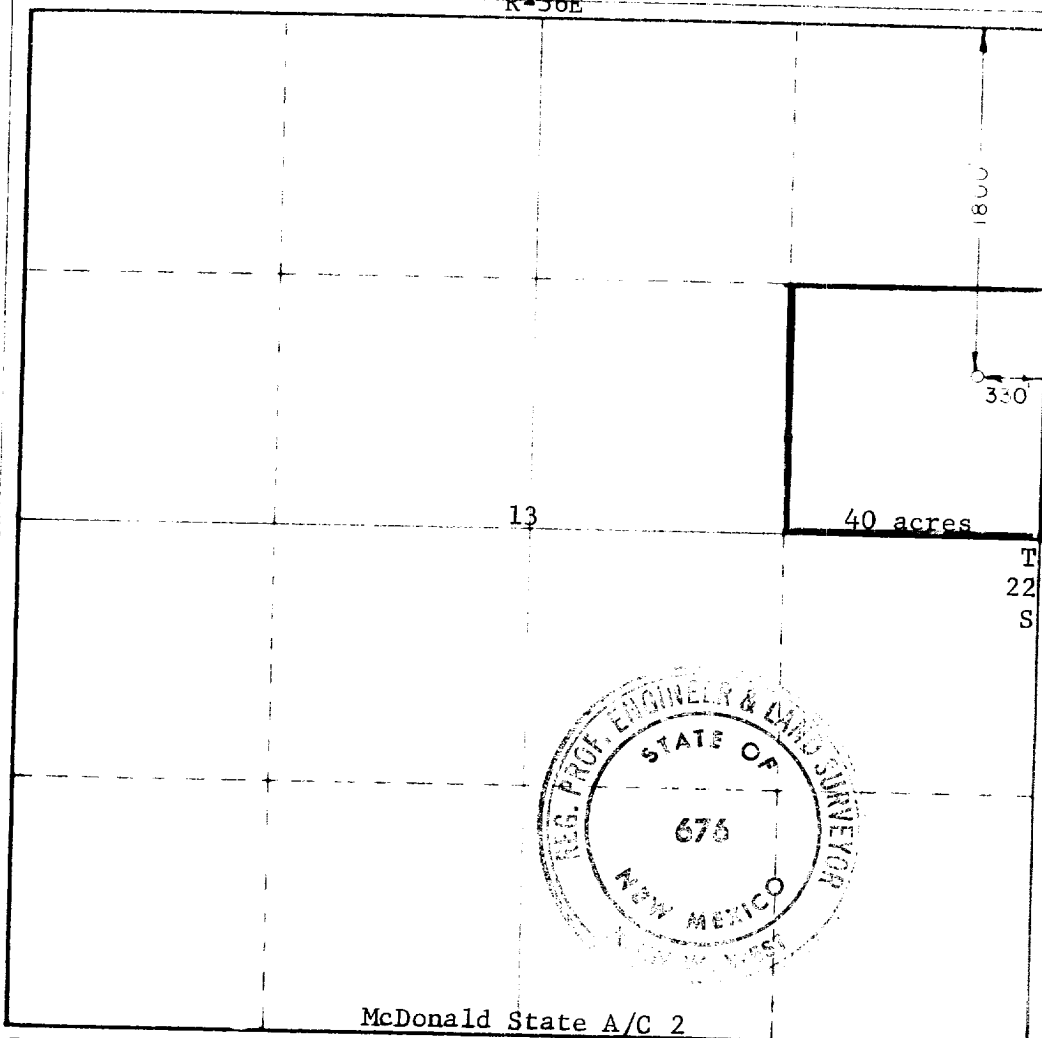

CERTIFICATION

I hereby certify that the information contained herein is true and complete to the best of my knowledge and belief.

Name *William R. Huch*

Position
Petroleum Engineer

Company
Marathon Oil Company

Date
March 14, 1978

I hereby certify that the well location shown on this plat was plotted from field notes of actual surveys made by me or under my supervision, and that the same is true and correct to the best of my knowledge and belief.

Date Surveyed
3/10/78

Registered Professional Engineer and Land Surveyor

John W. West
Certificate No. **John W. West 676**
Ronald J. Eidson 3239

McDonald State A/C 2

33 560 190 1320 1650 1980 2310 2640 2000 1600 1000 500

RECEIVED

MAR 15 1978

OIL CONSERVATION COMM.
HOBBS, N. M.

173