

© Copyrighted Reproduction Prohibited

COUNTY LEA FIELD Wildcat  
OPR AMOCO PRODUCTION CO.  
NO 22 LEASE Gullully "B" Federal  
Sec 33, T20S, R37E  
2310' FNL, 1980' FWL of Sec  
7 mi S/Monument

STATE NM  
API 30-025-26129  
MAP  
(COORD)

3-3-18 NM

SPI) 12-15-78 CMP 2-16-79

13 3/8" at 1232' w/775 sx  
5 1/2" at 4200' w/1745 sx

WELL CLASS: INIT		WD	WSD	ELEV	L & S
FORMATION	DATUM	FORMATION	DATUM		
7200'	(ABO)	PHD	3765'		

IP (Queen-Penrose) Perfs 3461-3623<sup>†</sup> F 185 MCFGPD. Pot based  
on 24 hr test thru 24/64" chk. GOR (NR); gty (NR); CP Pkr;  
TP 240#

CONTR	Capitan #16	OPRSELEV	3541' GL	PD	7000' RT
-------	-------------	----------	----------	----	----------

F.R. 10-30-78  
12-21-78 Drlg 1426' anhy  
1-5-79 TD 7200'; Prep Fish logging tool  
1-11-79 TD 7200'; WOC  
1-12-79 TD 7200'; WOCU  
1-26-79 TD 7200'; Prep Perf  
2-1-79 TD 7200'; PBD 3765'; Prep Acid  
Perf (Grayburg) 3950-58', 3979-86', 3994-98',  
4008-16', 4054-59' w/2 SPF  
Acid (3950-4059') 3000 gals (15%)  
Swbd 144 BW in 8 hrs (3950-4059')  
Set CIRP @ 3800' w/35' cmt on top  
Perf (Queen-Penrose) 3461-67', 3551-61', 3575-81',  
3587-94', 3603-09', 3621-23' w/2 SPF  
2-7-79 TD 7200'; PBD 3765'; Swbg  
2-13-79 TD 7200'; PBD 3765'; Tstg  
Acid (3461-3623') 3000 gals (15%)  
3-3-18 NM

---

LEA  
AMOCO PRODUCTION CO.

Wildcat  
22 Gillully "B" Federal  
Sec 33, T20S, R37E

NM  
Page #2

---

2-13-79 Continued  
Flwd 181 MCFGPD in 3 hrs thru 40/64" chk,  
TP 30# (3461-3623')  
2-16-79 TD 7200'; PBD 3765'; WOSP  
Flwd 185 MCFGPD in 24 hrs thru 24/64" chk,  
TP 240# (3461-3623')  
3-12-79 TD 7200'; PBD 3765'; Complete  
Queen-Penrose Discovery; No Suggested Field Name  
LOG TOPS: Yates 2715', Seven Rivers 3040',  
Queen 3440', Penrose 3556', Grayburg 3662',  
San Andres 4095', Glorieta 5248', Blinbry  
5995', Drinkard 6537', Abo 7037'  
Rig Released 1-10-79 3-3-18 NM  
3-17-79 COMPLETION ISSUED IC 30-025-70376-78

---

**NEW MEXICO OIL CONSERVATION COMMISSION  
WELL LOCATION AND ACREAGE DEDICATION PLAT**

Form 7-102  
Supersedes C-128  
Effective 1-1-65

All distances must be from the outer boundaries of the Section

Operator <b>Amoco Production Co.</b>			Lease <b>Gillully B" Federal</b>		Well No. <b>22</b>
Unit Letter <b>F</b>	Section <b>33</b>	Township <b>20 South</b>	Range <b>37 East</b>	County <b>Lea</b>	
Actual Footage Location of Well: <b>2310</b> feet from the <b>North</b> line and <b>1980</b> feet from the <b>West</b> line					
Ground Level Elev. <b>3540.5</b>	Producing Formation <b>QUEEN</b>		Pool <b>EUMONT QUEEN</b>		Dedicated Acreage: <b>360</b> Acres

1. Outline the acreage dedicated to the subject well by colored pencil or hachure marks on the plat below.
2. If more than one lease is dedicated to the well, outline each and identify the ownership thereof (both as to working interest and royalty).
3. If more than one lease of different ownership is dedicated to the well, have the interests of all owners been consolidated by communitization, unitization, force-pooling, etc?

☐ Yes   ☐ No   If answer is "yes," type of consolidation \_\_\_\_\_

If answer is "no," list the owners and tract descriptions which have actually been consolidated. (Use reverse side of this form if necessary.) \_\_\_\_\_

No allowable will be assigned to the well until all interests have been consolidated (by communitization, unitization, forced-pooling, or otherwise) or until a non-standard unit, eliminating such interests, has been approved by the Commission.

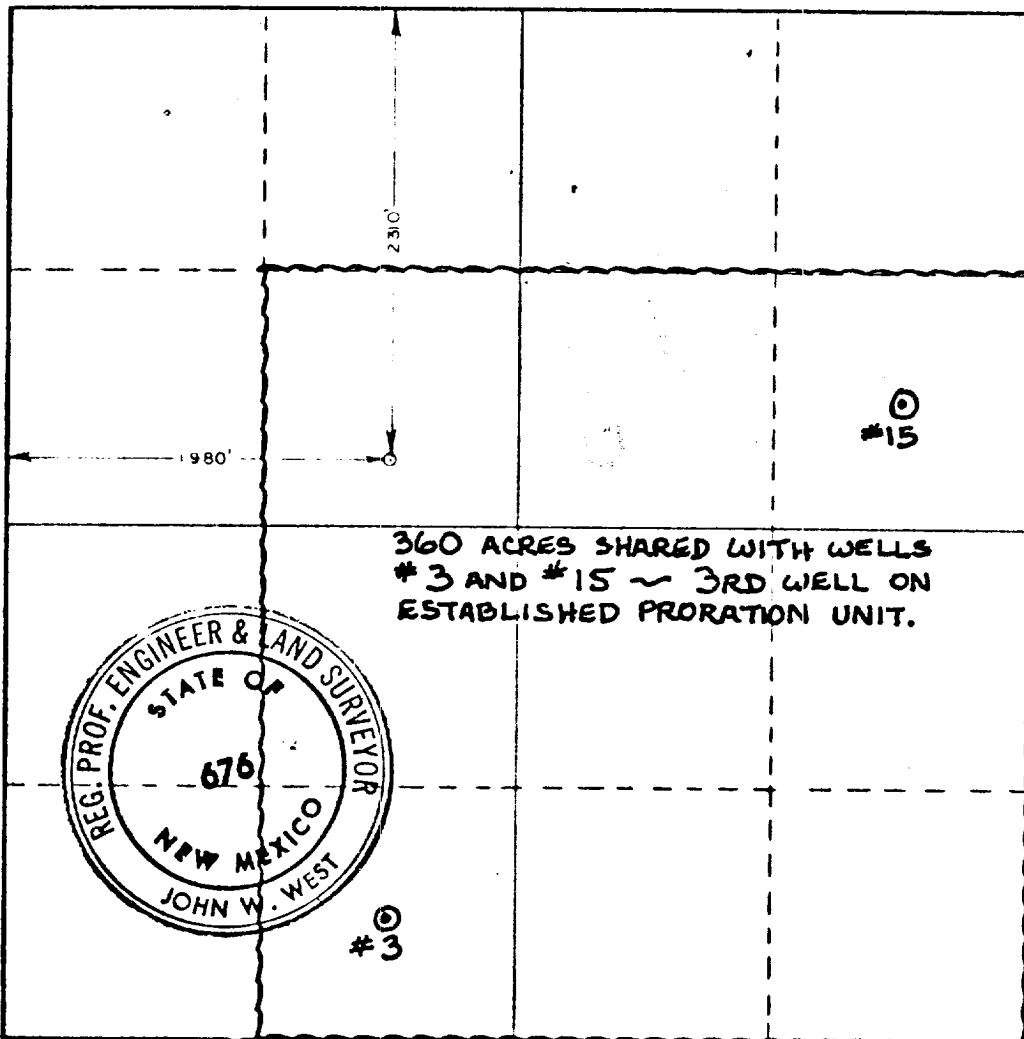

**CERTIFICATION**

I hereby certify that the information contained herein is true and complete to the best of my knowledge and belief.

Name Randy Atkins  
 Position ADMINISTRATIVE ANALYST  
 Company AMOCO PRODUCTION CO.  
 Date MARCH 29, 1979

I hereby certify that the well location shown on this plat was plotted from field notes of actual surveys made by me or under my supervision, and that the same is true and correct to the best of my knowledge and belief.

Date Surveyed October 6, 1978  
 Registered Professional Engineer and/or Land Surveyor  
John W. West  
 Certificate No. John W. West 676  
Ronald J. Eldon 3235

0 330 660 990 1320 1650 1980 2310 2640 2970 3300 3630 3960 4290 4620 4950 5280 5610 5940 6270 6600

**RECEIVED**  
**MAR 29 1979**  
**OIL CONSERVATION COUNCIL**  
**ROBERT E. H.**