



STATE OF NEW MEXICO
ENERGY, MINERALS AND NATURAL RESOURCES DEPARTMENT

OIL CONSERVATION DIVISION
HOBBS DISTRICT OFFICE

2-4-93

BRUCE KING
GOVERNOR

POST OFFICE BOX 1980
HOBBS, NEW MEXICO 88241-1980
(505) 393-6161

OIL CONSERVATION DIVISION
P. O. BOX 2088
SANTA FE, NEW MEXICO 87501

RE: Proposed:

MC _____
DHC _____
NSL _____
NSP X amend _____
SWD _____
WFX _____
PMX _____

Gentlemen:

I have examined the application for the:

Arco oil & Gas Co W.C. Roach #6-C #7-K 21-20-37
Operator Lease & Well No. Unit S-T-R

and my recommendations are as follows:

OK

Yours very truly,

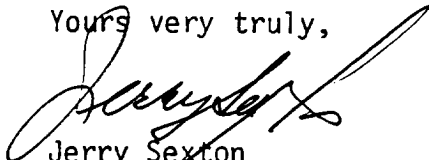
Jerry Sexton
Supervisor, District 1

/ed

ARCO Oil and Gas Company
Western District
Post Office Box 1610
Midland, TX 79702
Telephone (915) 688-5200



January 29, 1993

Mr. William J. LeMay
New Mexico Oil Conservation Division
P. O. Box 2088
Santa Fe, New Mexico 87501

Mr. J. T. Sexton
New Mexico Oil Conservation Division
P. O. Box 1980
Hobbs, New Mexico 88240

Dear Mr. LeMay:

ARCO Oil and Gas Company respectfully requests administrative approval to amend an existing non-standard 320-acre Eumont gas spacing and proration unit (consisting of the W/2 of Section 21, T-20S, R-37E) by deleting 40-acres (the SE/4 NW/4) to form a non-standard 280-acre Eumont gas spacing and proration unit. The existing 320-acre spacing and proration unit was approved by Division Order NSP-1570(L)(SD), dated April 6, 1989 for the W. C. Roach #6 and the W. C. Roach #7 wells. On November 24, 1992, by Administrative Order SD-92-6, the W. C. Roach #5 was simultaneously dedicated to this 320-acre spacing and proration unit in anticipation of recompleting this well to the Eumont Gas Pool from the Eunice Monument Grayburg San Andres Pool. However, the recompletion of the W. C. Roach #5 has resulted in an oil well rather than a gas well (see attached C-105). Thus, ARCO is requesting to remove the 40-acres where the W. C. Roach #5 is located from the existing 320-acre spacing and proration unit in order to form a 40-acre spacing and proration unit for the W. C. Roach #5 in the Eumont Oil Pool.

Attached are C-102 forms identifying the proposed configuration of the 280-acre Eumont gas proration unit for the W. C. Roach #6 and the W. C. Roach #7 wells and the 40-acre Eumont oil proration unit for the W. C. Roach #5. Also attached is a list of offset operators for this unit, and a land plat map of the surrounding area.

ARCO Oil and Gas Company believes approval of this request will be in the interest of conservation, will protect correlative rights, and will allow for a more complete recovery of Eumont gas and Eumont oil reserves from the subject acreage.

ARCO Oil and Gas Company is notifying the offset operators of this application by sending a copy of this application package, along with waiver to objection forms, by certified mail. If you need further information, please call me at (915) 688-5446.

Sincerely,

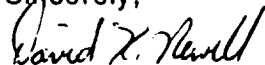

David K. Newell
Senior Operations/Analytical Engineer
DKN:lrh

Attachments

Offset Operators:

Please indicate your approval for our request as detailed in the attached package by signing the waiver form below. Please return the signed waiver in the enclosed stamped, self-addressed envelope.

Thank you for your cooperation in this matter.

WAIVER TO OBJECTION

ARCO OIL AND GAS COMPANY

Application to amend an existing 320-acre Eumont gas proration unit by deleting 40-acres to form a 280-acre Eumont gas proration unit and a 40-acre Eumont oil proration unit

**Eumont Gas Pool and Eumont Oil Pool
W/2, Section 21, T-20S, R-37E
Lea County, New Mexico**

I/We do hereby waive any objection to ARCO Oil and Gas Company's request for NMOCD Administrative Approval to amend an existing 320-acre Eumont gas proration unit by deleting 40-acres to form a 280-acre Eumont gas proration unit and a 40-acre Eumont oil proration unit.

Signed: _____
Title: _____
Company: _____
Date: _____

ARCO OIL AND GAS COMPANY

Application to ammend an existing 320-acre Eumont gas proration unit
by deleting 40-acres to form a 280-acre Eumont gas proration unit
and a 40-acre Eumont oil proration unit

Eumont Gas Pool and Eumont Oil Pool
W/2, Section 21, T-20S, R-37E
Lea County, New Mexico

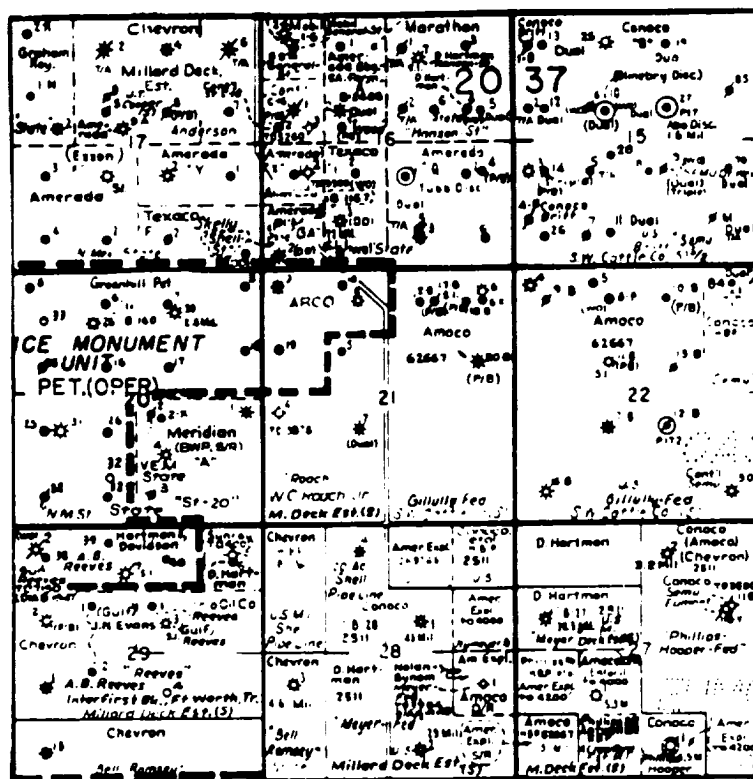

OFFSET OPERATORS

Conoco, Inc.
Texaco Expl. & Prod.
Doyle Hartman
Amerada Hess Corp.
Chevron, USA
Meridian Oil, Inc.
R. B. Honeyman, Jr.
John H. Hendrix
Mobil Prod. TX & NM
Amoco Prod. Co.
Estoril Prod. Corp.

Submit to Appropriate
District Office
State Lease - 4 copies
Fee Lease - 3 copies

State of New Mexico
Energy, Minerals and Natural Resources Department

Form C-102
Revised 1-1-89

OIL CONSERVATION DIVISION

P.O. Box 2088
Santa Fe, New Mexico 87504-2088

DISTRICT I

P.O. Box 1980, Hobbs, NM 88240

DISTRICT II

P.O. Drawer DD, Artesia, NM 88210

DISTRICT III

1000 Rio Brazos Rd., Aztec, NM 87410

WELL LOCATION AND ACREAGE DEDICATION PLAT

All Distances must be from the outer boundaries of the section

Operator ARCO OIL AND GAS COMPANY			Lease W. C. ROACH		Well No. 6
Unit Letter C	Section 21	Township T-20-S	Range R-37-E	County LEA	
Actual Footage Location of Well:					
660 feet from the NORTH line and		1980 feet from the WEST line			
Ground level Elev. 3513	Producing Formation YATES/7-RIVERS/QUEEN		Pool EUMONT GAS		Dedicated Acreage: 280 Acres

1. Outline the acreage dedicated to the subject well by colored pencil or hectare marks on the plat below.

2. If more than one lease is dedicated to the well, outline each and identify the ownership thereof (both as to working interest and royalty).

3. If more than one lease of different ownership is dedicated to the well, have the interest of all owners been consolidated by communitization, unitization, force-pooling, etc.?

☐ Yes ☐ No If answer is "yes" type of consolidation _____

If answer is "no" list the owners and tract descriptions which have actually been consolidated. (Use reverse side of this form if necessary).

No allowable will be assigned to the well until all interests have been consolidated (by communitization, unitization, forced-pooling, or otherwise) or until a non-standard unit, eliminating such interest, has been approved by the Division.

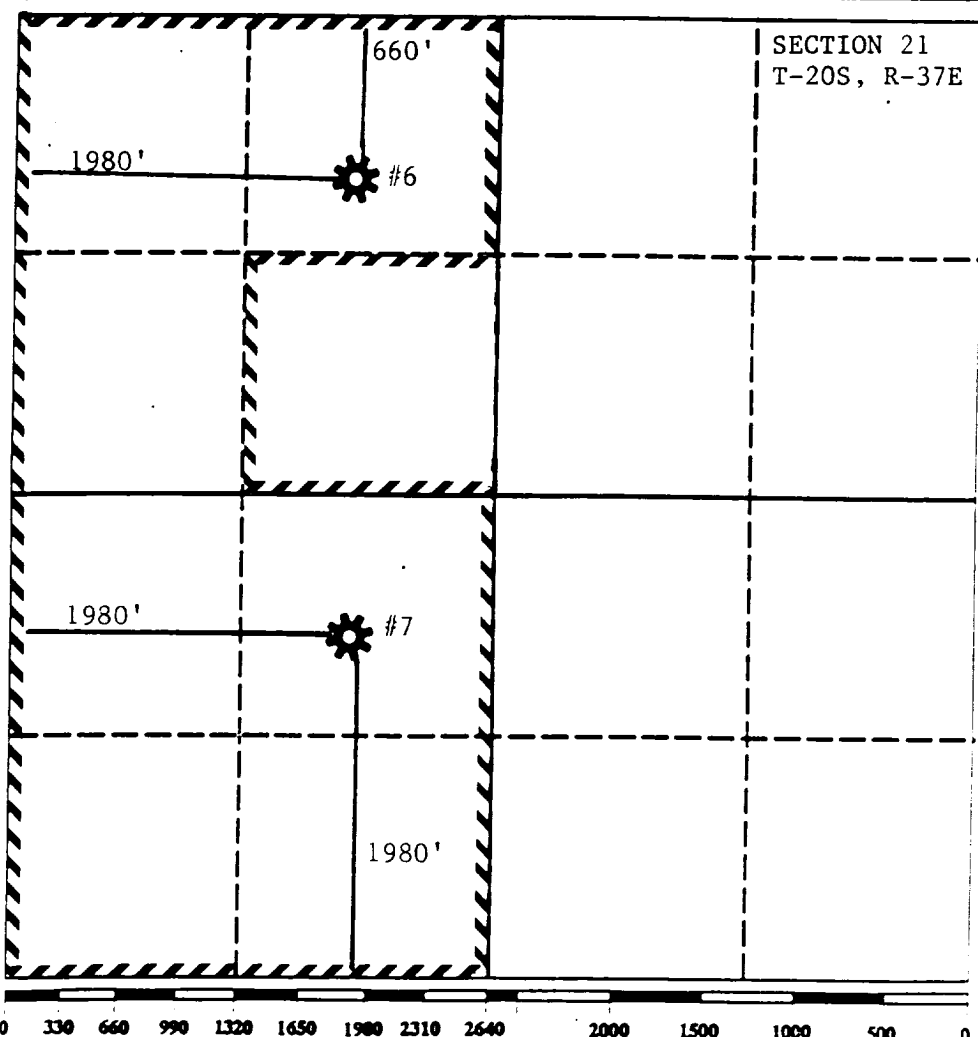

OPERATOR CERTIFICATION

I hereby certify that the information contained herein is true and complete to the best of my knowledge and belief.

Signature

Evelyn E. Gilson

Printed Name:

EVELYN GILSON

Position

ENGINEERING TECHNICIAN

Company

ARCO OIL AND GAS COMPANY

Date

JANUARY 28, 1993

SURVEYOR CERTIFICATION

I hereby certify that the well location shown on this plat was plotted from field notes of actual surveys made by me or under my supervision, and that the same is true and correct to the best of my knowledge and belief.

Date Surveyed

Signature & Seal of
Professional Surveyor

Certificate No.

Submit to Appropriate
District Office
State Lease - 4 copies
Fee Lease - 3 copies

State of New Mexico
Energy, Minerals and Natural Resources Department

Form C-102
Revised 1-1-89

OIL CONSERVATION DIVISION

P.O. Box 2088
Santa Fe, New Mexico 87504-2088

DISTRICT I
P.O. Box 1980, Hobbs, NM 88240

DISTRICT II
P.O. Drawer DD, Artesia, NM 88210

DISTRICT III
1000 Rio Brazos Rd., Aztec, NM 87410

WELL LOCATION AND ACREAGE DEDICATION PLAT

All Distances must be from the outer boundaries of the section

Operator ARCO OIL AND GAS COMPANY			Lease W. C. ROACH		Well No. 7
Unit Letter K	Section 21	Township T-20-S	Range R-37-E	County LEA	
Actual Footage Location of Well: 1980 feet from the SOUTH line and 1980 feet from the WEST line					
Ground level Elev. 3509	Producing Formation YATES/7-RIVERS/QUEEN		Pool EUMONT GAS	Dedicated Acreage: 280 Acres	

1. Outline the acreage dedicated to the subject well by colored pencil or hatchure marks on the plat below.

2. If more than one lease is dedicated to the well, outline each and identify the ownership thereof (both as to working interest and royalty).

3. If more than one lease of different ownership is dedicated to the well, have the interest of all owners been consolidated by communitization, unitization, force-pooling, etc.?

☐ Yes ☐ No If answer is "yes" type of consolidation

If answer is "no" list the owners and tract descriptions which have actually been consolidated. (Use reverse side of this form if necessary.)

No allowable will be assigned to the well until all interests have been consolidated (by communitization, unitization, forced-pooling, or otherwise) or until a non-standard unit, eliminating such interest, has been approved by the Division.

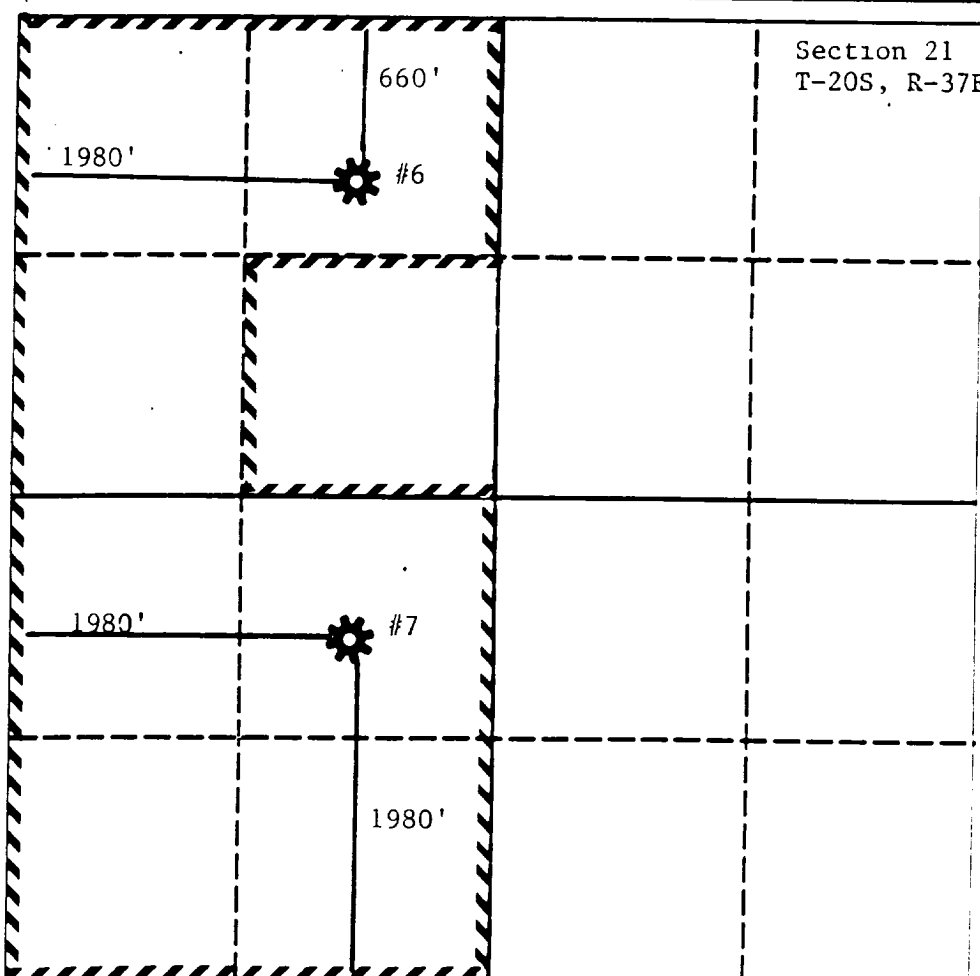

OPERATOR CERTIFICATION

I hereby certify that the information contained herein is true and complete to the best of my knowledge and belief.

Signature

Evelyn E. Gilson

Printed Name

EVELYN GILSON

Position

ENGINEERING TECHNICIAN

Company

ARCO OIL AND GAS COMPANY

Date

JANUARY 28, 1993

SURVEYOR CERTIFICATION

I hereby certify that the well location shown on this plat was plotted from field notes of actual surveys made by me or under my supervision, and that the same is true and correct to the best of my knowledge and belief.

Date Surveyed

Signature & Seal of
Professional Surveyor

Certificate No.

0 330 660 990 1320 1650 1980 2310 2640 2000 1500 1000 500 0

Submit to Appropriate
District Office
State Lease - 4 copies
Fee Lease - 3 copies

State of New Mexico
Energy, Minerals and Natural Resources Department

Form C-102
Revised 1-1-89

OIL CONSERVATION DIVISION

P.O. Box 2088
Santa Fe, New Mexico 87504-2088

DISTRICT I
P.O. Box 1980, Hobbs, NM 88240

DISTRICT II
P.O. Drawer DD, Artesia, NM 88210

DISTRICT III
1000 Rio Brazos Rd., Aztec, NM 87410

WELL LOCATION AND ACREAGE DEDICATION PLAT

All Distances must be from the outer boundaries of the section

Operator ARCO OIL AND GAS COMPANY			Lease W. C. ROACH		Well No. 5
Unit Letter F	Section 21	Township T-20-S	Range R-37-E	County LEA	
Actual Footage Location of Well: 1650 feet from the NORTH line and 1650 feet from the WEST line					
Ground level Elev. 3512	Producing Formation YATES / 7-RIVERS / QUEEN		Pool EUMONT OIL	Dedicated Acreage: 40 Acres	

- Outline the acreage dedicated to the subject well by colored pencil or hachure marks on the plat below.
- If more than one lease is dedicated to the well, outline each and identify the ownership thereof (both as to working interest and royalty).
- If more than one lease of different ownership is dedicated to the well, have the interest of all owners been consolidated by communitization, unitization, force-pooling, etc.?
☐ Yes ☐ No If answer is "yes" type of consolidation _____
If answer is "no" list the owners and tract descriptions which have actually been consolidated. (Use reverse side of this form if necessary.)
No allowable well be assigned to the well until all interests have been consolidated (by communitization, unitization, forced-pooling, or otherwise) or until a non-standard unit, eliminating such interest, has been approved by the Division.

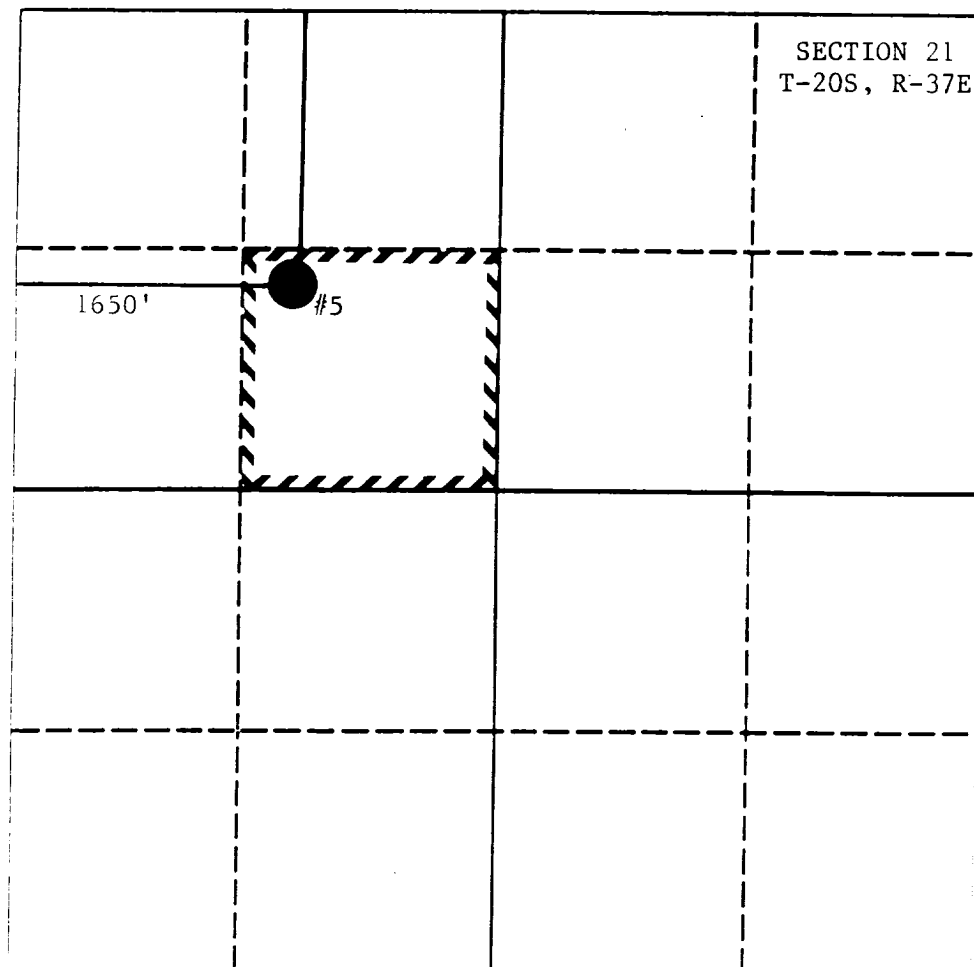

OPERATOR CERTIFICATION

I hereby certify that the information contained herein is true and complete to the best of my knowledge and belief.

Signature

Evelyn E. Gilson

Printed Name

EVELYN GILSON

Position

ENGINEERING TECHNICIAN

Company

ARCO OIL AND GAS COMPANY

Date

JANUARY 29, 1993

SURVEYOR CERTIFICATION

I hereby certify that the well location shown on this plat was plotted from field notes of actual surveys made by me or under my supervision, and that the same is true and correct to the best of my knowledge and belief.

Date Surveyed

Signature & Seal of
Professional Surveyor

Certificate No.

0 330 660 990 1320 1650 1980 2310 2640 2000 1500 1000 500 0

Submit to Appropriate
District Office
State Lease - 6 copies
Fee Lease - 5 copies
DISTRICT I
P.O. Box 1980, Hobbs, NM 88240

DISTRICT II
P.O. Drawer DD, Artesia, NM 88210

DISTRICT III
1000 Rio Brazos Rd., Aztec, NM 87410

State of New Mexico
Energy, Minerals and Natural Resources Department

OIL CONSERVATION DIVISION

P.O. Box 2088
Santa Fe, New Mexico 87504-2088

Form C-105
Revised 1-1-89

WELL API NO.	30-025-24418
5. Indicate Type of Lease	STATE <input type="checkbox"/> FEE <input checked="" type="checkbox"/>
6. State Oil & Gas Lease No.	

WELL COMPLETION OR RECOMPLETION REPORT AND LOG

1a. Type of Well: OIL WELL <input checked="" type="checkbox"/> GAS WELL <input type="checkbox"/> DRY <input type="checkbox"/> OTHER _____		7. Lease Name or Unit Agreement Name W. C. ROACH
b. Type of Completion: NEW WELL <input type="checkbox"/> WORK OVER <input type="checkbox"/> DEEPEN <input type="checkbox"/> PLUG BACK <input type="checkbox"/> DIFF RESVR <input type="checkbox"/> OTHER _____		
2. Name of Operator ARCO OIL & GAS COMPANY		8. Well No. 5
3. Address of Operator P O BOX 1710 HOBBS, NEW MEXICO 88240		9. Pool name or Wildcat EUMONT YATES 7RQ
4. Well Location Unit Letter <u>F</u> : <u>1650</u> Feet From The <u>North</u> Line and <u>1650</u> Feet From The <u>WEST</u> Line Section <u>21</u> Township <u>20 S</u> Range <u>37 E</u> NMPM LEA County		
10. Date Spudded 12/14/92	11. Date T.D. Reached	12. Date Compl. (Ready to Prod.) 1/7/93
13. Elevations (DF& RKB, RT, GR, etc.) 3512 GR	14. Elev. Casinghead	
15. Total Depth 3808	16. Plug Back T.D. 3608	17. If Multiple Compl. How Many Zones?
18. Intervals Drilled By Rotary Tools		Cable Tools
19. Producing Interval(s), of this completion - Top, Bottom, Name 3266-3593 / .37 1JSPF/ 35 SHOTS		20. Was Directional Survey Made NO
21. Type Electric and Other Logs Run CBL / CCL		22. Was Well Cored NO

CASING RECORD (Report all strings set in well)

CASING SIZE	WEIGHT LB/FT.	DEPTH SET	HOLE SIZE	CEMENTING RECORD	AMOUNT PULLED
8 5/8	24	426		325	0
4 1/2	9.5	3808		550 ORB + 403 SX	0

24. LINER RECORD				25. TUBING RECORD		
SIZE	TOP	BOTTOM	SACKS CEMENT	SCREEN	SIZE	DEPTH SET
					2 3/8	3555
						PACKER SET
						NO

26. Perforation record (interval, size, and number) 3266-3593 / .37 1JSPF/ 35 SHOTS	27. ACID, SHOT, FRACTURE, CEMENT, SQUEEZE, ETC. DEPTH INTERVAL 3266-3593 AMOUNT AND KIND MATERIAL USED 4200 GAL H ₂ O. FRAC W/229 TONS CO ₂ & 274,000# 12/20 SAND
--	---

28. PRODUCTION	
Date First Production 1/7/93	Production Method (Flowing, gas lift, pumping - Size and type pump) PUMPING, 2 X 1 1/4 X 3 X 12 RWTC
Date of Test 1/15/93	Hours Tested 24
Flow Tubing Press.	Casing Pressure 115
Calculated 24-Hour Rate	Oil - Bbl. 8
Gas - MCF 400	Water - Bbl. 1
Gas - Oil Ratio 50.000	Oil Gravity - API - (Corr.)

29. Disposition of Gas (Sold, used for fuel, vented, etc.) SOLD	Test Witnessed By
--	-------------------

30. List Attachments

31. I hereby certify that the information shown on both sides of this form is true and complete to the best of my knowledge and belief

Signature James Cogburn Printed Name James Cogburn Title Operations Coordinator Date 1/20/93