

STATE OF NEW MEXICO
ENERGY AND MINERALS DEPARTMENT

OIL CONSERVATION DIVISION

P. O. BOX 2088
SANTA FE, NEW MEXICO 87501

Form C-102
Revised 10-1-78

All distances must be from the outer boundaries of the Section.

Operator Minerals, Inc.		Lease Llano "3" State Com.		Well No. 1
Unit Letter H	Section 3	Township 22 South	Range 34 East	County Lea

Actual Footage Location of Well:

1980 feet from the North line and 660 feet from the East line	
Ground Level Elev. 3592.5	Producing Formation Bone Springs
Pool Undesignated	
Dedicated Acreage: 40 Acres	

1. Outline the acreage dedicated to the subject well by colored pencil or hatchure marks on the plat below.
2. If more than one lease is dedicated to the well, outline each and identify the ownership thereof (both as to working interest and royalty).
3. If more than one lease of different ownership is dedicated to the well, have the interests of all owners been consolidated by communitization, unitization, force-pooling, etc?

☒ Yes ☐ No If answer is "yes," type of consolidation Communitization

If answer is "no," list the owners and tract descriptions which have actually been consolidated. (Use reverse side of this form if necessary.)

No allowable will be assigned to the well until all interests have been consolidated (by communitization, unitization, forced-pooling, or otherwise) or until a non-standard unit, eliminating such interests, has been approved by the Division.

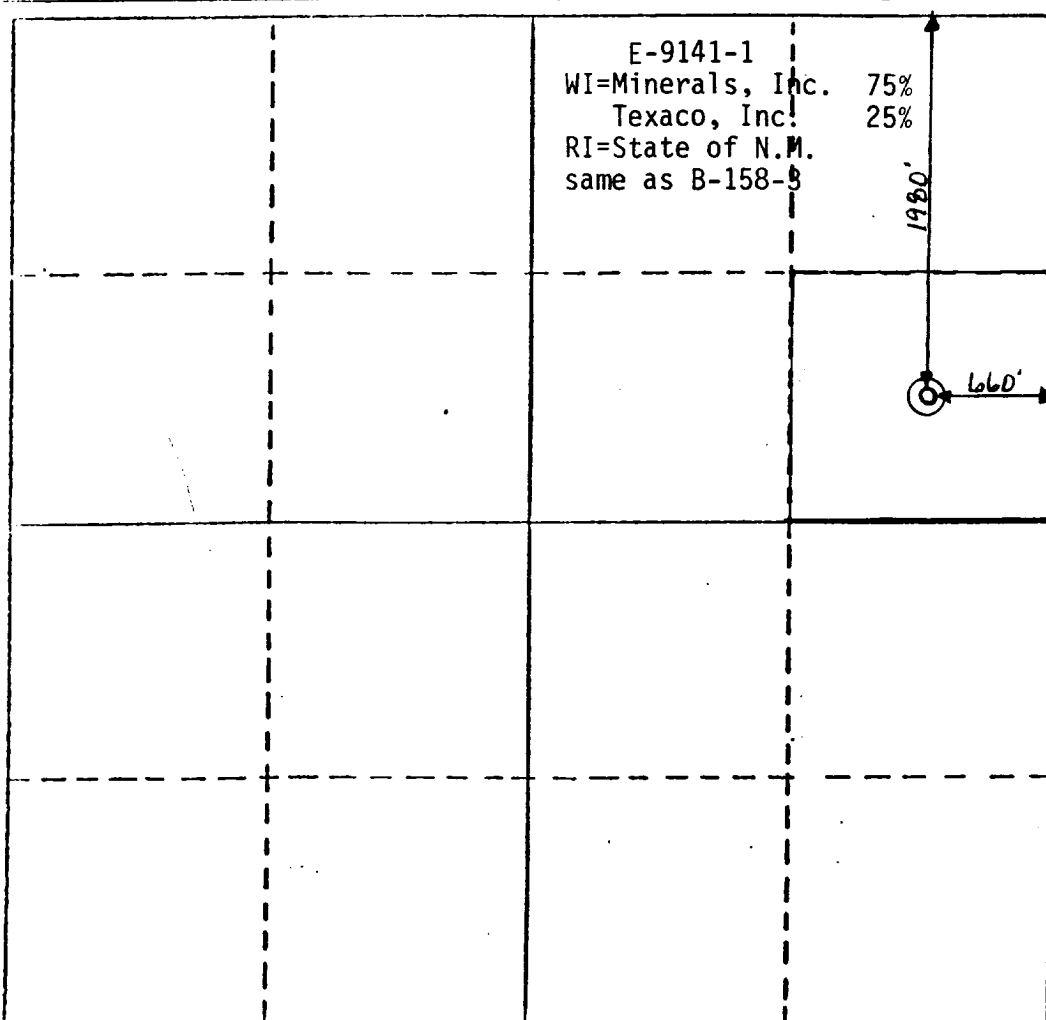

CERTIFICATION

I hereby certify that the information contained herein is true and complete to the best of my knowledge and belief.

Al Flaar

Name
Al Flaar
Position
Vice-President, Engineering
Company
Minerals, Inc.
Date
4-27-83

I hereby certify that the well location shown on this plat was plotted from field notes of actual surveys made by me or under my supervision, and that the same is true and correct to the best of my knowledge and belief.

Date Surveyed

Registered Professional Engineer
and/or Land Surveyor

Certificate No.

330 660 990 1320 1650 1980 2310 2640 2970 3300 3630 3960 4290 4620 4950 5280 5610 5940 6270 6600

RECEIVED

APR 28 1983

C.C.D.
HOBBS OFFICE

NEW MEXICO
OIL CONSERVATION DIVISION
BOX 2045
HOBBS, NEW MEXICO 88240

NOTICE OF GAS DISCONNECTION

DATE February 19, 1981

THIS IS TO NOTIFY THE OIL CONSERVATION DIVISION THAT DISCONNECTION OF GAS FROM
THE Minerals, Inc., Llano "3" State Com.
OPERATOR LEASE

1 H, 3-22S-34E, Grama Ridge Bone Springs,
WELL-UNIT S-T-R POOL

LLANO, INC., WAS MADE ON October 13, 1980.
NAME OF TRANSPORTER

LLANO'S STATION NUMBER

259

LLANO, INC.
TRANSPORTER

REPRESENTATIVE

MANAGER OF PETROLEUM AND
NATURAL GAS ENGINEERING
TITLE

xc: To Oil Conservation Division P. O. Box 2088 Santa Fe, New Mexico 87501
xc: To Operator

RECEIVED

FEB 20 1961

U.S. DEPARTMENT OF AGRICULTURE