

UNITED STATES
DEPARTMENT OF THE INTERIOR
GEOLOGICAL SURVEY

APPLICATION FOR PERMIT TO DRILL, DEEPEN, OR PLUG BACK

1a. TYPE OF WORK

DRILL ☒PLUG BACK ☐

b. TYPE OF WELL

OIL

WELL ☐

GAS

WELL ☒OTHER ☐

SING

ZONE ☒

MULTIPLE

ZONE ☐

2. NAME OF OPERATOR

Getty Oil Company

3. ADDRESS OF OPERATOR

P. O. Box 730

4. LOCATION OF WELL (Report location clearly and in accordance with any State requirements.*)

At surface

Unit Letter "F" Section 18, T-22S, R-32E

1980 FNL&1780 FWL Lea County, New Mexico

At proposed prod. zone

14. DISTANCE IN MILES AND DIRECTION FROM NEAREST TOWN OR POST OFFICE*

33 miles west of Eunice, New Mexico

15. DISTANCE FROM PROPOSED*

LOCATION TO NEAREST

PROPERTY OR LEASE LINE, FT.

(Also to nearest drlg. unit line, if any)

1780'

16. NO. OF ACRES IN LEASE

320

17. NO. OF ACRES ASSIGNED

TO THIS WELL

320

18. DISTANCE FROM PROPOSED LOCATION*

TO NEAREST WELL, DRILLING, COMPLETED,
OR APPLIED FOR, ON THIS LEASE, FT.

None

19. PROPOSED DEPTH

15,000'

20. ROTARY OR CABLE TOOLS

Rotary

21. ELEVATIONS (Show whether DF, RT, GR, etc.)

3653.0' G.L.

22. APPROX. DATE WORK WILL START*

July 1981

23.

PROPOSED CASING AND CEMENTING PROGRAM

SIZE OF HOLE	SIZE OF CASING	WEIGHT PER FOOT	SETTING DEPTH	QUANTITY OF CEMENT
26"	20"	94	40'	Ready Mix
17 1/2"	13 3/8"	48	900'	1100 sxs
12 1/4"	9 5/8"	36 & 40	4700'	2450 sxs
8 1/2"	7"	26	11,800'	3100 sxs
6 1/8"	5" Liner	18	11,500-15,000'	310 sxs

1. The subject well will be drilled from surface to 11,800' with brine of sufficient weight and gel additives to control formation pressures and condition the hole for electric logs and running of casing. The mud will be a 10-12 ppg. oil base low solids low fluid loss mud from 11,800' to 15,000' (TD).
2. The pump and plug method will be used in cementing all strings of casing. The 13 3/8", 9 5/8" and 7" casing will be cemented to the surface. The 5" liner will be set at TD with the top at approximately 11,500' inside the 7" casing and cemented from bottom to top.
3. See attachment for BOP program.

GAS NOT DEDICATED.

IN ABOVE SPACE DESCRIBE PROPOSED PROGRAM: If proposal is to deepen or plug back, give data on present productive zone and proposed new productive zone. If proposal is to drill or deepen directionally, give pertinent data on subsurface locations and measured and true vertical depths. Give blowout preventer program, if any.

24.

SIGNED

Dale R. Crockett

TITLE Area Superintendent

DATE 3/16/81

(This space for Federal or State office use)

APPROVED

PERMIT NO.

APPROVAL DATE

APPROVED BY
CONDITION OF APPROVAL, IF ANY:

MAY 19 1981

TITLE

DATE

FOR

JAMES A. GILLHAM
DISTRICT SUPERVISOR

*See Instructions On Reverse Side

NEW MEXICO OIL CONSERVATION COMMISSION
WELL LOCATION AND ACREAGE DEDICATION PLAT

Form C-102
Supersedes C-128
Effective 1-1-65

All distances must be from the outer boundaries of the Section

Operator GETTY OIL COMPANY			Lease Beta 18 Federal		Well No. 1
Section 18	Township 22 South	Range 32 East	County Lea		
Actual Footage Location of Well: 1780' North Line and 1780' East Line Ground Elev. Elev. 3653 Producing Formation Undesignated Morrow Pool Morrow Dedicated Acreage: 320 Acres					

1. Outline the acreage dedicated to the subject well by colored pencil or hachure marks on the plat below.
2. If more than one lease is dedicated to the well, outline each and identify the ownership thereof (both as to working interest and royalty).
3. If more than one lease of different ownership is dedicated to the well, have the interests of all owners been consolidated by communitization, unitization, force-pooling, etc?

☐ Yes ☒ No If answer is "yes," type of consolidation _____

If answer is "no," list the owners and tract descriptions which have actually been consolidated (Use reverse side of this form if necessary.) _____

No allowable will be assigned to the well until all interests have been consolidated (by communitization, unitization, forced-pooling, or otherwise) or until a non-standard unit, eliminating such interests, has been approved by the Commission.

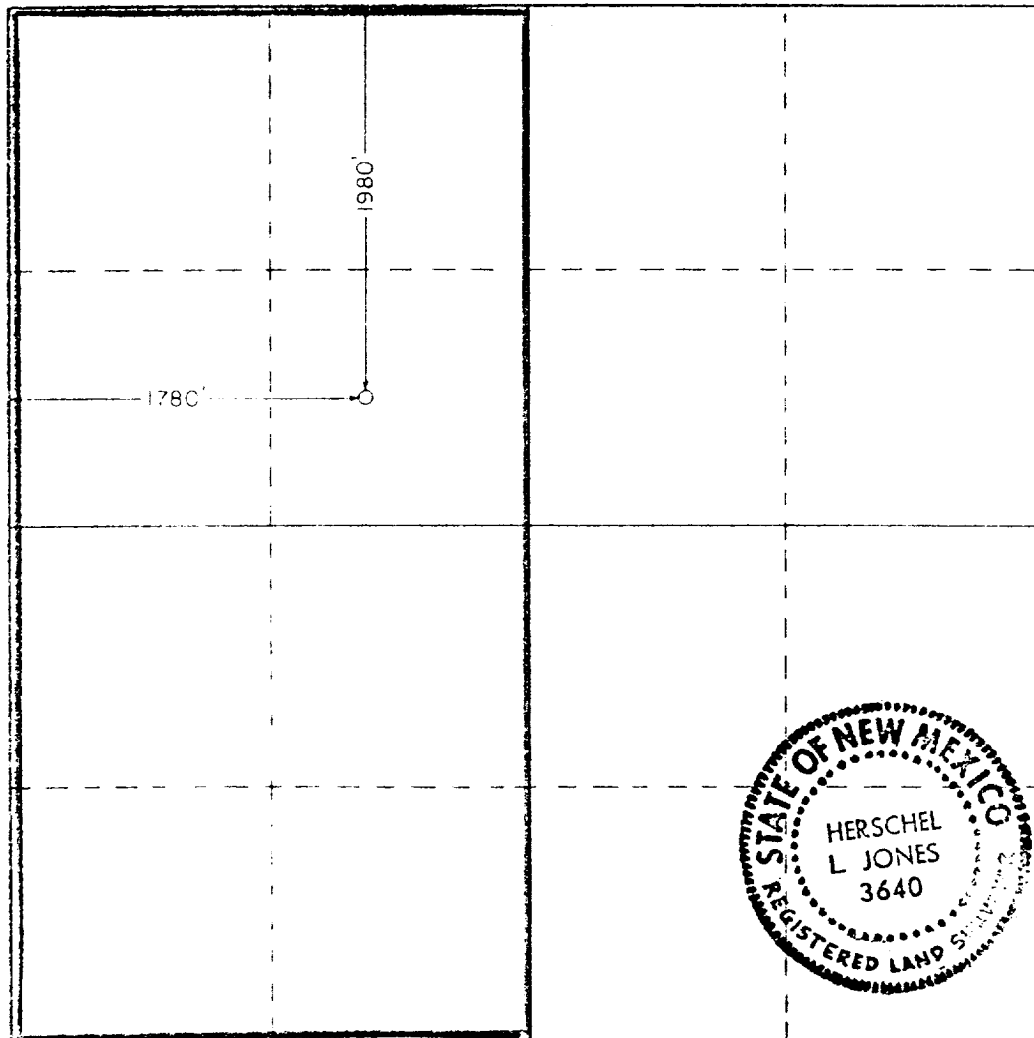

CERTIFICATION

I hereby certify that the information contained herein is true and complete to the best of my knowledge and belief.

Dale R. Crockett

Dale R. Crockett

Present as

Area Superintendent

Company

Getty Oil Company

Date

3/16/81

I hereby certify that the well location shown on this plat was plotted from field notes of actual surveys made by me or under my supervision, and that the same is true and correct to the best of my knowledge and belief.

Date Surveyed

February 26, 1981

Registered Professional Engineer and Land Surveyor

Herschel L Jones

Certificate No.

3640