

NO. OF COPIES RECEIVED		
DISTRIBUTION		
SANTA FE		
FILE		
U.S.G.S.		
LAND OFFICE		
OPERATOR		

Form C-101
Revised 1-1-65

5A. Indicate Type of Lease
STATE ☒ FEE ☐
5. State Oil & Gas Lease No.
E-8077

1a. Type of Work				7. Unit Agreement Name					
b. Type of Well OIL WELL <input checked="" type="checkbox"/> GAS WELL <input type="checkbox"/> OTHER <input type="checkbox"/>				DRILL <input checked="" type="checkbox"/> DEEPEN <input type="checkbox"/> PLUG BACK <input type="checkbox"/>					
2. Name of Operator				8. Farm or Lease Name					
ARCO Oil and Gas Company, Div. of Atlantic Richfield Company				State 731					
3. Address of Operator				9. Well No.					
P. O. Box 1710, Hobbs, New Mexico 88240				2					
4. Location of Well				10. Field and Pool, or Wildcat					
UNIT LETTER A LOCATED 660 FEET FROM THE North LINE				Jalmat Yates 7Rivers					
AND 330 FEET FROM THE East LINE OF SEC. 26 TWP. 22S RGE. 35E NMPM									
				12. County					
				Lea					
21. Elevations (Show whether DF, RT, etc.)		21A. Kind & Status Plug. Bond		19. Proposed Depth		19A. Formation		20. Rotary or C.T.	
3565.4' GR		GCA #8		4000'		Yates 7Rivers		Rotary	
21B. Drilling Contractor				22. Approx. Date Work will start					
Not selected				7/13/81					

SIZE OF HOLE	SIZE OF CASING	WEIGHT PER FOOT	SETTING DEPTH	SACKS OF CEMENT	EST. TOP
17½"	13-3/8" OD	54.5#	30'	4 yds Redi-mix	
12½"	8-5/8" OD	24# K-55	1700'	925	Circ to surf.
7-7/8"	5½" OD	15.5# K-55	4000'	1025	Circ to surf

Blowout Preventer Program attached.

APPROVAL VALID FOR 180 DAYS
PERMIT EXPIRES 12/11/81
UNLESS DRILLING UNDERWAY

IN ABOVE SPACE DESCRIBE PROPOSED PROGRAM; IF PROPOSAL IS TO DEEPEN OR PLUG BACK, GIVE DATA ON PRESENT PRODUCTIVE ZONE AND PROPOSED NEW PRODUCTIVE ZONE. GIVE BLOWOUT PREVENTER PROGRAM, IF ANY.

I hereby certify that the information above is true and complete to the best of my knowledge and belief.

Signed D. W. Schmidt Title Dist. Drlg. Supt. Date 6/9/81

(This space for State Use)

APPROVED BY [Signature] TITLE _____ DATE _____

CONDITIONS OF APPROVAL, IF ANY:

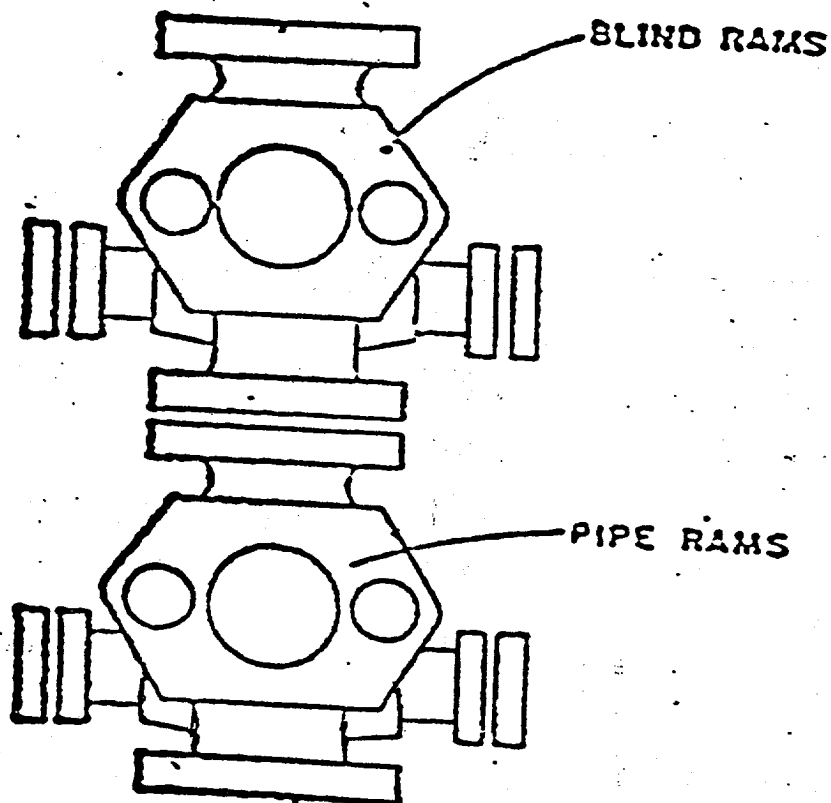

ARCO Oil & Gas Company
Division of Atlantic Richfield Company
Blow Out Preventer Program

Lease Name State 731

Well No. 2

Location .660' FNL & 330' FEL
Sec 26-22S-35E, Lea County

BOP to be tested before installed on well and will be maintained in good working condition during drilling. All wellhead fittings to be of sufficient pressure to operate in a safe manner.

NEW MEXICO OIL CONSERVATION COMMISS. 4
WELL LOCATION AND ACREAGE DEDICATION PLAT

Form C-102
Supersedes C-128
Effective 1-1-65

All distances must be from the outer boundaries of the Section.

Operator Div. of Atlantic Richfield Co. ARCO Oil & Gas Co.			Lease State 731		Well No. 2
Unit Letter A	Section 26	Township 22 South	Range 35 East	County Lea	
Actual Footage Location of Well: 660 feet from the north line and 330 feet from the east line					
Ground Level Elev. 3565.4	Producing Formation Yates 7Rivers		Pool Jalmat	Dedicated Acreage: 40 Acres	

1. Outline the acreage dedicated to the subject well by colored pencil or hachure marks on the plat below.
2. If more than one lease is dedicated to the well, outline each and identify the ownership thereof (both as to working interest and royalty).
3. If more than one lease of different ownership is dedicated to the well, have the interests of all owners been consolidated by communization, unitization, force-pooling, etc?

☐ Yes ☐ No If answer is "yes," type of consolidation _____

If answer is "no," list the owners and tract descriptions which have actually been consolidated. (Use reverse side of this form if necessary.) _____

No allowable will be assigned to the well until all interests have been consolidated (by communization, unitization, forced-pooling, or otherwise) or until a non-standard unit, eliminating such interests, has been approved by the Commission.

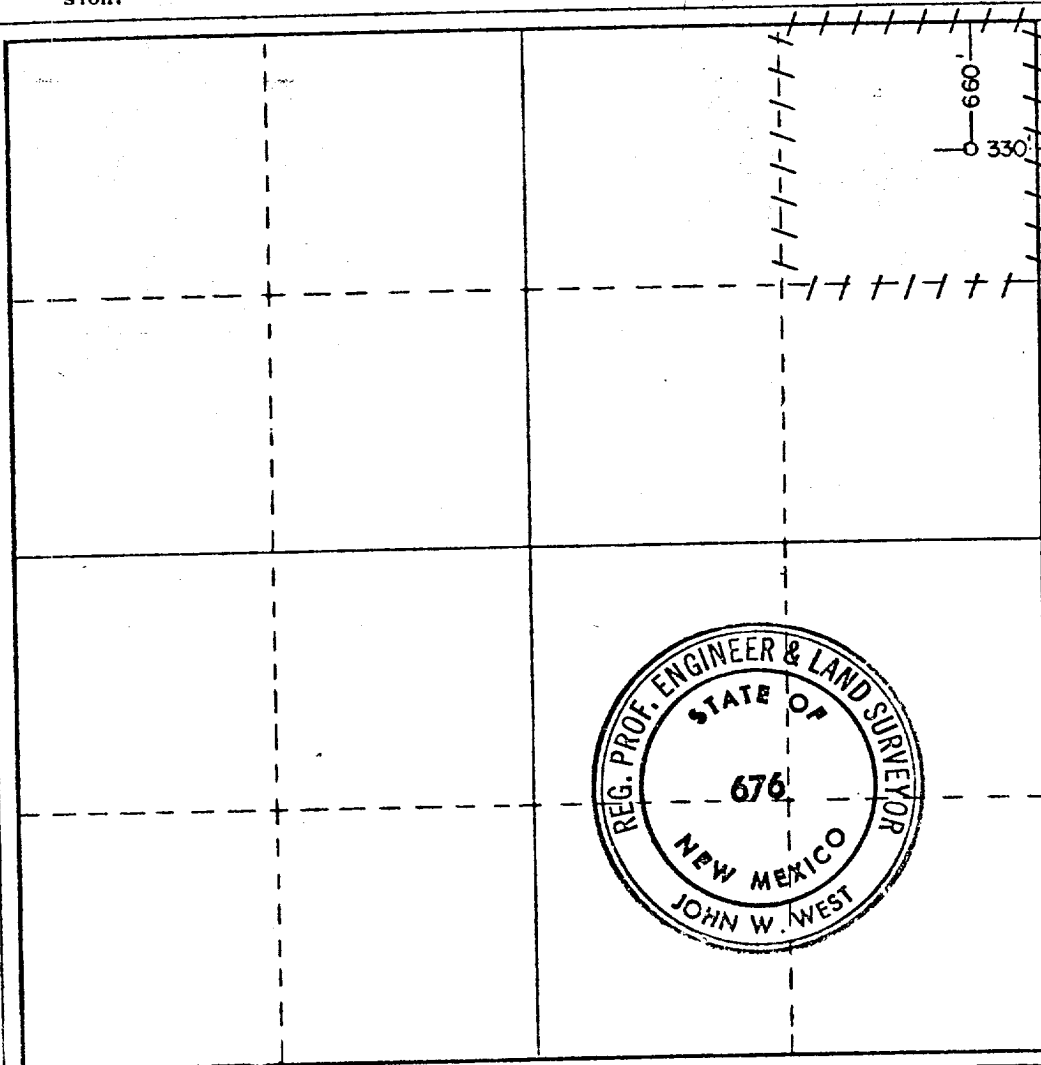

CERTIFICATION

I hereby certify that the information contained herein is true and complete to the best of my knowledge and belief.

Name

John W. West

Position

Dist. Drlg. Supt.

Company **ARCO Oil and Gas Co.**

Div. of Atlantic Richfield Co.

Date

6/09/81

I hereby certify that the well location shown on this plat was plotted from field notes of actual surveys made by me or under my supervision, and that the same is true and correct to the best of my knowledge and belief.

Date Surveyed

June 3, 1981

Registered Professional Engineer and/or Land Surveyor

John W. West

Certificate No **JOHN W. WEST 676**
PATRICK A. ROMERO 6863
Ronald J. Eldon 3239

0 330 660 990 1320 1650 1980 2310 2640 2000 1500 1000 500