

N MEXICO OIL CONSERVATION COMMISSION
WELL LOCATION AND ACREAGE DEDICATION PLAT

Form C-12
Supersedes C-128
Effective 1-1-85

All distances must be from the outer boundaries of the Section

Operator The Superior Oil Co.		Lease SSP State 7 <i>SS2</i>		Well 1
Section Letter J	Section 7	Township 22 South	Range 33 East	Lea
Approximate Location of Well: 1980 feet from the south line and 1980 feet from the east line				
Ground Surface Elev. 3591.3	Producing Formation Morrow	Pool UNDESIGNATED	Estimated Acreage 320	

1. Outline the acreage dedicated to the subject well by colored pencil or hatchure marks on the plat below.
2. If more than one lease is dedicated to the well, outline each and identify the ownership thereof (both as to working interest and royalty).
3. If more than one lease of different ownership is dedicated to the well, have the interests of all owners been consolidated by communitization, unitization, force-pooling, etc?

☐ Yes ☐ No If answer is "yes," type of consolidation _____

If answer is "no," list the owners and tract descriptions which have actually been consolidated (Use reverse side of this form if necessary.) _____

No allowable will be assigned to the well until all interests have been consolidated (by communitization, unitization, forced-pooling, or otherwise) or until a non-standard unit, eliminating such interests, has been approved by the Commission.

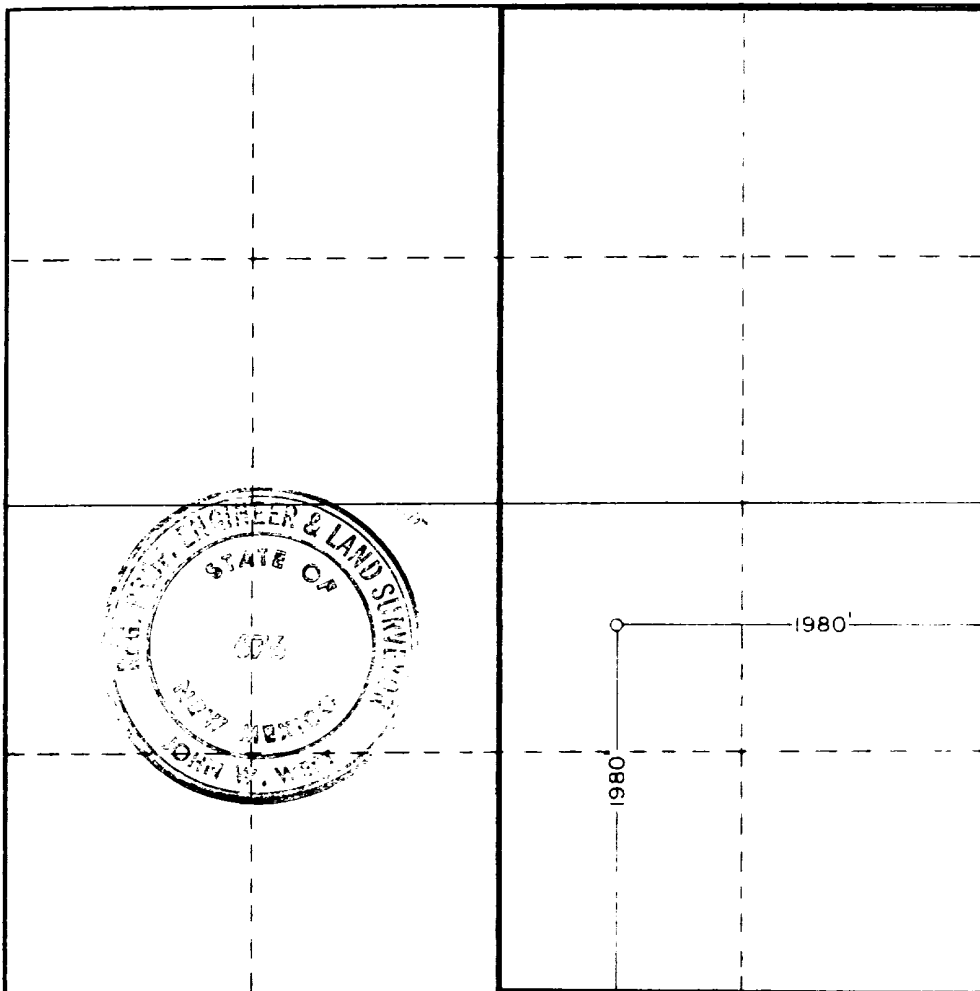

CERTIFICATION

I hereby certify that the information contained hereon is true and complete to the best of my knowledge and belief

G. Bannantine

G. Bannantine

Position

Regulatory Group Manager

Company

THE SUPERIOR OIL COMPANY

Date

June 22, 1981

I hereby certify that the well location shown on this plat was plotted from field notes of actual surveys made by me or under my supervision, and that the same is true and correct to the best of my knowledge and belief

Date Surveyed

June 5, 1981

Registered Professional Engineer and Land Surveyor

John W. West

Certificate No. **JOHN W. WEST 676**
PATRICK A. ROMERO 6883
Ronald J. Eidson 3239

0 330 660 990 1320 1650 1980 2310 2640 2970 3300 3630 3960 4290 4620 4950 5280 5610 5940 6270 6600

Page 17

JUN 25 1981

11:11 AM

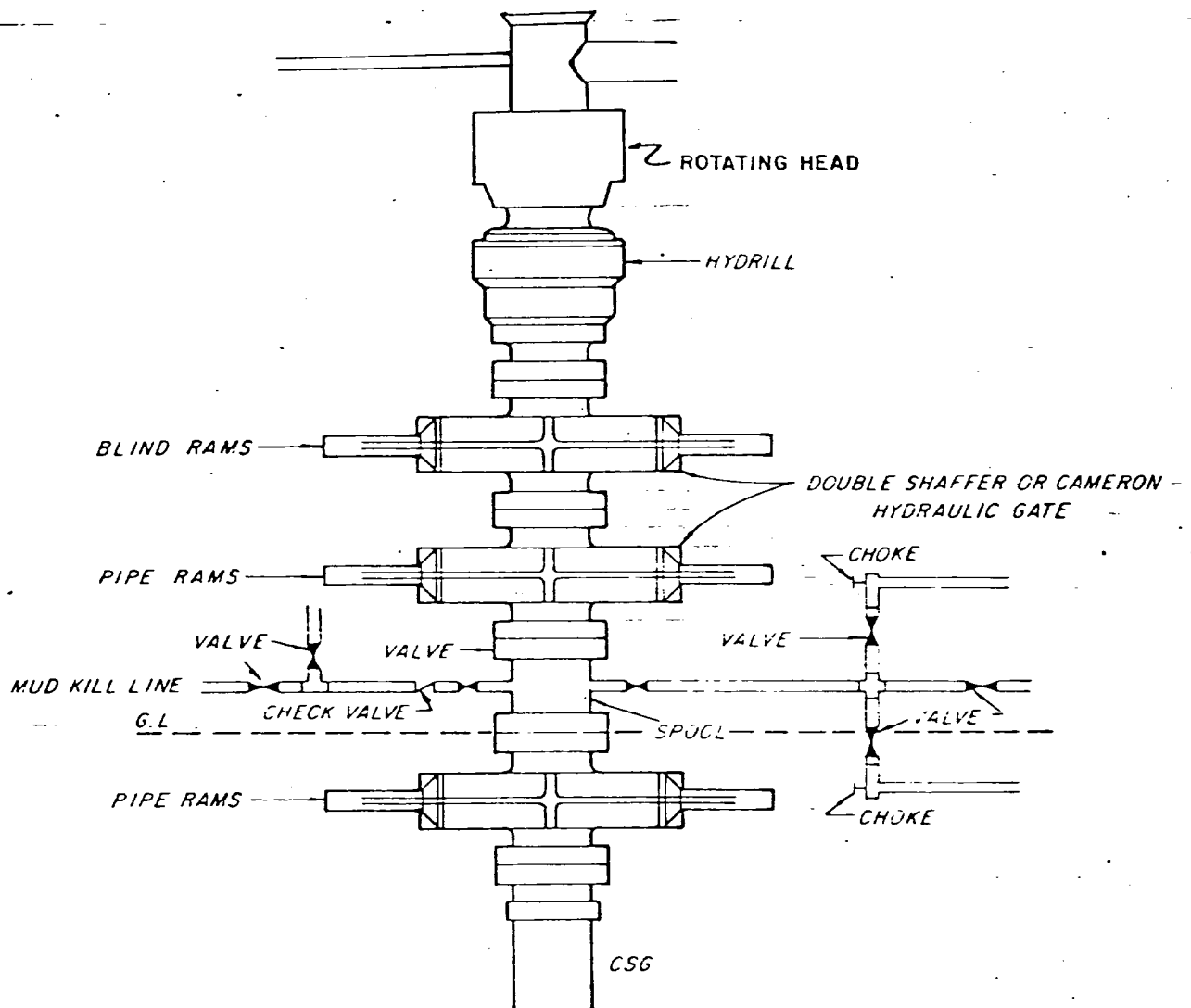

API SERIES 1500

NOTE:

Manual and Hydraulic controls with closing unit no less than 75' from well head.
Remote controls on rig floor.

THE SUPERIOR OIL CO.
WESTERN DIVISION



BLOW-OUT PREVENTER
SPECIFICATIONS

1471

RECEIVED

JUL 2 1991

OIL CONSERVATION DIV.

173