

M. M. OIL CONS. COMMISSION  
P. O. BOX 1930  
HOBBS, NEW MEXICO 88240

UNITED STATES  
DEPARTMENT OF THE INTERIOR  
GEOLOGICAL SURVEY

APPLICATION FOR PERMIT TO DRILL, DEEPEN, OR PLUG BACK

1a. TYPE OF WORK  
DRILL ☒ DEEPEN ☐ PLUG BACK ☐

b. TYPE OF WELL  
OIL WELL ☒ GAS WELL ☐ OTHER ☐ SINGLE ZONE ☐ MULTIPLE ZONE ☒

2. NAME OF OPERATOR  
CONOCO INC.

3. ADDRESS OF OPERATOR  
P. O. Box 460, Hobbs, N.M. 88240

4. LOCATION OF WELL (Report location clearly and in accordance with any State requirements.\*)  
At surface 660' FNL & 2050' FEL

At proposed prod. zone

14. DISTANCE IN MILES AND DIRECTION FROM NEAREST TOWN OR POST OFFICE\*

15. DISTANCE FROM PROPOSED\* LOCATION TO NEAREST PROPERTY OR LEASE LINE, FT. (Also to nearest drlg. unit line, if any)

16. NO. OF ACRES IN LEASE

17. NO. OF ACRES ASSIGNED TO THIS WELL

18. DISTANCE FROM PROPOSED LOCATION\* TO NEAREST WELL, DRILLING, COMPLETED, OR APPLIED FOR, ON THIS LEASE, FT.

19. PROPOSED DEPTH

20. ROTARY OR CABLE TOOLS

21. ELEVATIONS (Show whether DF, RT, GR, etc.)

22. APPROX. DATE WORK WILL START\*

23. PROPOSED CASING AND CEMENTING PROGRAM

24. IN ABOVE SPACE DESCRIBE PROPOSED PROGRAM: If proposal is to deepen or plug back, give data on present productive zone and proposed new productive zone. If proposal is to drill or deepen directionally, give pertinent data on subsurface locations and measured and true vertical depths. Give blowout preventer program, if any.

25. SIGNED *Wm A. Butterfield* TITLE Administrative Supervisor DATE August 4, 1981

APPROVED (Sgt. 3rd) GEORGE H. STEWART

PERMIT NO. APPROVAL DATE

APPROVED BY AUG 20 1981 TITLE DATE

CONDITIONS OF APPROVAL, IF ANY:

JAMES A. GILLHAM DISTRICT SUPERVISOR

\*See Instructions On Reverse Side

5. LEASE DESIGNATION AND SERIAL NO.  
LC-063458  
6. IF INDIAN, ALLOTTEE OR TRIBE NAME  
7. UNIT AGREEMENT NAME  
NMFU  
8. FARM OR LEASE NAME  
Warren Unit  
9. WELL NO.  
90  
10. FIELD AND POOL, OR WILDCAT  
Blinebry / Abo  
11. SEC., T., R. M., OR BLK. AND SURVEY OR AREA  
Sec. 35, T-20S, R-38E  
12. COUNTY OR PARISH  
Lea  
13. STATE  
NM

It is proposed to drill a straight hole to a TD of 7750' and complete it as a Blinebry / Abo dual oil well.

See attachments for 10-point well plan and 13-point Surface Use Plan.

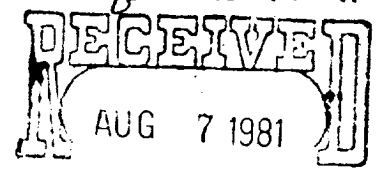

OIL & GAS  
U.S. GEOLOGICAL SURVEY  
ROSWELL, NEW MEXICO

NEW MEXICO OIL CONSERVATION COMM. ON  
WELL LOCATION AND ACREAGE DEDICATION PLAT

Form C-102  
Supersedes C-128  
Effective 1-1-65

All distances must be from the outer boundaries of the Section.

Operator <b>Conoco, Inc.</b>			Lease <b>Warren Unit</b>		Well No. <b>90</b>
Unit Letter <b>B</b>	Section <b>35</b>	Township <b>20South</b>	Range <b>38East</b>	County <b>Lea</b>	

Actual Footage Location of Well:

**2050** feet from the **East** line and **660** feet from the **North** line

Ground Level Elev. <b>3566.2'</b>	Producing Formation <b>Blinberry / Abo</b>	Pool <b>Blinberry Oil &amp; Gas / Abo</b>	Dedicated Acreage: <b>40</b> Acres
--------------------------------------	---	--	---------------------------------------

1. Outline the acreage dedicated to the subject well by colored pencil or hachure marks on the plat below.
2. If more than one lease is dedicated to the well, outline each and identify the ownership thereof (both as to working interest and royalty).
3. If more than one lease of different ownership is dedicated to the well, have the interests of all owners been consolidated by communitization, unitization, force-pooling, etc?

☐ Yes ☐ No If answer is "yes," type of consolidation \_\_\_\_\_

If answer is "no," list the owners and tract descriptions which have actually been consolidated. (Use reverse side of this form if necessary.) \_\_\_\_\_

No allowable will be assigned to the well until all interests have been consolidated (by communitization, unitization, forced-pooling, or otherwise) or until a non-standard unit, eliminating such interests, has been approved by the Commission.

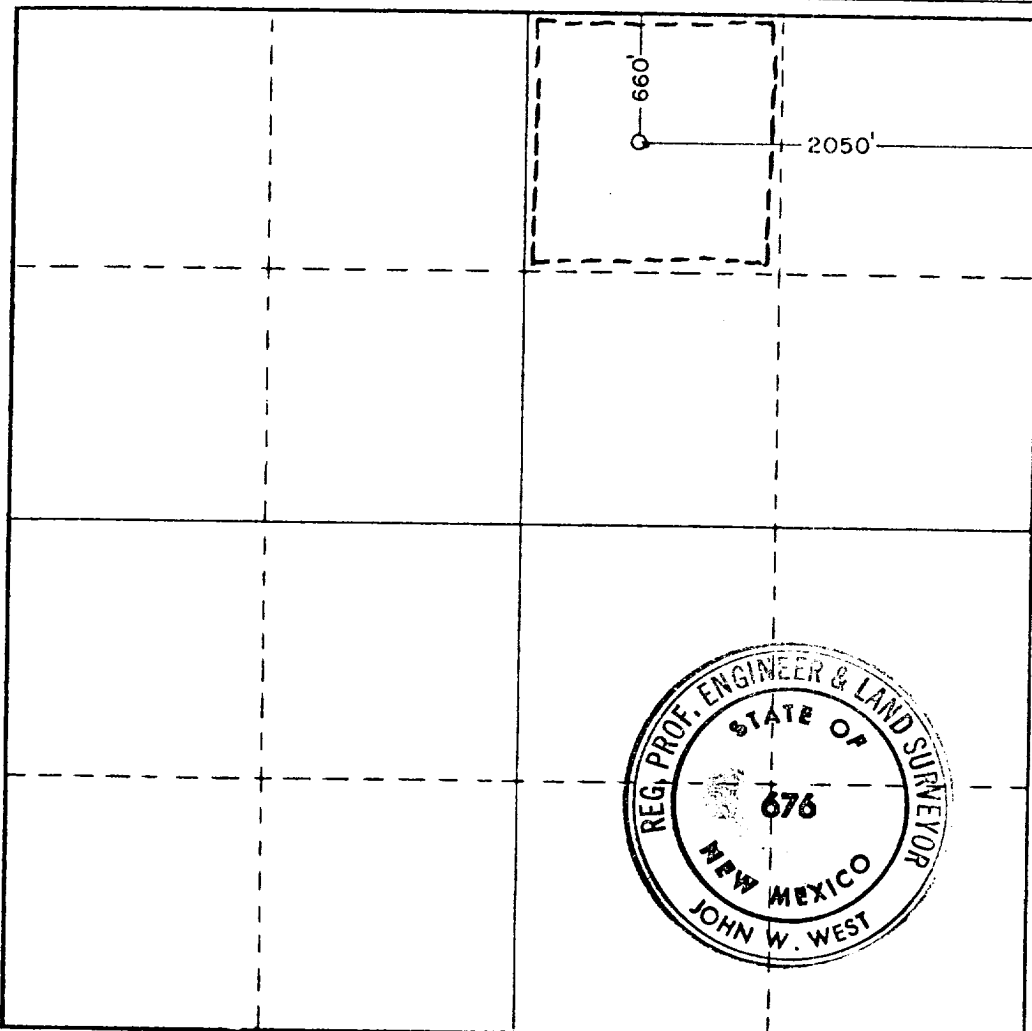

CERTIFICATION

I hereby certify that the information contained herein is true and complete to the best of my knowledge and belief.

Name  
*John W. West*  
Position  
*Administrative Supervisor*  
Company  
*Conoco Inc*

Date  
*August 4, 1981*

I hereby certify that the well location shown on this plat was plotted from field notes of actual surveys made by me or under my supervision, and that the same is true and correct to the best of my knowledge and belief.

Date Surveyed  
**July 16, 1981**

Registered Professional Engineer and/or Land Surveyor

*John W. West*

Certificate No **JOHN W. WEST 676**  
**PATRICK A. ROMERO 6868**  
**Ronald J. Eidson 3239**

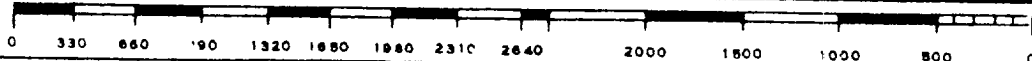

CONTINENTAL OIL COMPANY  
Blow-out Preventer Specifications

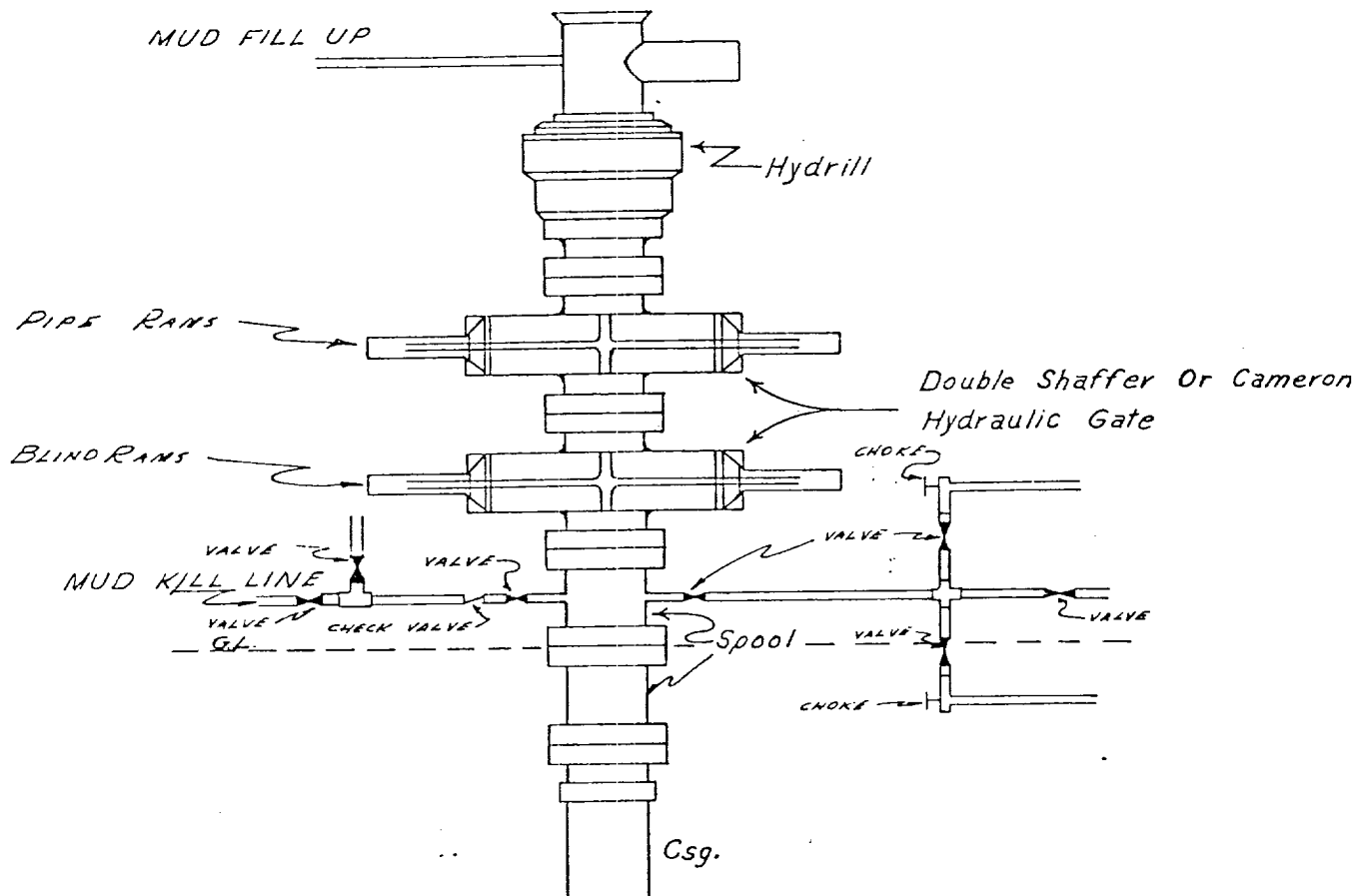

API SERIES 900

NOTE:

Manual and Hydraulic controls with closing unit no less than 75' from well head.  
Remote controls on rig floor.

DUE TO SUBSTRUCTURE CLEARANCE,  
HYDRILL MAY OR MAYNOT BE USED.

ATL

RECEIVED

AUG 24 1981

OIL CONSERVATION DIV