

Submit to Appropriate  
District Office  
State Lease - 6 copies  
Fee Lease - 5 copies

State of New Mexico  
Energy, Minerals and Natural Resources Department

Form C-101  
Revised 1-1-89

DISTRICT I  
P.O. Box 1980, Hobbs, NM 88240

DISTRICT II  
P.O. Drawer DD, Artesia, NM 88210

DISTRICT III  
1000 Rio Brazos Rd., Aztec, NM 87410

OIL CONSERVATION DIVISION

P.O. Box 2088  
Santa Fe, New Mexico 87504-2088

API NO. (assigned by OCD on New Wells)  
30 025 27596

5. Indicate Type of Lease  
STATE ☒ FEE ☐

6. State Oil & Gas Lease No.  
Y-3526

APPLICATION FOR PERMIT TO DRILL, DEEPEN, OR PLUG BACK

1a. Type of Work:

DRILL ☐ RE-ENTER ☒ DEEPEN ☐ PLUG BACK ☐

b. Type of Well:

OIL WELL ☒ GAS WELL ☐ OTHER ☐  
SINGLE ZONE ☒ MULTIPLE ZONE ☐

2. Name of Operator

Mitchell Energy Corporation

3. Address of Operator

P.O. Box 4000 The Woodlands, TX 77387-4000

7. Lease Name or Unit Agreement Name

Bighorn "30" State

8. Well No.

1

9. Pool name or Wildcat

Bootleg Ridge - Delaware

4. Well Location

Unit Letter H : 1980 Feet From The North Line and 660 Feet From The East Line

Section 30 Township 22S Range 33E NMPM Lea County

10. Proposed Depth

5300

11. Formation

Delaware

12. Rotary or C.T.

Rotary

13. Elevations (Show whether DF, RT, GR, etc.)

3696 KB

14. Kind & Status Plug. Bond

Blanket on File

15. Drilling Contractor

16. Approx. Date Work will start

17. PROPOSED CASING AND CEMENT PROGRAM

SIZE OF HOLE	SIZE OF CASING	WEIGHT PER FOOT	SETTING DEPTH	SACKS OF CEMENT	EST. TOP
17-1/2"	13-3/8"	54.5#	711'	750 sx	Surface
12-1/4"	10-3/4"	40.5# & 51.0#	4848'	2050 sx	1150' *
9-1/2"	5-1/2"	15.5#	5300'	350 sx	4300'

Propose to re-enter the Yates Petroleum Pronghorn Unit #2. Will MIRU pulling unit, double set of BOP's, rotating head and reverse unit. Will drill out surface plug & plug at 570-1102' using 9 1/2" bit. GIH & tag plug across 10-3/4" shoe. Circulate 10-lb/gal mud out of hole using fresh water. Drill out plug and GIH to 5300' using 2% KCl water. Circulate & condition hole. POOH. Run 5 1/2" casing to 5300'. Cement with 350 sx Class "C" cement. Hang off casing and NU wellhead. Run GR-CBL log. Perforate Delaware at  $\pm$  4950'. Acidize with 15% HCl. Frac with gelled water and 20/40 sand. Put well on pump and test.

\* One (1) barrel of cement pumped in at top.

IN ABOVE SPACE DESCRIBE PROPOSED PROGRAM: IF PROPOSAL IS TO DEEPEN OR PLUG BACK, GIVE DATA ON PRESENT PRODUCTIVE ZONE AND PROPOSED NEW PRODUCTIVE ZONE. GIVE BLOWOUT PREVENTER PROGRAM, IF ANY.

I hereby certify that the information above is true and complete to the best of my knowledge and belief.

SIGNATURE

George Mullen

TITLE

Regulatory Affairs Specialist

DATE

12-09-92

TYPE OR PRINT NAME

George Mullen

TELEPHONE NO. (713) 377-5855

(This space for State Use)

APPROVED BY

Orig. Signed by  
Paul Kautz  
Geologist

TITLE

DATE

DEC 16 '92

CONDITIONS OF APPROVAL, IF ANY:

Permit Expires 6 Months From Approval  
Date Unless Drilling Underway.

Submit to Appropriate  
District Office  
State Lease - 4 copies  
Fee Lease - 3 copies

State of New Mexico  
Energy, Minerals and Natural Resources Department

Form C-102  
Revised 1-1-89

OIL CONSERVATION DIVISION

P.O. Box 2088  
Santa Fe, New Mexico 87504-2088

DISTRICT I  
P.O. Box 1980, Hobbs, NM 88240

DISTRICT II  
P.O. Drawer DD, Artesia, NM 88210

DISTRICT III  
1000 Rio Brazos Rd., Aztec, NM 87410

WELL LOCATION AND ACREAGE DEDICATION PLAT

All Distances must be from the outer boundaries of the section

Operator Mitchell Energy Corporation			Lease Bighorn "30" State		Well No. 1
Unit Letter H	Section 30	Township 22S	Range 33E	County Lea	NMPM
Actual Footage Location of Well: 1980 feet from the North line and 660 feet from the East line					
Ground level Elev. 3674'	Producing Formation Delaware		Pool Bootleg Ridge-Delaware		Dedicated Acreage: 40 Acres

- Outline the acreage dedicated to the subject well by colored pencil or hatchure marks on the plat below.
- If more than one lease is dedicated to the well, outline each and identify the ownership thereof (both as to working interest and royalty).
- If more than one lease of different ownership is dedicated to the well, have the interest of all owners been consolidated by communitization, unitization, force-pooling, etc.?  
☐ Yes ☐ No If answer is "yes" type of consolidation \_\_\_\_\_  
If answer is "no" list the owners and tract descriptions which have actually been consolidated. (Use reverse side of this form if necessary.) \_\_\_\_\_  
No allowable will be assigned to the well until all interests have been consolidated (by communitization, unitization, forced-pooling, or otherwise) or until a non-standard unit, eliminating such interest, has been approved by the Division.

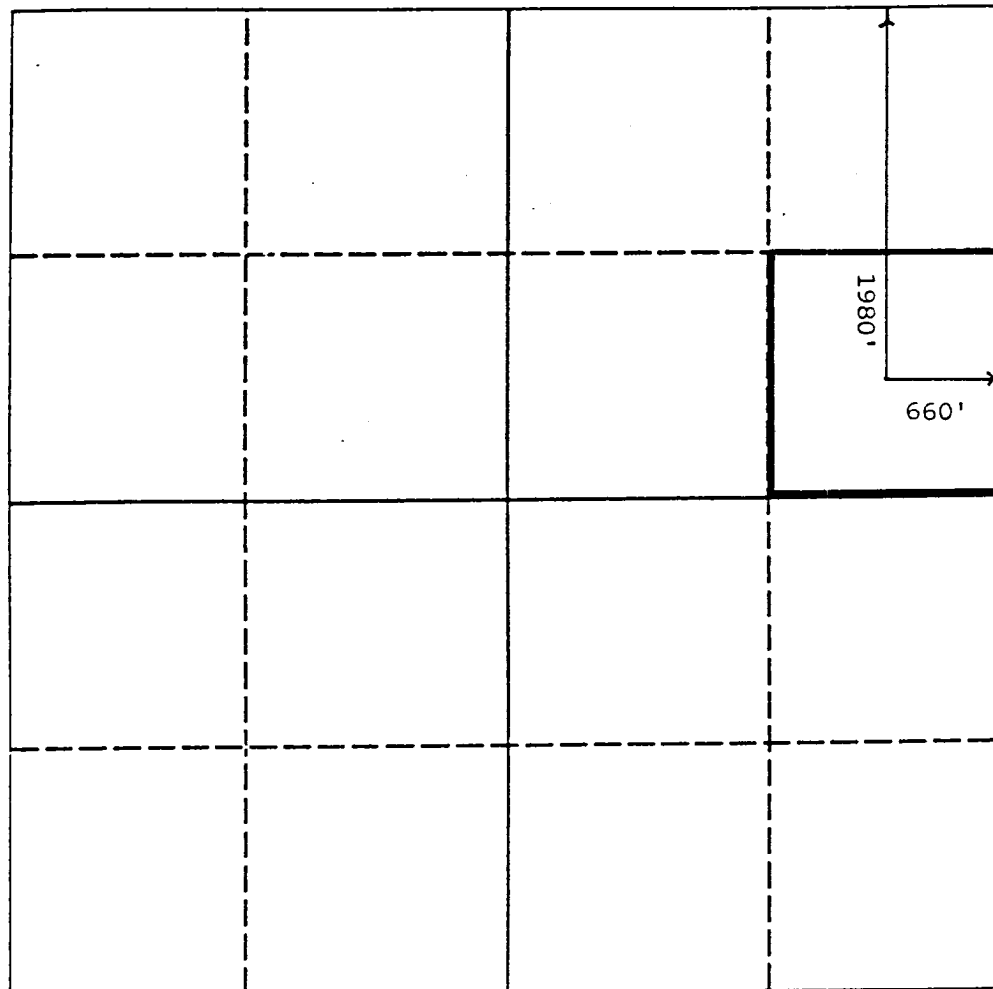

OPERATOR CERTIFICATION

I hereby certify that the information contained herein is true and complete to the best of my knowledge and belief.

Signature  
George Mullen

Printed Name  
George Mullen

Position  
Reg. Affairs Specialist

Company  
Mitchell Energy Corp.

Date  
December 10, 1992

SURVEYOR CERTIFICATION

I hereby certify that the well location shown on this plat was plotted from field notes of actual surveys made by me or under my supervision, and that the same is true and correct to the best of my knowledge and belief.

Date Surveyed

Signature & Seal of  
Professional Surveyor

Certificate No.

