

30-025-27629

NO. OF COPIES RECEIVED	
DISTRIBUTION	
SANTA FE	
FILE	
U.S.G.S.	
LAND OFFICE	
OPERATOR	

NEW MEXICO OIL CONSERVATION COMMISSION

Form C-101
Revised 1-1-65

5A. Indicate Type of Lease STATE <input type="checkbox"/> FEE <input checked="" type="checkbox"/>
5. State Oil & Gas Lease No.
7. Unit Agreement Name D
8. Farm or Lease Name McAllister
9. Well No. 2
10. Field and Pool, or Wildcat UNDESIGNATED
12. County Lea
19. Proposed Depth 7100
19A. Formation Drinkard
20. Rotary or C.T. Rotary
21. Elevations (Show whether DF, RT, etc.) 3569 GD
21A. Kind & Status Plug. Bond Blanket
21B. Drilling Contractor Kenai of Texas
22. Approx. Date Work will start 12-1-81

APPLICATION FOR PERMIT TO DRILL, DEEPEN, OR PLUG BACK

1a. Type of Work b. Type of Well OIL WELL <input checked="" type="checkbox"/> GAS WELL <input type="checkbox"/> OTHER <input type="checkbox"/> DEEPEN <input type="checkbox"/> PLUG BACK <input type="checkbox"/> SINGLE ZONE <input checked="" type="checkbox"/> MULTIPLE ZONE <input type="checkbox"/>	2. Name of Operator Crown Central Petroleum Corporation	3. Address of Operator 1002 Wilco Building Midland, Texas 79701	4. Location of Well UNIT LETTER D LOCATED 660 FEET FROM THE N LINE AND 660 FEET FROM THE W LINE OF SEC. 8 TWP. 20S RGE. 38E NMPM
--	--	--	--

PROPOSED CASING AND CEMENT PROGRAM

SIZE OF HOLE	SIZE OF CASING	WEIGHT PER FOOT	SETTING DEPTH	SACKS OF CEMENT	EST. TOP
17-1/2	13-3/8	54.5	30		SURF
12-1/4	8-5/8	32	1500	600	SURF
7-7/8	5-1/2	14, 15.5, 17	7100	1000	1500

Blowout prevention system: Shaffer 10" series 900 type LWS Double Hydraulic B.O.P

APPROVAL VALID FOR 180 DAYS
PERMIT EXPIRES 5/9/82
UNLESS DRILLING UNDERWAY

IN ABOVE SPACE DESCRIBE PROPOSED PROGRAM: IF PROPOSAL IS TO DEEPEN OR PLUG BACK, GIVE DATA ON PRESENT PRODUCTIVE ZONE AND PROPOSED NEW PRODUCTIVE ZONE. GIVE BLOWOUT PREVENTER PROGRAM, IF ANY.

I hereby certify that the information above is true and complete to the best of my knowledge and belief.

Signed Bruce LiSooney Title Production Engineer Date 10-30-81

(This space for State Use)
Orig. Signed by
Jerry Benton

APPROVED BY TITLE DATE
CONDITIONS OF APPROVAL, IF ANY:

NOV 6 1981

NEW MEXICO OIL CONSERVATION COMMISSION
WELL LOCATION AND ACREAGE DEDICATION PLAT

Form C-102
Supersedes C-128
Effective 1-1-65

All distances must be from the outer boundaries of the Section.

Operator Crown Central Petroleum Corp.			Lease McAllister		Well No. 2
Unit Letter D	Section 8	Township 20 South	Range 38 East	County Lea	
Actual Footage Location of Well: 660 feet from the North line and 660 feet from the West line					
Ground Level Elev. 3569	Producing Formation Drinkard		Pool UNDESIGNATED		Dedicated Acreage: 40 Acres

1. Outline the acreage dedicated to the subject well by colored pencil or hachure marks on the plat below.
2. If more than one lease is dedicated to the well, outline each and identify the ownership thereof (both as to working interest and royalty).
3. If more than one lease of different ownership is dedicated to the well, have the interests of all owners been consolidated by communitization, unitization, force-pooling, etc?

☐ Yes ☐ No If answer is "yes," type of consolidation _____

If answer is "no," list the owners and tract descriptions which have actually been consolidated. (Use reverse side of this form if necessary.) _____

No allowable will be assigned to the well until all interests have been consolidated (by communitization, unitization, forced-pooling, or otherwise) or until a non-standard unit, eliminating such interests, has been approved by the Commission.

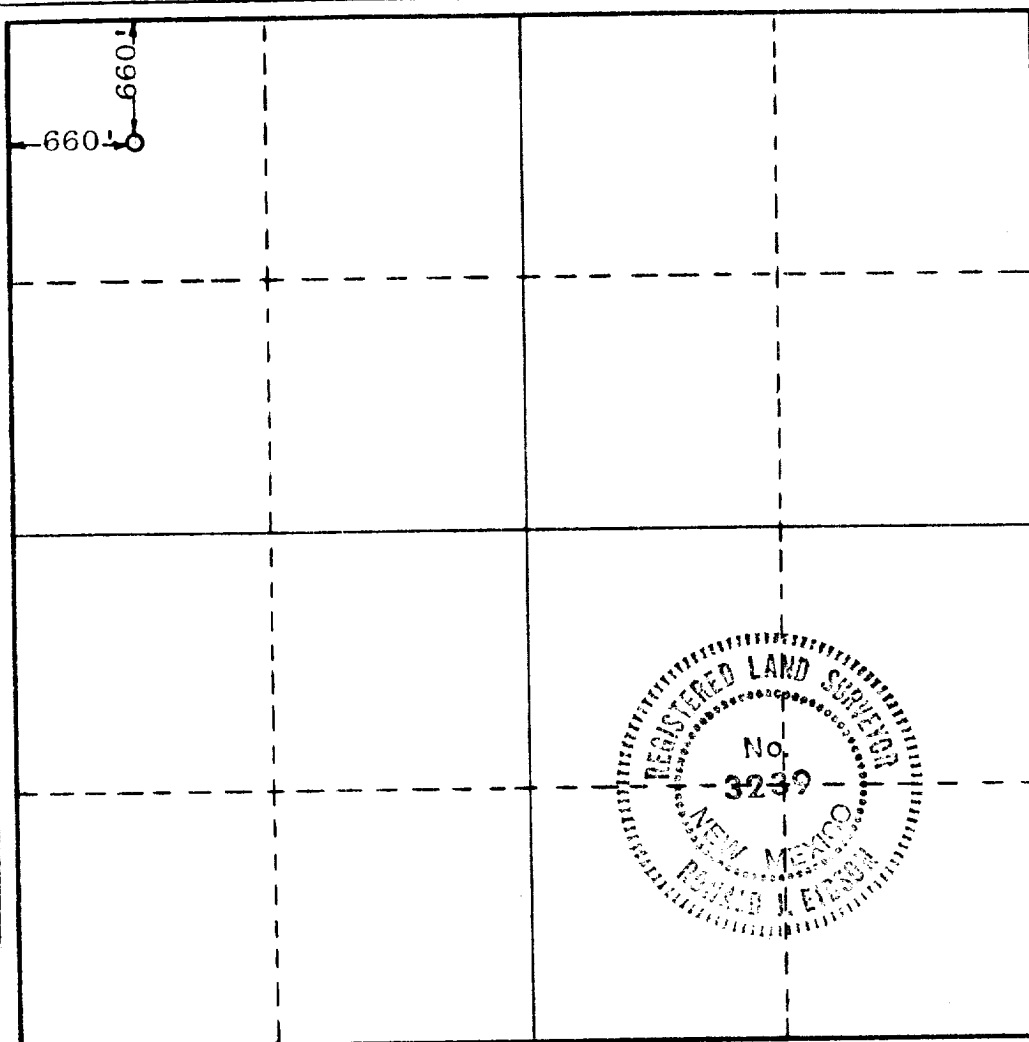

CERTIFICATION

I hereby certify that the information contained herein is true and complete to the best of my knowledge and belief.

Bruce M. LiSooy
Name
Bruce LiSooy

Position
Production Engineer

Company
Crown Central Petroleum Corp

Date
10-30-81

I hereby certify that the well location shown on this plat was plotted from field notes of actual surveys made by me or under my supervision, and that the same is true and correct to the best of my knowledge and belief.

Date Surveyed

November 3, 1981

Registered Professional Engineer and/or Land Surveyor

Ronald J. Eidson

Certificate No. **JOHN W. WEST 676**
PATRICK A. ROMERO 6863
Ronald J. Eidson 3239

0 330 660 990 1320 1650 1980 2310 2640 2970 3300 3630 3960 4290 4620 4950 5280 5610 5940 6270 6600