

NEW MEXICO OIL CONSERVATION COMMISSION
WELL LOCATION AND ACREAGE DEDICATION PLAT

Form C-102
Supersedes C-128
Effective 1-1-65

All distances must be from the outer boundaries of the Section.

Operator TEXACO Inc.		Lease State of New Mexico "H" NCT-2		Well No. 30
Unit Letter B	Section 20	Township 20 South	Range 37 East	County Lea
Actual Fontage Location of Well:				
851' feet from the North line and		1825' feet from the East line Sec. 20		
Ground Level Elev: 3521'	Producing Formation Yates, Seven Rivers, Queen	Pool Eumont-Yates, Seven Rivers, Queen	Dedicated Acreage: 160 Acres	

1. Outline the acreage dedicated to the subject well by colored pencil or hatchure marks on the plat below.
2. If more than one lease is dedicated to the well, outline each and identify the ownership thereof (both as to working interest and royalty).
3. If more than one lease of different ownership is dedicated to the well, have the interests of all owners been consolidated by communization, unitization, force-pooling, etc?

☐ Yes ☐ No If answer is "yes," type of consolidation _____

If answer is "no," list the owners and tract descriptions which have actually been consolidated. (Use reverse side of this form if necessary.) _____

No allowable will be assigned to the well until all interests have been consolidated (by communization, unitization, forced pooling, or otherwise) or until a non-standard unit, eliminating such interests, has been approved by the Commission.

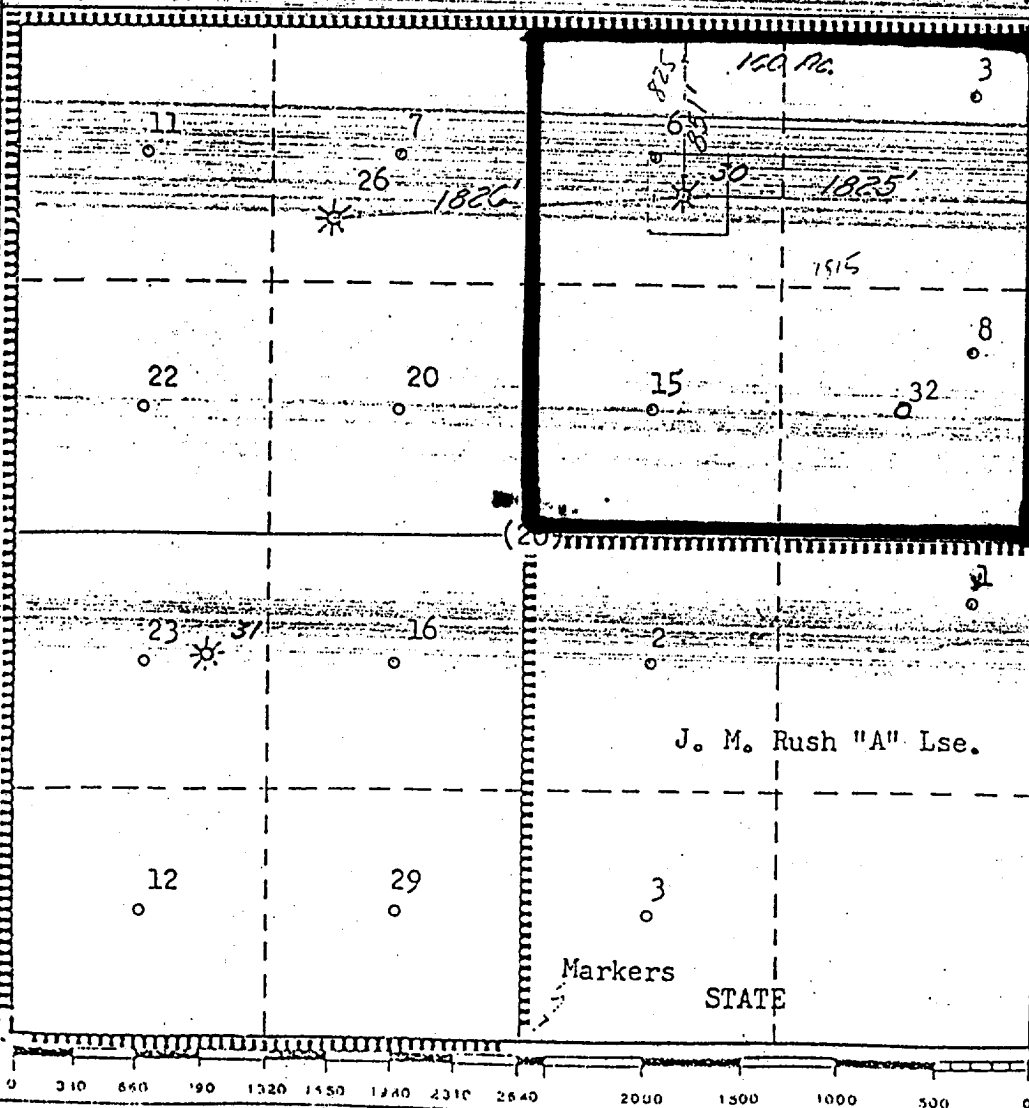

CERTIFICATION

I hereby certify that the information contained herein is true and complete to the best of my knowledge and belief.

B. L. Eiland
Name

B. L. Eiland

Position

Division Surveyor

Company

Texaco Inc.

Date

4-27-81

I hereby certify that the well location shown on this plat was plotted from field notes of actual surveys made by me or under my supervision, and that the same is true and correct to the best of my knowledge and belief.

4-23-81

Date Surveyed

Registered Professional Engineer and/or Land Surveyor

B. L. Eiland
B. L. Eiland

Certificate No.

4386

NEW MEXICO OIL CONSERVATION COMMISSION
WELL LOCATION AND ACREAGE DEDICATION PLAT

Form C-1
Supersedes 128
Effective 1-1-65

All distances must be from the outer boundaries of the Section.

Operator TEXACO Inc.		Lease State of New Mexico "H" NCT-2		Well No. 30
Unit Letter B	Section 20	Township 20 South	Range 37 East	County Lea
Actual Footage Location of Well: 851' feet from the North line and 1825' feet from the East line Sec. 20				
Ground Level Elev. 3521'	Producing Formation Yates, Seven Rivers, Queen	Pool Eumont-Yates, Seven Rivers, Queen	Dedicated Acreage: 160 Acres	

1. Outline the acreage dedicated to the subject well by colored pencil or hachure marks on the plat below.
2. If more than one lease is dedicated to the well, outline each and identify the ownership thereof (both as to working interest and royalty).
3. If more than one lease of different ownership is dedicated to the well, have the interests of all owners been consolidated by communitization, unitization, force-pooling, etc?

☐ Yes ☐ No If answer is "yes," type of consolidation _____

If answer is "no," list the owners and tract descriptions which have actually been consolidated. (Use reverse side of this form if necessary.) _____

No allowable will be assigned to the well until all interests have been consolidated (by communitization, unitization, forced-pooling, or otherwise) or until a non-standard unit, eliminating such interests, has been approved by the Commission.

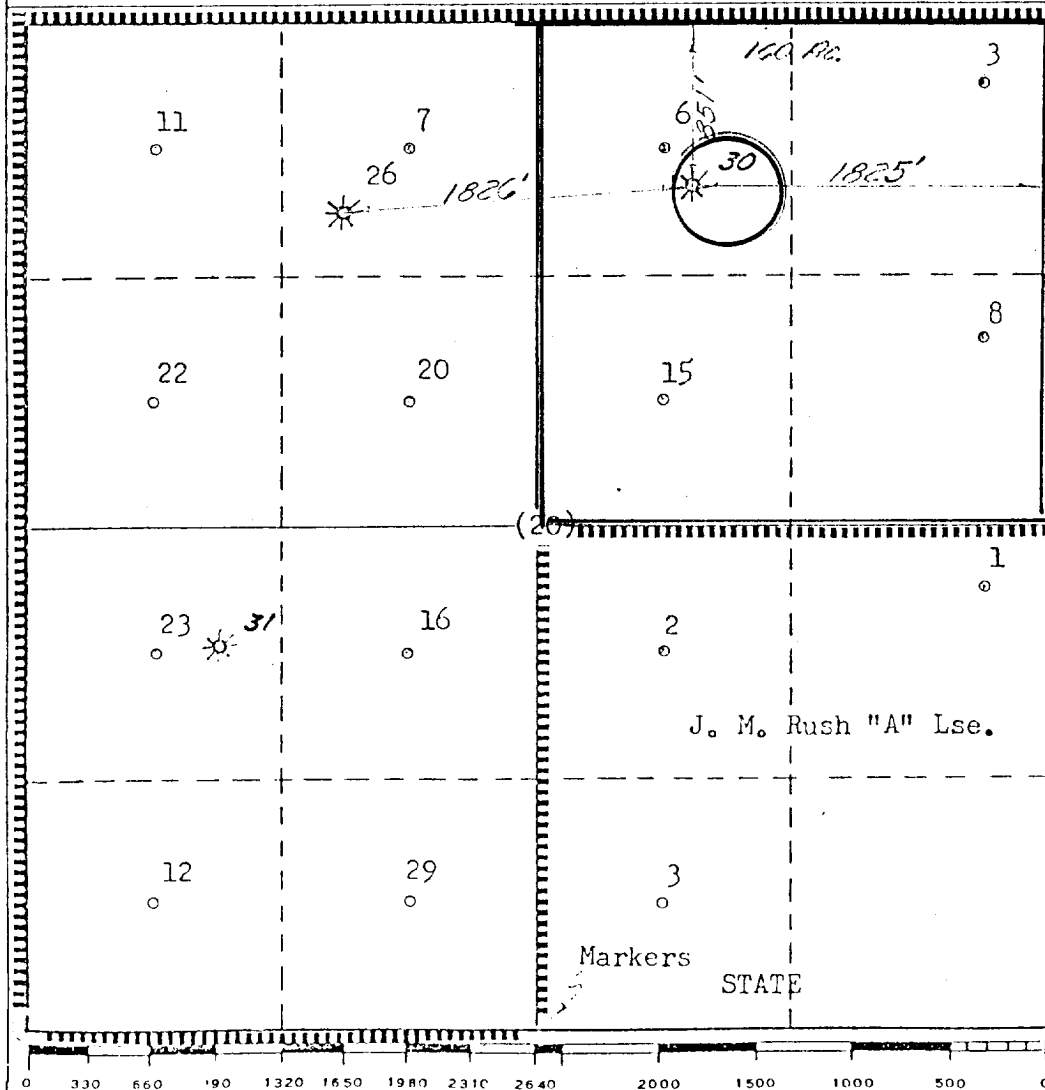

CERTIFICATION

I hereby certify that the information contained herein is true and complete to the best of my knowledge and belief.

Name
B. L. Eiland
Position
Division Surveyor
Company
Texaco Inc.

Date
4-27-81

I hereby certify that the well location shown on this plat was plotted from field notes of actual surveys made by me or under my supervision, and that the same is true and correct to the best of my knowledge and belief.

4-23-81

Date Surveyed

Registered Professional Engineer and/or Land Surveyor

B. L. Eiland

Certificate No.

4386

COUNTY **LEA** FIELD **Eumont** STATE **NM**
 OPR: **TEXACO-INC.** API: **30-025-27719**
 NO **30** LEASE **New Mexico "H" State (NCT-2)** MAP
Sec 20, T20S, R37E CO-ORD
851 FNL, 1825 FEL of Sec **3-4-64 NM**
4 mi S/Monument SPD **2-10-82** CMP **3-4-82**

CSC	WELL CLASS: INIT D FIN DO LSE. CODE			
	FORMATION	DATUM	FORMATION	DATUM
	TD 3600 (QUEN)		PBD 3568	

IP (Queen) Perfs 3361-3499 F 2832 MCFGPD. Pot based on 5 hr test thru 1 chk. GOR Dry; gty (Gas) (NR); CP Pkr; TP 85

CONTR **Hondo #6** OPRSELEV **3521 GL** sub-s **9**

F.R. 2-1-82
 PD 3600 RT (Queen)
 3-17-82 AMEND ZONE: Formerly reported as Yates
 2-12-82 TD 1100; Prep run 8 5/8 csg
 2-22-82 TD 3600; MORT
 3-1-82 TD 3600; PBD 3568; Prep Acid
 Perf (Queen) @ 3361, 3373, 3377, 3383, 3389, 3400, 3405, 3410, 3421, 3430, 3434, 3440, 3448, 3457, 3465, 3469, 3475, 3486, 3499
 Swbd 12 BLW + max 160
 MCFGPD in 5 hrs (3361-3499)
 3-8-82 TD 3600; PBD 3568; WO PLC
 Acid (3361-3499) 2000 gals
 Flwd 590 MCFGPD in 5 hrs thru 1 chk (3361-3499)
 3-22-82 TD 3600; PBD 3568; Complete

3-4-64 NM

LEA
TEXACO INC.

Dumont
30 New Mexico "H"
State (NCT-2)
Sec 20, T20S, R37E

NM
Page 2

3-22-82 Continued
LOG TOPS: Rustler 1073, Salt 1157, Base Salt
2375, Yates 2532, Seven Rivers 2777, Queen
3272
3-27-82 COMPLETION ISSUED

3-4-64 NM
IC 30-025-70065-82
