

30-025-27816

NO. OF COPIES RECEIVED	
DISTRIBUTION	
SANTA FE	
FILE	
U.S.G.S.	
LAND OFFICE	
OPERATOR	

NEW MEXICO OIL CONSERVATION COMMISSION

Form C-101
Revised 1-1-65

5A. Indicate Type of Lease	
STATE <input checked="" type="checkbox"/>	FEE <input type="checkbox"/>
5. State Oil & Gas Lease No.	
B-2656	

APPLICATION FOR PERMIT TO DRILL, DEEPEN, OR PLUG BACK

1a. Type of Work		7. Unit Agreement Name	
b. Type of Well DRILL <input checked="" type="checkbox"/> DEEPEN <input type="checkbox"/> PLUG BACK <input type="checkbox"/> OIL WELL <input type="checkbox"/> GAS WELL <input checked="" type="checkbox"/> OTHER <input type="checkbox"/> SINGLE ZONE <input checked="" type="checkbox"/> MULTIPLE ZONE <input type="checkbox"/>		8. Farm or Lease Name State A-20	
2. Name of Operator Doyle Hartman		9. Well No. 4	
3. Address of Operator P. O. Box 10426 Midland, Texas 79702		10. Field and Pool, or Wildcat Eumont (Gas)	
4. Location of Well UNIT LETTER J LOCATED 1450 FEET FROM THE South LINE AND 1980 FEET FROM THE East LINE OF SEC. 20 TWP. 20S RGE. 37E NMPM		12. County Lea	
19. Proposed Depth 4000		19A. Formation Queen (Penrose)	20. Rotary or C.T. Rotary
21. Elevations (Show whether DP, RT, etc.) 3520 (Approx.) *	21A. Kind & Status Plug Bond Multi-Approved	21B. Drilling Contractor Kenai	22. Approx. Date Work will start May 1982

23. PROPOSED CASING AND CEMENT PROGRAM

SIZE OF HOLE	SIZE OF CASING	WEIGHT PER FOOT	SETTING DEPTH	SACKS OF CEMENT	EST. TOP
12 1/4	9 5/8	36.0	400	300	Surface
8 3/4	7	23.0	4000	800	Surface

The proposed well will be drilled to a total depth of 4000 feet and will be completed as a Eumont (Queen-Penrose) gas producer. From the base of the surface pipe through the running of the production casing, the well will be equipped with a 3000-psi double ram BOP system.

NOTE: Any gas produced from the proposed well has previously been dedicated to El Paso Natural Gas Company.

* Survey of location has not been completed.

APPROVAL VALID FOR 180 DAYS
PERMIT EXPIRES 12/7/82
UNLESS DRILLING UNDERWAY

IN ABOVE SPACE DESCRIBE PROPOSED PROGRAM: IF PROPOSAL IS TO DEEPEN OR PLUG BACK, GIVE DATA ON PRESENT PRODUCTIVE ZONE AND PROPOSED NEW PRODU-
TIVE ZONE. GIVE BLOWOUT PREVENTER PROGRAM, IF ANY.

I hereby certify that the information above is true and complete to the best of my knowledge and belief.

Signed Henry C. Sexton Title Engineer Date April 13, 1982

(This space for State Use)

ORIGINAL SIGNED BY

APPROVED BY Henry C. Sexton TITLE Engineer DATE JUN 4 1982

CONDITIONS OF APPROVAL, IF ANY: No allowable will be assigned for this well until approval is obtained for the unorthodox location.

NEW MEXICO OIL CONSERVATION COMMISSION
WELL LOCATION AND ACREAGE DEDICATION PLAT

Form O-102
Supersedes O-128
Effective 1-1-65

All distances must be from the outer boundaries of the Section

Operator Doyle Hartman		Lease State A-20		Well No. 4
Unit Letter J	Section 20	Township 20 South	Range 37east	County Lea
Actual Portage Location of Well: 1450 feet from the South line and 1980 feet from the East line				
Ground Level Elev. 3515.0	Producing Formation Queen-Penrose		Pool Eumont (Gas)	Dedicated Acreage 160

1. Outline the acreage dedicated to the subject well by colored pencil or hachure marks on the plat below.
2. If more than one lease is dedicated to the well, outline each and identify the ownership thereof (both as to working interest and royalty).
3. If more than one lease of different ownership is dedicated to the well, have the interests of all owners been consolidated by communitization, unitization, force-pooling, etc?

☐ Yes ☐ No If answer is "yes," type of consolidation _____

If answer is "no," list the owners and tract descriptions which have actually been consolidated. (Use reverse side of this form if necessary.) _____

No allowable will be assigned to the well until all interests have been consolidated (by communitization, unitization, forced-pooling, or otherwise) or until a non-standard unit, eliminating such interests, has been approved by the Commission.

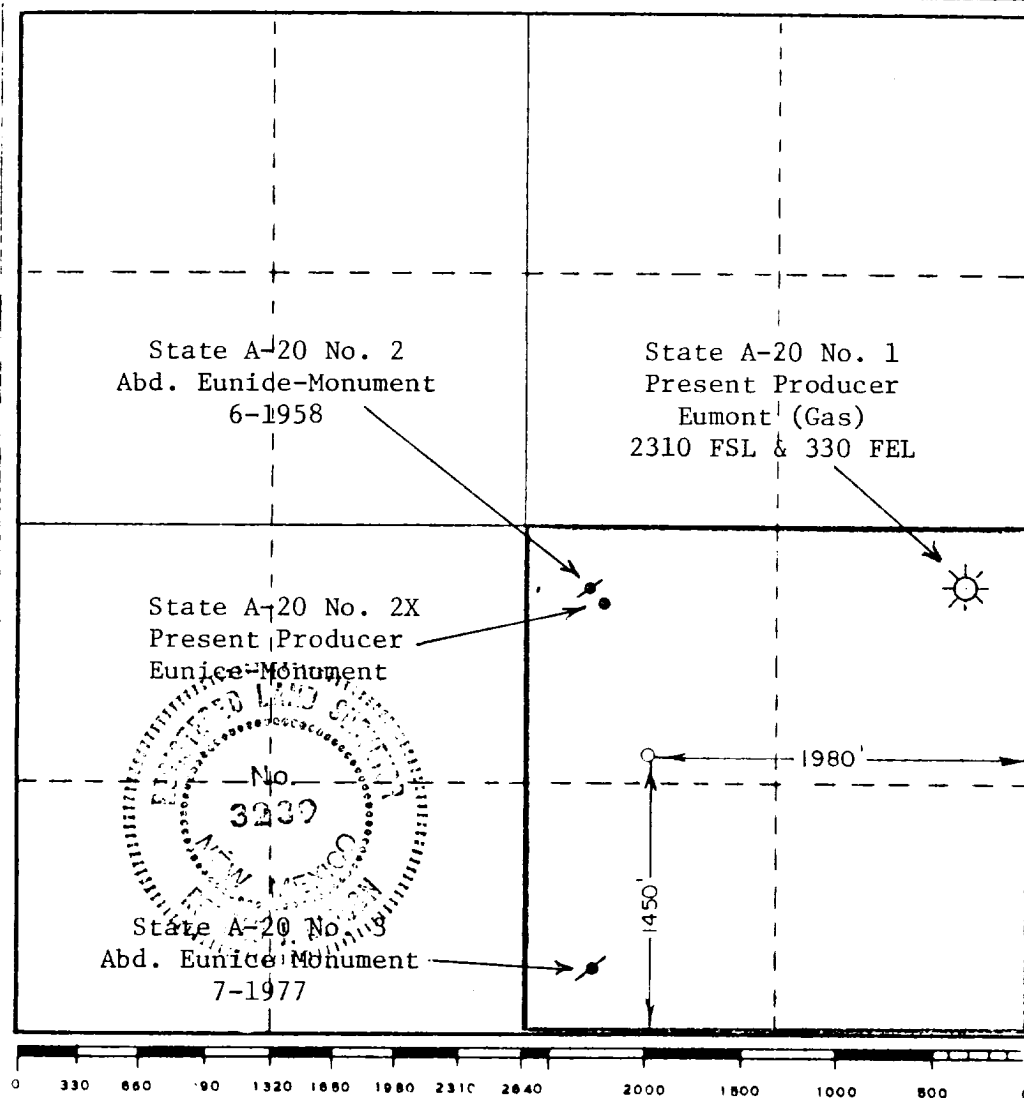

CERTIFICATION

I hereby certify that the information contained herein is true and complete to the best of my knowledge and belief

Larry A. Nermyr

Name

Larry A. Nermyr

Position

Engineer

Company

Doyle Hartman

Date

April 30, 1982

I hereby certify that the well location shown on this plat was plotted from field notes of actual surveys made by me or under my supervision, and that the same is true and correct to the best of my knowledge and belief.

Date Surveyed

5 - 1 - 82

Registered Professional Engineer and/or Land Surveyor

Ronald J. Eiden

Certificate No. **JOHN V. WEST 676**
PATRICK A. ROMERO 6665
Ronald J. Eiden 3239

RECEIVED

MAY 10 1982

U.S. DEPT. OF JUSTICE
HOBBBS OFFICE

FILE