

COPIES RECEIVED	
DISTRIBUTION	
SANTA FE	
FILE	
U.S.G.S.	
LAND OFFICE	
OPERATOR	

5A. Indicate Type of Lease
STATE ☒ FEE ☐
5. State Oil & Gas Lease No.
B-1040

APPLICATION FOR PERMIT TO DRILL, DEEPEN, OR PLUG BACK

1a. Type of Work
DRILL ☒ DEEPEN ☐ PLUG BACK ☐
b. Type of Well
OIL WELL ☐ GAS WELL ☒ OTHER ☐ SINGLE ZONE ☒ MULTIPLE ZONE ☐
2. Name of Operator
L & E Oil Company, Inc.
3. Address of Operator
2600 S. Gessner, Suite 220, Houston, Texas 77063
4. Location of Well
UNIT LETTER Q LOCATED 660 FEET FROM THE North LINE
1,980 FEET FROM THE West LINE OF SEC. II TWP. 22S RGE. 34E NMPM
10. Field and Pool, or Wildcat
E. Gramma Ridge (Morrow)
12. County
Lea
19. Proposed Depth
13,500
19A. Formation
Morrow
20. Rotary or C.T.
Rotary
1. Elevations (Show whether D.F., R.T., etc.)
3,554' GR
21A. Kind & Status Plug. Bond
I-well; attached
21B. Drilling Contractor
Sharp Drilling Co.
22. Approx. Date Work will start
8/82

PROPOSED CASING AND CEMENT PROGRAM

SIZE OF HOLE	SIZE OF CASING	WEIGHT PER FOOT	SETTING DEPTH	SACKS OF CEMENT	EST. TOP
17-1/2	13-3/8	48.00	1,100	935	surface
12-1/4	10-3/4	51.00	5,600	1,225	1,000
9-1/2	7-5/8	29.70	11,300	1,540	5,000
6-3/4	5-1/2	20	13,500	1,500	11,300

Plan to drill to total depth, set casing, perforate and test well.

POP's

13-5/8" 3,000 psi WP Hydril GK
11" 10,000 psi WP Cameron U Double
10" 5,000 psi WP Hydril GK

APPROVAL VALID FOR 180 DAYS
PERMIT EXPIRES 2/23/83
UNLESS DRILLING UNDERWAY

ABOVE SPACE DESCRIBE PROPOSED PROGRAM: IF PROPOSAL IS TO DEEPEN OR PLUG BACK, GIVE DATA ON PRESENT PRODUCTIVE ZONE AND PROPOSED NEW PRODUCTIVE ZONE. GIVE BLOWOUT PREVENTER PROGRAM, IF ANY.

I hereby certify that the information above is true and complete to the best of my knowledge and belief.

Signed Garry Evans Title Engineering Assistant Date 7/30/82

(This space for State Use)

ORIGINAL SIGNED BY

PROVED BY JERRY SEXTON TITLE DATE AUG 24 1982

**NEW MEXICO OIL CONSERVATION COMMISSION
WELL LOCATION AND ACREAGE DEDICATION PLAT**

Form C-102
Supersedes C-128
Effective 1-1-65

All distances must be from the outer boundaries of the Section.

Operator L & B OIL COMPANY, Inc.			Lease State		Well No. 1-11
Unit Letter C	Section 11	Township 22-S	Range 34-E	County LEA	
Actual Footage Location of Well: 1980 feet from the WEST line and 660 feet from the NORTH line					
Ground Level Elev. 3554'	Producing Formation Morrow		Pool Morrow		Dedicated Acreage: 320 Acres

1. Outline the acreage dedicated to the subject well by colored pencil or hachure marks on the plat below.
2. If more than one lease is dedicated to the well, outline each and identify the ownership thereof (both as to working interest and royalty).
3. If more than one lease of different ownership is dedicated to the well, have the interests of all owners been consolidated by communitization, unitization, force-pooling, etc?

☒ Yes ☐ No If answer is "yes," type of consolidation COMMUNITIZATION

If answer is "no," list the owners and tract descriptions which have actually been consolidated. (Use reverse side of this form if necessary.) _____

No allowable will be assigned to the well until all interests have been consolidated (by communitization, unitization, forced-pooling, or otherwise) or until a non-standard unit, eliminating such interests, has been approved by the Commission.

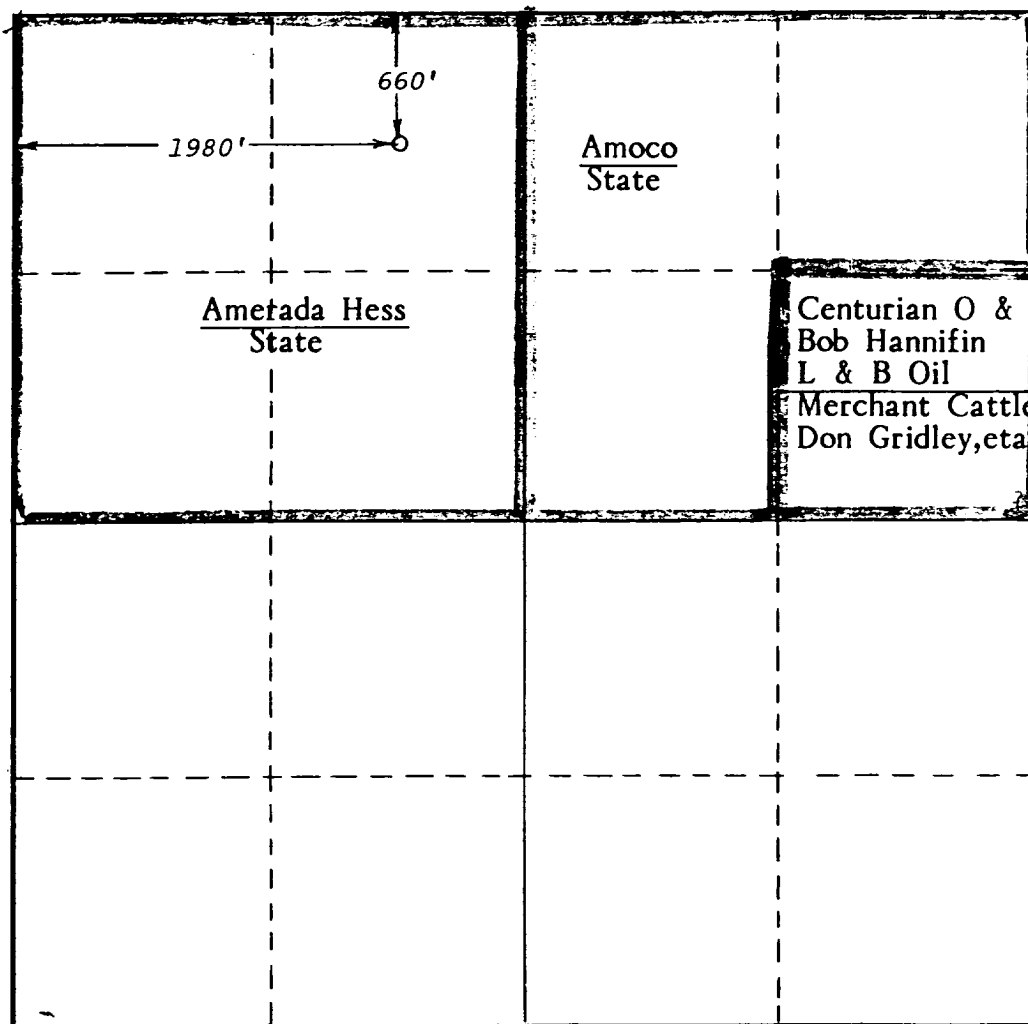

CERTIFICATION

I hereby certify that the information contained herein is true and complete to the best of my knowledge and belief.

Caryl Evans

Name
Caryl Evans

Position
Engineering Assistant

Company
L & B Oil Company, Inc.

Date
7/30/82

I hereby certify that the well location shown on this plat was plotted from field notes of actual surveys made by me or under my supervision, and that the same is true and correct to the best of my knowledge and belief.

July 15, 1982

Date Surveyed
Gary D. Boswell

Registered Professional Engineer
and/or Land Surveyor

Gary D. Boswell
Certificate No.

6689

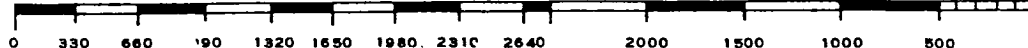

RECEIVED

AUG 10 1982

O.C.D.
HOSPITAL OFFICE

473

OIL CONSERVATION DIVISION

P. O. BOX 2088

SANTA FE, NEW MEXICO 87501

Form C-101
Revised 10-1-78

NO. OF COPIES RECEIVED	
DISTRIBUTION	
SANTA FE	
FILE	
U.S.G.S.	
LAND OFFICE	
OPERATOR	

5a. Indicate Type of Lease State <input checked="" type="checkbox"/> Free <input type="checkbox"/>
5. State Oil & Gas Lease No. B-1040

SUNDRY NOTICES AND REPORTS ON WELLS
(DO NOT USE THIS FORM FOR PROPOSALS TO DRILL OR TO DEEPEN OR PLUG BACK TO A DIFFERENT RESERVOIR.
USE "APPLICATION FOR PERMIT -" (FORM C-101) FOR SUCH PROPOSALS.)

1. <input type="checkbox"/> OIL WELL <input checked="" type="checkbox"/> GAS WELL <input type="checkbox"/> OTHER-	7. Unit Agreement Name
2. Name of Operator L & B Oil Company, Inc.	8. Farm or Lease Name State
3. Address of Operator 2600 S. Gessner, Suite 220, Houston, Texas 77063	9. Well No. I
4. Location of Well UNIT LETTER <u>C</u> <u>660</u> FEET FROM THE <u>N</u> LINE AND <u>1,980</u> FEET FROM THE <u>W</u> LINE, SECTION <u>11</u> TOWNSHIP <u>22S</u> RANGE <u>34E</u> NMPM.	10. Field and Pool, or Wildcat E. Gramma Ridge (Morrow)
15. Elevation (Show whether DF, RT, GR, etc.) 3,554' GR	12. County Lea

16. Check Appropriate Box To Indicate Nature of Notice, Report or Other Data	
NOTICE OF INTENTION TO:	SUBSEQUENT REPORT OF:
PERFORM REMEDIAL WORK <input type="checkbox"/>	REMEDIAL WORK <input type="checkbox"/>
TEMPORARILY ABANDON <input type="checkbox"/>	COMMENCE DRILLING OPS. <input type="checkbox"/>
PULL OR ALTER CASING <input type="checkbox"/>	CASING TEST AND CEMENT JOB <input checked="" type="checkbox"/>
CHANGE PLANS <input type="checkbox"/>	OTHER <input type="checkbox"/>
OTHER <input type="checkbox"/>	ALTERING CASING <input type="checkbox"/>
	PLUG AND ABANDONMENT <input type="checkbox"/>

17. Describe Proposed or Completed Operations (Clearly state all pertinent details, and give pertinent dates, including estimated date of starting any proposed work) SEE RULE 1103.

9/19/82 TD 11,200'. Ran 54 jts., 7-5/8", 29.70#, T-95, LT&C, 8RD; 125 jts., 7-5/8", 29.70#, N-80, LT&C, 8RD; and 95 jts., 7-5/8", 26.40#, N-80, LT&C, 8RD casing. Set at 11,200'. DV tool at 7,482'. Cemented 1st stage w/370 sx. Halliburton Lite + 5 lb/sx KCl + 0.6% Hallad-22A and 340 sx. Class "H" + 0.6% Halad-22A + 0.4% CFR-2 + 5 lb/sx KCl. Cemented 2nd stage w/400 sx. Halliburton Lite + 5 lb/sx KCl + 0.6% Halad-22A and 300 sx. Class "H" w/50/50 Pozmix A + 0.6% Halad-22A + 5 lb/sx KCl.

	Depth	Temp., °F	Calculated Top of Cement	Slurry Mixing Temp., °F	Cement Strength psi	Cement in Place Prior to Test Hrs.
DV Tool	7,482	135	4,700	95	2,900	62
Float Shoe	11,200	167	8,000	95	3,100	67

Casing tested w/2,000 psi w/9.7 ppg mud in hole (12.3 ppg EMW) for 30 minutes; no failure.

Reduced hole to 6-3/4" and resumed drilling.

18. I hereby certify that the information above is true and complete to the best of my knowledge and belief.

SIGNED <u>Carol Evans</u>	TITLE <u>Engineering Assistant</u>	DATE <u>10/25/82</u>
ORIGINAL SIGNED BY <u>JERRY SEXTON</u>		
APPROVED BY <u>DISTRICT 1 SUPV.</u>	TITLE _____	DATE _____

OCT 28 1982

RECEIVED

OCT 26 1982

RECEIVED