

**OIL CONSERVATION DIVISION**

**DISTRICT I**  
P.O. Box 1980, Hobbs, NM 88240

**DISTRICT II**  
P.O. Box Drawer DD, Artesia, NM 88210

**DISTRICT III**  
1000 Rio Brazos Rd., Aztec, NM 87410

P.O. Box 2088  
Sante Fe, New Mexico 87504-2088

WELL API NO.	30 025 27917
5. Indicate Type of Lease	STATE <input type="checkbox"/> FEE <input checked="" type="checkbox"/>
6. State Oil / Gas Lease	

**APPLICATION FOR PERMIT TO DRILL, DEEPEN, OR PLUG BACK**

1a. Type of Work: DRILL <input type="checkbox"/> RE-ENTER <input type="checkbox"/> DEEPEN <input type="checkbox"/> PLUG BACK <input checked="" type="checkbox"/>	7. Lease Name or Unit Agreement Name M B WEIR B
b. Type of Well: OIL WELL <input type="checkbox"/> GAS WELL <input checked="" type="checkbox"/> OTHER <input type="checkbox"/>	8. Well No. 11
2. Name of Operator TEXACO EXPLORATION & PRODUCTION INC.	9. Pool Name or Wildcat SKAGGS ABO MONUMENT TUBB
3. Address of Operator P.O. BOX 730, HOBBS, NM 88240	
4. Well Location Unit Letter <u>N</u> : <u>660</u> Feet From The <u>SOUTH</u> Line and <u>2079</u> Feet From The <u>WEST</u> Line Section <u>12</u> Township <u>20S</u> Range <u>37E</u> NMPM <u>LEA</u> COUNTY	

10. Proposed Depth 7630	11. Formation ABO/TUBB	12. Rotary or C.T. -
13. Elevations (Show whether DF, RT, GR, etc.) 3572' GL	14. Kind and Status Plug Bond -	15. Drilling Contractor -
16. Approx. Date Work will start 1/12/94		

17. PROPOSED CASING AND CEMENT PROGRAM					
SIZE OF HOLE	SIZE OF CASING	WEIGHT PER FOOT	SETTING DEPTH	SACKS OF CEMENT	EST. TOP
17 1/2"	13 3/8"	61#	1430'	1550 SXS	CIRC
12 1/4"	9 5/8"	36# & 40#	4000'	1900 SXS	CIRC
8 3/4"	7"	23# & 26#	7650'	1150 SXS	CIRC

THIS WELL CURRENTLY PRODUCES FROM THE SKAGGS ABO FORMATION. WORKOVER PROPOSES TO ADD TUBB PRODUCTION TO MAKE IT A DUAL COMPLETED WELL IN THE SKAGGS ABO AND MONUMENT TUBB.

1. MIRU. TOH W/ PROD EQUIP. TIH W/ PKR & SET @ 6970'. A/ ABO PERFS W/ 2000 GALS 15% NEFE. MAX P = 2000#, AIR = 3 BPM.
2. FLUSH TO BOTTOM PERF W/ 100 GALS 2 % KCL WTR. SET BLANKING PLUG IN PKR. TOH W/ WS.
3. TIH W/ RBP, SET @ 6800' & DUMP 2 SX SND ON TOP. PERF TUBB 6309'-6523' @ 2 SPF (141 FT - 282 HLES)
4. TIH W/ TREATING PKR & SET @ 6280'. A/ TUBB PERFS W/ 3500 GALS 15% NEFE, MAX P = 2600#, AIR = 10 BPM.
5. FRAC TUBB PERFS FR 6309'-6523' W/ 67,000 GALS 30# XL GEL, 228,000# 20/40 OTTAWA SAND, & 60,000# 12/20 SAND. MAX P = 4900#, AIR = 30 BPM.
6. FLOW WELL BACK. TOH W/ TREATING PKR & C/O TO RBP. EVALUATE TUBB PRODUCTION.
7. TOH W/ RBP. TIH W/ DUAL PKR ON ABO STRING, STAB INTO PKR @ 6970', SET DUAL PKR @ 6250' STAB INTO DUAL PKR @ 6250' W/ TUBB STRING.
8. SWAB BOTH STRINGS UNTIL FLOWING & RETURN WELL TO PRODUCTION.

IN ABOVE SPACE DESCRIBE PROPOSED PROGRAM: IF PROPOSAL IS TO DEEPEN OR PLUG BACK, GIVE DATA ON PRESENT PRODUCTIVE ZONE AND PROPOSED NEW PRODUCTIVE ZONE. GIVE BLOWOUT PREVENTER PROGRAM, IF ANY.

I hereby certify that the information above is true and complete to the best of my knowledge and belief.

SIGNATURE Monte C. Duncan TITLE Engr Asst DATE 1/7/94  
TYPE OR PRINT NAME Monte C. Duncan Telephone No. 397-0418

(This space for State Use)

**ORIGINAL SIGNED BY JERRY SEXTON**

APPROVED BY DISTRICT I SUPERVISOR

CONDITIONS OF APPROVAL, IF ANY:

DATE JAN 11 1994

# OIL CONSERVATION DIVISION

RICT I  
O. Box 1980, Hobbs, NM 88240

RICT II

O. Box Drawer DD, Artesia, NM 88210

RICT III

00 Rio Brazos Rd., Aztec, NM 87410

P.O. Box 2088

Sante Fe, New Mexico 87504-2088

## WELL LOCATION AND ACERAGE DEDICATION PLAT

All Distances must be from the outer boundaries of the section.

Operator <b>EXACO EXPLORATION &amp; PRODUCTION INC.</b>			Lease <b>M B WEIR B</b>		Well No. <b>11</b>
Init Letter <b>N</b>	Section <b>12</b>	Township <b>20S</b>	Range <b>37E</b>	NMPM	County <b>LEA</b>
Actual Footage Location of Well: 660 Feet From The SOUTH Line and 2079 Feet From The WEST Line					
Ground Level Elev. <b>3572'</b>	Producing Formation <b>ABO/TUBB</b>		Pool <b>168 80</b> <b>SKAGGS ABO/MONUMENT TUBB</b>		Dedicated Acreage: <b>160/80</b> Acres

1. Outline the acreage dedicated to the subject well by colored pencil or hatchure marks on the plat below.
2. If more than one lease is dedicated to the well, outline each and identify the ownership thereof (both as to working interest and royalty).
3. If more than one lease of different ownership is dedicated to the well, have the interest of all owners been consolidated by communitization, unitization, force-pooling, etc.?

☐ Yes

☐ No

If answer is "yes" type of consolidation

If answer is "no" list the owners and tract descriptions which have actually been consolidated. Use the reverse side of this form if necessary.

No allowable will be assigned to the well until all interests have been consolidated (by communitization, unitization, forced-pooling, or otherwise) or until a non-standard unit, eliminating such interest, has been approved by the Division.

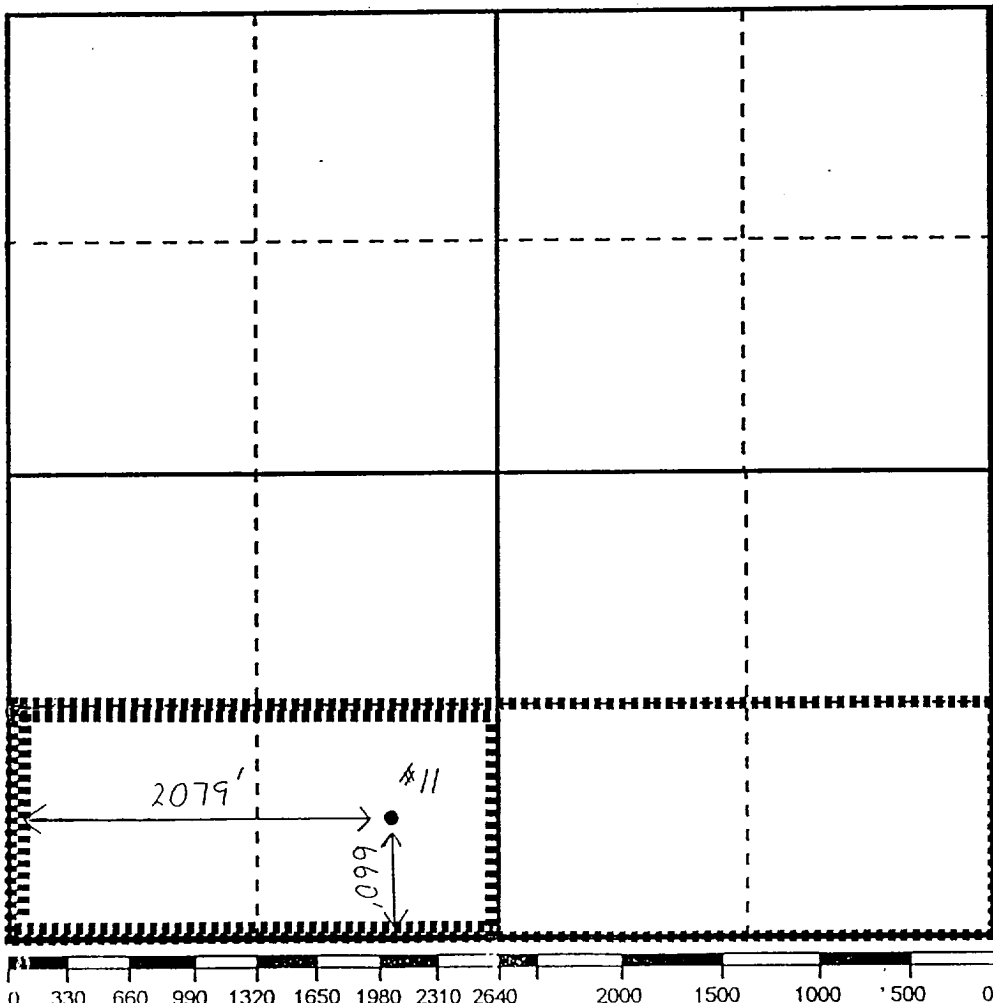

### OPERATOR CERTIFICATION

I hereby certify that the information contained herein is true and complete to the best of my knowledge and belief

Signature

*Monte C. Duncan*

Printed Name

Monte C. Duncan

Position

Engr Asst

Company

TEXACO E & P INC.

Date

1/7/94

### SURVEYOR CERTIFICATION

I hereby certify that the well location shown on this plat was plotted from field notes of actual surveys made by me or under my supervision, and that the same is true and correct to the best of my knowledge and belief.

Date Surveyed

Signature & Seal of

Professional Surveyor

Certificate No.