

0+3 NM CD-Hobbs

1-Field

1-Eng. DW

1-Foreman

1-H.O. Woods

NEW MEXICO OIL CONSERVATION COMMISSION WELL LOCATION AND ACREAGE DEDICATION PLAT

 FL 102
 Sup. Rules C-128
 Effective 1-1-65

All distances must be from the outer boundaries of the Section.

Operator GETTY OIL COMPANY			Lease Federal 15 Com "B"		Well No. 1
Unit Letter C	Section 15	Township 22 South	Range 33 East	County Lea	
Actual Footage Location of Well:					
660 feet from the North line and		1980 feet from the West line			
Ground Level Elev. 3548.2'	Producing Formation Morrow	Pool Undesignated		Dedicated Acreage: 320 Acres	

1. Outline the acreage dedicated to the subject well by colored pencil or hachure marks on the plat below.
2. If more than one lease is dedicated to the well, outline each and identify the ownership thereof (both as to working interest and royalty).
3. If more than one lease of different ownership is dedicated to the well, have the interests of all owners been consolidated by communitization, unitization, force-pooling, etc?

☒ Yes ☐ No If answer is "yes," type of consolidation Communitization

If answer is "no," list the owners and tract descriptions which have actually been consolidated. (Use reverse side of this form if necessary.)

No allowable will be assigned to the well until all interests have been consolidated (by communitization, unitization, forced-pooling, or otherwise) or until a non-standard unit, eliminating such interests, has been approved by the Commission.

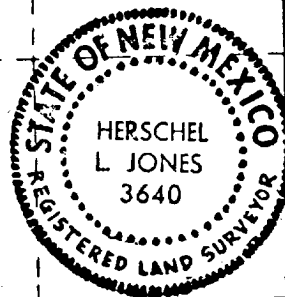
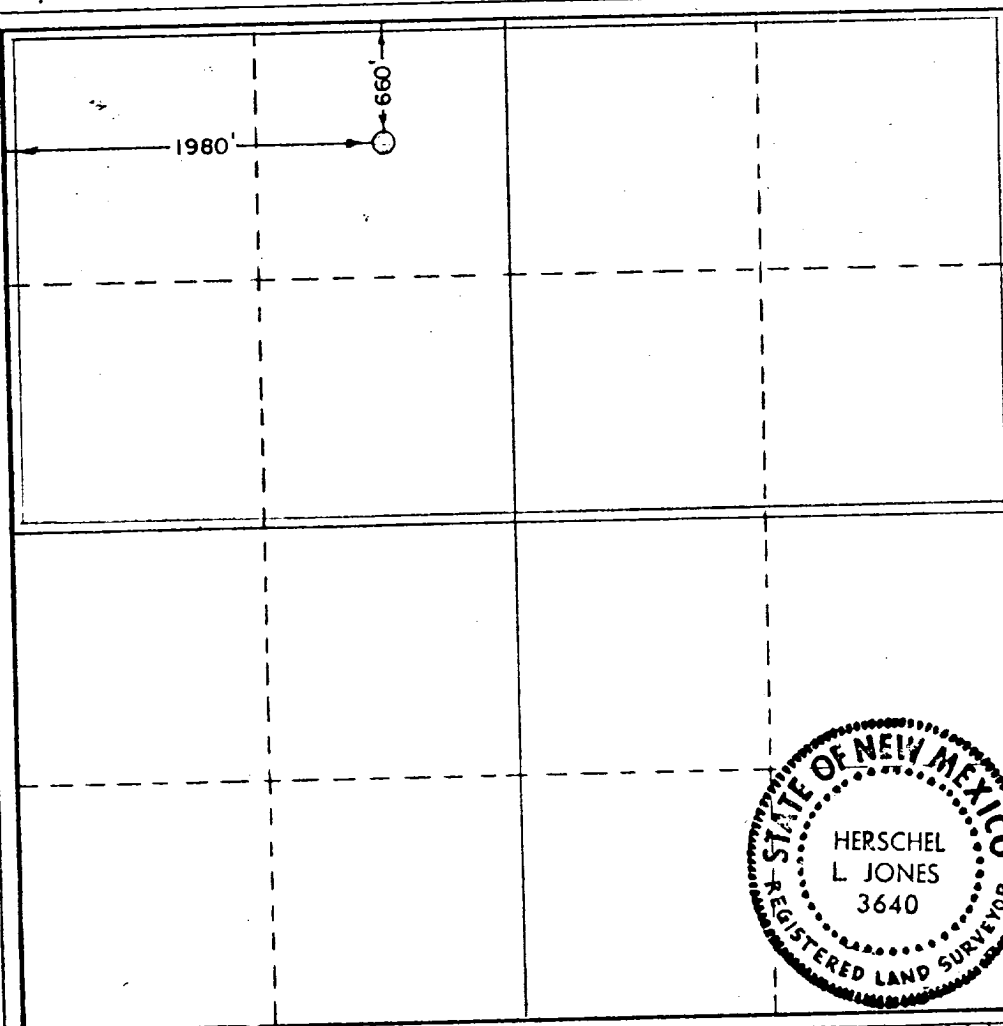

CERTIFICATION

I hereby certify that the information contained herein is true and complete to the best of my knowledge and belief.

Name

Dale R. Crockett

Position

Area Superintendent

Company

Getty Oil Company

Date

November 30, 1982

I hereby certify that the well location shown on this plat was plotted from field notes of actual surveys made by me or under my supervision, and that the same is true and correct to the best of my knowledge and belief.

Date Surveyed

November 4, 1982

 Registered Professional Engineer
 and/or Land Surveyor

Certificate No.

3640

COUNTY LEA FIELD Undesignated STATE NM
 OPR GETTY OIL CO. API 30-025-28096
 NO 1 LEASE Federal "15" Com. "B" MAP
Sec 15, T22S, R33E CO-ORD
660 FNL, 1980 FWL of Sec 4-5-37 NM
15 mi SE/Halfway SPD 12-30-82 CMP 4-4-83

CSG	WELL CLASS: INIT D FINDG LSE. CODE			
	FORMATION	DATUM	FORMATION	DATUM
	13 3/8-1100-1075 sx			
	9 5/8-5460-4000 sx			
	7-11,500-1860 sx			
	4 1/2-1nr-11,168-15,092-700 sx			
2 7/8-14,347				
	TD 15,092 (MRRW)		PBD 14,855	

IP (Morrow) Perfs 14,768-786 F 1779 MCF/GPD. Pot based on
 24 hr test thru 9/64 chk. GOR Dry; gtv (Gas) (NR); CP Pkr;
 TP 3600

CONTR Sharp #36 OPRSTEV 3548 GL sub-s 22

F.R. 12-13-82
 PD 15,150 RT (Morrow)
 1-10-83 Drlg 1275
 1-24-83 Drlg 7360
 1-26-83 Drlg 8435
 1-31-83 Drlg 11,050
 2-7-83 Drlg 11,886
 2-14-83 Drlg 13,536
 2-22-83 Drlg 14,028
 2-28-83 Drlg 14,301
 3-7-83 Drlg 14,822
 3-15-83 Drlg 15,082
 3-21-83 TD 15,092, PBD 15,048; LDDP
 3-28-83 TD 15,092; PBD 15,048; Testg
 Perf (Morrow) 14,768-776, 14,778-786 w/1
 SPF
 Natural

4-5-37 NM

LEA
GETTY OIL CO.

Undesignated NM
1 Federal "15" Com. "B" Page 2
Sec 15, T22S, R33E

4-5-83 TD 15,092; PBD 15,048; Tstg
4-7-83 TD 15,092; PBD 14,855; NUBOP
CIBP @ 14,855
4-25-83 TD 15,092; PBD 14,855; Complete
LOG TOPS: Rustler 1211, Lamar Lime 4879,
Delaware Sand 4930, Cherry Canyon 5981,
Bone Spring 8684, Wolfcamp 12,210, Strawn
13,608, Atoka 13,716, Morrow 14,208
LOGS RUN: DILL, MLAT, CNL, GRL, DENL, FD
Rig Released 3-21-83
4-30-83 COMPLETION ISSUED

4-5-87 NM
LC 30-025-70965-82