

NO. OF COPIES RECEIVED	
DISTRIBUTION	
SANITARY	
FILE	
U.S.G.S.	
LAND OFFICE	
OPERATOR	

NEW MEXICO OIL CONSERVATION COMMISSION

Form C-121
Revised 1-1-85

API NO. 30-025-28277

5A. Indicate Type of Lease
STATE ☒ FEDERAL ☐
5. State Oil & Gas Lease No.

APPLICATION FOR PERMIT TO DRILL, DEEPEN, OR PLUG BACK

6a. Type of Work DRILL <input checked="" type="checkbox"/> DEEPEN <input type="checkbox"/> PLUG BACK <input type="checkbox"/>		7. Unit Agreement Name
6b. Type of Well OIL <input checked="" type="checkbox"/> GAS WELL <input type="checkbox"/> OTHER <input type="checkbox"/> SINGLE ZONE <input checked="" type="checkbox"/> MULTIPLE ZONE <input type="checkbox"/>		8. Firm or Lease Name State "A" A/C 2
9. Name of Operator Sun Exploration & Production Co.		9. Well No. 68
10. Address of Operator P. O. Box 1861 - Midland, Texas 79702		10. Field and Pool, or adjacent Eunice Seven Rivers Queen South
11. Location of Well UNIT LETTER <u>E</u> LOCATED <u>2570</u> FEET FROM THE <u>North</u> LINE AND <u>70</u> FEET FROM THE <u>West</u> LINE OF SEC. <u>9</u> TWP. <u>22-S</u> R.C. <u>36-E</u> SECT. <u>1</u>		11. County Lea
12. Proposed Depth 4000		12A. Formation *
12B. Drilling Contractor N/A		12C. Rotary Rotary
13. Estimated Cost (including RI, etc.) 3585.0' GR		13A. Kind of Mud Pump Used Blanket on file
13B. Approx. Date Work will start ASAP		

PROPOSED CASING AND CEMENT PROGRAM

SIZE OF HOLE	SIZE OF CASING	WEIGHT PER FOOT	SETTING DEPTH	SACKS OF CEMENT	EST. TOP
12 1/4	8-5/8	24#	550	375 sxs	Surface
7-7/8	5-1/2	14#	3900	1100 sxs	Surface

Blowout preventer 10" hydraulic

*19A. Primary Reservoir - Queen
Secondary Reservoir - Seven Rivers

APPROVAL VALID FOR 180 DAYS
PERMIT EXPIRES 2/5/84
UNLESS DRILLING UNDERWAY

IN ABOVE SPACE DESCRIBE PROPOSED PROGRAM: IF PROPOSAL IS TO DEEPEN OR PLUG BACK, GIVE DATA ON PRESENT PRODUCTIVE ZONE AND PROPOSED NEW PRODUCTIVE ZONE. GIVE BLOWOUT PREVENTER PROGRAM, IF ANY.

I hereby certify that the information above is true and complete to the best of my knowledge and belief.

Signed Dee Ann Long Title Senior Accounting Assistant Date 7-12-83

(This space for State Use)

ORIGINAL SIGNED BY JERRY SEXTON

APPROVED BY DISTRICT SUPERVISOR TITLE DATE AUG 5 1983

CONDITIONS OF APPROVAL, IF ANY:

NEW MEXICO OIL CONSERVATION COMMISSION
WELL LOCATION AND ACREAGE DEDICATION PLAT

Form O-102
Supersedes O-101
Effective 1-1-83

All distances must be from the outer boundaries of the Section

Operator Sun Exploration & Producing Company			Lease State "A" A/C 2		Well No. 68
Tract Letter E	Section 9	Township 22 South	Range 36 East	County Lea County	
Actual Footage Location of Well: <div style="display: flex; justify-content: space-between; align-items: center;"> 2570 feet from the North line and 70 feet from the West line </div>					
Ground Level Elev. 3585.0	Producing Formation Queen	Pool Euwice Seew Rivers Queen South		Dedicated Acreage: 40	

1. Outline the acreage dedicated to the subject well by colored pencil or hatchure marks on the plat below.
2. If more than one lease is dedicated to the well, outline each and identify the ownership thereof (both as to working interest and royalty).
3. If more than one lease of different ownership is dedicated to the well, have the interests of all owners been consolidated by communitization, unitization, force-pooling, etc?

☐ Yes ☐ No If answer is "yes," type of consolidation _____

If answer is "no," list the owners and tract descriptions which have actually been consolidated (Use reverse side of this form if necessary.) _____

No allowable will be assigned to the well until all interests have been consolidated (by communitization, unitization, forced-pooling, or otherwise) or until a non-standard unit, eliminating such interests, has been approved by the Commission.

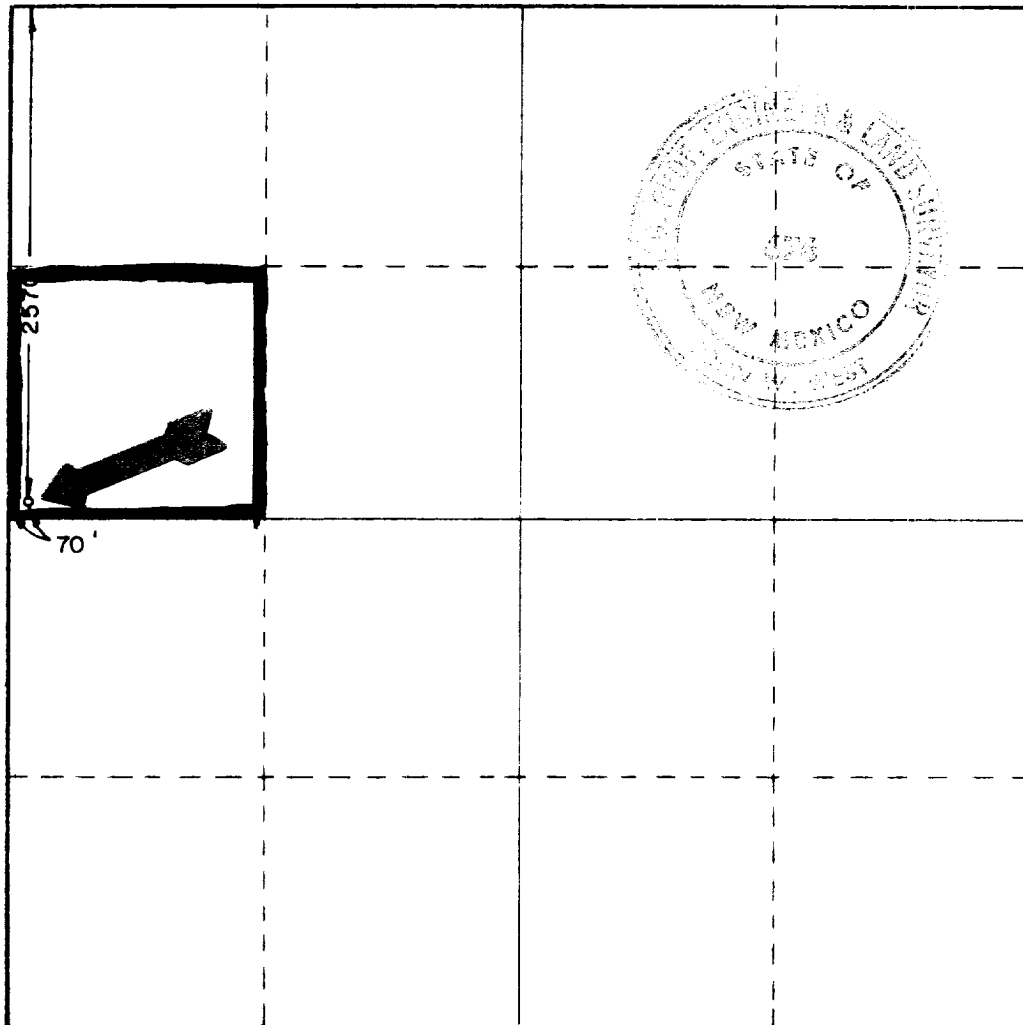

CERTIFICATION

I hereby certify that the information contained herein is true and complete to the best of my knowledge and belief.

Dee Ann Kemp
 Name
Dee Ann Kemp
 Position
Senior Acct. Asst.
 Company
Sun Exploration & Producing Co.
 Date
7-13-83

I hereby certify that the well location shown on this plat was plotted from field notes of actual surveys made by me or under my supervision, and that the same is true and correct to the best of my knowledge and belief.

Date Surveyed
June 30, 1983
 Registered Professional Engineer
 and/or Land Surveyor

John W. West
 Certificate No. **JOHN W. WEST, 67**
RONALD J. EIDSON, 3259

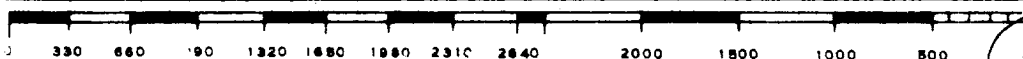

JUL 15 1983

