

| | |
|------------------------|--|
| NO. OF COPIES RECEIVED | |
| DISTRIBUTION | |
| SANTA FE | |
| FILE | |
| U.S.G.S. | |
| LAND OFFICE | |
| OPERATOR | |

NEW MEXICO OIL CONSERVATION COMMISSION

Form C-101
Revised 1-1-65

API NO. 30-025-282 ⁷⁹~~80~~

| |
|--|
| 5A. Indicate Type of Lease |
| STATE <input checked="" type="checkbox"/> FEE <input type="checkbox"/> |
| 5. State Oil & Gas Lease No. |
| 6. Unit Agreement Name |
| 8. Name of Lease Name |
| State "A" A/C 2 |
| 9. Well No. |
| 70 |
| 10. Field and Pool, or Wildcat |
| Eunice Seven Rivers |
| Queen South |
| 12. County |
| Lea |
| 14. Proposed depth |
| 4000 |
| 15A. Formation |
| * |
| 16. Rotary or M.T. |
| Rotary |
| 17. Elevation (Show whether B.P., K.L., etc.) |
| 3560.6' GR |
| 18. Kind & Status of Log, etc. |
| Blanket on file |
| 19. Drilling Contractor |
| N/A |
| 20. Approx. Date Work will start |
| ASAP |

APPLICATION FOR PERMIT TO DRILL, DEEPEN, OR PLUG BACK

a. Type of Work

DRILL ☒ DEEPEN ☐ PLUG BACK ☐

b. Type of Well

OIL WELL ☒ GAS WELL ☐ OTHER ☐

c. Name of Operator

Sun Exploration & Production Co.

d. Address of Operator

P. O. Box 1861 - Midland, Texas 79702

e. Location of Well

UNIT LETTER P LOCATED 1295 FEET FROM THE South LINE

1295 FEET FROM THE East LINE OF SEC. 8 TWP. 22-S RCF. 36-E

1. Elevation (Show whether B.P., K.L., etc.)

3560.6' GR

2. Kind & Status of Log, etc.

Blanket on file

3. Drilling Contractor

N/A

4. Approx. Date Work will start

ASAP

PROPOSED CASING AND CEMENT PROGRAM

| SIZE OF HOLE | SIZE OF CASING | WEIGHT PER FOOT | SETTING DEPTH | SACKS OF CEMENT | EST. TOP |
|--------------|----------------|-----------------|---------------|-----------------|----------|
| 12 1/4 | 8-5/8 | 24# | 550 | 375 sxs | Surface |
| 7-7/8 | 5 1/2 | 14# | 3900 | 1100 sxs | Surface |

Blowout preventer: 10" Hydraulic

*19A. Primary Reservoir - Queen
Secondary Reservoir - Seven Rivers

APPROVAL VALID FOR 180 DAYS
PERMIT EXPIRES 2/22/84
UNLESS DRILLING UNDERWAY

IN ABOVE SPACE DESCRIBE PROPOSED PROGRAM IF PROPOSAL IS TO DEEPEN OR PLUG BACK, GIVE DATA ON PRESENT PRODUCTIVE ZONE AND PROPOSED NEW PRODUCTIVE ZONE. GIVE BLOWOUT PREVENTER PROGRAM, IF ANY.

I hereby certify that the information above is true and complete to the best of my knowledge and belief.

Signed DeAnn Kemp Title Senior Accounting Assistant Date 7-12-83

(This space for State Use)

ORIGINAL SIGNED BY JERRY SEXTON

DISTRICT 1 SUPERVISOR

APPROVED BY _____ TITLE _____ DATE _____

CONDITIONS OF APPROVAL, IF ANY:

AUG 22 1983

RECEIVED

JUL 15 1983

O.C.D.
HOBBS OFFICE

NEW MEXICO OIL CONSERVATION COMMISSION
WELL LOCATION AND ACREAGE DEDICATION PLAT

Form C-102
Supersedes C-128
Effective 1-1-65

All distances must be from the outer boundaries of the Section

| | | | | | |
|--|-------------------------------------|--|--------------------------------------|-----------------------------|-----------------------|
| Operator Sun Exploration & Producing Company | | | Lease State A A/C 2 | | Well No. 70 |
| Section Letter P | Section 8 | Township 22 South | Range 36 East | County Lea County | |
| Actual Footage Location of Well: | | | | | |
| 1295 feet from the South line and | | 1295 feet from the East line | | | |
| Ground Level Elev. 3560.6 | Producing Formation Queen | Pool Eunice Seven Rivers Queen South | Dedicated Acreage 40 Acres | | |

1. Outline the acreage dedicated to the subject well by colored pencil or hatchure marks on the plat below.
2. If more than one lease is dedicated to the well, outline each and identify the ownership thereof (both as to working interest and royalty).
3. If more than one lease of different ownership is dedicated to the well, have the interests of all owners been consolidated by communitization, unitization, force-pooling, etc?

☐ Yes ☐ No If answer is "yes," type of consolidation _____

If answer is "no," list the owners and tract descriptions which have actually been consolidated. (Use reverse side of this form if necessary.) _____

No allowable will be assigned to the well until all interests have been consolidated (by communitization, unitization, forced-pooling, or otherwise) or until a non-standard unit, eliminating such interests, has been approved by the Commission.

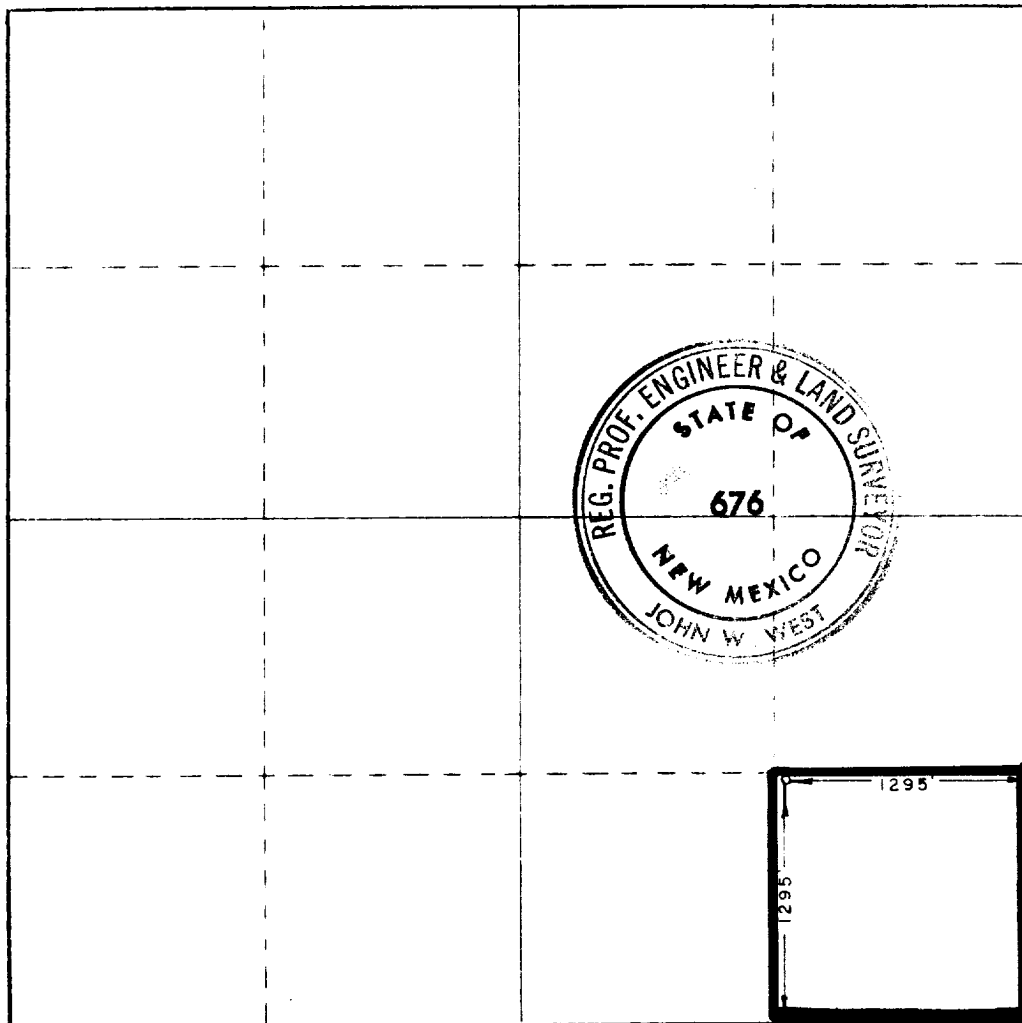

CERTIFICATION

I hereby certify that the information contained herein is true and complete to the best of my knowledge and belief.

Dee Ann Kemp
Name

Dee Ann Kemp
Signature

Sr. Acct. Asst.
Position

Sun Exploration Productions
Company

7-12-83
Date

I hereby certify that the well location shown on this plat was plotted from field notes of actual surveys made by me or under my supervision, and that the same is true and correct to the best of my knowledge and belief.

Date Surveyed

June 25, 1983

Registered Professional Engineer
and/or Land Surveyor

Ronald J. Eidson
Signature

Certificate No. **JOHN W. WEST, 676**
RONALD J. EIDSON, 5239



113

RECEIVED
JUL 15 1983
O.C.D.
HOBBS OFFICE