

WELL LOCATION AND ACREAGE DEDICATION PLAT

Supersedes Circular
Effective 1-1-85

All distances must be from the outer boundaries of the Section.

Lessor HNG OIL COMPANY			Lease SAN SIMON "5" STATE		Well No. 2
Letter G	Section 5	Township 22 SOUTH	Range 35 EAST	County LEA	

Well Footage Location of Well:

1980	feet from the	NORTH	line and	1980	feet from the	EAST	line
and Level Elev. 3621.2' GR	Producing Formation Wolfcamp		Pool San Simon		Dedicated Acreage: 320-160		

1. Outline the acreage dedicated to the subject well by colored pencil or hachure marks on the plat below.
2. If more than one lease is dedicated to the well, outline each and identify the ownership thereof (both as to working interest and royalty).

If more than one lease of different ownership is dedicated to the well, have the interests of all owners been consolidated by communitization, unitization, force-pooling, etc?

☐ Yes ☐ No If answer is "yes," type of consolidation _____

If answer is "no," list the owners and tract descriptions which have actually been consolidated. (Use reverse side of this form if necessary.) _____

No allowable will be assigned to the well until all interests have been consolidated (by communitization, unitization, forced-pooling, or otherwise) or until a non-standard unit, eliminating such interests, has been approved by the Commission.

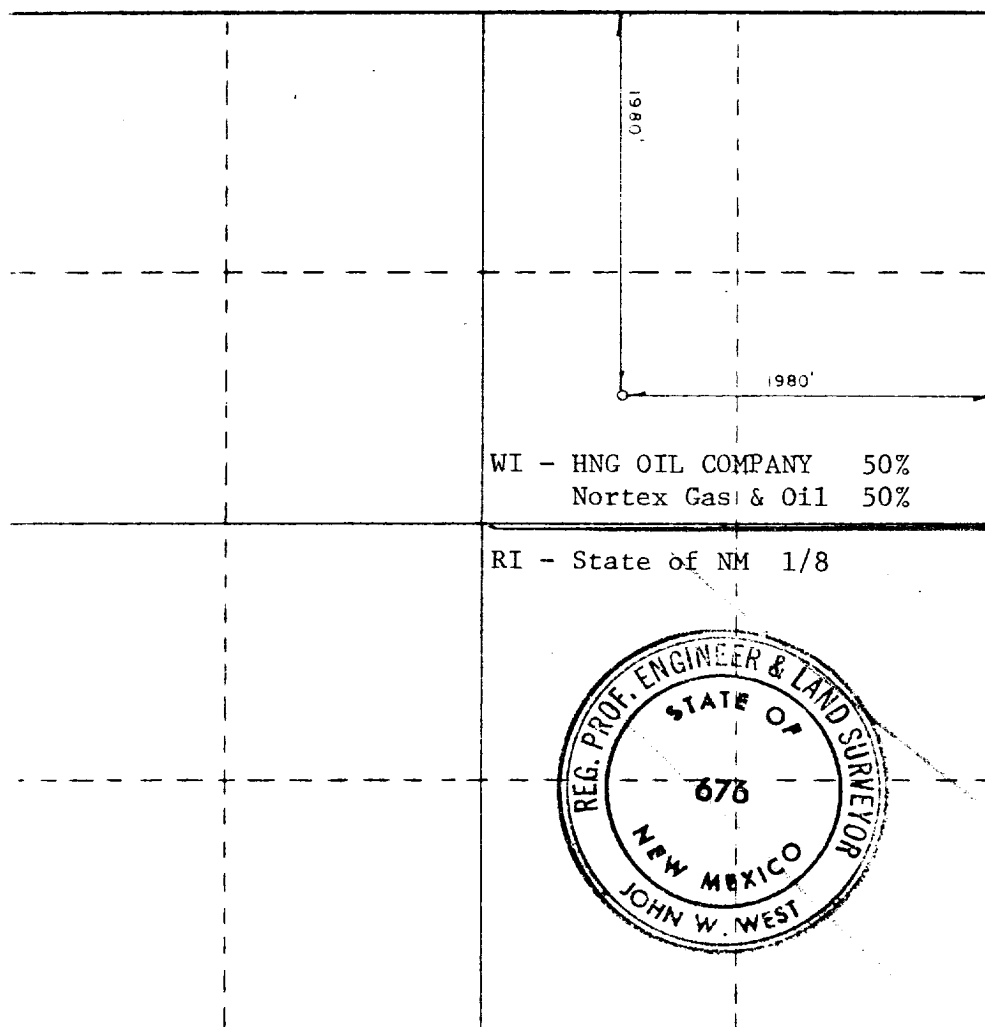

CERTIFICATION

I hereby certify that the information contained herein is true and complete to the best of my knowledge and belief.

Betty Gildon

Name

Betty Gildon

Position

Regulatory Analyst

Company

HNG OIL COMPANY

Date

3/25/86

I hereby certify that the well location shown on this plat was plotted from field notes of actual surveys made by me or under my supervision, and that the same is true and correct to the best of my knowledge and belief.

Date Surveyed

NOVEMBER 11, 1983

Registered Professional Engineer
and/or Land Surveyor

John W. West

Certificate No

JOHN W. WEST,

676

RONALD J. EIDSON,

3239

130 660 90 1320 1680 1980 2310 2640 2000 1800 1000 800