

N M EXICO OIL CONSERVATION COMMISS
WELL LOCATION AND ACREAGE DEDICATION PLAT

Form C-102
 Supersedes C-128
 Effective 1-1-65

All distances must be from the outer boundaries of the Section

Operator HNG OIL CO.		Lease SAN SIMON STATE "5"		Well No. 2
Map Letter G	Section 5	Township 22 SOUTH	Range 35 EAST	County LEA
Actual Footage Location of Well:				
1980	feet from the	EAST	line and	1980 feet from the
				NORTH
Ground Level Elev. 3621.2	Producing Formation Morrow		Pool East Grama Ridge	Dedicated Acreage 320

1. Outline the acreage dedicated to the subject well by colored pencil or hachure marks on the plat below.
2. If more than one lease is dedicated to the well, outline each and identify the ownership thereof (both as to working interest and royalty).
3. If more than one lease of different ownership is dedicated to the well, have the interests of all owners been consolidated by communitization, unitization, force-pooling, etc?

☐ Yes ☐ No If answer is "yes," type of consolidation _____

If answer is "no," list the owners and tract descriptions which have actually been consolidated. (Use reverse side of this form if necessary.) _____

No allowable will be assigned to the well until all interests have been consolidated (by communitization, unitization, forced-pooling, or otherwise) or until a non-standard unit, eliminating such interests, has been approved by the Commission.

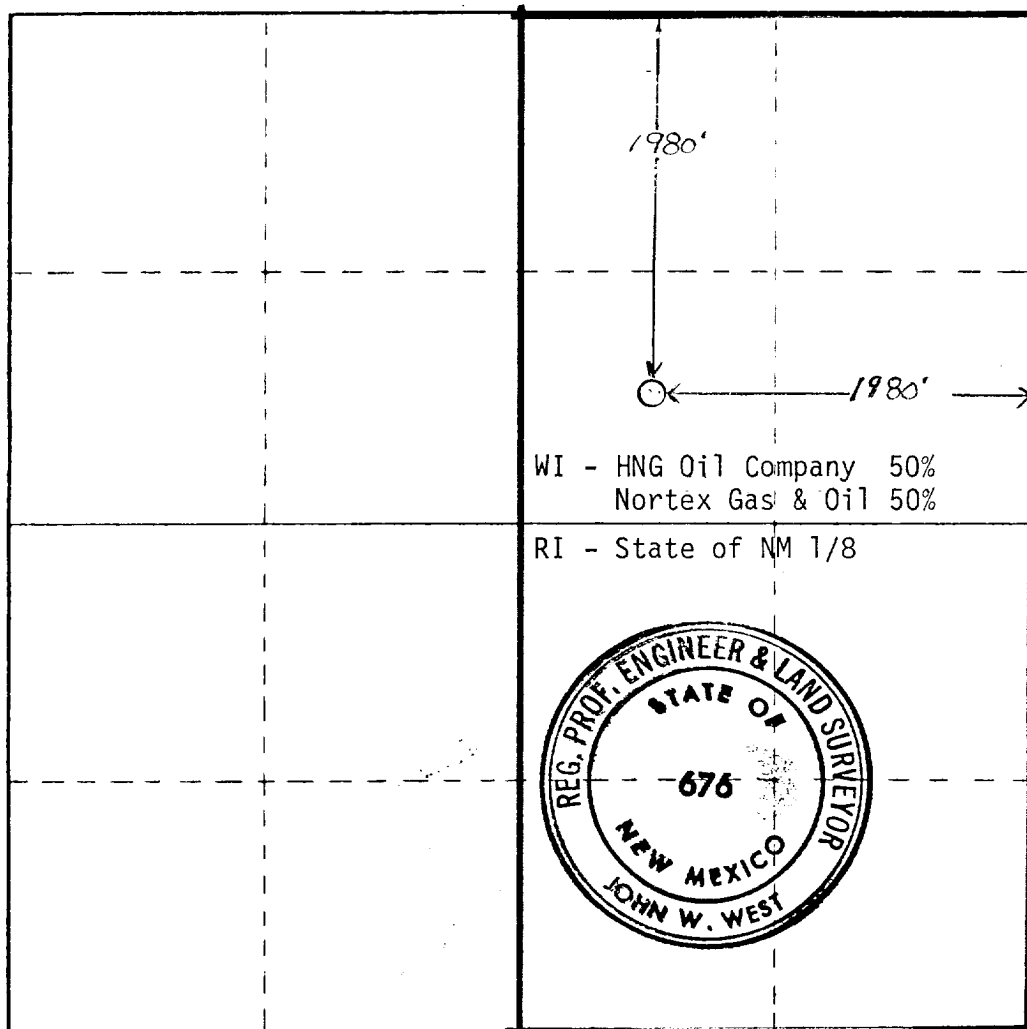

CERTIFICATION

I hereby certify that the information contained herein is true and complete to the best of my knowledge and belief

Betty Gildon

Name
Betty Gildon

Position
Regulatory Analyst

Company
HNG OIL COMPANY

Date
November 10, 1983

I hereby certify that the well location shown on this plat was plotted from field notes of actual surveys made by me or under my supervision, and that the same is true and correct to the best of my knowledge and belief.

Date Surveyed
OCTOBER 13, 1983

Registered Professional Engineer and/or Land Surveyor

John W. West

Certificate No. **JOHN W. WEST**

111

RECEIVED
NOV 14 2003
C. C. C.
HOLLY OFFICE