

30-025-28548

NO. OF COPIES RECEIVED		
DISTRIBUTION		
SANTA FE		
FILE		
U.S.G.S.		
LAND OFFICE		
OPERATOR		

NEW MEXICO OIL CONSERVATION COMMISSION

Form C-101
Revised 1-4-65

5A. Indicate Type of Lease STATE <input checked="" type="checkbox"/> FEE <input type="checkbox"/>	
5. State Oil & Gas Lease No. E-1932	
7. Unit Agreement Name ---	
8. Farm or Lease Name PHILLIPS STATE	
9. Well No. 1	
10. Field and Pool, or Wildcat Jalmat (Y-SR)	
12. County Lea	
19. Proposed Depth 4200'	19A. Formation Yates
20. Rotary or C.T. Rotary	
21A. Kind & Status Plug. Bond One-Well (Pending)	21B. Drilling Contractor Marc Drilling Inc.
22. Approx. Date Work will start 12-27-83	

APPLICATION FOR PERMIT TO DRILL, DEEPEN, OR PLUG BACK

a. Type of Work DRILL <input checked="" type="checkbox"/> DEEPEN <input type="checkbox"/> PLUG BACK <input type="checkbox"/>	
b. Type of Well OIL WELL <input checked="" type="checkbox"/> GAS WELL <input type="checkbox"/> OTHER <input type="checkbox"/> SINGLE ZONE <input checked="" type="checkbox"/> MULTIPLE ZONE <input type="checkbox"/>	
c. Name of Operator JUBILEE ENERGY CORPORATION (915-686-0431) (Tom Garber)	
d. Address of Operator 3100 North A Street, Suite E-103, Midland, Texas 79701	
e. Location of Well UNIT LETTER H LOCATED 1980 FEET FROM THE North LINE AND 330 FEET FROM THE East LINE OF SEC. 10 TWP. 22S RGE. 35E NMPM	
f. Elevations (Show whether DF, RT, etc.) 3613' G.L.	

PROPOSED CASING AND CEMENT PROGRAM

SIZE OF HOLE	SIZE OF CASING	WEIGHT PER FOOT	SETTING DEPTH	SACKS OF CEMENT	EST. TOP
11"	8 5/8"	24#	400'	150	Surface
7 7/8"	5 1/2"	13#	4200'	*	*

* Proposed First Stage at total depth with 200 sacks circulated back into salt section.
Proposed Second Stage at 1500/1700' with 300 sacks circulated back into 8 5/8" casing.

Pay zone will be selectively perforated and stimulated as needed for optimum production.

Attached are: 1. Well Location and Acreage Dedication Plat
2. BOP Sketch

APPROVAL VALID FOR 180 DAYS
PERMIT EXPIRES 7/10/84
UNLESS DRILLING UNDERWAY

ABOVE SPACE DESCRIBE PROPOSED PROGRAM: IF PROPOSAL IS TO DEEPEN OR PLUG BACK, GIVE DATA ON PRESENT PRODUCTIVE ZONE AND PROPOSED NEW PRODUCTION ZONE. GIVE BLOWOUT PREVENTER PROGRAM, IF ANY.

I hereby certify that the information above is true and complete to the best of my knowledge and belief.

Signed James A. Knaut Title Agent Date December 15, 1983
(This space for State Use)

ORIGINAL SIGNED BY JERRY SEXTON
DISTRICT 1 SUPERVISOR

APPROVED BY _____ DATE _____

CONDITIONS OF APPROVAL, IF ANY:

JAN 10 1984

**NEW MEXICO OIL CONSERVATION COMMISSION
WELL LOCATION AND ACREAGE DEDICATION PLAT**

Form C-102
Supersedes C-128
Effective 1-1-85

All distances must be from the outer boundaries of the Section

Operator JUBILEE ENERGY CORP.		Lease PHILLIPS STATE		Well No. 1
Section Letter H	Section 10	Township 22S	Range 35E	County LEA
Actual Footage Location of Well:				
1980	feet from the NORTH	line and 330	feet from the EAST	line
Land Level Elev. 3613.1	Producing Formation Yates	Fluid Jalmat (Y-SR)	Dedicated Acreage 40	

1. Outline the acreage dedicated to the subject well by colored pencil or hachure marks on the plat below.
2. If more than one lease is dedicated to the well, outline each and identify the ownership thereof (both as to working interest and royalty).
3. If more than one lease of different ownership is dedicated to the well, have the interests of all owners been consolidated by communitization, unitization, force-pooling etc?

☐ Yes ☐ No If answer is "yes," type of consolidation _____

If answer is "no," list the owners and tract descriptions which have actually been consolidated (use reverse side of this form if necessary): _____

No allowable will be assigned to the well until all interests have been consolidated (by communitization, unitization, forced-pooling, or otherwise) or until a non-standard unit, eliminating such interests, has been approved by the Commission.

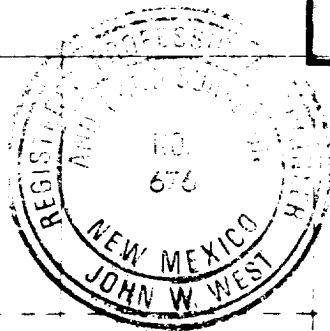
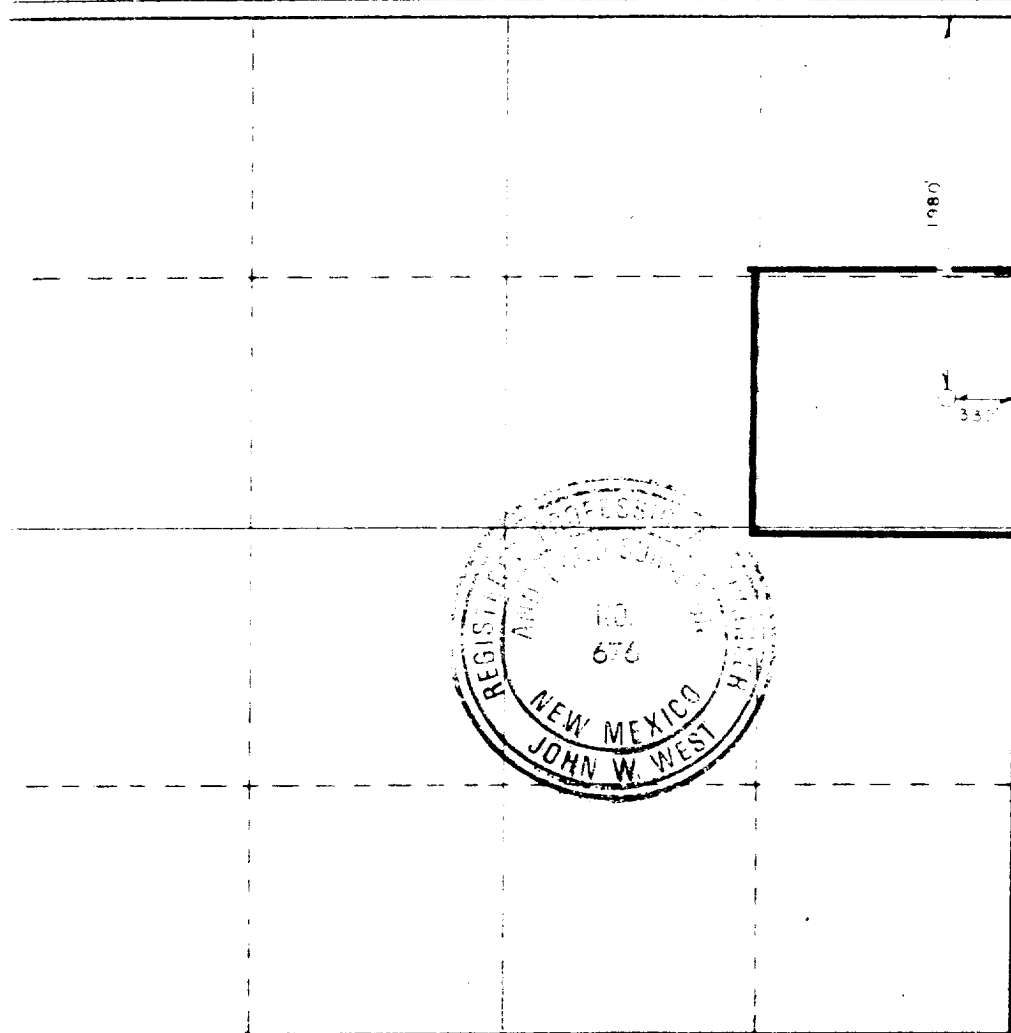

CERTIFICATION

I hereby certify that the information furnished herein is true and complete to the best of my knowledge and belief.

James A. Knauft
James A. Knauft

Agent

JUBILEE ENERGY CORP.

December 19, 1983

I hereby certify that the well location shown on this plat was plotted from field notes of actual surveys made by me or under my supervision, and that the same is true and correct to the best of my knowledge and belief.

Date Surveyed:
12/15/83

Registered Professional Engineer
☒ or ☐ Surveyor

John W. West

Certificate No.
N.M. P.E. & L.S. NO. 676

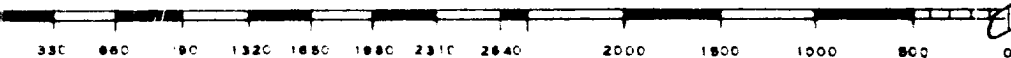

DEC 21 1983
P.C.D.
HOUSE OFFICE

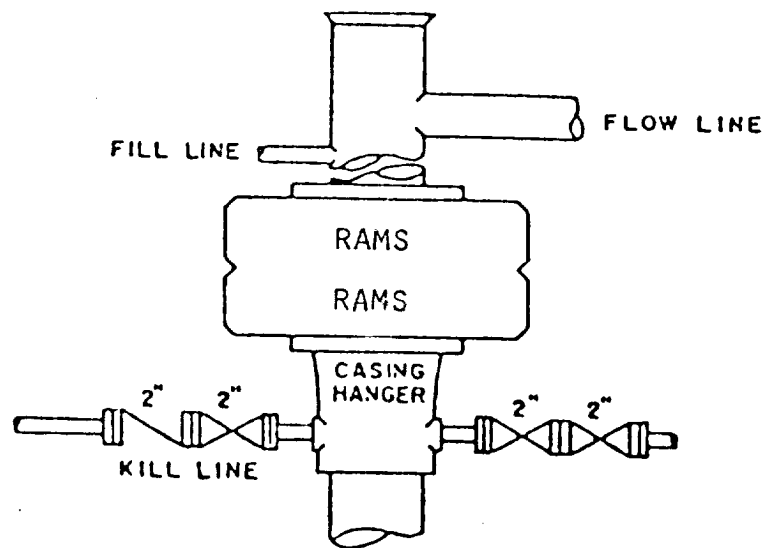

BOP ARRANGEMENT

RECEIVED
DEC 21 1983
O-503
Housing Office