

30-025-28653

NO. OF COPIES RECEIVED	
DISTRIBUTION	
SANTA FE	
FILE	
U.S.G.S.	
LAND OFFICE	
OPERATOR	

## NEW MEXICO OIL CONSERVATION COMMISSION

Form O-101  
Revised 1-1-65

5A. Indicate Type of Lease	
STATE <input type="checkbox"/>	FEE <input checked="" type="checkbox"/>
5. State Oil & Gas Lease No.	

## APPLICATION FOR PERMIT TO DRILL, DEEPEN, OR PLUG BACK

1a. Type of Work DRILL <input checked="" type="checkbox"/> DEEPEN <input type="checkbox"/> PLUG BACK <input type="checkbox"/>		7. Unit Agreement Name	
b. Type of Well OIL WELL <input checked="" type="checkbox"/> GAS WELL <input type="checkbox"/> OTHER <input type="checkbox"/> SINGLE ZONE <input checked="" type="checkbox"/> MULTIPLE ZONE <input type="checkbox"/>		8. Firm or Lease Name S.J. SARKEY	
3. Name of Operator GULF OIL CORPORATION		9. Well No. 2	
6. Address of Operator P.O. Box 670 Hobbs, New Mexico 88240		10. Field and Pool, or Wildcat WANTZ GRANITE WASH	
4. Location of Well UNIT LETTER E LOCATED 2310 FEET FROM THE NORTH LINE AND 660 FEET FROM THE WEST LINE OF SEC. 25 TWP. 21S RGE. 37E NMPM		11. Undesignated UNDESIGNATED	
		12. County LEA	
19. Proposed Depth 7700		19A. Formation GRANITE WASH	20. Rotary or C.T. ROTARY
21. Elevations (Show whether DE, RT, etc.) 3379 GL	21A. Kind & Status Plug. Bond BLANKET	21B. Drilling Contractor UNKNOWN	22. Approx. Date Work will start APRIL 1, 1984

## PROPOSED CASING AND CEMENT PROGRAM

SIZE OF HOLE	SIZE OF CASING	WEIGHT PER FOOT	SETTING DEPTH	SACKS OF CEMENT	EST. TOP
12 1/4	8 5/8	24#	1400	~ 600	SURFACE
7 7/8	5 1/2	15.5#	7700	~ 1600	TIEBACK TO CSG

MUD PROGRAM: 0-1400 FW SPUD MUD 8.6-8.8 ppq 32-36vis 9.0ph NCONWL  
 1400-6800 SATURATED BRINE 9.8-10.2 ppq 29-33vis 8.0pH NCONWL  
 6800-7700 BRINE POLYMER 9.9-10.1 ppq 32-34vis 9.0pH 6% KCL <20WL

BOP PROGRAM: DRAWING # 2 3000 psi WORKING PRESSURE

APPROVAL VALID FOR 180 DAYS  
 PERMIT EXPIRES 9/27/84  
 UNLESS DRILLING UNDERWAY

IN ABOVE SPACE DESCRIBE PROPOSED PROGRAM: IF PROPOSAL IS TO DEEPEN OR PLUG BACK, GIVE DATA ON PRESENT PRODUCTIVE ZONE AND PROPOSED NEW PRODUCTIVE ZONE. GIVE BLOWOUT PREVENTER PROGRAM, IF ANY.

I hereby certify that the information above is true and complete to the best of my knowledge and belief.

Signed L.C. Under Title AREA PROD MGR Date 3-22-84

(This space for State Use)

ORIGINAL SIGNED BY JERRY SEXTON

DISTRICT I SUPERVISOR

APPROVED BY \_\_\_\_\_ TITLE \_\_\_\_\_ DATE MAR 27 1984

CONDITIONS OF APPROVAL, IF ANY:

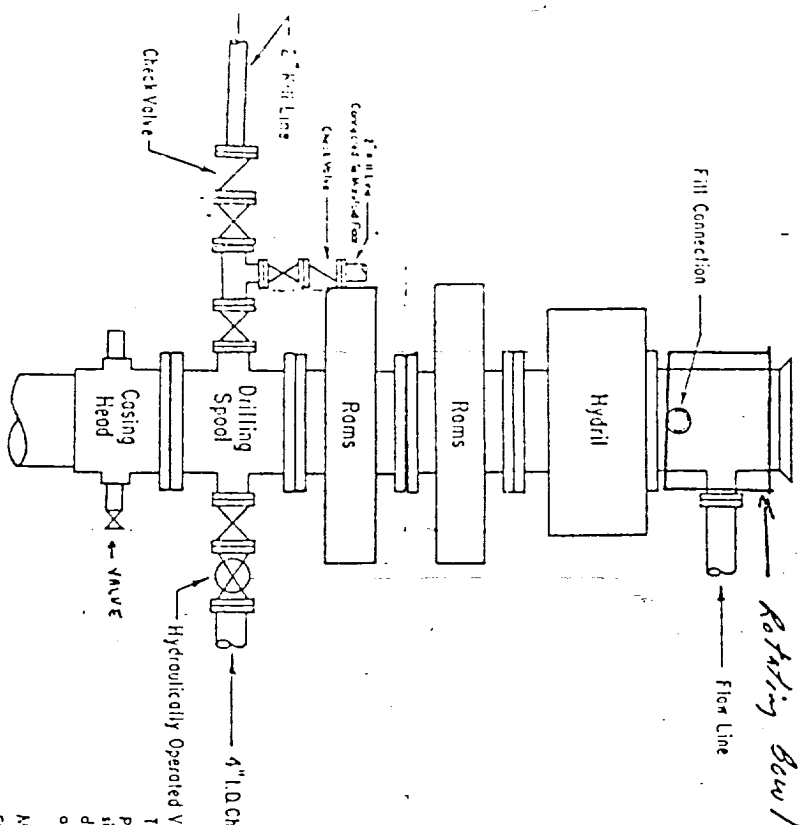

## 2000-3000 PSI WORKING PRESSURE BOP HOOK-UP FOR LARGE CASINGS

### SPECIFY WORKING PRESSURE

labeled, with control handles to indicate open and closed positions. A pressure reducer and regulator must be provided for operating the Hydril preventer. When requested, a second pressure reducer shall be available to limit operating fluid pressures to ram preventers. Gulf Region No. 38 hydraulic oil, or equivalent or better, is to be used as the fluid to operate the hydraulic equipment.

The choke manifold, the choke flow line, the choke lines and the relief lines are to be supported by metal stands and adequately anchored. The choke flow line, relief lines and choke lines shall be constructed as straight as possible and without sharp bends. Easy access shall be maintained to the choke manifold. All valves are to be selected for operation in the presence of oil, gas, and drilling fluids. The choke flow line valves and valves of the relief lines connected to the drilling spools and all ram type preventers must be equipped with stem extensions, universal joints if needed, and hand wheels which are to extend beyond the edge of the derrick substructure. All other valves shall be equipped with handles.

### THE BLOWOUT PREVENTER ASSEMBLY REQUIRED

The blowout preventer assembly shall consist of one blind ram preventer and one pipe ram preventer, both hydraulically operated; a Hydril preventer; valves, chokes and connections, as illustrated. If a tapered drill string is used, a ram preventer shall be provided for each size of drill pipe. Casing and tubing rams to fit the preventers are to be available as needed. The ram preventers may be two singles or a double type. If correct in size, the flanged outlets of the ram preventer may be used for connecting to the 4-inch I.D. choke flow line and to the kill line. The substructure height shall be sufficient to install a rotating blowout preventer.

Minimum operating equipment for the preventers and hydraulically operated valves shall be as follows: (1) multiple pumps, driven by a continuous source of power, capable of fluid charging the total accumulator volume from the nitrogen precharge pressure to its rated pressure within 2 minutes. Also, the pumps are to be connected to the hydraulic operating system which is to be a closed system. (2) accumulators with a precharge of nitrogen of not less than 750 PSI and connected so as to receive the aforementioned fluid charge. With the charging pumps shut down, the pressurized fluid volume stored in the accumulators shall be sufficient to close all the pressure-operated devices simultaneously within 4 seconds after closure. The remaining accumulator pressure shall be not less than 1000 PSI with the and equivalent, is to be available to operate the above pumps; or there shall be additional pumps operated by separate power and equal in performance capabilities.

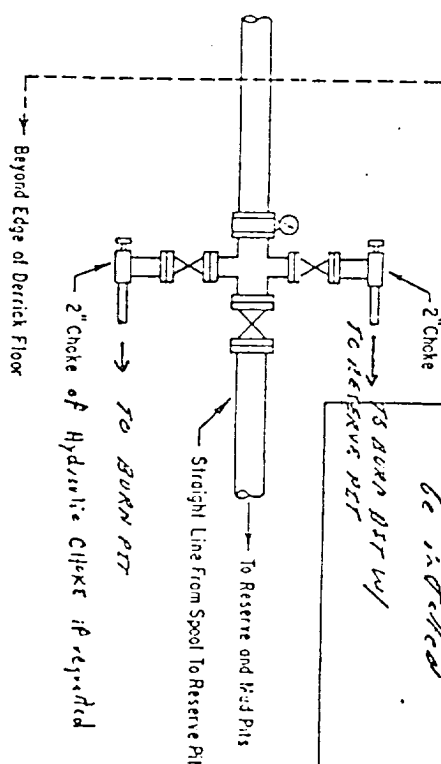

### ADDITIONS - DELETIONS - CHANGES SPECIFY

NOTE: "When Requested" means at any time the Gulf Region can, may, or will require the equipment to be installed during operations.

Nothing shall be indicated

NEW MEXICO OIL CONSERVATION COMMISS.  
WELL LOCATION AND ACREAGE DEDICATION PLAT

Form C-102  
Supersedes C-128  
Effective 1-1-65

All distances must be from the outer boundaries of the Section

Operator <b>GULF OIL CORP.</b>		Lease <b>S. J. SARKEYS</b>		Well No. <b>2</b>
Unit Letter <b>E</b>	Section <b>25</b>	Township <b>21 SOUTH</b>	Range <b>37 EAST</b>	County <b>LEA</b>

Actual Footage Location of Well:

<b>2310</b> feet from the <b>NORTH</b> line and <b>660</b> feet from the <b>WEST</b> line	
Ground Level Elev. <b>3379.0'</b>	Producing Formation <b>Granite Wash</b>
Pool <b>Wertz Granite Wash</b>	Dedicated Acreage: <b>40</b> Acres

- Outline the acreage dedicated to the subject well by colored pencil or hachure marks on the plat below.
- If more than one lease is dedicated to the well, outline each and identify the ownership thereof (both as to working interest and royalty).
- If more than one lease of different ownership is dedicated to the well, have the interests of all owners been consolidated by communitization, unitization, force-pooling, etc?

☐ Yes ☐ No If answer is "yes," type of consolidation \_\_\_\_\_

If answer is "no," list the owners and tract descriptions which have actually been consolidated. (Use reverse side of this form if necessary.) \_\_\_\_\_

No allowable will be assigned to the well until all interests have been consolidated (by communitization, unitization, forced-pooling, or otherwise) or until a non-standard unit, eliminating such interests, has been approved by the Commission.

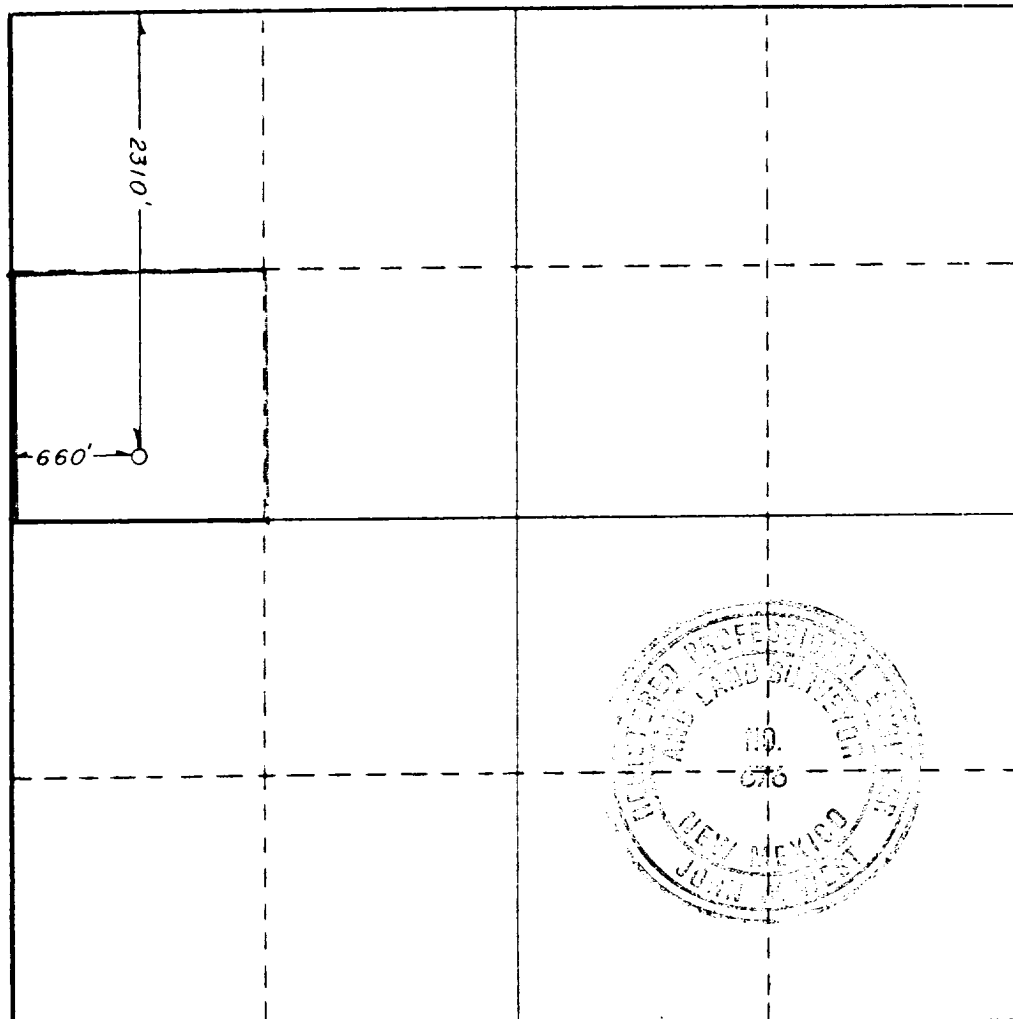

CERTIFICATION

I hereby certify that the information contained herein is true and complete to the best of my knowledge and belief.

Name  
**R.C. ANDERSON**  
Position  
**AREA PROD MANAGER**  
Company  
**GULF OIL CORP**

Date  
**3-22-84**

I hereby certify that the well location shown on this plat was plotted from field notes of actual surveys made by me or under my supervision, and that the same is true and correct to the best of my knowledge and belief.

Date Surveyed  
**3/20/84**

Registered Professional Engineer and/or Land Surveyor

**John W West**  
Certificate No. **JOHN W. WEST, 676**  
**RONALD J. EIDSON, 3239**



MAR 26 1984  
O.C.  
HOBBSVILLE

473