

District I  
PO Box 1980, Hobbs, NM 88241-1980

District II  
811 South First, Artesia, NM 88210

District III  
1000 Rio Brazos Rd., Aztec, NM 87410

District IV  
2040 South Pacheco, Santa Fe, NM 87505

State of New Mexico  
Energy, Minerals & Natural Resources Department

OIL CONSERVATION DIVISION  
2040 South Pacheco  
Santa Fe, NM 87505

Form C-102  
Revised October 18, 1994  
Instructions on back  
Submit to Appropriate District Office  
State Lease - 4 Copies  
Fee Lease - 3 Copies

☐ AMENDED REPORT

WELL LOCATION AND ACREAGE DEDICATION PLAT

<sup>1</sup> API Number 30-025-28900	<sup>2</sup> Pool Code 06660	<sup>3</sup> Pool Name Blinebry Oil & Gas
<sup>4</sup> Property Code 19968	<sup>5</sup> Property Name Hardy, Cordelia	<sup>6</sup> Well Number 8
<sup>7</sup> OGRID No. 012024	<sup>8</sup> Operator Name John H. Hendrix Corporation	<sup>9</sup> Elevation

<sup>10</sup>Surface Location

UL or lot no. C	Section 29	Township 21S	Range 37E	Lot Idn	Feet from the 760	North/South line North	Feet from the 1880	East/West Line West	County Lea
--------------------	---------------	-----------------	--------------	---------	----------------------	---------------------------	-----------------------	------------------------	---------------

<sup>11</sup>Bottom Hole Location If Different From Surface

UL or lot no.	Section	Township	Range	Lot Idn	Feet from the	North/South line	Feet from the	East/West Line	County
<sup>12</sup> Dedicated Acres 40.00	<sup>13</sup> Joint or Infill	<sup>14</sup> Consolidation Code	<sup>15</sup> Order No.						

NO ALLOWABLE WILL BE ASSIGNED TO THIS COMPLETION UNTIL ALL INTERESTS HAVE BEEN CONSOLIDATED  
OR A NON-STANDARD UNIT HAS BEEN APPROVED BY THE DIVISION

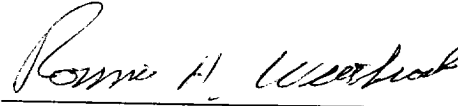
<sup>16</sup>					<sup>17</sup> OPERATOR CERTIFICATION I hereby certify that the information contained herein is true and complete to the best of my knowledge and belief  Signature Ronnie H. Westbrook Printed Name Vice President Title 11-23-98 Date
					<sup>18</sup> SURVEYOR CERTIFICATION I hereby certify that the well location shown on this plat was plotted from field notes of actual surveys made by me or under my supervision, and that the same is true and correct to the best of my belief.  Date of Survey Signature and Seal of Professional Surveyer:  Certificate Number

## OIL CONSERVATION DIVISION

P. O. BOX 2088

SANTA FE, NEW MEXICO 87501

Form C-1C2  
Revised 10-1-78

STATE OF NEW MEXICO

ENERGY AND MINERALS DEPARTMENT

All distances must be from the outer boundaries of the Section.

Operator Mobil Producing TX. & N.M. Inc.		Lease Cordelia Hardy		Well No. 8	
Unit Letter C	Section 29	Township 21-S	Range 37-E	County Lea	
Actual Footage Location of Well:					
760' feet from the North		line and 1880		feet from the West line	
Ground Level Elev. 3488	Producing Formation Blinebrv		Pool Blinebrv Oil & Gas		Dedicated Acreage: 160 Acres

1. Outline the acreage dedicated to the subject well by colored pencil or hatchure marks on the plat below.
2. If more than one lease is dedicated to the well, outline each and identify the ownership thereof (both as to working interest and royalty).
3. If more than one lease of different ownership is dedicated to the well, have the interests of all owners been consolidated by communitization, unitization, force-pooling, etc?

☒ Yes ☐ No If answer is "yes," type of consolidation Communitization

If answer is "no," list the owners and tract descriptions which have actually been consolidated. (Use reverse side of this form if necessary.)

No allowable will be assigned to the well until all interests have been consolidated (by communitization, unitization, forced-pooling, or otherwise) or until a non-standard unit, eliminating such interests, has been approved by the Division.

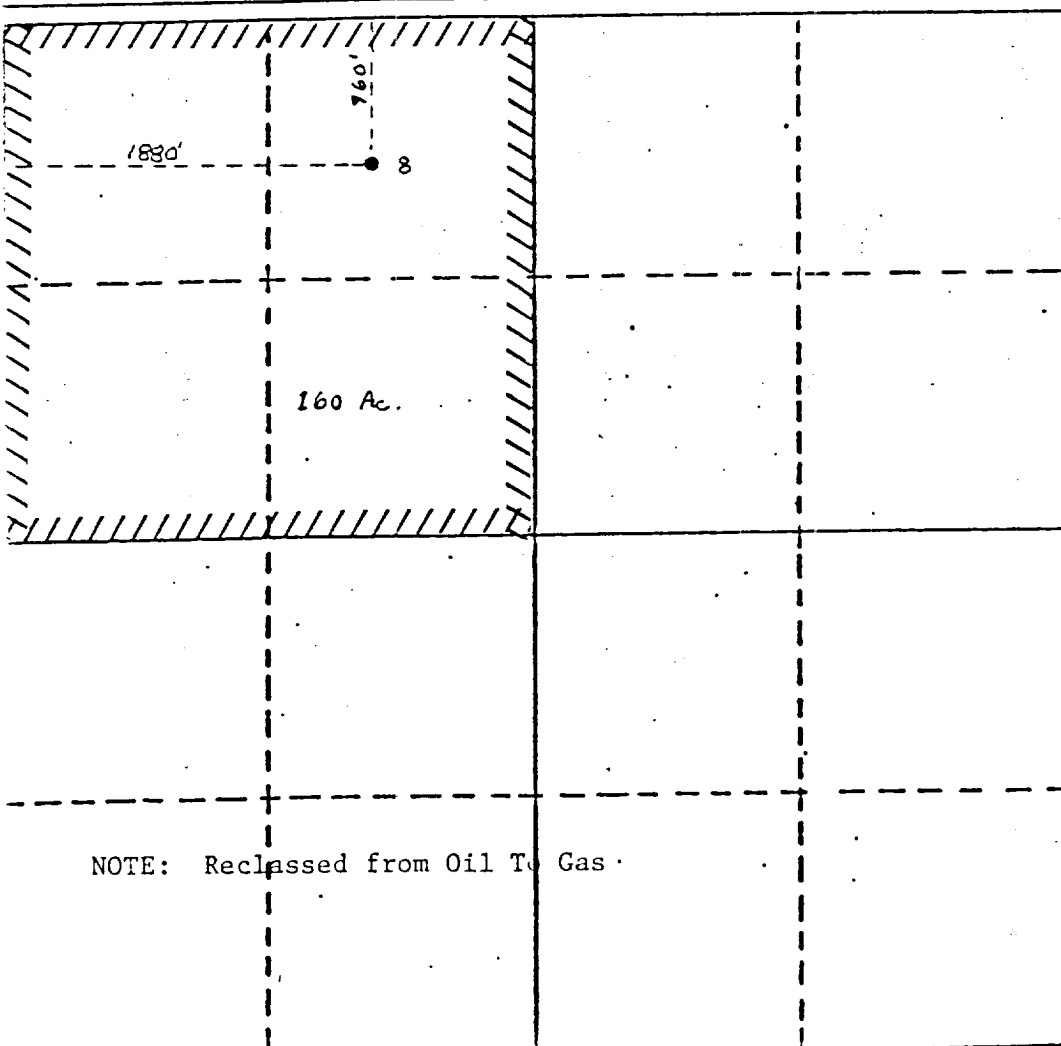

## CERTIFICATION

I hereby certify that the information contained herein is true and complete to the best of my knowledge and belief.

*M. E. Sweeney*  
Name

Manager Environmental and Regulatory  
Position

Mobil Producing Texas & New Mexico Inc.

Company  
acting by and through its agent  
Mobil Exploration & Producing U.S. Inc.

Date  
11-9-88

I hereby certify that the well location shown on this plat was plotted from field notes of actual surveys made by me or under my supervision, and that the same is true and correct to the best of my knowledge and belief.

8-1-84

Date Surveyed

H. A. Carson

Registered Professional Engineer  
and/or Land Surveyor

Certificate No.  
5063

RECEIVED

DEC 20 1988

OCD  
HOBBS OFFICE



COUNTY LEA      Well Blinebry      STATE NM  
 OPR MOBIL PRODUCING TX & NM      API 30-025-28900  
 NO 8      LEASE Hardy, Cordelia      MAP  
 Sec 29, T21S, R37E      CO-ORD  
 760 FNL, 1880 FWL of Sec      3-1-48 NM  
 3 mi NE/Eunice      SPD 10-29-84 CMP 2-1-85

CSC

8 5/8-1260-700 sx  
 5 1/2-5910-2350 sx  
 2 3/8-5180

WELL CLASS: INIT D FIN DO LSE CODE

FORMATION	DATUM	FORMATION	DATUM
TD 5910 (BLBR)		PBD 5909	

TP (Blinebry) Perfs 5603-5763 P 29 BOPD 445 BW. Pot  
 basef on 24 hr test. GOR 3913; gty 44.6

CONTR Rod Ric #2      OPRSELEV 3488 GR 3498 KB SUBS 9

F.R. 9-17-84  
 PD 5700 RT (Blinebry)  
 10-30-84 TD 455; fsg DC  
 11-5-84 Drlg 3705 anhy & salt  
 11-9-84 TD 4784; Trip  
 11-19-84 TD 5910; Fsg  
 12-3-84 TD 5910; Prep ST  
 Could not recover fish  
 12-7-84 TD 5910; Drlg by @ 5199  
 PB to 4958  
 DOC to 5115  
 Set whipstock & drld off @ 5115  
 12-15-84 TD 5910; WOCT  
 No Cores or DST's  
 1-9-85 TD 5910; PBD 5909; Swbg  
 Perf (Blinebry) 5603-5604, 5610-5612, 5616-  
 5618, 5643-5647, 5672-5675, 5682-5714, 5735-  
 5740, 5746-5750, 5763-5763 w/1 SPF  
 3-1-48 NM

---

LEA  
MOBIL PRODUCING  
TX & NM

Blinebry  
8 Harly, Cordelia  
Sec 29, T21S, R37E

NM  
Page #2

1-9-85      Continued  
            Acid (5603-5763) 6200 gals (15%)  
            Swbd 11 BO + 4 BLW in 5 hrs (5603-5763)  
1-14-85      TD 5910; PBD 5909; CO sd  
            Frac (5603-5763) 63,000 gals + 157,000# sd  
1-17-85      TD 5910; PBD 5909; TOP  
            Ppd 31 BLW in 14 hrs (5603-5763)  
2-25-85      TD 5910; PBD 5909; Complete  
            LOG TOPS: Queen 3365, San Andres 3858,  
            Glorieta 5092, Paddock 5142, Blinebry 5560  
            LOGS RUN: CCL, CBND, CNL, NGT, LSS  
            Rig Released 12-14-84      3-1-48 NM  
3-2-85      COMPLETION ISSUED      IC 30-025-70469-84

---