

30-025-29277

STATE OF NEW MEXICO
ENERGY AND MINERALS DEPARTMENT

OIL CONSERVATION DIVISION
P. O. BOX 2088
SANTA FE, NEW MEXICO 87501

Form C-101
Revised 10-1-78

COPIES RECEIVED	
DISTRIBUTION	
SANTA FE	
FILE	
U.S.G.S.	
LAND OFFICE	
OPERATOR	

5A. Indicate Type of Lease STATE <input checked="" type="checkbox"/> FEE <input type="checkbox"/>
5. State Oil & Gas Lease No. 16-4234
7. Unit Agreement Name
8. Farm or Lease Name San Simon St.
9. Well No. 1
10. Field and Pool, or Wildcat San Simon Yates
17. County Lea

APPLICATION FOR PERMIT TO DRILL, DEEPEN, OR PLUG BACK

1a. Type of Work
b. Type of Well
OIL WELL ☒ GAS WELL ☐ OTHER ☐
DRILL ☒ DEEPEN ☐ PLUG BACK ☐
SINGLE ZONE ☒ MULTIPLE ZONE ☐

2. Name of Operator
V-F Petroleum, Inc.
3. Address of Operator
One Marienfeld Place, Suite 580 Midland, Texas 79701
4. Location of Well
UNIT LETTER D LOCATED 990 FEET FROM THE North LINE
AND 330 FEET FROM THE West LINE OF SEC. 4 TWP. 22-S RGE. 35-E NMPM

19. Proposed Depth
4500
19A. Formation
Yates
20. Rotary or C.T.
Rotary
21. Elevations (Show whether DF, KT, etc.)
3622 GL
21A. Kind & Status Plug. Bond
\$50,000 Blanket-current
21B. Drilling Contractor
CapStar
22. Approx. Date Work will start
6-5-85

23. PROPOSED CASING AND CEMENT PROGRAM

SIZE OF HOLE	SIZE OF CASING	WEIGHT PER FOOT	SETTING DEPTH	SACKS OF CEMENT	EST. TOP
11"	8 5/8"	24#	350'	250	surface
7 7/8"	5 1/2"	15.5#	4300'	400	2000'

Drill 11" surface hole to 350'. Set 8 5/8" 24# J-55 casing & cement to surface. Test casing to 1,000# for 30 min. Nipple up wellhead & 3,000# annular BOP. Test to 1,000# for 30 min. Drill 7 7/8" hole to TD. Mud up at 4,000' with salt water gel & starch to 34 vis & 10 WL. Evaluate Yates sand by samples evaluation & run Electric logs. If samples & Electric logs indicate the Yates to be productive, run production casing. If samples & Electric logs do not indicate the Yates formation to be productive, plug well per New Mexico Oil Conservation Commission recommendation.

52
Permit Expires 6 Months From Approval Date Unless Drilling Underway.

IN ABOVE SPACE DESCRIBE PROPOSED PROGRAM; IF PROPOSAL IS TO DEEPEN OR PLUG BACK, GIVE DATA ON PRESENT PRODUCTIVE ZONE AND PROPOSED NEW PRODUCTION ZONE. GIVE BLOWOUT PREVENTER PROGRAM, IF ANY.

I hereby certify that the information above is true and complete to the best of my knowledge and belief.

Signed Jerry Sexton Title Production Superintendent Date 5-16-85

(This space for State Use)

ORIGINAL SIGNED BY JERRY SEXTON

APPROVED BY DISTRICT SUPERVISOR TITLE DISTRICT SUPERVISOR DATE 5-16-85

CONDITIONS OF APPROVAL, IF ANY:

NEW MEXICO OIL CONSERVATION COMMISSION
WELL LOCATION AND ACREAGE DEDICATION PLAT

Form C-102
Supersedes C-128
Effective 1-4-85

All distances must be from the outer boundaries of the Section.

Operator V-F Petroleum, Inc.		Lease San Simon St.		Well No. L
Unit Letter D	Section 4	Township 22 South	Range 35 East	County Lea
Actual Footage Location of Well: 990 feet from the North line and 330 feet from the West line				
Ground Level Elev. 3622	Producing Formation Yates	Pool San Simon Yates	Dedicated Acreage: 41.96 40 Acres	

1. Outline the acreage dedicated to the subject well by colored pencil or hatchure marks on the plat below.
2. If more than one lease is dedicated to the well, outline each and identify the ownership thereof (both as to working interest and royalty).
3. If more than one lease of different ownership is dedicated to the well, have the interests of all owners been consolidated by communitization, unitization, force-pooling, etc?

☐ Yes ☐ No If answer is "yes," type of consolidation _____

If answer is "no," list the owners and tract descriptions which have actually been consolidated. (Use reverse side of this form if necessary.) _____

No allowable will be assigned to the well until all interests have been consolidated (by communitization, unitization, forced-pooling, or otherwise) or until a non-standard unit, eliminating such interests, has been approved by the Commission.

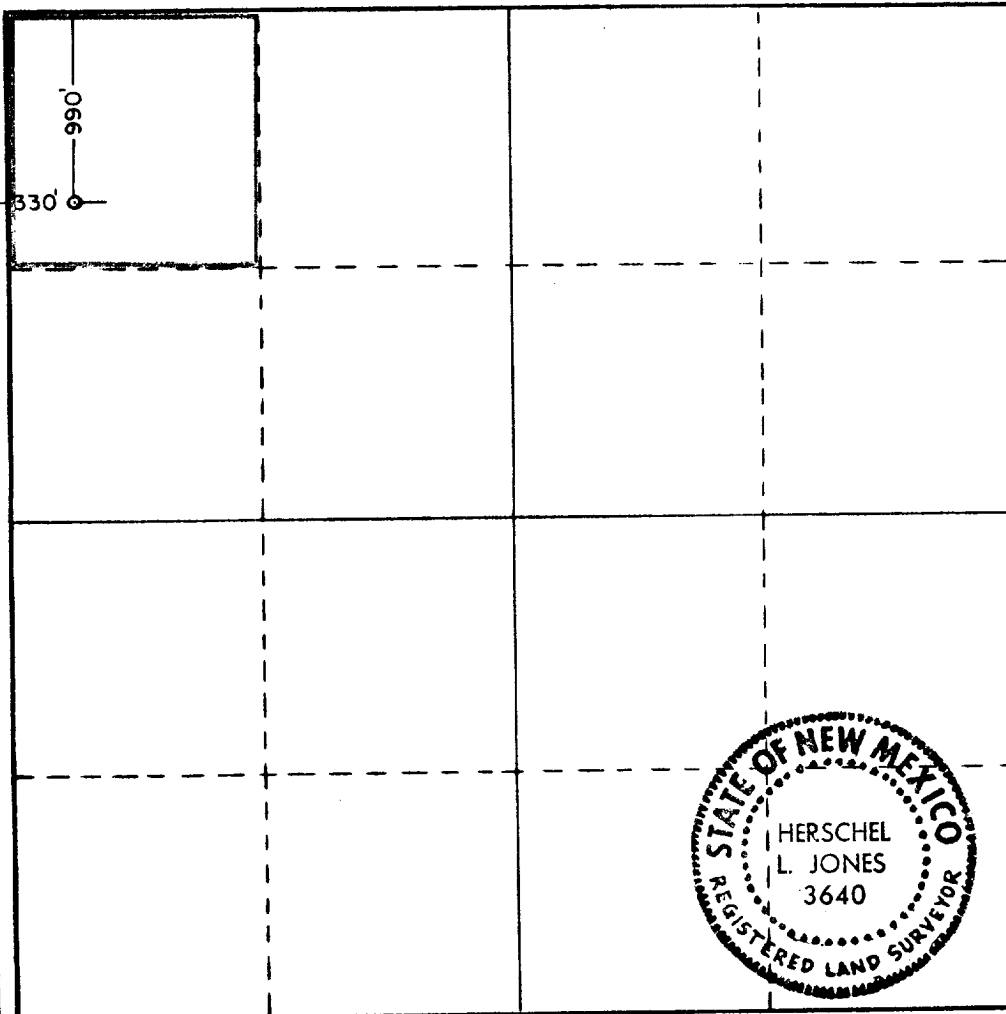

CERTIFICATION

I hereby certify that the information contained herein is true and complete to the best of my knowledge and belief.

Name

Wayne Luna

Position

Superintendent

Company

V-F Petroleum, Inc.

Date

5-16-85

I hereby certify that the well location shown on this plat was plotted from field notes of actual surveys made by me or under my supervision, and that the same is true and correct to the best of my knowledge and belief.

Date Surveyed

4/3/85

Registered Professional Engineer and/or Land Surveyor

Certificate No.

3640

0 330 660 990 1320 1650 1980 2310 2640 2970 3300 3630 3960 4290 4620 4950 5280 5610 5940 6270 6600 6930 7260 7590 7920 8250 8580 8910 9240 9570 9900