

NEW MEXICO OIL CONSERVATION COMMISSION
WELL LOCATION AND ACREAGE DEDICATION PLAT

Form C-102
Supersedes C-128
Effective 1-1-65

All distances must be from the outer boundaries of the Section.

Operator MAXUS EXPLORATION COMPANY			Lease FEDERAL		Well No. 2
Unit Letter P	Section 34	Township 22-S	Range 34-E	County Lea	
Actual Footage Location of Well: 660 feet from the East line and 660 feet from the South line					
Ground Level Elev: 3403	Producing Formation Atoka / Morrow		Pool Antelope Ridge		Dedicated Acreage: 320 Acres

1. Outline the acreage dedicated to the subject well by colored pencil or hachure marks on the plat below.
2. If more than one lease is dedicated to the well, outline each and identify the ownership thereof (both as to working interest and royalty).
3. If more than one lease of different ownership is dedicated to the well, have the interests of all owners been consolidated by communitization, unitization, force-pooling, etc?

☐ Yes ☐ No If answer is "yes," type of consolidation _____

If answer is "no," list the owners and tract descriptions which have actually been consolidated. (Use reverse side of this form if necessary.) _____

No allowable will be assigned to the well until all interests have been consolidated (by communitization, unitization, forced-pooling, or otherwise) or until a non-standard unit, eliminating such interests, has been approved by the Commission.

SECTION 34 <div style="position: relative; width: 100%; height: 100%;"> <div style="position: absolute; top: 50%; left: 50%; transform: translate(-50%, -50%);">E/2 320 acres</div> </div>			
--	--	--	--

CERTIFICATION

I hereby certify that the information contained herein is true and complete to the best of my knowledge and belief.

Greg Drwenski
Name

Greg Drwenski

Position
Senior Production Engineer

Company
Maxus Exploration Company

Date
October 10, 1987

I hereby certify that the well location shown on this plat was plotted from field notes of actual surveys made by me or under my supervision, and that the same is true and correct to the best of my knowledge and belief.

Date Surveyed

Registered Professional Engineer
and/or Land Surveyor

Certificate No.

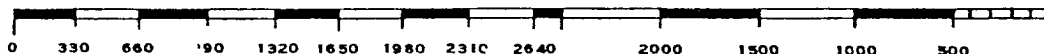

ENERGY AND MINERALS DEPARTMENT

OIL CONSERVATION DIVISION



April 15, 1987

GARREY CARRUTHERS
GOVERNOR

Diamond Shamrock Exploration Company
2001 Ross Avenue
Dallas, Texas 75201-2916

POST OFFICE BOX 2088
STATE LAND OFFICE BUILDING
SANTA FE, NEW MEXICO 87501
(505) 827-5800

Attn: Randy Simmons
Reservoir Engineer Manager

Re: Federal Well No. 2 Unit P,
Section 34, Township 22
South, Range 34 East, Lea
County, New Mexico

Dear Mr. Simmons:

Division Order No. R-8331, dated November 4, 1986, authorized the drilling of the subject well to test the Antelope Ridge Atoka Gas Pool at an unorthodox gas well location 660 feet from the South and East lines (Unit P) of said Section 34. Division Order No. R-8331-A, dated March 13, 1987, amended R-8331 to include the Undesignated Antelope Ridge Morrow Gas Pool into the provisions set forth in that order. Both orders indicated the S/2 of said Section 34 was to be dedicated in both pools to the well.

Your letter dated April 10, 1987, requesting a re-orientation of the dedicated acreage in both pools for the subject well to include the E/2 of said Section 34, has been considered and reviewed. Since this change would facilitate the drilling of an Atoka/Morrow well in the SW/4 of said Section 34 and the ownership of minerals is common throughout the entire section, your request to rededicate the E/2 of said Section 34 to the subject well is hereby approved.

Sincerely,

A handwritten signature in dark ink, appearing to read "William J. Lemay".

WILLIAM J. LEMAY
Director

WJL/MES/et

xc: Oil Conservation Division - Hobbs
Paul Cooler
Case Nos. 9005, 9087

Submit to appropriate
District Office
State Lease - 4 copies
Fee Lease - 3 copies

State of New Mexico
Energy, Minerals and Natural Resources Department

Form C-102
Revised 1-1-89

OIL CONSERVATION DIVISION

P.O. Box 2088
Santa Fe, New Mexico 87504-2088

DISTRICT I

P.O. Box 1980, Hobbs, NM 88240

DISTRICT II

P.O. Drawer DD, Artesia, NM 88210

DISTRICT III

1000 Rio Brazos Rd., Aztec, NM 87410

WELL LOCATION AND ACREAGE DEDICATION PLAT

All Distances must be from the outer boundaries of the section

Operator BTA OIL PRODUCERS			Lease MAXUS "B", 8026 JV-P		Well No. 1
Unit Letter P	Section 34	Township 22 S	Range 34E	County NMPM	Lea
Actual Footage Location of Well: 660 feet from the South line and 660 feet from the East line					
Ground level Elev. 3403	Producing Formation Atoka Morrow		Pool Antelope Ridge	Dedicated Acreage: 320 Acres	

1. Outline the acreage dedicated to the subject well by colored pencil or hatchure marks on the plat below.
2. If more than one lease is dedicated to the well, outline each and identify the ownership thereof (both as to working interest and royalty).
3. If more than one lease of different ownership is dedicated to the well, have the interest of all owners been consolidated by communitization, unitization, force-pooling, etc.?
☐ Yes ☐ No If answer is "yes" type of consolidation _____
If answer is "no" list the owners and tract descriptions which have actually been consolidated. (Use reverse side of this form if necessary). _____
No allowable will be assigned to the well until all interests have been consolidated (by communitization, unitization, forced-pooling, or otherwise) or until a non-standard unit, eliminating such interest, has been approved by the Division.

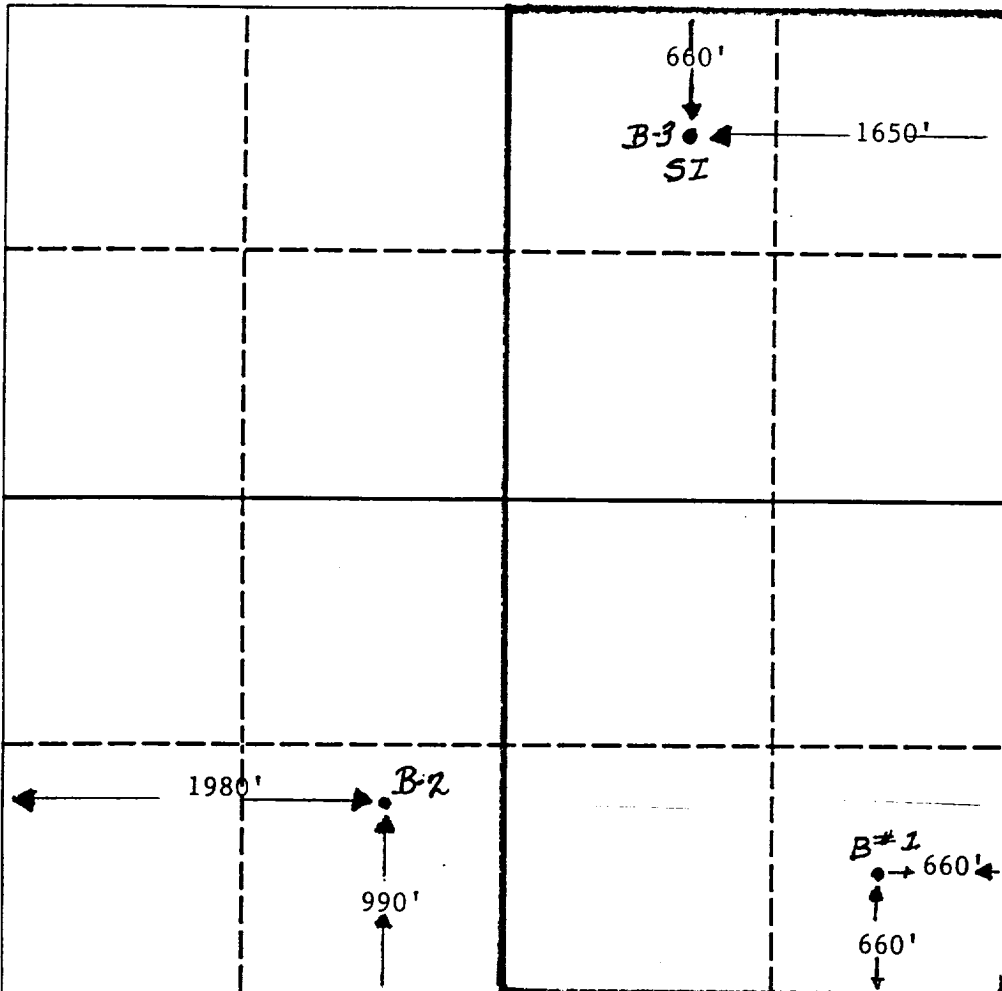

OPERATOR CERTIFICATION

I hereby certify that the information contained herein is true and complete to the best of my knowledge and belief.

Signature

Printed Name

DOROTHY HOUGHTON

Position

Regulatory Administrator

Company

BTA OIL PRODUCERS

Date

12-2-92

SURVEYOR CERTIFICATION

I hereby certify that the well location shown on this plat was plotted from field notes of actual surveys made by me or under my supervision, and that the same is true and correct to the best of my knowledge and belief.

Date Surveyed

Signature & Seal of
Professional Surveyor

Certificate No.

NEW MEXICO OIL CONSERVATION COMMISSION
WELL LOCATION AND ACREAGE DEDICATION PLAT

Form C-102
Supersedes C-128
Effective 1-1-65

All distances must be from the outer boundaries of the Section.

Operator BTA OIL PRODUCERS			Lease Maxus -B-, 8026 JV-P			Well No. 1		
Unit Letter P	Section 34	Township 22-S	Range 34-E	County LEA				
Actual Footage Location of Well: <div style="display: flex; justify-content: space-between; align-items: center;"> 660 feet from the South line and 660 feet from the East line </div>								
Ground Level Elev. 3403'	Producing Formation Atoka		Pool Antelope Ridge			Dedicated Acreage 320 Acres		

1. Outline the acreage dedicated to the subject well by colored pencil or hatchure marks on the plat below.
2. If more than one lease is dedicated to the well, outline each and identify the ownership thereof (both as to working interest and royalty).
3. If more than one lease of different ownership is dedicated to the well, have the interests of all owners been consolidated by communitization, unitization, force-pooling, etc?

☐ Yes ☐ No If answer is "yes," type of consolidation _____

If answer is "no," list the owners and tract descriptions which have actually been consolidated. (Use reverse side of this form if necessary.) _____

No allowable will be assigned to the well until all interests have been consolidated (by communitization, unitization, forced-pooling, or otherwise) or until a non-standard unit, eliminating such interests, has been approved by the Commission.

DISTANCE & DIRECTION: From Jct. of Hwy 17B & Loop 18, in Eunice, Go South 2.5 mi. on Hwy 18, Thence West, Southwest & West 20.5 mi. on Paved Co. Rd., Thence North 1.0 mi. on Lease Rd., Thence West on Trail Rd. 0.8 mi. to the SE corner of Sec. 34.

NOTE: BTA OIL PRODUCERS
#1 Maddox
Bears N 89°54' E, 2645'

660'
660'

CERTIFICATION

I hereby certify that the information contained herein is true and complete to the best of my knowledge and belief.

Dorothy Houghton
Name

DOROTHY HOUGHTON
Position

Reg. Administrator
Company

BTA OIL PRODUCERS
Date

1/8/90

I hereby certify that the well location shown on this plat was plotted from field notes of actual surveys made by me or under my supervision, and that the same is true and correct to the best of my knowledge and belief.

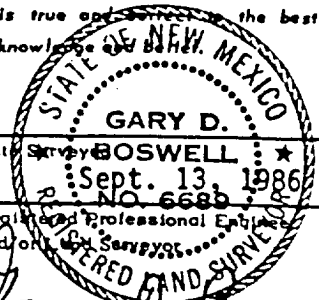

Date Surveyed **Sept. 13, 1986**
No. **6689**

Registered Professional Engineer and Oil & Gas Surveyor

Gary D. Boswell
Certificate No.

6689

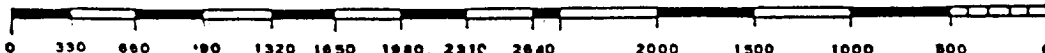

WRS COMPLETION REPORTREISSUES SEC 34 TWP 22S RGE 34E
PI# 30-T-0015 01/30/89 30-025-29807-0000 PAGE 1

NMEX LEA * 660FSL 660FEL SEC SE SE
STATE COUNTY FOOTAGE SPOT
MAXUS EXPL D DG
OPERATOR WELL CLASS INIT FIN
2 FEDERAL
WELL NO. LEASE NAME
3430KB 3403GR ANTELOPE RIDGE
OPER ELEV FIELD POOL AREA
API 30-025-29807-0000
LEASE TYPE/NO. PERMIT OR WELL I.D. NO.
01/19/1987 09/05/1987 ROTARY 2 GAS
SPUD DATE COMP. DATE TYPE TOOL STATUS
12500 WILLBROS DRLG 11 RIG SUB 26
PROJ. DEPTH PROJ. FORM CONTRACTOR
DTD 13562 PB 13512 FM/TD MORROW
DRILLERS T.D. LOG T.D. PLUG BACK TD OLD T.D. FORM T.D.

LOCATION DESCRIPTION

32 MI SE BUCKEYE, NM

WELL IDENTIFICATION/CHANGESOPER CHGD FROM DIAMOND SHAMROCK EXPL
ELEV CHGD FROM 3043 GR**CASING/LINER DATA**

CSG 13 3/8 @ 725 W/ 540 SACKS
CSG 9 5/8 @ 4849 W/ 1525 SACKS
CSG 7 @ 11722 W/ 300 SACKS
LNR 5 1/2 11367-13559 W/ 225S

TUBING DATA

TBG 2 3/8 AT 11348 2 3/8 AT 13081

INITIAL POTENTIAL

IPF 71BOPD 1500 MCFD 8BW 21/64CK 24HRS
ATOKA PERF W/ 30/IT 12191-12244 GROSS
TP 850 CP 1100
GTY 49.8 GOR 23746 GAS GTY NOT RPTD

IPF 12BOPD 4536 MCFD 12BW 10/64CK 24HRS
MORROW PERF W/ 18/IT 13338-13428 GROSS
TP 3900
GTY 45.5 GOR 378000 GAS GTY NOT RPTD

CONTINUED IC# 300257034586

Copyrighted 1989
Petroleum
Information Corporation**Petroleum Information****DB** a company of
The Dun & Bradstreet CorporationPI-WRS-GE
Form No 18

REISSUES
PI# 30-T-0015 01/30/89 SEC 34 TWP 22S RGE 34E
30-025-29807-0000 PAGE 2

MAXUS EXPL
2

FEDERAL

D DG

INITIAL POTENTIAL

FCP PKR

POT BASED ON 2 HR TEST - FLWD 1 BO, 343 MCFG, 1 BW

TYPE	FORMATION	LTH	TOP	DEPTH/SUB	BSE	DEPTH/SUB
LOG	DELAWARE		4845	-1415		
LOG	BELL CYN		5308	-1878		
LOG	CHER CYN		6203	-2773		
LOG	BRSH CYN		7193	-3763		
LOG	BONE SPG		8494	-5064		
LOG	BONE SP1		8592	-5162		
LOG	BONE SP2		9535	-6105		
LOG	WOLFCAMP		10489	-7059		
LOG	STRAWN		11812	-8382		
LOG	ATOKA		12085	-8655		
LOG	MORROW U		12785	-9355		
LOG	MORROW M		13090	-9660		

SUBSEA MEASUREMENTS FROM KB

FORMATION TEST DATA

DST 1 7264- 7330 BRSH CYN S
REC 30.0 FT OCFLUD
INIT OP 30M IFP 25 FFP 25
FINAL OP 1H IFP 30 FFP 31
ISIP 1854 1H33M FSIP 2095 3H IHP 3325 FHP 3325

PRODUCTION TEST DATA

PTF 12BO 4129 MCFD 12BW 10/64CK 2HRS
MORROW PERF W/ 18/IT 13338-13428 GROSS
PERF 13338-13342 13348-13359 13395-13409 13422-13428
ACID 13338-13428 4000GALS
SWFR 13338-13428 42000GALS 27500LBS SAND
20/40 40 LB HPG ADDTVGELA
PTF 71BOPD 1500 MCFD 8BW 21/64CK 24HRS
ATOKA PERF W/ 30/IT 12191-12244 GROSS
PERF 12191-12196 12208-12215 12225-12232 12237-12244
ACID 12191-12244 5000GALS

CONTINUED

REISSUES SEC 34 TWP 22S RGE 34E
PI# 30-T-0015 01/30/89 30-025-29807-0000 PAGE 3

MAXUS EXPL
2

FEDERAL

D DG

PRODUCTION TEST DATA

15% HCL
ACFR 12191-12244 20000GALS
20% HCL

LOGS AND SURVEYS /INTERVAL,TYPE/

LOGS	DLL	SPCT	BHCS
LOGS	GR	SDBL	MSFL
LOGS	CNL	LDT	CNDL

DRILLING PROGRESS DETAILS

MAXUS EXPL
2001 ROSS AVE STE 1200 LTV CENTER
DALLAS, TX 75201
214-922-2000
PROJ FM - ATOKA & MORROW

12/04	LOC/1986/
01/19	RURT
01/30	4849 TD, RNG CSG
02/02	DRLG 5460
02/09	DRLG 8175
02/17	DRLG 11588
03/06	11722 TD, RNG 7 CSG
03/18	DRLG 12000
03/26	13562 TD, RNG LOGS
04/03	13562 TD, WOCT
05/01	13562 TD, WOCT
06/02	13562 TD, WOCT
06/19	13562 TD, WOCT
06/26	13562 TD, WOCT
07/02	13562 TD, WOCT
07/17	13562 TD, PB 13512, PREP PERF
08/20	13562 TD, PB 13512, PREP PERF
08/31	13562 TD, PB 13512, PREP PERF
09/18	13562 TD, PB 13512, FLWG
01/18	RAN RFT 12230-12242 (ATOKA) NO OTHER DETAILS
	POROUS ZONE - 12191-12244 (ATOKA) MASS NON-BDD
	LS, WHT TO MED BRN, FOSS, VF GRN MTRX, MOL &
	INTRAPAR PORO, PKST
	POROUS ZONE - 13348-13428 (MORROW) INTBD SH &
	WHT CLR OPQ TO TRANSL, CONSOL FN TO MED GRN SS,

CONTINUED

REISSUES SEC 34 TWP 22S RGE 34E
PI# 30-T-0015 01/30/89 30-025-29807-0000 PAGE 4

MAXUS EXPL
2

FEDERAL

D DG

DRILLING PROGRESS DETAILS

SLI CALC CMT, WL SRTD & WL RND GRN
01/18 TD REACHED 03/25/87 RIG REL 03/25/87
13562 TD, PB 13512
COMP 9/5/87, IPF 71 BO, 1500 MCFG, 8 BWPD
THRU 21/64 CHK, GOR 23746,
GTY (GAS) (NR), (COND) 49.8,
FTP 850, FCP 1100
PROD ZONE - ATOKA 12191-12244
COMP 8/2/87, IPF 12 BO, 4536 MCFG, 12 BWPD
THRU 10/64 CHK, GOR 378000,
GTY (GAS) (NR), (COND) 45.5,
FTP 3900, FCP PKR
PROD ZONE - MORROW 13338-13428
(DUAL PRODUCER)
NO CORES, ONE DST RPTD
01/26 REISSUED TO ADD DST & NO CORES STMT
REPLACEMENT FOR CT ISSUED 1/25/88